

TERMINAL JOINT BETWEEN CONTRACTS - TYPE 1

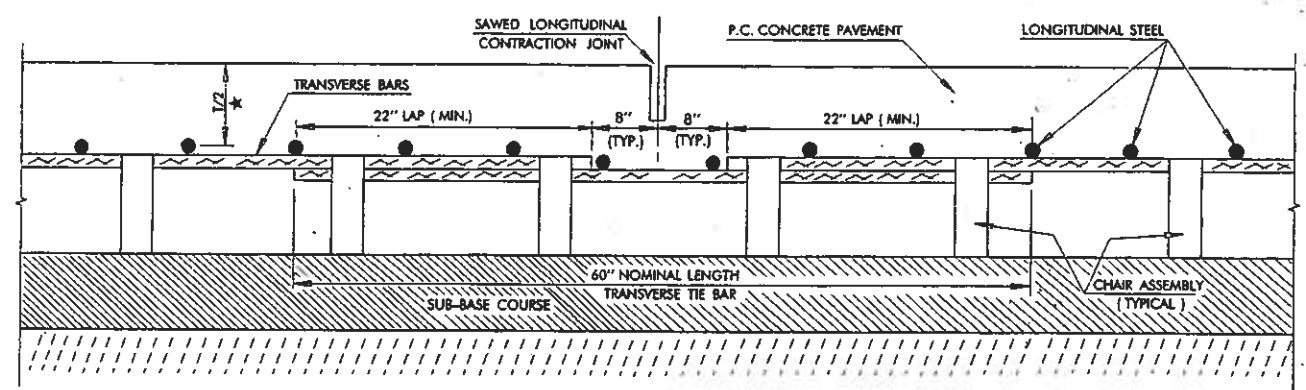

TRANSVERSE BAR SUPPORT DETAIL

NOTE: CHAIR ASSEMBLIES ARE SUGGESTIONS ONLY AND DO NOT ENDORSE SPECIFIC DESIGN SHOW HERE.

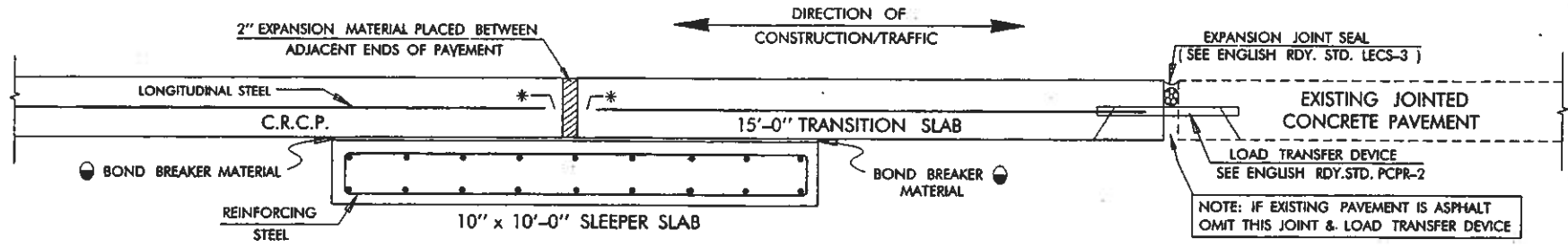

TERMINAL JOINT BETWEEN CONTRACTS - TYPE 2

- GENERAL NOTES**
1. THREE APPLICATIONS OF WAX-BASED CURING COMPOUND SHALL BE APPLIED TO TOP SURFACE OF SLEEPER SLAB IMMEDIATELY PRIOR TO PAVING. BOND BREAKER MATERIAL SHALL NOT BE APPLIED TO REINFORCING STEEL IMMEDIATELY PRIOR TO PAVING. BOND BREAKER MATERIAL SHALL NOT BE APPLIED TO REINFORCING STEEL.
 2. LONGITUDINAL STEEL REINFORCEMENT MAY BE PLACED WITHIN 1" ABOVE T/2 TO 1/2" BELOW T/2. DIMENSION FOR PLACEMENT IS MEASURED AT THE CENTERLINE OF THE REINFORCING BAR.
 3. TYPE 1 TERMINAL JOINT ONLY TO BE USED BETWEEN CRCP CONTRACTS AND/OR WHERE THE PAVING OPERATION IS DELAYED SEVEN OR MORE DAYS. THE CONTRACTOR SHALL PROTECT THE EXPOSED END OF PAVEMENT AND SLEEPER SLAB FROM PERMANENT DAMAGE DURING ALL WORK STOPPAGES IN A MANNER APPROVED BY THE ENGINEER.
 4. TYPE 2 TERMINAL JOINT TO BE USED WHEN CRCP PAVEMENT TERMINATES AT LOCATIONS OTHER THAN AT BRIDGES. TRANSITION SLAB MAY BE TEMPORARY OR BE PERMANENT.
 5. THE 15 FOOT TRANSITION SECTION OF REINFORCED PAVEMENT ADJACENT TO THE TYPE 2 TERMINAL JOINT SHALL BE PAID FOR AS CONTINUOUSLY REINFORCED CONCRETE PAVEMENT.
 6. THE TRANSITION SLAB SHALL BE REINFORCED WITH THE SAME SIZE BARS AND SPACED THE SAME AS THE CONTINUOUSLY REINFORCED CONCRETE PAVEMENT. SEE PLANS FOR VALUE OF PAVEMENT THICKNESS "T".
 7. THE LONGITUDINAL REINFORCING STEEL SHALL HAVE THREE (3) TO FOUR (4) INCHES OF CONCRETE COVER BETWEEN THE END OF THE REINFORCING STEEL AND THE JOINT OPENING FACE.
 8. SLEEPER SLAB SHALL EXTEND 2'-0" BEYOND THE OUTSIDE LATERAL EDGES OF THE CRCP PAVED LANES.
 9. COST OF LOAD TRANSFER DEVICE RETROFIT TO BE INCLUDED IN OTHER ITEMS OF WORK.

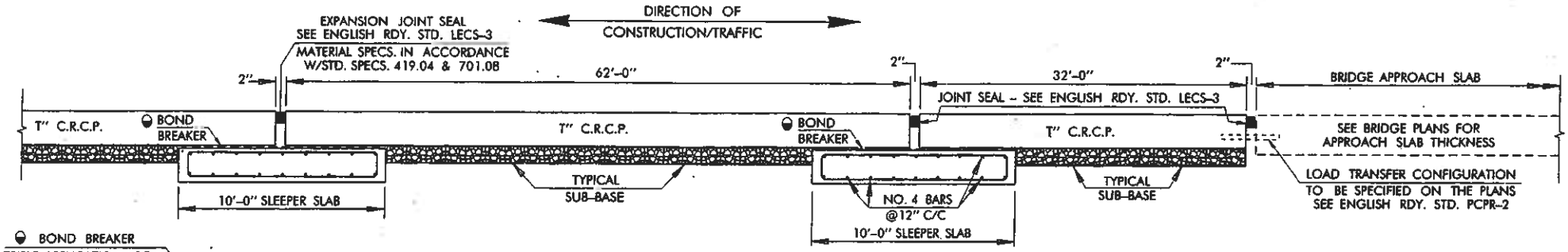

TERMINAL JOINT - TYPE 3 - BRIDGE APPROACH CONTINUOUSLY REINFORCED CONCRETE

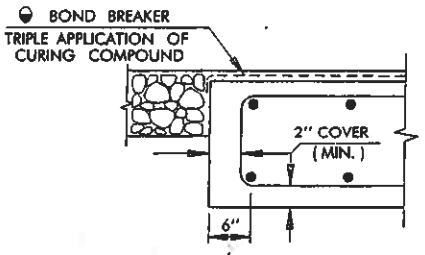

BASIS OF PAYMENT		
ITEM NO.	ITEM	UNIT
414.06(D)	▼ P.C. CONCRETE PAVEMENT (CONTIN. REINFORCED)	S.Y.
414.06(F)	■ TERMINAL JOINT SLEEPER SLAB	S.Y.

▼ THICKNESS IN INCHES TO BE SPECIFIED
 ■ SCHEDULE OF TYPE 1, TYPE 2 AND/OR TYPE 3
 TERMINAL JOINTS SHALL BE SPECIFIED ON THE PLANS.

APPROVED BY ROADWAY ENGINEER *C.M. Shankouli* DATE 9/1/99

OKLAHOMA DEPT. OF TRANSPORTATION
 ROADWAY STANDARD (ENGLISH)
 CONTINUOUSLY REINFORCED
 CONCRETE PAVEMENT
 (REINFORCING STEEL BARS)