

R 17 E

Copies of this map are available for public use at nominal cost.  
Address:  
OKLAHOMA DEPARTMENT OF TRANSPORTATION  
REPRODUCTION BRANCH (Phone - 521-2586)  
200 N. E. 21st STREET  
OKLAHOMA CITY, OKLA. 73105

T 23 N  
T 22 N

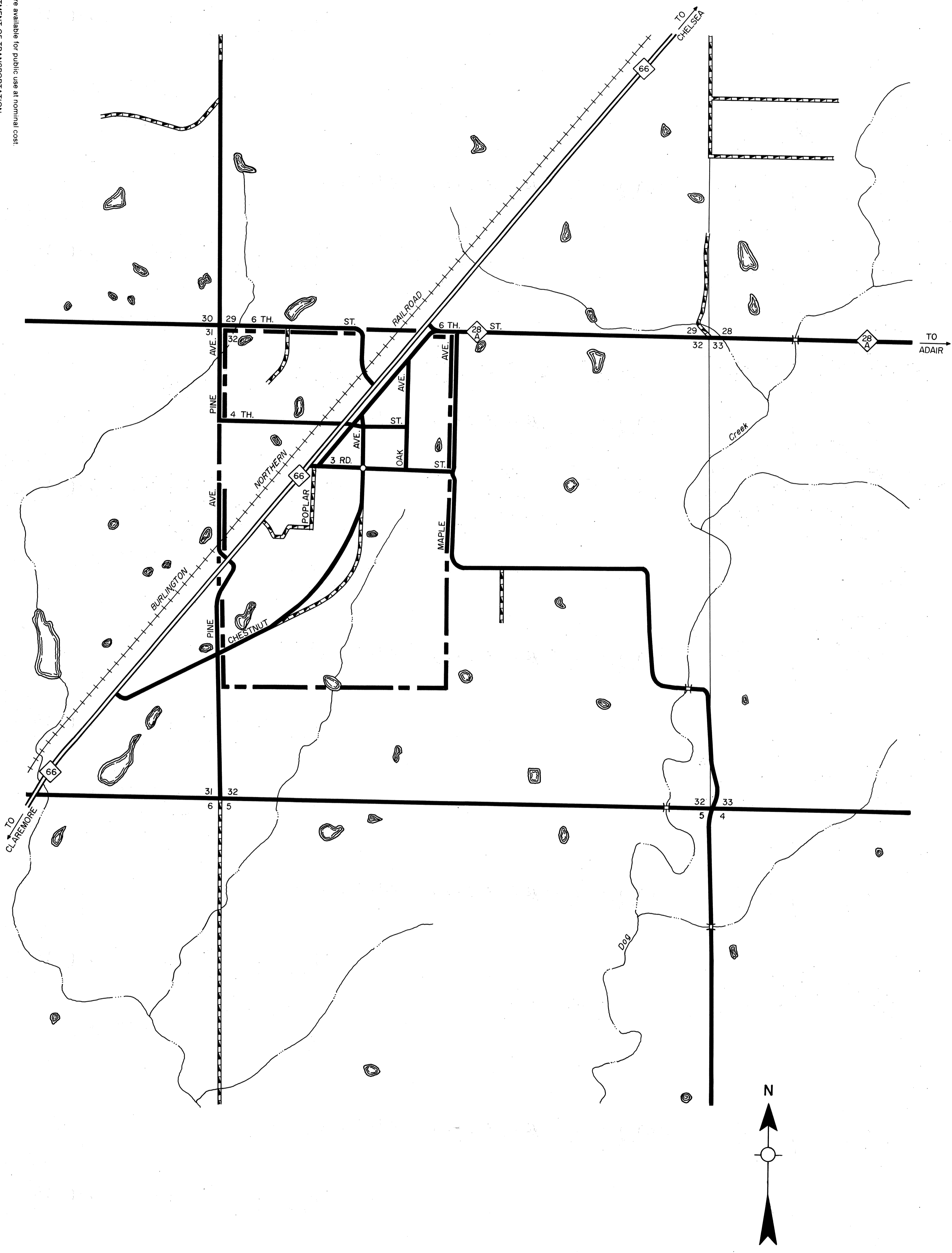

STATE OF OKLAHOMA  
DEPARTMENT OF TRANSPORTATION

CITY OF  
**FOYIL**  
ROGERS COUNTY  
1990  
POPULATION  
86

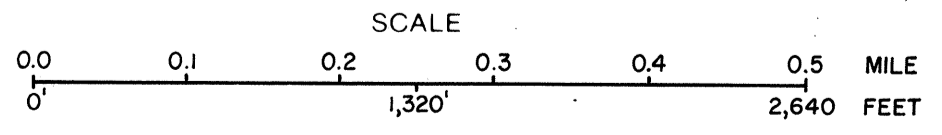

LEGEND

MILEAGE	
PAVED	2.7 CORPORATE LIMITS
GRAVEL	0.8 STATE NUMBERED ROUTES
GRADED & DRAINED	0.0 U.S. NUMBERED ROUTES
UNIMPROVED	0.0 INTERSTATE ROUTES
TOTAL STREETS & HIGHWAYS	3.5 STREETS 2.9 HIGHWAYS 0.6

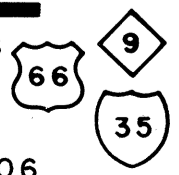

ALL RIGHTS RESERVED

FOYIL, ROGERS CO.  
APRIL 1988