

Copies of this map are available for public use at nominal cost.
Address:
OKLAHOMA DEPARTMENT OF TRANSPORTATION
REPRODUCTION BRANCH (Phone - 521-2586)
200 N. E. 21st STREET
OKLAHOMA CITY, OKLA. 73105

R 6 E R 7 E

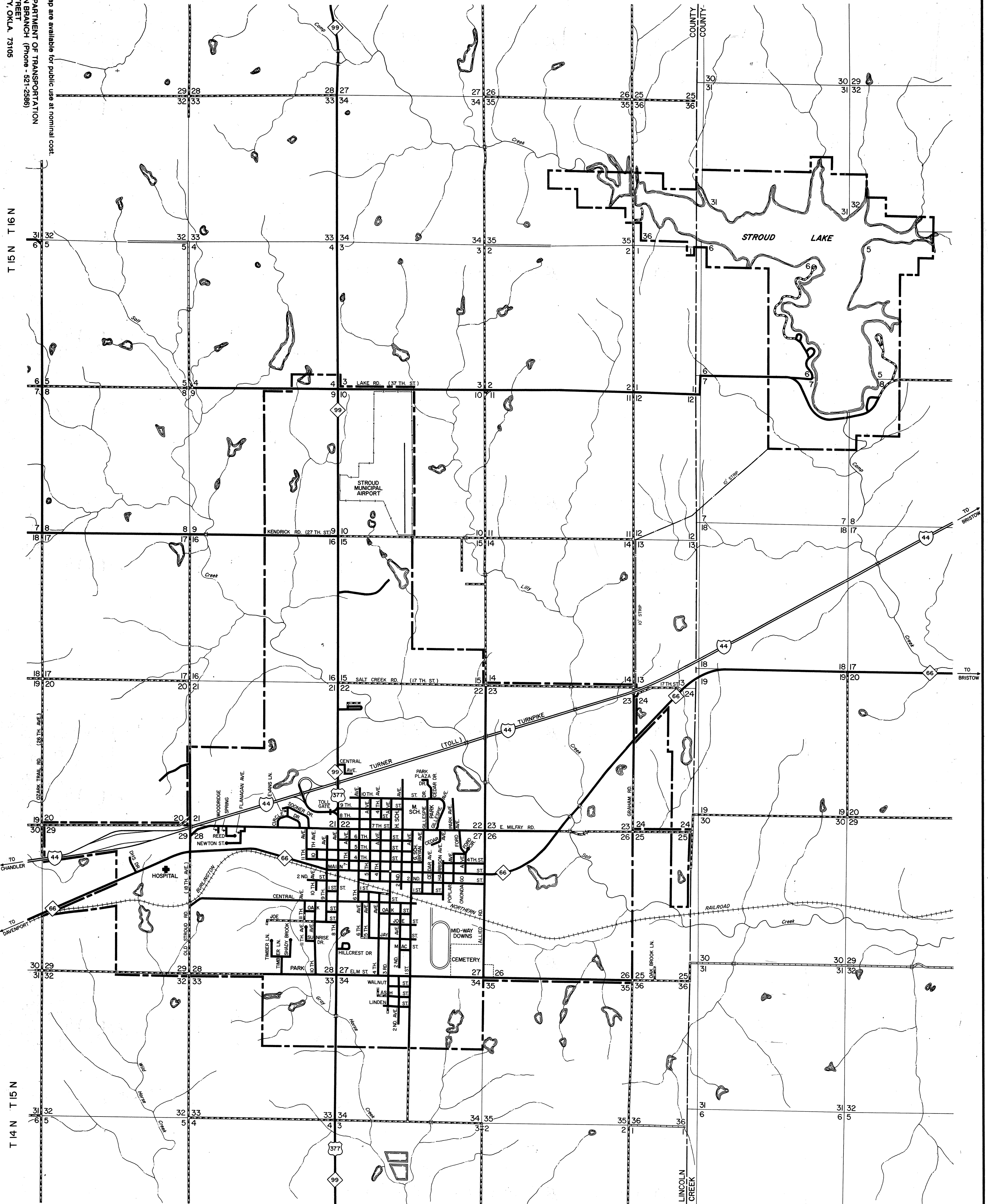

N 9 1 1 N 9 1 1

N 1 5 1 1 N 1 4 1 1

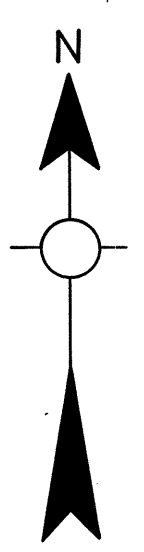

STATE OF OKLAHOMA
DEPARTMENT OF TRANSPORTATION
CITY OF
STROUD
LINCOLN COUNTY
1990
POPULATION
2,666

SCALE

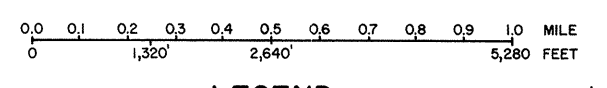

LEGEND

MILEAGE	
PAVED	46.8
GRAVEL	91
GRADED & DRAINED	01
UNIMPROVED	00
TOTAL STREETS & HIGHWAYS	56.0
CORPORATE LIMITS	46.8
STATE NUMBERED ROUTES	91
U.S. NUMBERED ROUTES	01
INTERSTATE ROUTES	00
STREETS 431	HIGHWAYS 12.9

ALL RIGHT RESERVED