

AGENDA ITEM 303 a

State Highway 9 Relocation Cleveland County

Remove from the State Highway System a segment of old road designated as State Highway 9 beginning its junction with US 77 in Norman, at the intersection of Alameda Street with Classen Boulevard and Porter Avenue, and extending easterly to its junction with the new location northeast of the Little River Reservoir Dam, a distance of 13.3 miles. This segment of old road will be transferred to Cleveland County or the City of Norman for further maintenance or abandonment.

Add State Highway 9 designation along US Highway 77 beginning at the intersection of Classen Boulevard with Alameda Street and Porter Avenue and extending southerly on Classen Boulevard to the junction with the new location, a distance of 2.6 miles.

Add to the State Highway System a segment of new road to be designated as State Highway 9 beginning at its junction with US Highway 77 in Norman and extending easterly to its junction with the old road northeast of the Little River Reservoir Dam, a distance of 13.6 miles.

The construction on this segment of new road has been completed as SAP Project 868 (9) (10) (11).

Action Approved December 2, 1963

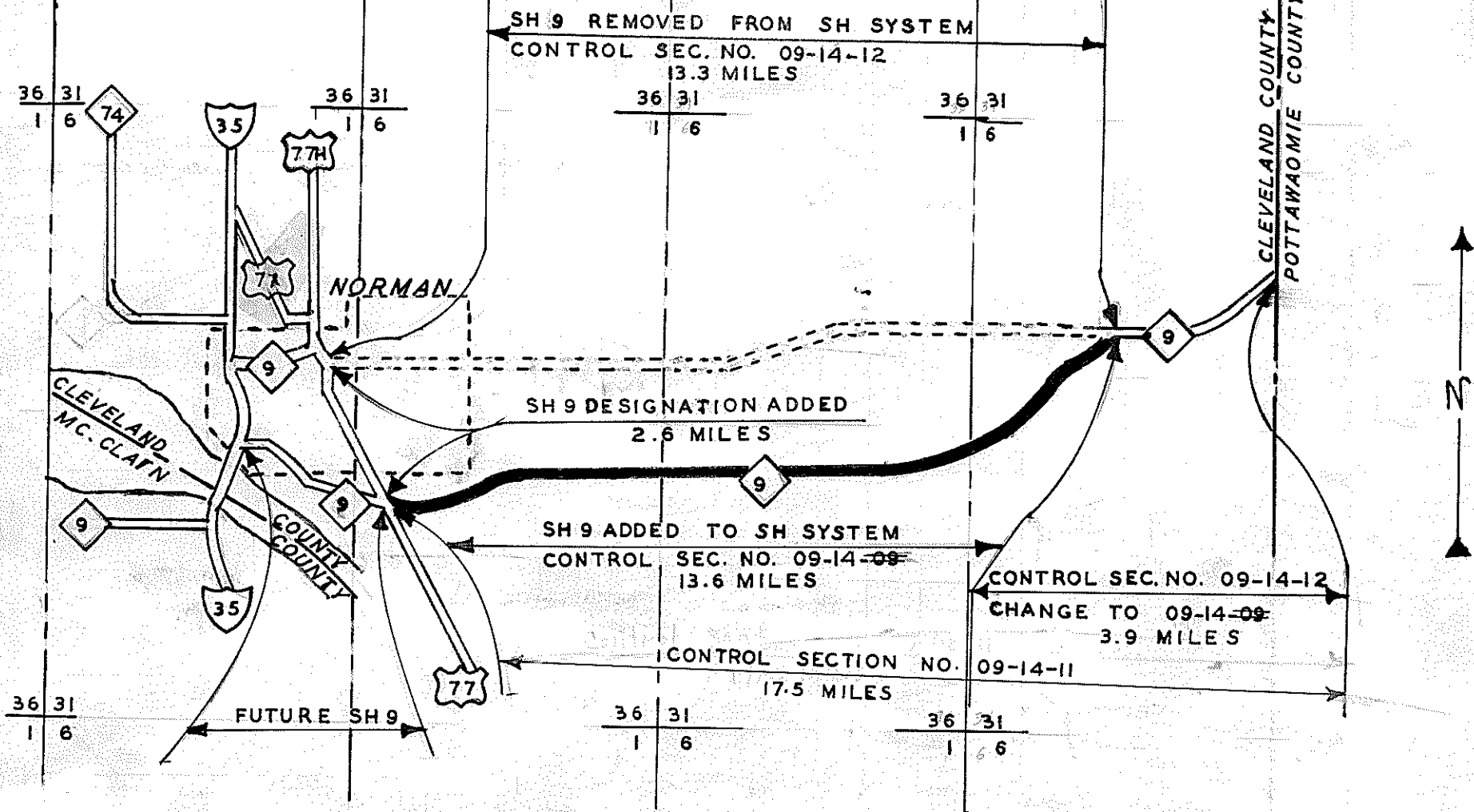

SH 9 RELOCATION  
 US 77 EAST IN NORMAN  
 CLEVELAND COUNTY  
 OCTOBER 7 1963  
 FAP PROJECT 868 (9) (10) (11)  
 CONTROL SECTION NO. REVISED 12-11-63

APPROVED DEC 2 1963 ITEM 303A  
 OKLAHOMA STATE HIGHWAY COMMISSION

APPROVED ADDITION TO SH SYSTEM **————**  
 APPROVED DELETION TO SH SYSTEM **-----**  
 PRESENT SH SYSTEM **=====**

December 5, 1963

Board of County Commissioners  
Cleveland County  
Norman, Oklahoma

Dear Sirs:

The Oklahoma State Highway Commission in regular session December 2, 1963, Item 303 a, approved the following revision in the State Highway System.

Remove from the State Highway System a segment of old road designated as State Highway 9 beginning at its junction with US 77 in Norman (at the intersection of Alameda Street with Classen Boulevard and Porter Avenue) and extending easterly to its junction with the new location northeast of the Little River Reservoir Dam, a distance of 13.3 miles. This segment of old road will be transferred to Cleveland County or the City of Norman for further maintenance or abandonment.

Add State Highway 9 designation along US Highway 77, beginning at the intersection of Classen Boulevard with Alameda Street and Porter Avenue and extending southerly on Classen Boulevard to the junction with the new location, a distance of 2.6 miles.

Add to the State Highway System a segment of new road to be designated as State Highway 9, beginning at its junction with US Highway 77 in Norman and extending easterly to its junction with the old road northeast of the Little River Reservoir Dam, a distance of 13.6 miles.

The construction on this segment of new road has been completed as SAP Project 868 (9) (10) (11).

A copy of the commission minutes concerning this action and a sketch map indicating the location of this revision is enclosed for your information.

Sincerely,



William M. Dane  
Planning Engineer

Encl:

cc: Maintenance Engineer  
Division Engineer III, L. S. Hill  
Commissioner C. Hubert Cragg

December 5, 1963

City Clerk  
City of Norman  
Norman, Oklahoma

Dear Sirs:

The Oklahoma State Highway Commission in regular session December 2, 1963, Item 303 a, approved the following revision in the State Highway System.

Remove from the State Highway System a segment of old road designated as State Highway 9 beginning at its junction with US 77 in Norman (at the intersection of Alameda Street with Classen Boulevard and Porter Avenue) and extending easterly to its junction with the new location northeast of the Little River Reservoir Dam, a distance of 13.3 miles. This segment of old road will be transferred to Cleveland County or the City of Norman for further maintenance or abandonment.

Add State Highway 9 designation along US Highway 77, beginning at the intersection of Classen Boulevard with Alameda Street and Porter Avenue and extending southerly on Classen Boulevard to the junction with the new location, a distance of 2.6 miles.

Add to the State Highway System a segment of new road to be designated as State Highway 9, beginning at its junction with US Highway 77 in Norman and extending easterly to its junction with the old road northeast of the Little River Reservoir Dam, a distance of 13.6 miles.

The construction on this segment of new road has been completed as SAP Project 868 (9) (10) (11).

A copy of the commission minutes concerning this action and a sketch map indicating the location of this revision is enclosed for your information.

Sincerely,

William M. Dane  
Planning Engineer

Encl:

cc: Maintenance Engineer  
Division Engineer III, L. S. Hill  
Commissioner C. Hubert Cragg