

FOR PRESENTATION AT COMMISSION MEETING AUGUST 7, 1995

AGENDA ITEM NO.: 125

SUBJECT: State Highway System Revision -
Relocation of US 62 in City of
Lawton

COUNTY: Comanche

This item requests the relocation of US 62 from Cache Road to Rogers Lane between West 52nd Street and I-44 in the City of Lawton. Construction of the first segment of the new Rogers Lane facility is now complete and open to traffic. West 52nd Street will be used as a temporary tie to existing US 62 until the next phase of Rogers Lane between West 52nd Street and West 82nd Street is constructed (1996).

The relocation of US 62 onto Rogers Lane will provide a routing on a modern four-lane limited access facility and eliminate numerous traffic signals and congestion associated with the present highway on Cache Road.

The following actions are necessary to implement this system revision:

Add to the State Highway System a segment of new highway (Rogers Lane) to be designated US 62, beginning at West 52nd Street and extending eastward 4.00 miles to I-44.

Add US 62T designation to West 52nd Street, beginning at its junction with existing US 62 just north of Cache Road and extending northward .88 mile to the new construction at Rogers Lane. This temporary facility will be removed from the state system upon completion of the next phase of Rogers Lane construction. The Department will be responsible for maintenance during the duration of this temporary designation.

Add SH 7 designation to Sheridan Road, beginning at the present terminus of SH 7 at Cache Road and extending northward 1.04 miles to its junction with new US 62 at Rogers Lane. The temporary extension of Sheridan Road is required to reconnect SH 7 to the state system.

Remove from the State Highway System that portion of US 62, beginning at West 52nd Street and extending eastward 4.13 miles to I-44. This section of old US 62 will be transferred to the appropriate local jurisdiction for further maintenance. In accordance with state law, a Public Removal Hearing was held January 17, 1995.

The relocation of US 62 and the establishment of US 62T must be submitted to the American Association of State Highway and Transportation Officials (AASHTO) for approval.

These actions will become effective upon approval by the State Transportation Commission and concurrence by AASHTO. Signing of Rogers Lane will be initiated upon receipt of AASHTO approval.

The Department recommends approval of this item.

COMMISSION ACTION: APPROVED 8-7-95

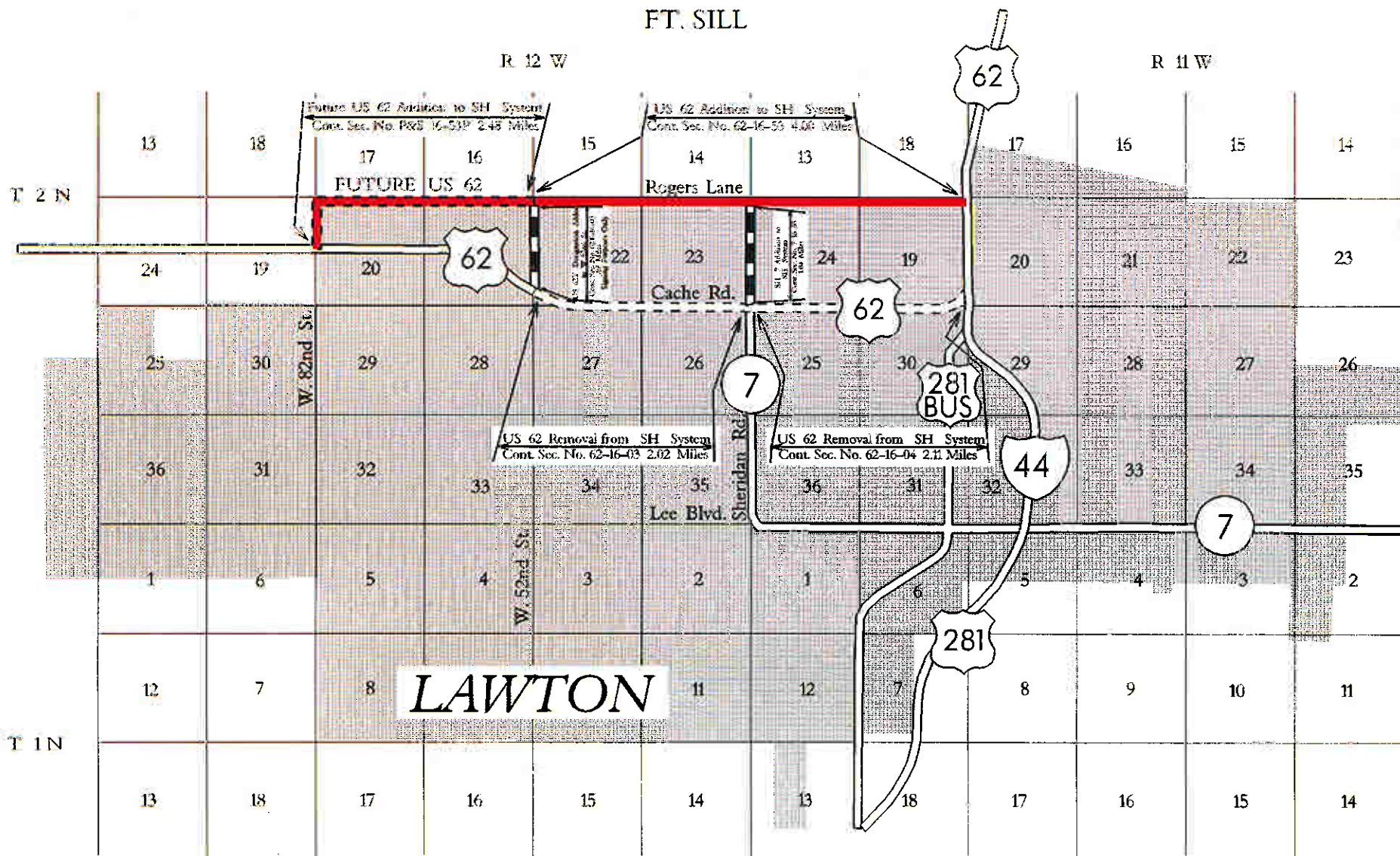

US 62 Relocation
 City of Lawton
 Comanche County
 MAM-7780 (01)(02)(03)
 July 10, 1995
 Systems Section

Note: US 62 T (Temporary) to be removed
 From SH System upon completion
 of construction Projects STP-016A(278)
 and STP-016B(279)

Approved August 7, 1995 Item No. 126
 OKLAHOMA STATE TRANSPORTATION COMMISSION
 Addition to SH System —————
 Removal from SH System
 Present SH System
 Temp. Addition to SH System



OKLAHOMA DEPARTMENT OF TRANSPORTATION

200 N. E. 21st Street
Oklahoma City, OK 73105-3204

August 10, 1995

Ms. Brenda Smith, City Clerk
City of Lawton
103 S.W. 4th Street
Lawton, Oklahoma 73501-4031

Dear Ms. Smith:

The Oklahoma State Transportation Commission in regular session August 7, 1995, Item 125, approved the relocation of US 62 in the City of Lawton. This revision to the State Highway System relocates US 62 onto the newly constructed section of Rogers Lane between West 52nd Street and I-44.

A copy of the Commission Minutes regarding this action and a sketch map indicating the location is enclosed for your information. Should you have any questions concerning this matter, please contact this office.

Sincerely,

A handwritten signature in cursive script, appearing to read "R. J. Driskill".

R. J. Driskill, P. E.
Planning Engineer

RJD:DRL/bc

Enclosures

c: David Golden, State Maintenance Manager
Bob Rose, Division Engineer, Division VII
Gib Gibson, Member, Transportation Commission

CERTIFICATION OF PUBLIC HEARING

ON

HIGHWAY PROJECT

I hereby certify that in accordance with Title 69, Section 503 of the Oklahoma State Statutes, a public hearing was scheduled at:

Time: 7:00 P.M., Tuesday, January 17, 1995

Place: Lawton Public Library
110 Southwest 4th Street
Lawton, Oklahoma

concerning a proposal to remove from the State Highway System, a portion of US 62 from Cache Road in Lawton beginning at West 52nd Street and extending eastward 4.0 miles to Interstate 44, Comanche County.

A representative from the City of Lawton read into the record the City's comments regarding the proposal. The City followed up their oral comments with a letter clarifying their position. A copy of the transcript including the City of Lawton's letter is attached.



R. J. Driskill, P. E.
Planning Engineer
Oklahoma Department of Transportation

OKLAHOMA DEPARTMENT OF TRANSPORTATION

DATE: November 13, 1995
TO: Bob Rose, Division Engineer, Division VII
FROM: Roger J. Driskill, Planning Engineer 
SUBJECT: AASHTO Approval of the Relocation of US 62
onto Rogers Lane in the City of Lawton

On October 28, 1995, the AASHTO Special Committee on US Route Numbering and the Standing Committee on Highways approved the relocation of US 62 onto Rogers Lane between West 52nd Street and I-44 in the City of Lawton. Please advise your sign crew to make the necessary changes in route marking.

Enclosed are copies of the Commission Minutes and AASHTO documents approving this action.

RJD:DRL/bc

Enclosures

c: David Golden, State Maintenance Manager

AMERICAN ASSOCIATION OF STATE HIGHWAY AND TRANSPORTATION OFFICIALS



AN APPLICATION
FROM THE STATE HIGHWAY OR TRANSPORTATION
DEPARTMENT OF

OKLAHOMA

FOR

- the Elimination of a U.S. (I) Route
- the Establishment of a U.S. (I) Route
- * the Establishment of a U.S. Bike Route
- the Relocation of U.S. (I) Route 62
- * the Establishment of a U.S. Bike Route
- the Extension of U.S. (I) Route
- the Establishment of an Alternate U.S. Route
- the Establishment of a Temporary U.S. Route
- ** the Recognition of a Business Route on U.S. (I) Route
- ** the Recognition of a By-pass Route on U.S. Route

BETWEEN

at Lawton and

The Following
State or States are
Involved:

Oklahoma

Date Received	8-29-95
Date application acknowledged	9-7-95
Date to Route Number Committee	10-27-95
Date considered by Executive Committee	10-28-95
Action of Executive Committee	Approved
Member Department Notified	11-3-95

(This block to be completed by AASHTO General Office.)

Date Submitted:

AUG 23 1995, 19

*Attach map to page 3. Obtain signatures, page 6. Other sections not applicable.

**A local vicinity map needed on Page 3. On Page 5 a short statement to the effect that there are no deficiencies on proposed routing, if true, will suffice. If there are deficiencies, they should be so indicated in accordance with Page 4 instructions.

SUBMIT SIX COPIES

Future US 62 in Lawton on
Rogers Lane

Programming items

ley recommended that the Commission approve and to program a project for modification of The present access ramp from I-35 to Dan-off-ramp. The City plans to four-lane Dan-a rapidly growing area, and to also provide rea to the east. The estimated construction y has agreed to provide the design engineering, matching funds for a Federal-aid project to eplace the existing separation structure with is action will allow the City to budget funds e design engineering.

nd Mr. Patton seconded: That the Commission tions in a) and b).

I vote:

AYES: Young, Stubbs, Patton, Allen, Allford, Carter, Diel, Swineford

NAYS:

ABSENT:

06672
ITEM 87. COMANCHE COUNTY. Mr. Bradley reviewed May 7, 1984 Commission action programming Rogers Lane in Lawton from I-44 west approximately 4.0 miles to 52nd Street. Included as a part of the engineering and local right-of-way acquisition effort is a connection with 52nd Street between the new Rogers Lane project and existing US 62 on Cache Road. This connection is necessary to tie in the new highway with existing US 62 upon completion of the new facility. The estimated cost of the Rogers Lane construction, as initially programmed, was \$8,000,000 to be financed with 75% Federal funds and 25% State funds. The estimated cost of the 52nd Street connection is \$2,000,000, of which \$1,500,000 will be federal funds.

Mr. Bradley recommended that the Commission program the 52nd Street connection as a part of the Rogers Lane (Future US 62) project, increasing the Department's share of the total project by approximately \$500,000.

Action: Mr. Carter moved and Mr. Swineford seconded: That the Commission approve the recommendation.

Motion carried by the following vote:

AYES: Young, Stubbs, Patton, Allen, Allford, Carter, Diel, Swineford

NAYS:

ABSENT:

ITEM 88. ADDITIONS TO THE LAKE ACCESS PROGRAM:

08108
a) MUSKOGEE COUNTY. Mr. Bradley recommended that the Commission approve a Lake Access Project to repair and resurface the Porum Landing access road beginning at SH 2 in Porum and extending west 7.2 miles to the Porum Landing Public Recreation Area on Eufaula Reservoir. The estimated cost is \$568,000 for base repair and surfacing with 1 1/2-inches asphaltic material.

FOR PRESENTATION - COMMISSION MEETING OF JUNE 3, 1986

AGENDA ITEM NO. 87

SUBJECT: Modification of Project Limits to include
the 52nd Street Connection in Lawton

LOCATION: Comanche Co. - US 62 (Future)

At the Commission Meeting of May 7, 1984, a programming Item was approved adding the construction of Rogers Lane in Lawton, from I-44 west approximately 4.0 miles to 52nd Street, to the construction program. Rogers Lane runs along the south boundary of Ft. Sill and is being designated in cooperation with U. S. Army officials of Ft. Sill. The City of Lawton is providing the engineering, with the right-of-way for the project being provided by the City and the Military.

Also included as part of the engineering and local right-of-way acquisition effort is a connection with 52nd Street between the new Rogers Lane project and existing US 62 on Cache Road. This connection will be necessary to tie in the new highway with existing US 62 upon completion of the new facility.

The estimate for the Rogers Lane construction, as initially programmed, was \$8,000,000; 75% Federal Funds, 25% State Funds. The estimated cost of the 52nd Street connection is \$2,000,000, with \$1,500,000 being federal funds.

Modification of Project Limits in Lawton
Page 2

The Department is now requesting approval for this 52nd Street connection to be a part of the Rogers Lane (Future US 62) project. This will increase the Department's share of the total project cost by approximately \$500,000.

Approval is Recommended.

<u>TYPE WORK</u>	<u>JOB/PIECE #</u>	<u>PROJECT #</u>
PE	06672(001)	NONE
RW	06672(002)	NONE
UTIL	06672(003)	NONE
RECONSTRUCTION	06672(004)	AT-7641(010)

FT. SILL

ROGERS LANE AS ORIGINALLY PROGRAMED

LAWTON
OP. 80,054
4.1

52nd ST. CONNECTION

CAMERON
STATE
UNIV.

NORTHERN

LAWTON

Lowton S.

LAWTON
MUNICIPAL
AIRPORT

LAWRENCE

COMANCHE COUNTY

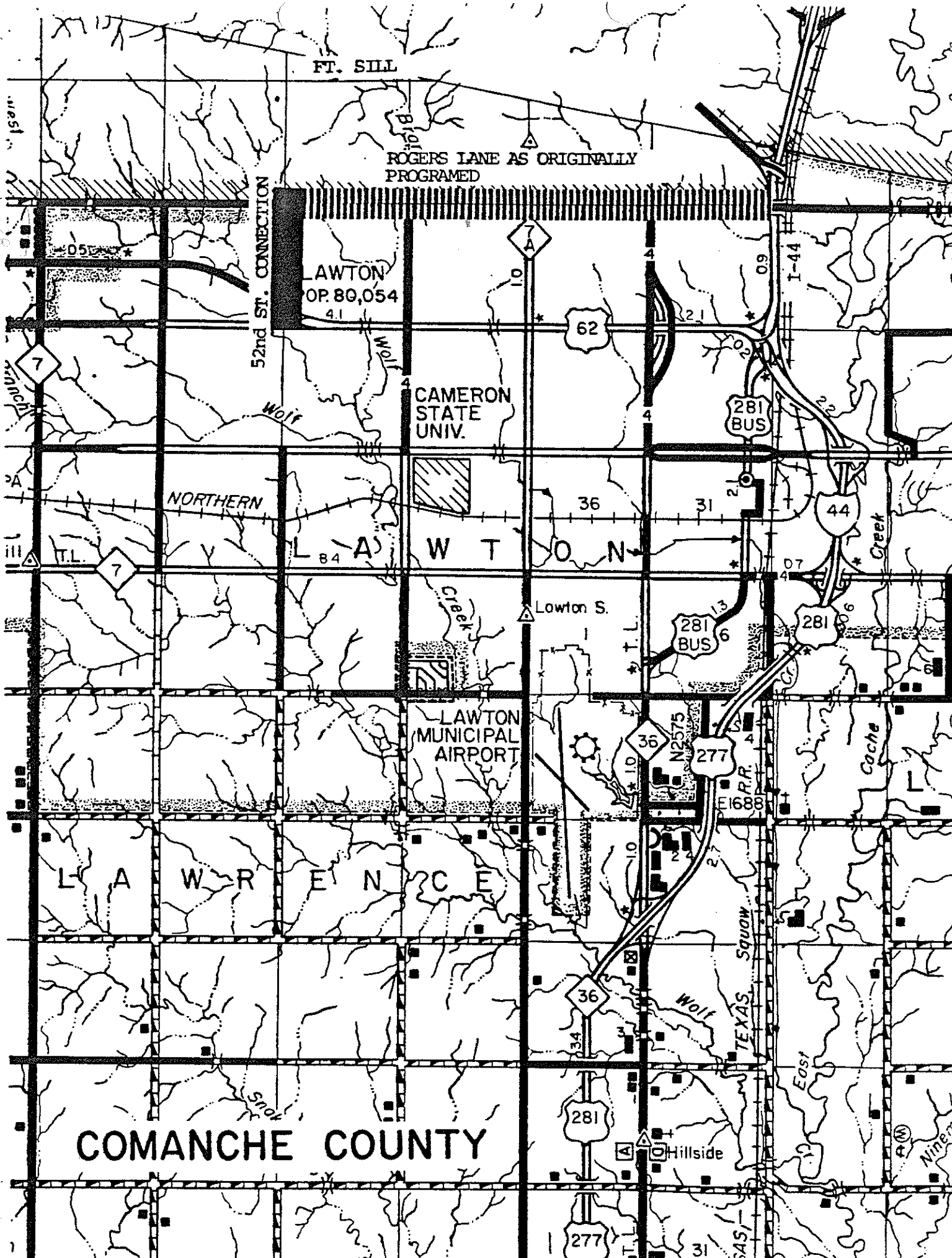

FOR PRESENTATION AT COMMISSION MEETING OF MAY 7, 1984

AGENDA ITEM NO. 72
SUBJECT: New Programming
LOCATION: Statewide

With the increase in State highway construction funding resulting from the Department's share of the 2.42¢ State Fuel Tax increase and the additional federal funding generated by the 5¢ Federal Fuel Tax increase, we anticipate that during FY 85, 86 and 87 there will be a total of approximately \$160,700,000 available to the Transportation Commission for programming new State highway construction projects. This does not include funding of Interstate Construction, Interstate Rehabilitation, Special Bridge Replacement or Miscellaneous Safety Categories. These programs, while subject to programming approval by the Commission will be handled apart from the basic State highway construction program.

In order that we may begin to schedule the various steps necessary to incorporate new projects into the continuing pre-letting processes, the Department is now requesting Commission approval of selected, critical projects at this time. We will continue our review of the improvement needs in each Commissioner District and to work with the Commission to fully develop the construction program throughout the State, utilizing all available funding, including the special category projects.

The attached project listing contains the Department's recommendations for construction program additions at this time.

APPROVAL IS RECOMMENDED:

08171

b) OKLAHOMA COUNTY. Mr. Bradley recommended that the Commission approve a request from the City of Edmond to program a project for modification of the Danforth/I-35 Interchange. The present access ramp from I-35 to Danforth is a single, northbound off-ramp. The City plans to four-lane Danforth from I-35 west to serve a rapidly growing area, and to also provide access into the Lake Arcadia area to the east. The estimated construction cost is \$1.4 million. The City has agreed to provide the design engineering, right-of-way, and the required matching funds for a Federal-aid project to construct the interchange and replace the existing separation structure with a new four-lane structure. This action will allow the City to budget funds in the next fiscal year for the design engineering.

Action: Mr. Swineford moved and Mr. Patton seconded: That the Commission approve the recommendations in a) and b).

Motion carried by the following vote:

AYES: Young, Stubbs, Patton, Allen, Allford, Carter, Diel, Swineford

NAYS:

ABSENT:

06672

ITEM 87. COMANCHE COUNTY. Mr. Bradley reviewed May 7, 1984 Commission action programming Rogers Lane in Lawton from I-44 west approximately 4.0 miles to 52nd Street. Included as a part of the engineering and local right-of-way acquisition effort is a connection with 52nd Street between the new Rogers Lane project and existing US 62 on Cache Road. This connection is necessary to tie in the new highway with existing US 62 upon completion of the new facility. The estimated cost of the Rogers Lane construction, as initially programmed, was \$8,000,000 to be financed with 75% Federal funds and 25% State funds. The estimated cost of the 52nd Street connection is \$2,000,000, of which \$1,500,000 will be federal funds.

Mr. Bradley recommended that the Commission program the 52nd Street connection as a part of the Rogers Lane (Future US 62) project, increasing the Department's share of the total project by approximately \$500,000.

Action: Mr. Carter moved and Mr. Swineford seconded: That the Commission approve the recommendation.

Motion carried by the following vote:

AYES: Young, Stubbs, Patton, Allen, Allford, Carter, Diel, Swineford

NAYS:

ABSENT:

ITEM 88. ADDITIONS TO THE LAKE ACCESS PROGRAM:

08108

a) MUSKOGEE COUNTY. Mr. Bradley recommended that the Commission approve a Lake Access Project to repair and resurface the Porum Landing access road beginning at SH 2 in Porum and extending west 7.2 miles to the Porum Landing Public Recreation Area on Eufaula Reservoir. The estimated cost is \$568,000 for base repair and surfacing with 1 1/2-inches asphaltic material.

5/10/71

79163

Item E-115. Oklahoma County Cont'd

Mr. Brooks recommended that the Commission authorize the Department to negotiate for the purchase, in fee simple less mineral rights, of the 33.72 acres of land located in the NW $\frac{1}{4}$ of Section 27, T12N, R3W, Oklahoma County, in the amount of \$590,100.

Action: Mr. Gragg moved and Mr. Kerr seconded: That the Commission approve the recommendation.

Motion carried unanimously.

ITEM E-115-a. ROGERS-WAGONER COUNTIES, AND COMANCHE COUNTY. Mr. Brooks said a project on SH 33 from just east of the Will Rogers Turnpike east 6.5 miles to the Verdigris River, estimated cost \$2,686,000, is scheduled to be let in March 1972. Right of way and utility relocation costs are estimated at \$632,000 of which approximately \$42,000 would normally be a local responsibility. The Department is of the opinion that since the project lies on the county line the project would not greatly benefit any towns in either county, and since SH 33 will likely be designated a trunk highway with controlled access when the Trunk System is revised, that the local right of way responsibility should be borne by the State.

Mr. Brooks recommended that the Commission authorize state funds, on a state-wide basis, in the amount of \$42,471 to offset the local underwriters obligation on this project.

COMANCHE COUNTY. Mr. Brooks recommended that Commission Policy be waived and that the acquisition of right of way for the interchange construction at Rogers Lane and US 62, 277 in Lawton be declared of statewide importance and that the entire cost of right of way and utilities be assumed by the State Highway Department. This recommendation was made because this intersection is the only one on this route between Oklahoma City and Wichita Falls not up to full freeway standards, construction will eliminate a death trap, and this route provides the primary access from all parts of the Nation to Ft. Sill Military Reservation.

Action: Mr. Gragg moved and Mr. Swon seconded: That the Commission approve the recommendation (funds to come from Commissioner District funds).

Motion carried unanimously.

ITEMS PRESENTED BY THE TRAFFIC ENGINEER - Mr. Hixon

ITEM 116. SPEED ZONES. Mr. Hixon recommended that the Commission approve establishing the following speed zones in accordance with current Commission policy. Speed studies were made in these cities and the respective parties have concurred in the recommendations and will be consulted prior to sign erection:

A. BECKHAM COUNTY - Elk City (City Concurrence)

1. Along SH 6 (Main Street)

- a. 55 MPH - From a point 0.2 mile south of the I-40 interchange, north to a point 0.3 mile south of 13th St. (presently not zoned) 0.75 mile.

Jan 69

ITEM 33. COMANCHE COUNTY. Mr. Noblitt said the Lawton Area Regional Transportation Study recommends a freeway along Rogers Lane at Lawton. The Department and Commissioner recently met with the Commanding General at Fort Sill for discussion, and he indicated an unwillingness to recommend approval of the Lawton Study until right of way requirements and operational features of the freeway could be shown.

Mr. Noblitt recommended that the Commission authorize the Department to conduct the necessary surveys for preparation of right of way and functional plans for the freeway along Rogers Lane from US 62-277 westerly to US 62 west of Lawton, with Department forces.

Action: Mr. West moved and Mr. Keating seconded: That the Commission approve the recommendation.

Motion carried unanimously.

Feb 69

ITEM E-33. GRADY COUNTY. Mr. Keating moved and Mr. West seconded: That when and if the proposed new industrial site is developed at the northwest corner of Chickasha, that the department be authorized to make whatever changes are necessary in the construction project on US 62, Chickasha north, to provide proper access from the right of way.

Motion carried unanimously.

ITEM E-33-a. GENERAL. The Commission requested the Acting Director to make a technical study of the status of engineering contracts, and to evaluate the Department's capabilities in view of the entire objective of the construction program; and if Commission action is necessary before the March 7 special meeting or the March 17 regular meeting, a special session will be called.

In the investigation of methods of selecting engineering consultants in other states and the Corps of Engineers, Commissioners Irish and West were appointed to act as a subcommittee. Necessary policy revisions are to be presented to the Commission for consideration.

FARM TO MARKET ENGINEER - Mr. Johnston

ITEM 34. COUNTY FAS PROGRAM. Mr. Johnston recommended that the Commission approve the following additions to the County FAS Program as recommended by Resolution of the Boards of County Commissioners involved:

(a) GRADY COUNTY - 0.01 mile bridge 0.5 mile east and 2 miles south of Verden. Estimated total cost \$19,000.

(b) KINGFISHER COUNTY - 3.0 miles overlay existing surface from 5 miles east and 6 miles south of Hennessey, south. Estimated total cost \$35,000.

3.0 miles reconstruct existing asphalt base and surface from Loyal, west. Estimated total cost \$36,000.