

FOR PRESENTATION AT COMMISSION MEETING OF FEBRUARY 4, 1991

AGENDA ITEM NO. : 20
SUBJECT: State Highway System Revision -
Relocation of US 62-75 South
of Okmulgee
COUNTY: Okmulgee

This item is necessitated by the construction of US 62-75 (parallel southbound lanes) on new alignment south of Okmulgee across the Burlington Northern Railroad. Construction Project MABRF-53(141).

Add to the State Highway System a segment of new highway to be designated US 62-75, beginning at a tie with the existing facility in Section 29, T13N, R13E and extending northward 1.68 miles across the Burlington Northern Railroad to a connection with present US 62-75 at the south edge of Okmulgee.

Remove from the State Highway System 1.76 miles of old highway (previous offset southbound lanes) replaced by the new facility. This segment of old US 62-75 will be transferred to the appropriate local jurisdiction for further maintenance or abandonment. A Public Removal Hearing was held January 10, 1991, in accordance with state law.

This relocation will become effective upon approval by the State Transportation Commission.

The Department recommends approval of this item.

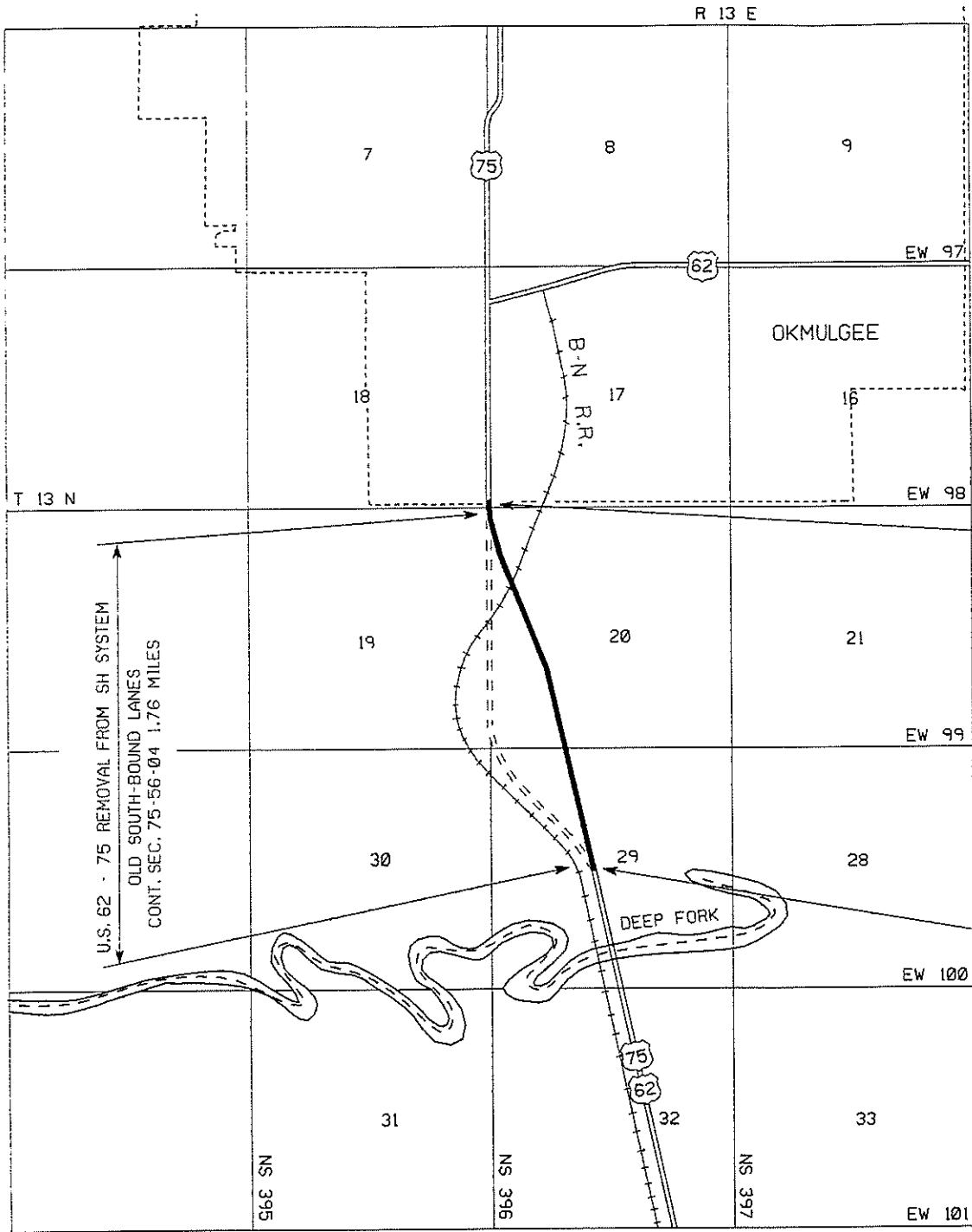

RELOCATION U.S. 62 - 75
 SOUTH OF OKMULGEE AT B-N R.R.
 OKMULGEE COUNTY
 PROJECT MABRF-53(141)
 DECEMBER 19, 1990
 SYSTEMS SECTION

APPROVED 2/4/91 ITEM NO. 20
 OKLAHOMA STATE TRANSPORTATION COMMISSION
 APPROVED ADDITION TO SH SYSTEM
 APPROVED REMOVAL FROM SH SYSTEM
 PRESENT SH SYSTEM

