

AGENDA ITEM: 13(a)

US Highways 62 and 81 and State Highway 9, Grady County

Transfer from the State Highway System a segment of old road designated as US Highway 62 and State Highway 9, beginning at its junction with the new road in the northwest $\frac{1}{4}$, Section 19, T 7N, R 7W, and extending easterly to its junction with US Highway 81, a distance of 2.0 miles.

Transfer from the State Highway System a segment of old road designated as US Highway 62 and 81 and State Highway 9, beginning at its junction with the new road in the northwest corner of Chickasha and extending northerly to its junction, a distance of 0.5 mile.

Transfer from the State Highway System a segment of old road designated as US Highway 81, beginning at its junction with US Highway 62 and State Highway 9 northwest of Chickasha and extending northerly to its junction with the new road, a distance of 1.9 miles.

These segments of old road will be transferred to the local jurisdiction of Grady County or the City of Chickasha for further maintenance or abandonment.

Add to the State Highway System a segment of new road to be designated as US Highway 62 and State Highway 9, beginning at its junction with the old road in the northwest $\frac{1}{4}$ of Section 19, T 7N, R 7W and extending southeasterly to its junction with the new location of US Highway 81, a distance of 1.3 miles.

Add to the State Highway System a segment of new road to be designated as US Highway 62 and 81 and State Highway 9, beginning at its junction with the new location and extending southeasterly to its junction with the old road in the northwest corner of Chickasha, a distance of 0.8 mile.

Add to the State Highway System a segment of new road to be designated as US Highway 81 beginning at its junction with the new location of US Highway 62 and extending northerly to its junction with the old road, a distance of 2.0 miles.

AGENDA ITEM: 13(a) (Continued)

These revisions to the State Highway System have been constructed as Federal-aid Projects F-U-162(31)(32), F-162(37)(38), and F-203(15)(16).

ACTION: Approved February 7, 1972

R 7 W

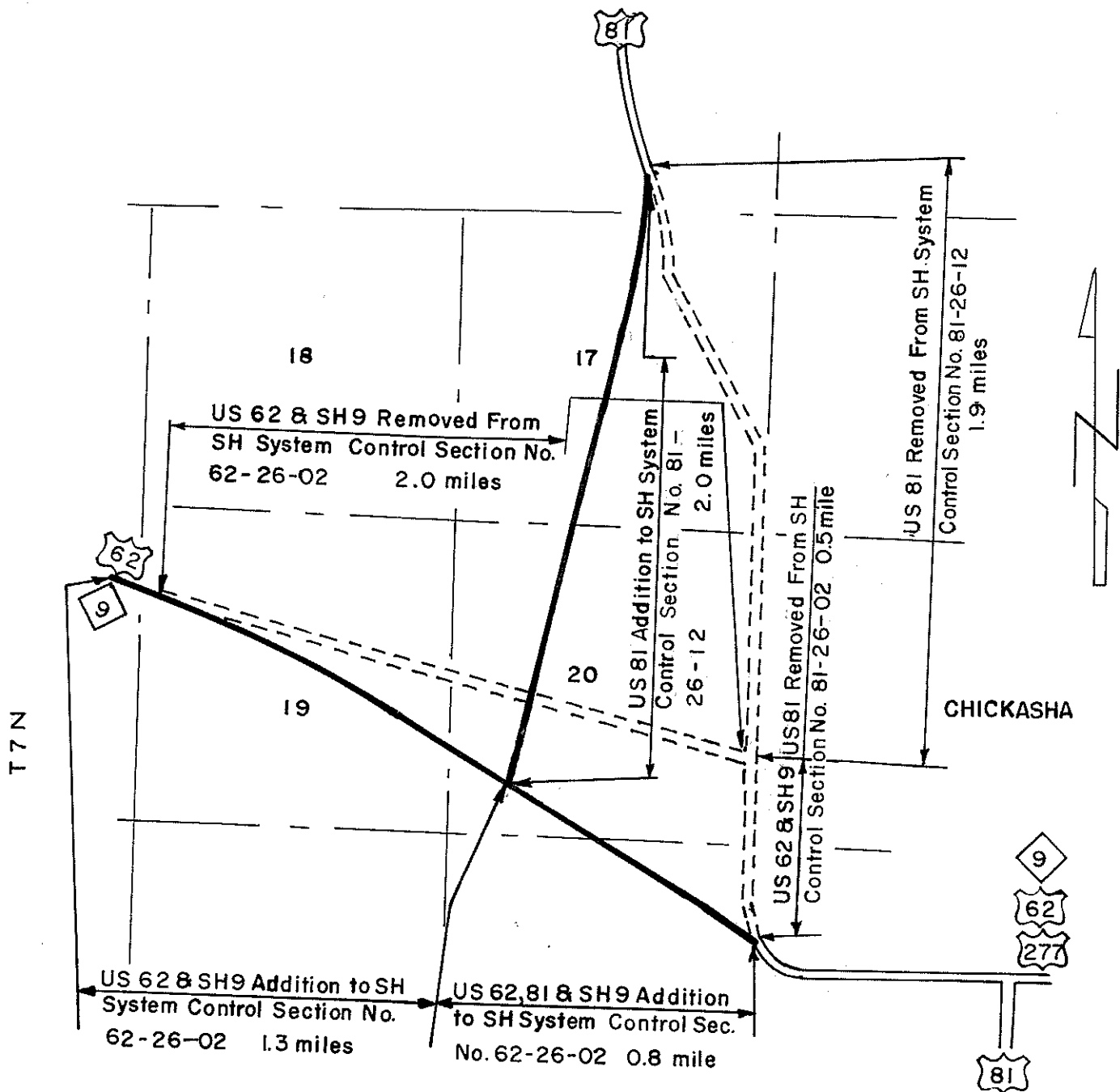

Approved February 7, 1972 Item 13(a)
 Rescinded January 4, 1971 Item 2(c)
 Approved by AASHO November 7, 1970
 Approved JUNE 1 1970 Item 111 D

US 81, 62 & S.H.9 Relocation
 NW of Chickasha

OKLAHOMA STATE HIGHWAY COMMISSION

Grady County
 November 3, 1969

Approved Addition to S.H System **————**
 Approved Deletion from SH System **-----**
 Present SH System **=====**

FA.P Proj.No. F-U-162 (31)(32)
 F-132(37)(38) F- 203 (15)(16)

AGENDA ITEM: 111(d).

US Highways 62 and 81 and State Highway 9, Grady County.

Transfer from the State Highway System a segment of old road designated as US Highway 62 and State Highway 9 beginning at its junction with the new road in the NW $\frac{1}{4}$, Section 19, T7N, R7W, and extending easterly to its junction with US Highway 81, a distance of 2.0 miles.

Transfer from the State Highway System a segment of old road designated as US Highway 62 and 81 and State Highway 9, beginning at its junction with the new road in the northwest corner of Chickasha and extending northerly to its junction, a distance of 0.5 mile.

Transfer from the State Highway System a segment of old road designated as US Highway 81 beginning at its junction with US Highway 62 and State Highway 9 northwest of Chickasha and extending northerly to its junction with the new road, a distance of 1.9 miles.

These segments of old will be transferred to the local jurisdiction of Grady County or the City of Chickasha for further maintenance or abandonment.

Add to the State Highway System a segment of new road to be designated as US Highway 62 and State Highway 9 beginning at its junction with the old road in the NW $\frac{1}{4}$ of Section of 19, T7N, R7W and extending southeasterly to its junction with the new location of US Highway 81, a distance of 1.3 miles.

Add to the State Highway System a segment of new road to be designated as US Highway 62 and 81 and State Highway 9 beginning at its junction with the new location and extending southeasterly to its junction with the old road in the northwest corner of Chickasha, a distance of 0.8 mile.

Add to the State Highway System a segment of new road to be designated as US Highway 81 beginning at its junction with the new location of US Highway 62 and extending northerly to its junction with the old road, a distance of 2.0 miles.

These revisions to the State Highway System will become effective upon the completion of construction of Federal-aid Projects F-U-162(31)(32) F-162(37)(38) and F-203(15)(16).

ACTION: Approved June 1, 1970.

February 9, 1972

C
O
P
Y
Board of County Commissioners
Grady County Courthouse
Chickasha, Oklahoma 73018

Gentlemen:

The Oklahoma State Highway Commission in regular session February 7, 1972, Item 13(a), approved the following revision in the State Highway System:

The relocation of US Highways 62 and 81 and State Highway 9 northwest of Chickasha.

A copy of the Commission Minutes concerning this action and a sketch map indicating the location of this revision are enclosed for your information.

Sincerely,

Monty C. Murphy

Monty C. Murphy, P.E.
Planning Engineer

MCM:kdg

Enclosure

cc: Maintenance Engineer, Mr. J. M. Copeland
Division Engineer, Mr. Kenneth S. Paul
Commissioner, Mr. C. D. Payne

February 9, 1972

C
O
P
Y

City Clerk
City of Chickasha
Chickasha, Oklahoma 73018

Dear Sir:

The Oklahoma State Highway Commission in regular session February 7, 1972, Item 13(a), approved the following revision in the State Highway System:

The relocation of US Highways 62 and 81 and State Highway 9 northwest of Chickasha.

A copy of the Commission Minutes concerning this action and a sketch map indicating the location of this revision are enclosed for your information.

Sincerely,

Monty C. Murphy

Monty C. Murphy, P.E.
Planning Engineer

MCM:kdg

Enclosure

cc: Maintenance Engineer, Mr. J. M. Copeland
Division Engineer, Mr. Kenneth S. Paul
Commissioner, Mr. C. D. Payne

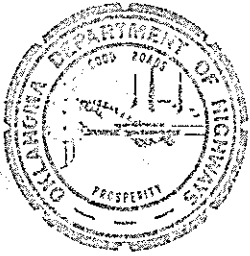

STATE OF OKLAHOMA
DEPARTMENT OF
HIGHWAYS
JIM THORPE BUILDING
OKLAHOMA CITY, OKLAHOMA 73105

June 2, 1970

Board of County Commissioners
Grady County Courthouse
Chickasha, Oklahoma 73018

Gentlemen:

The Oklahoma State Highway Commission in regular session June 1, 1970, Item 111(d), approved the following revision in the State Highway System.

The relocation of US Highways 62 and 81, and State Highway 9 northwest of Chickasha.

A copy of the Commission Minutes concerning this action and a Sketch Map indicating the location of this revision are enclosed for your information.

Very truly yours,

Monty C. Murphy, P. E.
Planning Engineer

MCM:hs

Encs.

cc: J. M. Copeland
Kenneth Paul
Commissioner Thomas

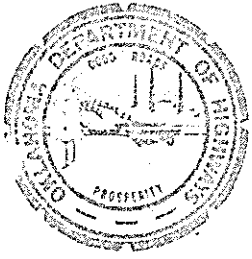

STATE OF OKLAHOMA
DEPARTMENT OF
HIGHWAYS
JIM THORPE BUILDING
OKLAHOMA CITY, OKLAHOMA 73105

June 2, 1970

City Clerk
City of Chickasha
Chickasha, Oklahoma 73018.

Dear Sir:

The Oklahoma State Highway Commission in regular session June 1, 1970, Item 111(d), approved the following revision in the State Highway System.

The relocation of US Highways 62 and 81, and State Highway 9 northwest of Chickasha.

A copy of the Commission Minutes concerning this action and a Sketch Map indicating the location of this revision are enclosed for your information.

Very truly yours,

Monty C. Murphy, P. E.
Planning Engineer

MCM:hs

Encs.

cc: J. M. Copeland
Kenneth Paul
Commissioner Thomas

December 3, 1970

Kenneth Paal, Division Engineer

Monty Murphy, Planning Engineer

AASBO Approval of State Highway Revisions

On November 7, 1970 the Executive Committee of the American Association of State Highway Officials approved the following U.S. Highway revisions.

1. U.S. 62 Lawton to Cache, and
2. U.S. 62 & 81 northwest of Chickasha.

Attached are the letter of approval and the title sheets of the applications to AASBO regarding the above revisions.



Monty C. Murphy, P. E.
Planning Engineer

MCW:dms BWH

Attachments

cc: Mr. J. H. Copeland
Mr. Dwight Nixon

AMERICAN ASSOCIATION OF STATE HIGHWAY OFFICIALS



PRESIDENT
W. J. Burmeister
State Highway Engineer
Division of Highways
4802 Sheboygan Ave.
Madison, Wisconsin 53702

EXECUTIVE DIRECTOR
A. E. Johnson
341 Nat'l Press Bldg.
Washington, D. C. 20004
Telephone 628-2438

November 19, 1970

Mr. Truman Branscum
Director
Oklahoma Department of Highways
Jim Thorpe Building
Oklahoma City, Oklahoma 73105

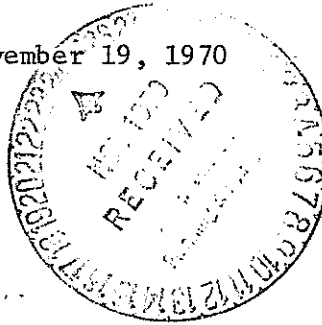

Dear Mr. Branscum:

Your Department submitted various applications for revisions to the U. S. Numbered System, which were considered by the U. S. Route Numbering Committee at its meeting on November 6, and their action concurred in by the Executive Committee.

All applications were approved, with the exception of the establishment of U. S. Route 377. This application was denied, with the suggestion that as major segments of this location are constructed to functional adequacy, it again be submitted to the Route Numbering Committee for consideration.

Copies of your applications are being returned herewith.

Yours very truly

A. E. Johnson
Executive Director

H. J. Rhodes
Assistant to the Director



AEJ:HJR:ja

AMERICAN ASSOCIATION OF STATE HIGHWAY OFFICIALS



AN APPLICATION

FROM THE STATE HIGHWAY DEPARTMENT OF
Oklahoma



FOR

- the Elimination of a U.S. Route
- the Establishment of a U.S. Route
- the Relocation of U.S. Route 62 & 81
- the Extension of U.S. Route
- the Establishment of an Alternate U.S. Route
- the Establishment of a Temporary U.S. Route
- * the Recognition of a Business Route on U.S. Route
- * the Recognition of a By-pass Route on U.S. Route

BETWEEN

Chickasha northwest
and

The Following
State or States are
Involved:

(In case more than one State is involved, an application must be submitted by each State for that portion within the respective State.)

.....
.....
.....
.....
.....
.....

Date Received	<u>9-2-70</u>
Date application acknowledged	<u>9-2-70</u>
Date to Route Number Committee	<u>9-30-70</u>
Date considered by Executive Committee	<u>11-7-70</u>
Action of Executive Committee	<u>Approved</u>
Member Department Notified	<u>11-19-70</u>

(This block to be completed by AASHO General Office.)

Date Submitted:

SEP 1 1970, 19.....

* A local vicinity map needed on Page 3. On Page 5 a short statement to the effect that there are no deficiencies on proposed routing, if true, will suffice. If there are deficiencies, they should be so indicated in accordance with Page 4 instructions.

SUBMIT SIX COPIES