

AGENDA ITEM: 111(c)

US Highway 62 Relocation - Comanche County

Transfer to the local jurisdiction a segment of road designated as US Highway 62 beginning at its junction with State Highway 115 at Cache and extending easterly to its junction with the new location in Lawton, a distance of 10.6 miles. This segment of road will be transferred to the jurisdiction of Comanche County or the City of Lawton for further maintenance or abandonment.

Add US Highway 62 designation on State Highway 115 beginning at its junction at the south edge of Cache and extending north to its junction at the north edge of Cache, a distance of 1.1 miles.

Add to the State Highway System a segment of new road to be designated as US Highway 62, beginning at its junction with State Highway 115 at the north edge of Cache and extending easterly to its junction with the old road in Lawton, a distance of 10.9 miles.

This revision to the State Highway System will become effective upon the completion of construction of FAP Projects U-215(15), F-215(23) and F-215(25).

ACTION: Approved June 1, 1970.

R 13 W

R 12 W

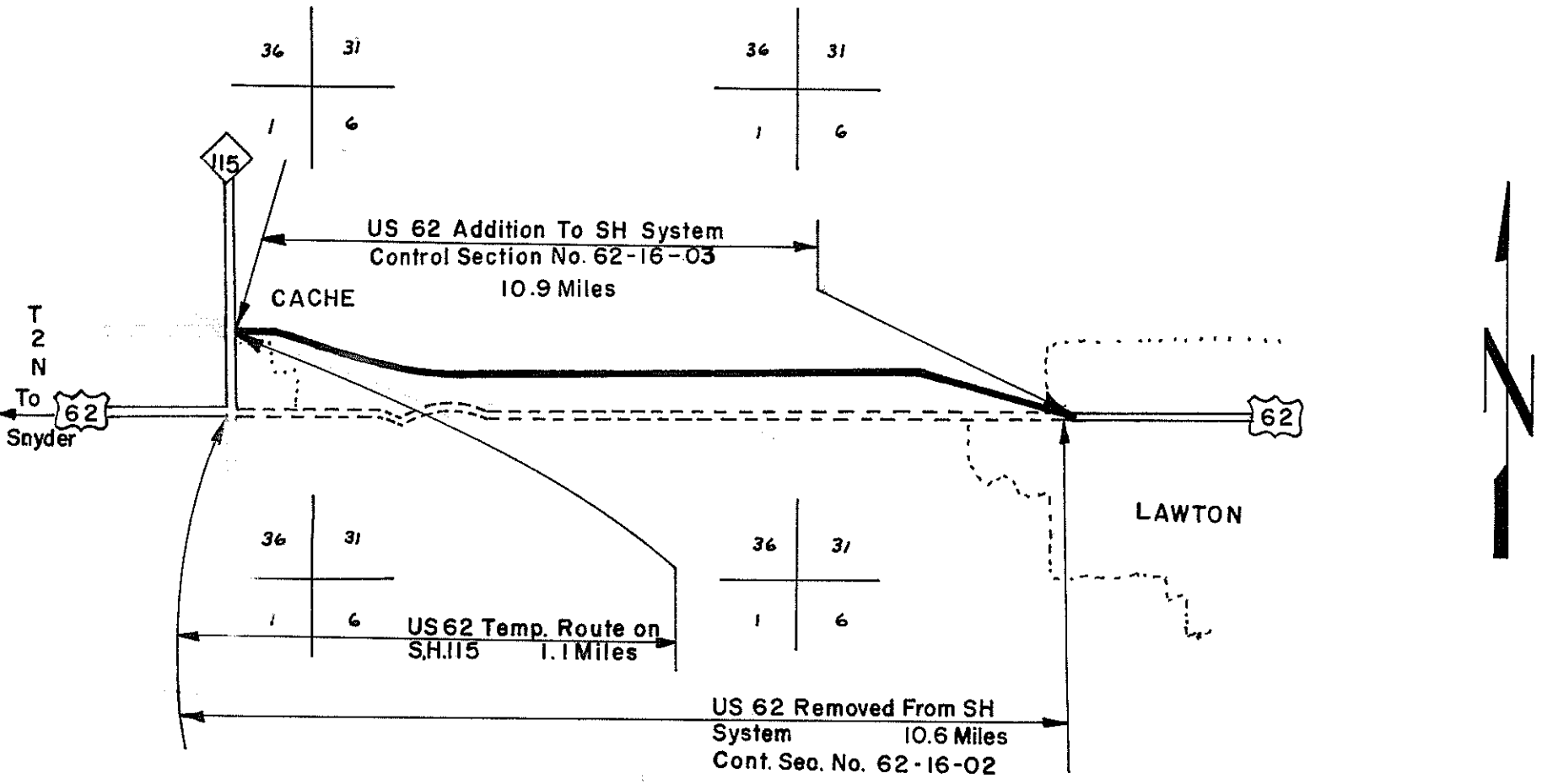

US 62 Relocation
 Lawton to Cache
 Comanche County
 November 14, 1969

Proj. No. 215 (15)(22)
 (23)(24)(25)

Approved by AASHO November 7, 1970
 Approved JUNE 1 1970 Item III C

OKLAHOMA STATE HIGHWAY COMMISSION

Approved Addition To SH System 

Approved Deletion From SH System 

Present SH System 

CERTIFICATION OF PUBLIC HEARING

REGARDING

STATE HIGHWAY SYSTEM

I hereby certify that in accordance with Section 503 of Title 69 - O.S. Supp. 1968, a public hearing was held at:

1:30 PM, Friday, May 8, 1970, in the City Council
Chamber, City Hall, Lawton, Comanche County, Oklahoma,

on the proposed transfer from the State Highway System to local jurisdiction:

A segment of US 62, Comanche County.

A copy of transcript of said hearing is submitted.



V. O. Bradley
Assistant Director
Planning and Research
Oklahoma Highway Department

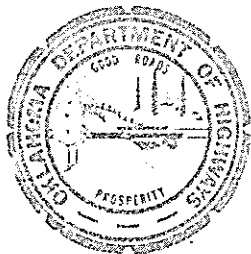

STATE OF OKLAHOMA
DEPARTMENT OF
HIGHWAYS
JIM THORPE BUILDING
OKLAHOMA CITY OKLAHOMA 73105

June 2, 1970

Board of County Commissioners
Comanche County Courthouse
Lawton, Oklahoma 73501

Gentlemen:

The Oklahoma State Highway Commission in regular session June 1, 1970, Item 111(c), approved the following revision in the State Highway System.

The relocation of US Highway 62 between Lawton and Cache.

A copy of the Commission Minutes concerning this action and a Sketch Map indicating the location of this revision are enclosed for your information.

Very truly yours,

Monty C. Murphy, P. E.
Planning Engineer

MCM:hs

Encs.

cc: J. M. Copeland
Kenneth Paul
Commissioner Thomas

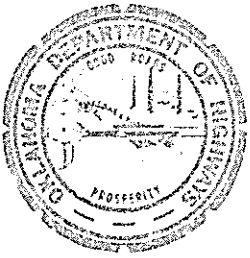

STATE OF OKLAHOMA
DEPARTMENT OF

HIGHWAYS

JIM THORPE BUILDING
OKLAHOMA CITY, OKLAHOMA 73105

June 2, 1970

City Clerk
City of Lawton
Lawton, Oklahoma 73501

Dear Sir:

The Oklahoma State Highway Commission in regular session June 1, 1970, Item 111(c), approved the following revision in the State Highway System.

The relocation of US Highway 62 between Lawton and Cache.

A copy of the Commission Minutes concerning this action and a Sketch Map indicating the location of this revision are enclosed for your information.

Very truly yours,

Monty C. Murphy, P. E.
Planning Engineer

MCM:hs
Encs.

cc: J. M. Copeland
Kenneth Paul
Commissioner Thomas

Open to Traveler
12-22-70

STATE HIGHWAY COMMISSION

CHAIRMAN - J. HARPER THOMAS, VICE CHAIRMAN - G. NAT. IRISH, SECRETARY - J. A. RICHARDSON, MEMBERS - COOPER WEST, VIRGIL JUMPER, JUDSON S. WOODRUFF, WILLIAM H. BELL, LEON COOK - - HIGHWAY DIRECTOR - TRUMAN BRANSCUM



STATE OF OKLAHOMA
DEPARTMENT OF
HIGHWAYS
JIM THORPE BUILDING
OKLAHOMA CITY OKLAHOMA 73105

June 2, 1970

City Clerk
City of Cache
Cache, Oklahoma 73527

Dear Sir:

The Oklahoma State Highway Commission in regular session June 1, 1970, Item 111(c), approved the following revision in the State Highway System.

The relocation of US Highway 62 between Lawton and Cache.

A copy of the Commission Minutes concerning this action and a Sketch Map indicating the location of this revision are enclosed for your information.

Very truly yours,

Monty C. Murphy, P. E.
Planning Engineer

MCM:hs
Encs.

cc: J. M. Copeland
Kenneth Paul
Commissioner Thomas

December 3, 1970

Kenneth Paul, Division Engineer

Monty Murphy, Planning Engineer

AASHTO Approval of State Highway Revisions

On November 7, 1970 the Executive Committee of the American Association of State Highway Officials approved the following U.S. Highway revisions.

1. U.S. 62 Iowton to Cache, and
2. U.S. 62 & 81 northwest of Chickasha.

Attached are the letter of approval and the title sheets of the applications to AASHTO regarding the above revisions.



Monty C. Murphy, P. E.
Planning Engineer

RCM:dms BNS

Attachments

cc: Mr. J. M. Copeland
Mr. Dwight Nixon

AMERICAN ASSOCIATION OF STATE HIGHWAY OFFICIALS



PRESIDENT
W. J. Burmeister
State Highway Engineer
Division of Highways
4802 Sheboygan Ave.
Madison, Wisconsin 53702

EXECUTIVE DIRECTOR
A. E. Johnson
341 Nat'l Press Bldg.
Washington, D. C. 20004
Telephone 628-2438

November 19, 1970

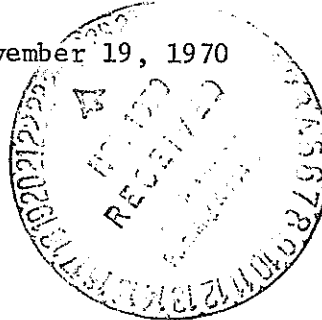

Mr. Truman Branscum
Director
Oklahoma Department of Highways
Jim Thorpe Building
Oklahoma City, Oklahoma 73105

Dear Mr. Branscum:

Your Department submitted various applications for revisions to the U. S. Numbered System, which were considered by the U. S. Route Numbering Committee at its meeting on November 6, and their action concurred in by the Executive Committee.

All applications were approved, with the exception of the establishment of U. S. Route 377. This application was denied, with the suggestion that as major segments of this location are constructed to functional adequacy, it again be submitted to the Route Numbering Committee for consideration.

Copies of your applications are being returned herewith.

Yours very truly

A. E. Johnson
Executive Director

[Handwritten Signature]
H. J. Rhodes
Assistant to the Director



AEJ:HJR:ja

AMERICAN ASSOCIATION OF STATE HIGHWAY OFFICIALS



AN APPLICATION
FROM THE STATE HIGHWAY DEPARTMENT OF
OKLAHOMA



FOR

- the Elimination of a U.S. Route
- the Establishment of a U.S. Route
- the Relocation of U.S. Route 62.....
- the Extension of U.S. Route
- the Establishment of an Alternate U.S. Route
- the Establishment of a Temporary U.S. Route
- * the Recognition of a Business Route on U.S. Route
- * the Recognition of a By-pass Route on U.S. Route

BETWEEN

Cache and Lawton

The Following
State or States are
Involved:

(In case more than one State is involved, an application must be submitted by each State for that portion within the respective State.)

.....
.....
.....
.....
.....
.....

Date Received	<i>9-2-70</i>
Date application acknowledged	<i>9-2-70</i>
Date to Route Number Committee	<i>9-30-70</i>
Date considered by Executive Committee	<i>11-2-70</i>
Action of Executive Committee	<i>Approved</i>
Member Department Notified	<i>11-19-70</i>

(This block to be completed by AASHO General Office.)

Date Submitted:

SEP 1 1970, 19.....

* A local vicinity map needed on Page 3. On Page 5 a short statement to the effect that there are no deficiencies on proposed routing, if true, will suffice. If there are deficiencies, they should be so indicated in accordance with Page 4 instructions.

SUBMIT SIX COPIES