

AGENDA ITEM NO: 107(a)

US Highway 169 Relocation - Nowata County

Transfer from the State Highway System a segment of old road designated as US Highway 169, beginning at its junction with State Highway 28 south of Delaware and extending north via Delaware to its junction with State Highway 10 east of Lenapah, a distance of 6.5 miles. This segment of old road will be transferred to the local jurisdiction of the cities of Delaware and Lenapah and Nowata County for further maintenance or abandonment.

Add to the State Highway System a segment of new road to be designated as US Highway 169, beginning at its junction with State Highway 28 south of Delaware and extending north to its junction with State Highway 10 east of Lenapah, a distance of 6.0 miles.

This revision to the State Highway System will be effective upon completion of construction of Project F-193(8).

ACTION: Approved, June 5, 1972

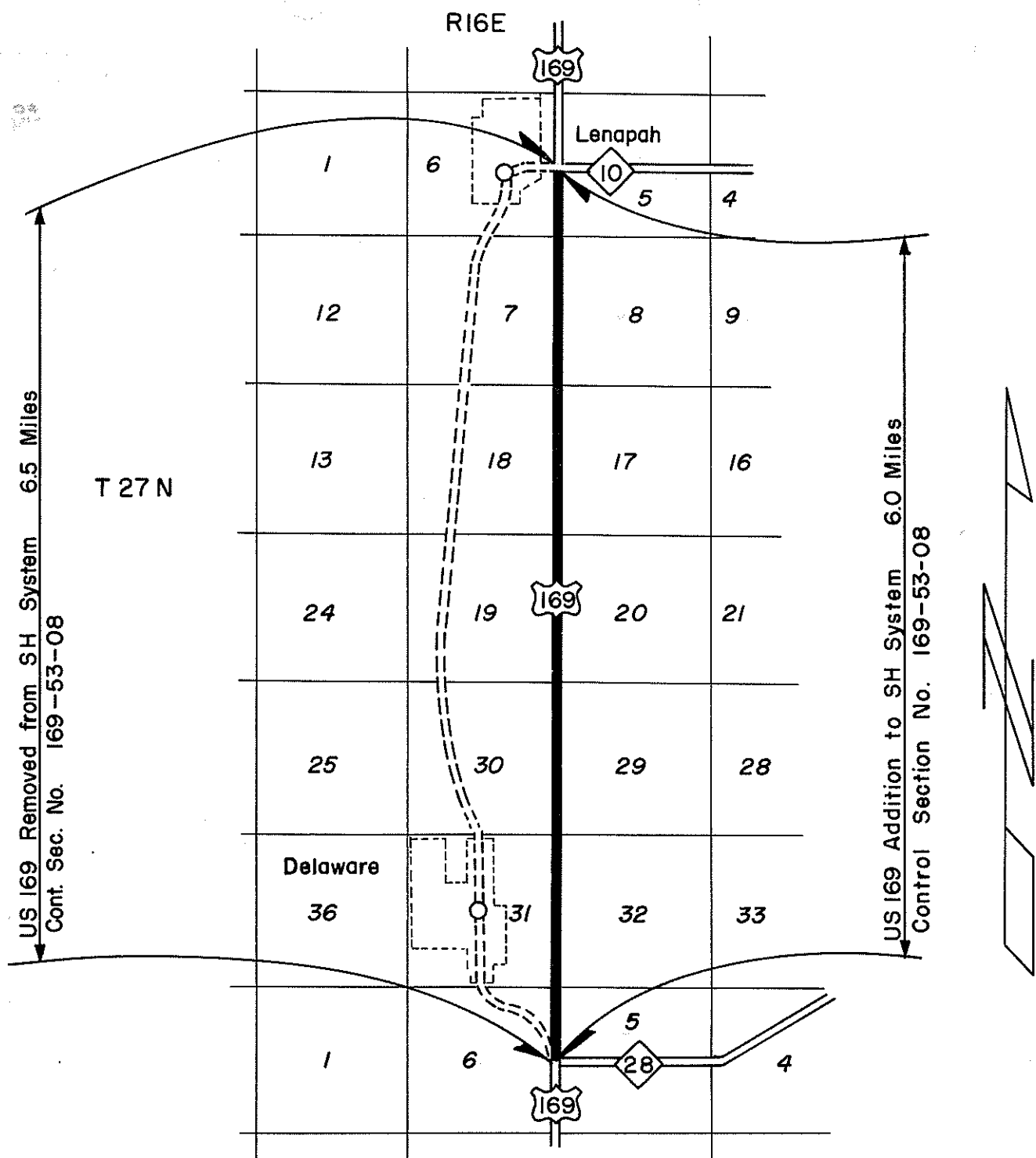

US 169 Relocation
 From Delaware to Lenapah
 Nowata County
 October 27, 1970
 F- 193(8)

Approved June 5, 1972 Item 107 (a)
 Oklahoma State Highway Commission
 Approved Addition to SH System **—————**
 Approved Deletion to SH System **-----**
 Present S.H. System **=====**

R 13 E

R 16 E

STATE OF KANSAS

STATE OF OKLAHOMA

SOUTH COFFEYVILLE

T 29 N

T 28 N

T 27 N

T 26 N

US 169 REMOVED FROM SH SYSTEM

11.6 MILES

SH 10 REMOVED FROM SH SYSTEM
0.4 MILES

US 169 ADDITION TO SH SYSTEM
CONTROL SECTION NO. 169-52-08
11.4 MILES

LENAPAH

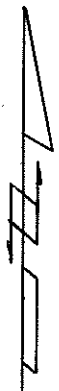

DELAWARE

NOWATA



US 169 RELOCATION & SH 10 REVISION
 FROM SH 28 NORTH TO A POINT 5.1 MILES
 NORTH OF SH 10.
 FROM US 169 IN LENAPAH EAST TO NEW
 LOCATION US 169.
 NOWATA COUNTY
 JANUARY 9, 1968
 PROJ. NO F-193 (8)(10)

APPROVED June 5 1972 ITEM 107(9)
 OKLAHOMA STATE HIGHWAY COMMISSION

APPROVED ADDITION TO SH SYSTEM 
 APPROVED DELETION TO SH SYSTEM 
 PRESENT SH SYSTEM 

June 6, 1972

C
O
P
Y
City Clerk
City of Lenapah
Lenapah, Oklahoma 74042

Dear Sir:

The Oklahoma State Highway Commission in regular session June 5, 1972, Item 107(a), approved the following revision in the State Highway System:

The relocation of US Highway 169 from State Highway 28 near Delaware to State Highway 10 near Lenapah.

A copy of the Commission Minutes concerning this action and a sketch map indicating the location of this revision are enclosed for your information.

Sincerely,

Monty C. Murphy, P.E.
Planning Engineer

MCM:kdg

Enclosure

cc: Mr. Tom Terry, Maintenance Engineer
Mr. B. G. Green, Division Engineer
Mr. William H. Bell, Commissioner

June 6, 1972

C
O
P
Y

City Clerk
City of Delaware
Delaware, Oklahoma 74027

Dear Sir:

The Oklahoma State Highway Commission in regular session June 5, 1972, Item 107(a), approved the following revision in the State Highway System:

The relocation of US Highway 169 from State Highway 28 near Delaware to State Highway 10 near Lenapah.

A copy of the Commission Minutes concerning this action and a sketch map indicating the location of this revision are enclosed for your information.

Sincerely,

Monty C. Murphy, P.E.
Planning Engineer

MCM:kdg

Enclosure

cc: Mr. Tom Terry, Maintenance Engineer
Mr. D. G. Green, Division Engineer
Mr. William H. Bell, Commissioner

June 6, 1972

C
Board of County Commissioners
Nowata County Courthouse
Nowata, Oklahoma 74048

O
Gentlemen:

The Oklahoma State Highway Commission in regular session June 5, 1972, Item 107(a), approved the following revision in the State Highway System:

P
The relocation of US Highway 169 from State Highway 28 near Delaware to State Highway 10 near Lenapah.

A copy of the Commission Minutes concerning this action and a sketch map indicating the location of this revision are enclosed for your information.

Y
Sincerely,

Monty C. Murphy, P.E.
Planning Engineer

MCM:kdg

Enclosure

cc: Mr. Tom Terry, Maintenance Engineer
Mr. B. G. Green, Division Engineer
Mr. William H. Bell, Commissioner

CERTIFICATION OF PUBLIC HEARING

REGARDING

STATE HIGHWAY SYSTEM

I hereby certify that in accordance with Section 503 of Title 69 - O.S.Supp.1968, a public hearing was scheduled at:

Time: 10:00 AM, Friday, May 12, 1972
Place: County Court Room, Nowata County,
Oklahoma,

on the proposed transfer from the State Highway System to local jurisdiction:

A segment of US 169, from its junction with SH 28 south of Delaware and extending north, via Delaware, to its junction with SH 10 east of Lenapah, a distance of 6.5 miles in Nowata County.

Notice of hearing was given by letter to the State Highway Commissioner, State Senator, State Representative and County Commissioners concerned.

No persons attended.

V. O. Bradley
Assistant Director
Planning and Research
Oklahoma Highway Department

Oklahoma State Highway Dept.

Date December 14, 1972

To B. G. Green, Division Engineer
From Monty C. Murphy, Planning Engineer
Subject AASHO Approvals

This is to advise that the relocation of US Highway 169 between Delaware and Lenapah was approved by the AASHO Route Numbering Committee on November 25, 1972.

Monty C. Murphy, P.E.
Planning Engineer

MCM/dk

Attachments

AMERICAN ASSOCIATION OF STATE HIGHWAY OFFICIALS



AN APPLICATION

FROM THE STATE HIGHWAY DEPARTMENT OF
OKLAHOMA



FOR

- the Elimination of a U.S. Route
- the Establishment of a U.S. Route
- the Relocation of U.S. Route ...169...
- the Extension of U.S. Route
- the Establishment of an Alternate U.S. Route
- the Establishment of a Temporary U.S. Route
- * the Recognition of a Business Route on U.S. Route
- * the Recognition of a By-pass Route on U.S. Route

BETWEEN

Nowata and South Coffeyville

The Following
State or States are
Involved:

(In case more than one State is involved, an application must be submitted by each State for that portion within the respective State.)

.....

.....

.....

.....

.....

Date Received 10/11/72

Date application acknowledged 10/11/72

Date to Route Number Committee 10/20/72

Date considered by Executive Committee 11/25/72

Action of Executive Committee Approved

Member Department Notified 12/5/72

(This block to be completed by AASHO General Office.)

Date Submitted:

....., 19.....

* A local vicinity map needed on Page 3. On Page 5 a short statement to the effect that there are no deficiencies on proposed routing, if true, will suffice. If there are deficiencies, they should be so indicated in accordance with Page 4 instructions.

SUBMIT SIX COPIES

Planning ~~*Strat*~~

AMERICAN ASSOCIATION OF STATE HIGHWAY OFFICIALS

PRESIDENT

Thomas F. Airis, Director
District of Columbia
Department of Highways and Traffic
415 - 12th. Street, N.W.
Washington, D. C. 20004



EXECUTIVE DIRECTOR

Henrik E. Stafseth
341 Nat'l Press Bldg.
Washington, D. C. 20004
Telephone 628-2438

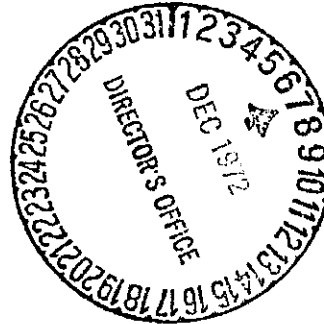
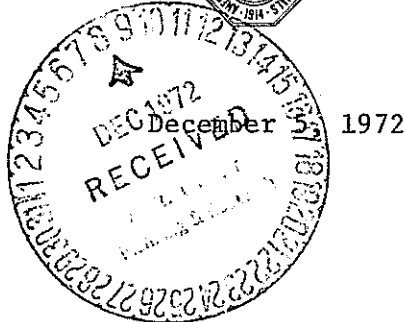

Mr. R. A. Ward, Director
Department of Highways
Jim Thorpe Bldg.
Oklahoma City, Oklahoma 73105

Dear Mr. Ward:

The U.S. Route Numbering Subcommittee has considered your applications for the relocation of U.S. Route 62 between Altus and Lawton and the relocation of U.S. Route 169 between Nowata and South Coffeyville, and favorable action has been taken upon these two requests.

The establishment of U.S. Route 377 between Madill and Cleveland has been denied, as the Committee did not feel that there had been sufficient demonstration of a need for a U.S. Route in this area, since there appears to be over concentration of U.S. Routes.

The U.S. Route Numbering Subcommittee has suggested that you review the entire sequence of U.S. Routes running north and south, between Tulsa and Oklahoma City, to see if some realignment or elimination might not be possible.

Attached you will find the two copies of the approved applications and the copy of the denied application.

Yours very truly,

Henrik E. Stafseth
Executive Director

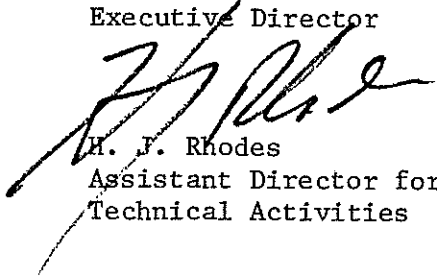

H. J. Rhodes
Assistant Director for
Technical Activities

HJR/cn

Attachments