

COUNTY

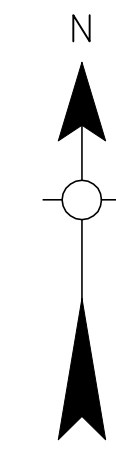

STATE OF OKLAHOMA  
DEPARTMENT OF TRANSPORTATION

CITY OF  
**PONCA CITY**  
KAY COUNTY

CENSUS YEAR 2010  
POPULATION 25,387

SCALE IN MILES

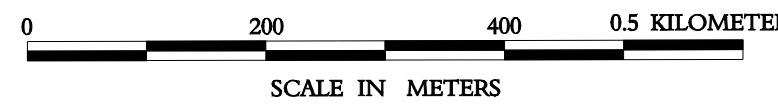
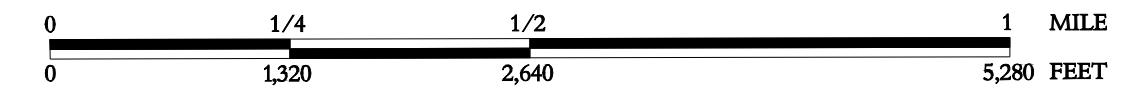

LEGEND

- CORPORATE LIMITS ————
- STATE NUMBERED ROUTES
- U.S. NUMBERED ROUTES
- INTERSTATE ROUTES

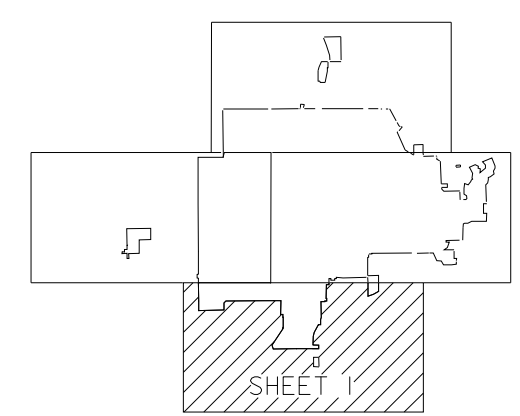

Copies of this map are available for public use at nominal cost.  
Address:  
OKLAHOMA DEPARTMENT OF TRANSPORTATION  
PRINTING SERVICES (Phone - 521-2586)  
200 N.E. 21st STREET  
OKLAHOMA CITY, OKLA. 73105

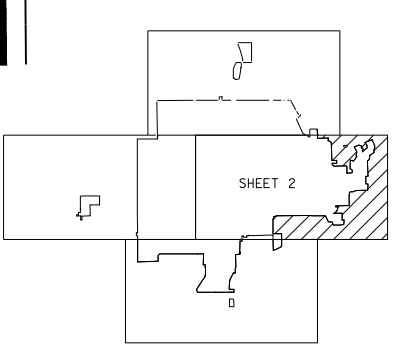
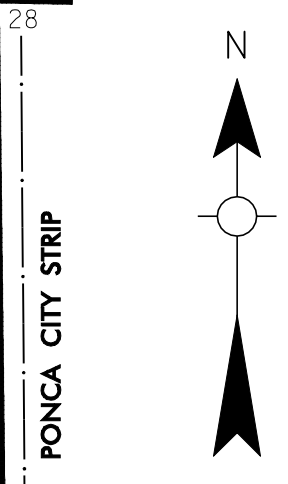
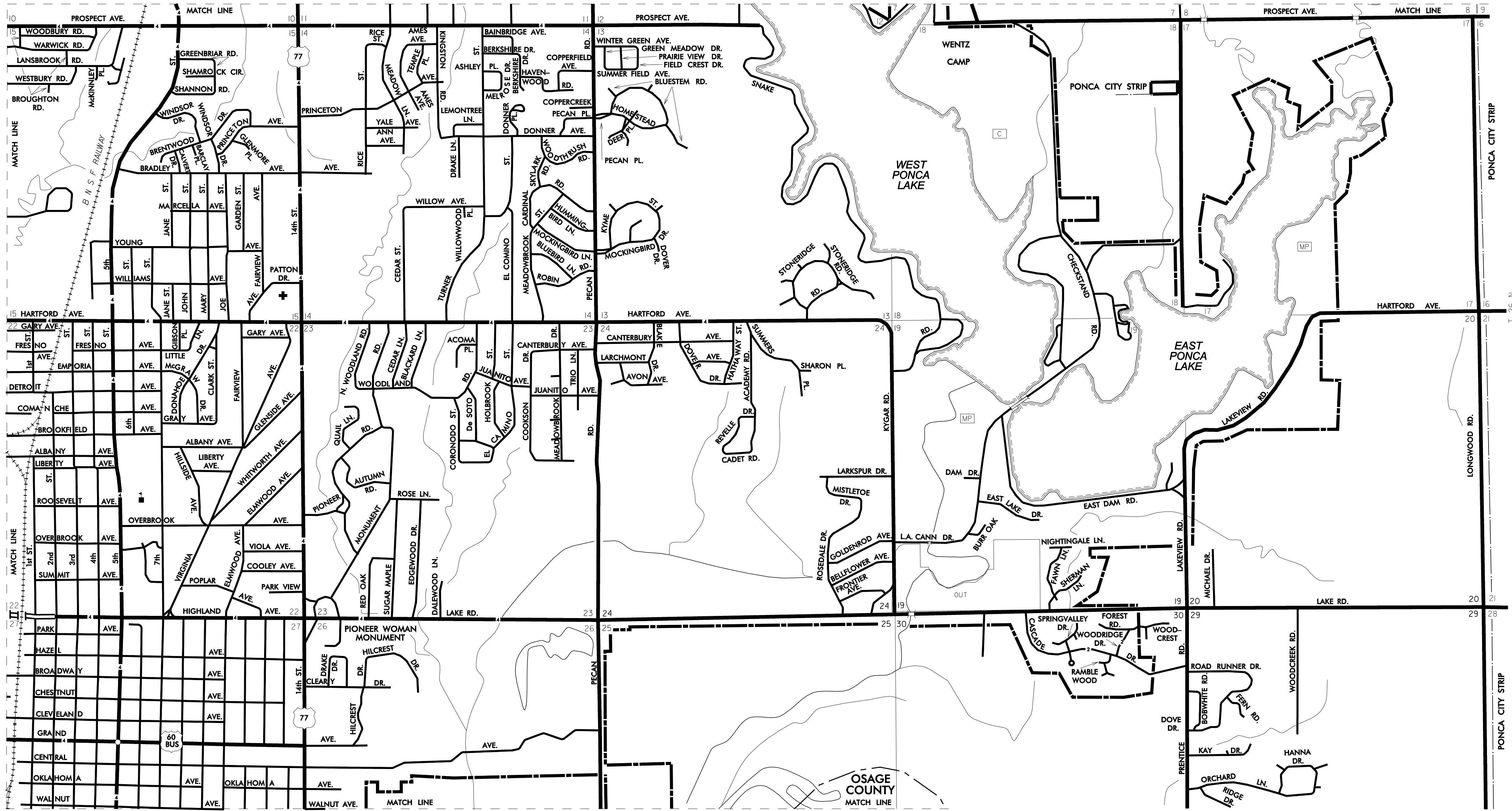

Copies of this map are available for public use at nominal cost.  
 Address:  
 OKLAHOMA DEPARTMENT OF TRANSPORTATION  
 PRINTING SERVICES (Phone - 521-2586)  
 200 N.E. 21st STREET  
 OKLAHOMA CITY, OKLA. 73105

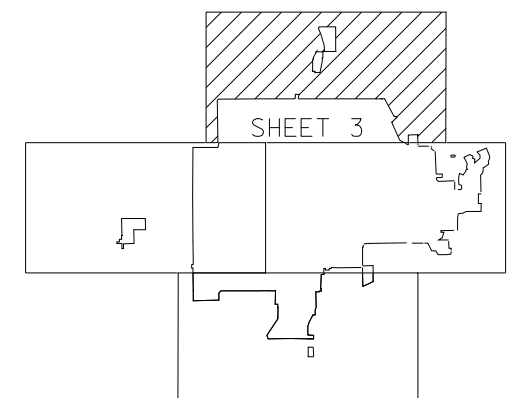
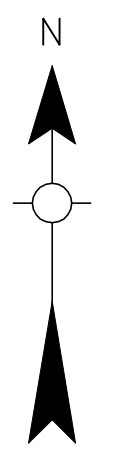
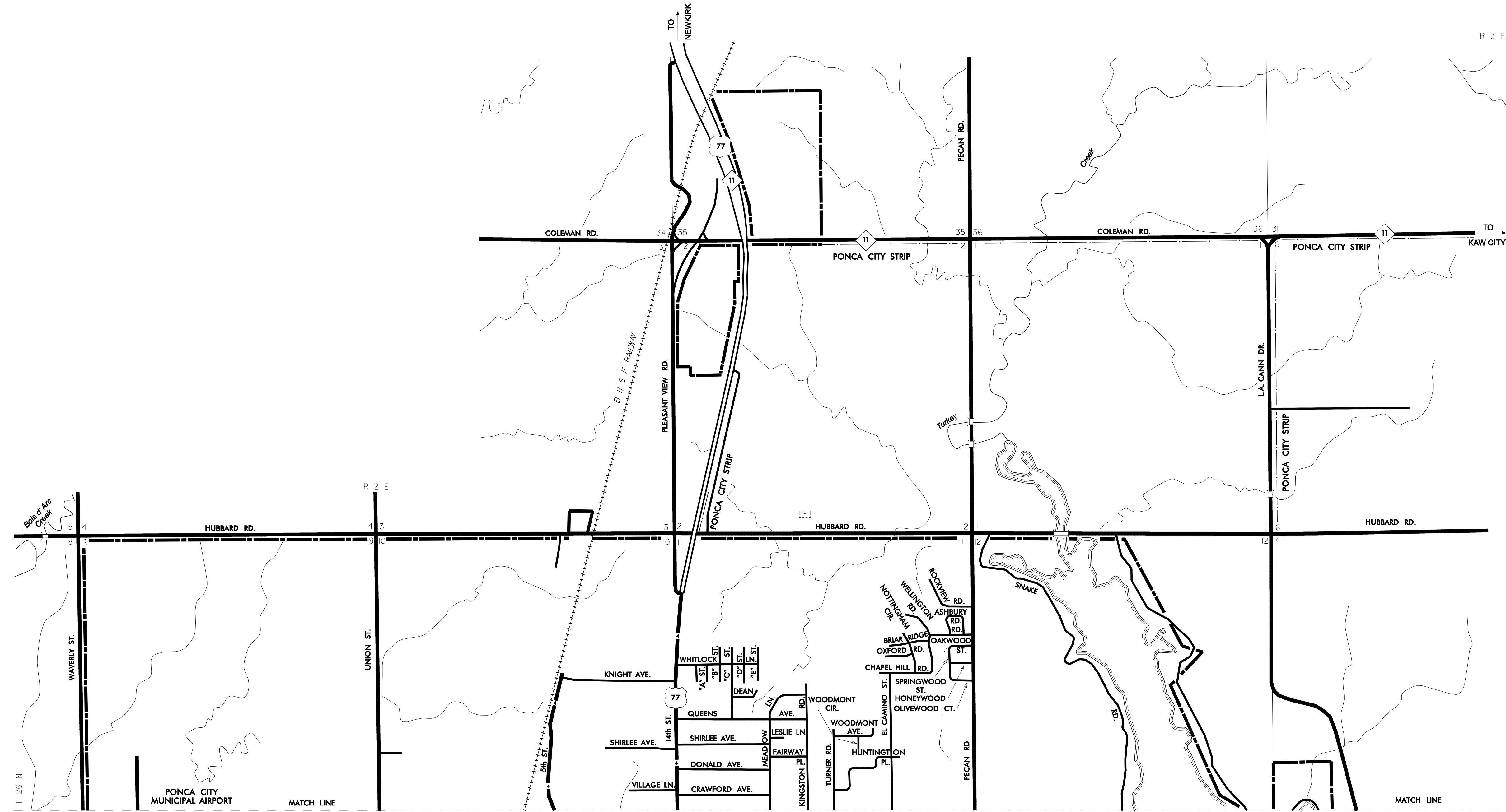

Copies of this map are available for public use at nominal cost.  
 Address:  
 OKLAHOMA DEPARTMENT OF TRANSPORTATION  
 PRINTING SERVICES (Phone - 521-2586)  
 200 N.E. 21st STREET  
 OKLAHOMA CITY, OKLA. 73105

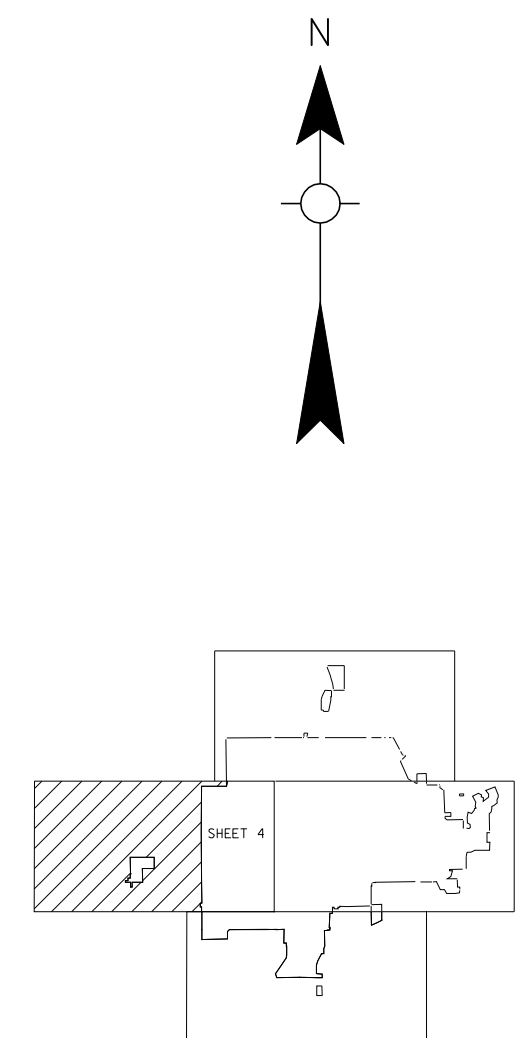
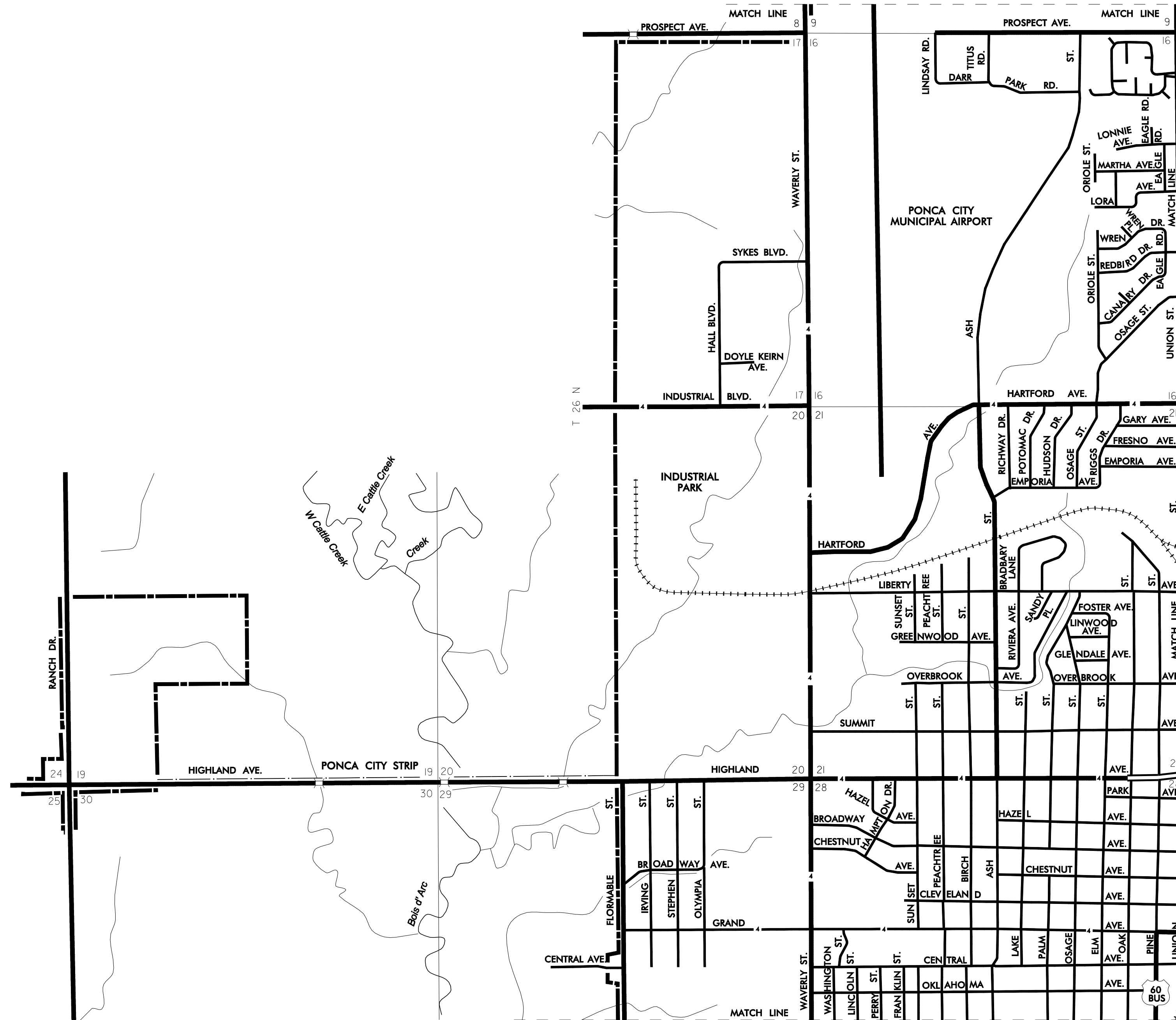

Copies of this map are available for public use at nominal cost.  
 Address:  
 OKLAHOMA DEPARTMENT OF TRANSPORTATION  
 PRINTING SERVICES (Phone - 521-2586)  
 200 N.E. 21st STREET  
 OKLAHOMA CITY, OKLA. 73105

ALL RIGHTS RESERVED

COMPUTER GENERATED

JULY 2011

PONCA CITY, SHEET 4, KAY COUNTY