

Copies of this map are available for public use at nominal cost.
 Address:
 OKLAHOMA DEPARTMENT OF TRANSPORTATION
 PRINTING SERVICES PHONE (405) 521-2586
 200 N.E. 21st STREET
 OKLAHOMA CITY, OKLAHOMA 73105-3204

This map indicates those roads known to the Department to be open to public travel. Placement of a road on the map has no relationship to maintenance responsibility by any level of government.

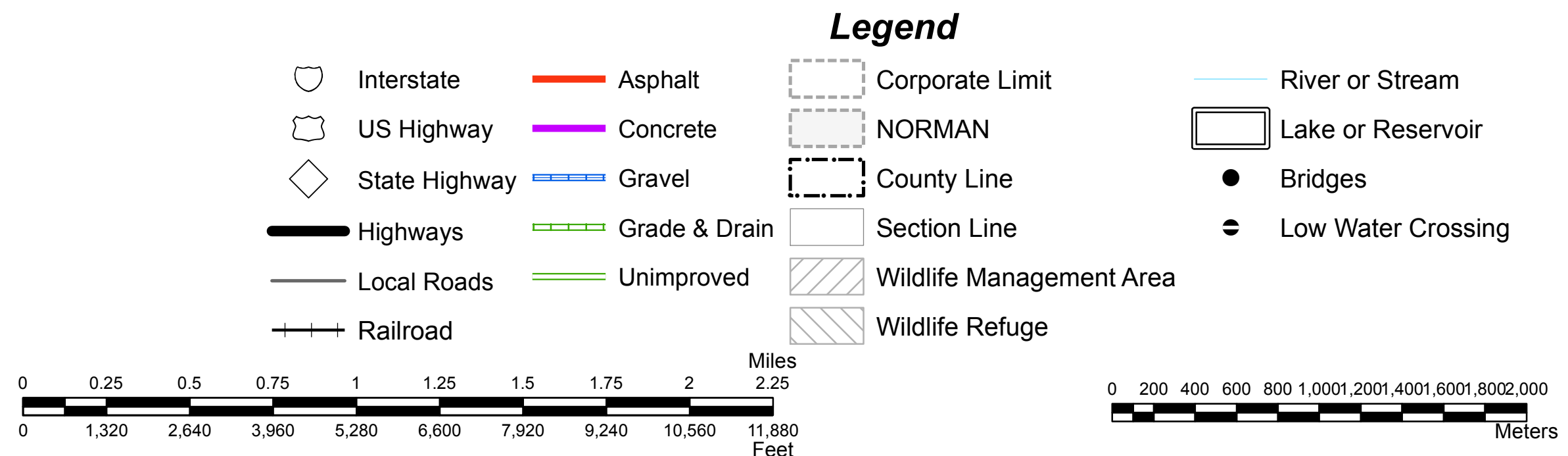

STATE OF OKLAHOMA
 DEPARTMENT OF TRANSPORTATION

CITY OF
NORMAN
 CLEVELAND COUNTY

CENSUS YEAR 2010
 POPULATION 110,925

ALL RIGHTS RESERVED COMPUTER GENERATED September, 2018

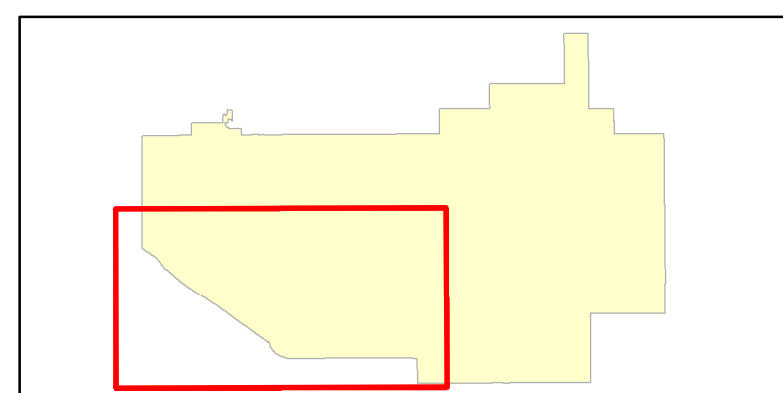
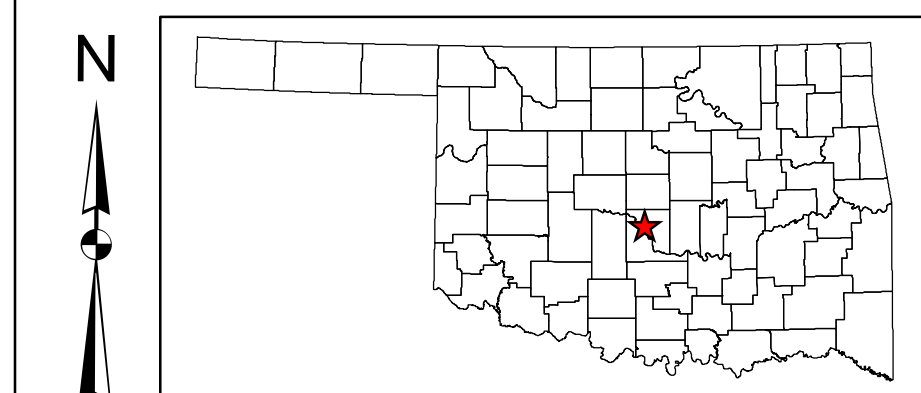
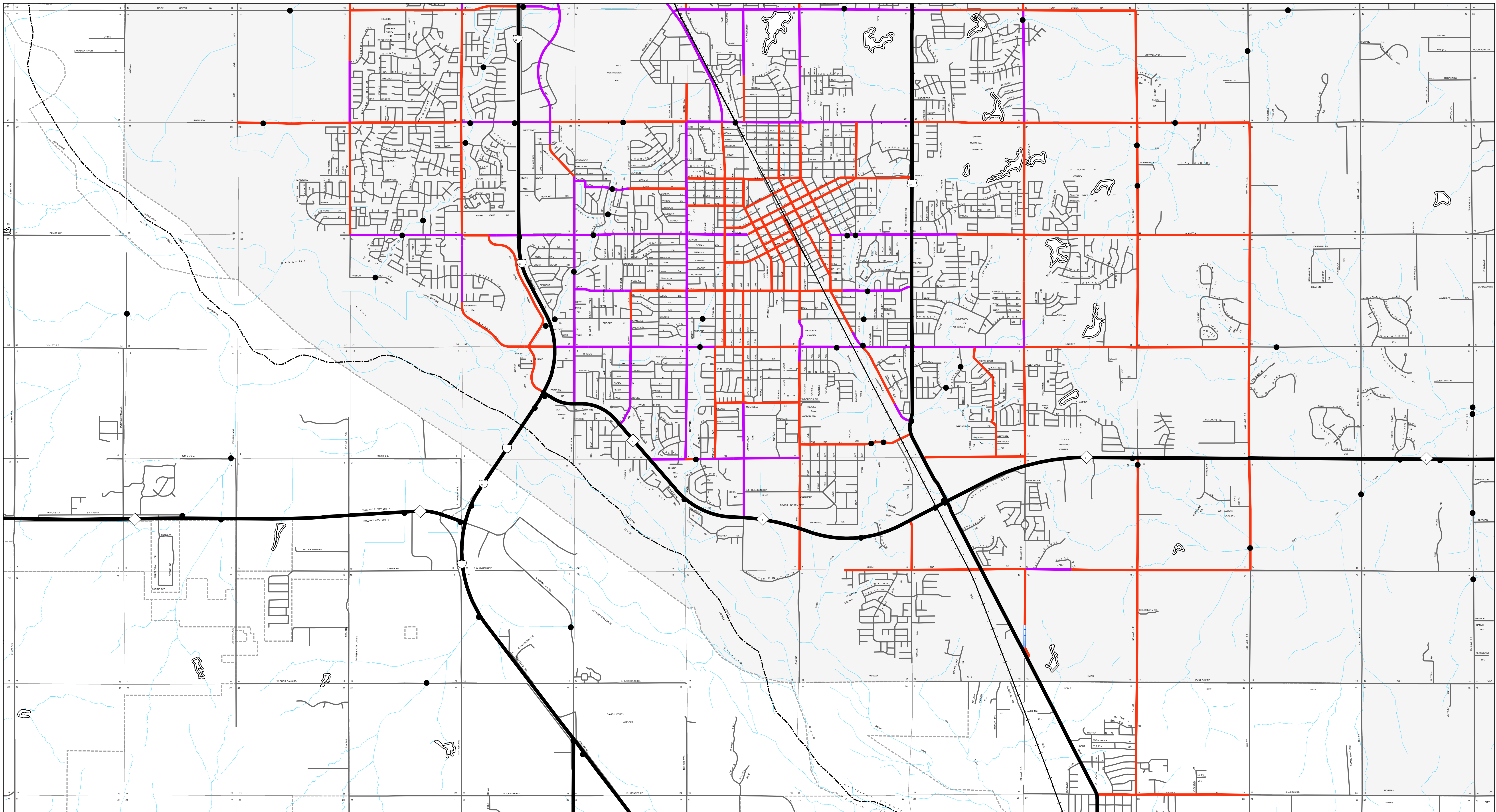

- Legend**
- Interstate
 - US Highway
 - State Highway
 - Highways
 - Local Roads
 - Railroad
 - Asphalt
 - Concrete
 - Gravel
 - Grade & Drain
 - Unimproved
 - Corporate Limit
 - NORMAN
 - County Line
 - Section Line
 - Wildlife Management Area
 - Wildlife Refuge
 - River or Stream
 - Lake or Reservoir
 - Bridges
 - Low Water Crossing

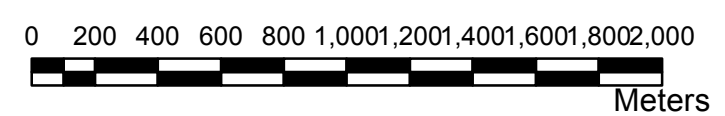
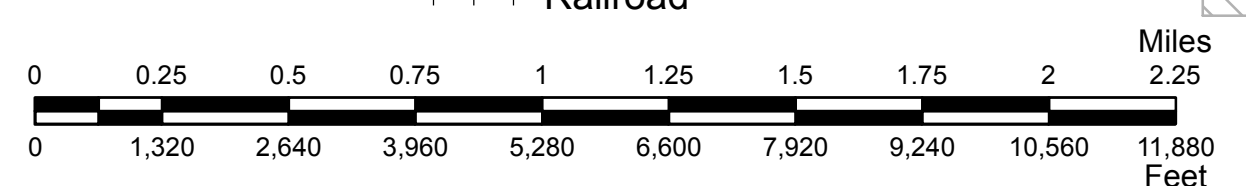

Copies of this map are available for public use at nominal cost.
 Address:
 OKLAHOMA DEPARTMENT OF TRANSPORTATION
 PRINTING SERVICES Phone (405) 521-2586
 200 N.E. 21st STREET
 OKLAHOMA CITY, OKLAHOMA 73105-3204

This map indicates those roads known to the Department to be open to public travel. Placement of a road on the map has no relationship to maintenance responsibility by any level of government.

© COPYRIGHT 2018
 PRINTED AT STATE EXPENSE

NOT FOR RESALE

**STATE OF OKLAHOMA
 DEPARTMENT OF TRANSPORTATION**

CITY OF
NORMAN
 CLEVELAND COUNTY

CENSUS YEAR 2010
 POPULATION 110,925

ALL RIGHTS RESERVED COMPUTER GENERATED September, 2018

NORMAN, CLEVELAND COUNTY

NORMAN

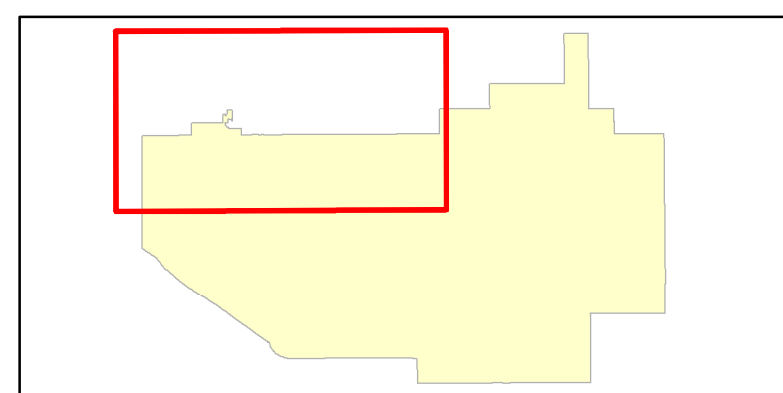
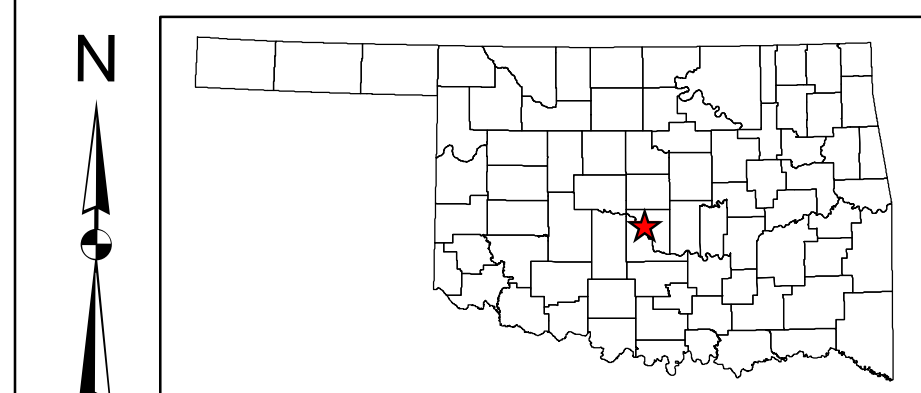
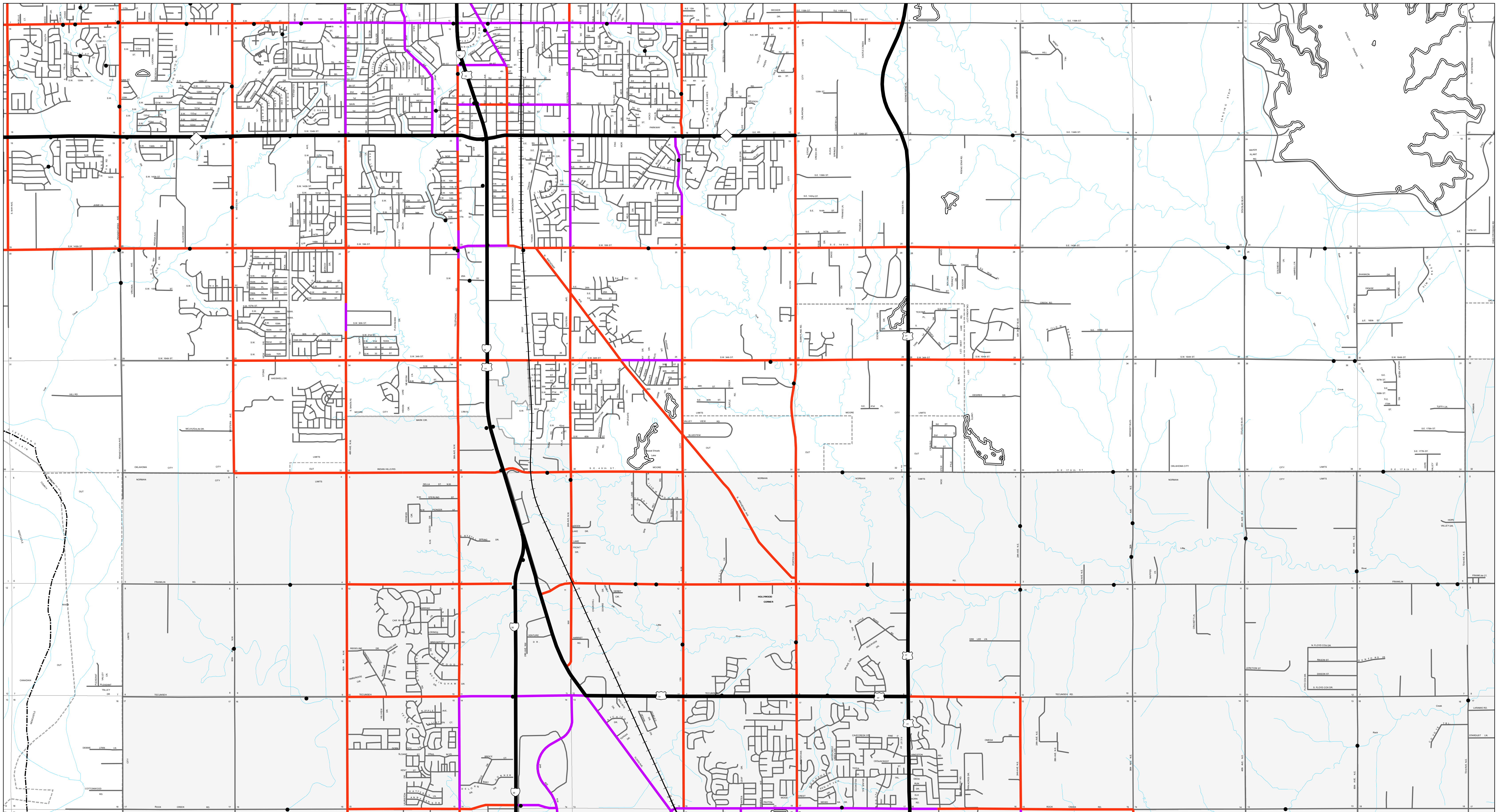

Legend

- | | | | |
|---------------|-----------------|--------------------------|--------------------|
| Interstate | Asphalt | Corporate Limit | River or Stream |
| US Highway | Concrete | NORMAN | Lake or Reservoir |
| State Highway | Gravel | County Line | Bridges |
| Highways | Grade & Drain | Section Line | Low Water Crossing |
| Local Roads | Unimproved | Wildlife Management Area | |
| Railroad | Wildlife Refuge | | |

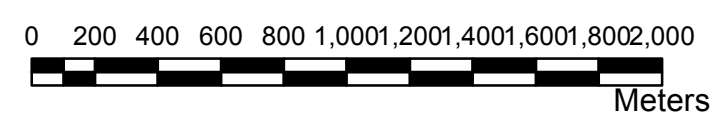
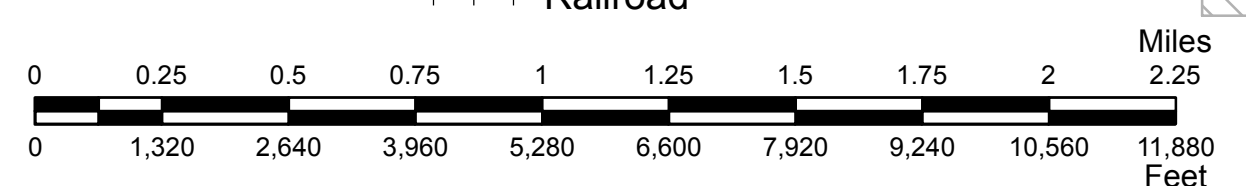

Copies of this map are available for public use at nominal cost.
 Address:
 OKLAHOMA DEPARTMENT OF TRANSPORTATION
 PRINTING SERVICES Phone (405) 521-2586
 200 N.E. 21st STREET
 OKLAHOMA CITY, OKLAHOMA 73105-3204

This map indicates those roads known to the Department to be open to public travel. Placement of a road on the map has no relationship to maintenance responsibility by any level of government.

© COPYRIGHT 2018
 PRINTED AT STATE EXPENSE

NOT FOR RESALE

**STATE OF OKLAHOMA
 DEPARTMENT OF TRANSPORTATION**

CITY OF
NORMAN
 CLEVELAND COUNTY

CENSUS YEAR 2010
 POPULATION 110,925

ALL RIGHTS RESERVED COMPUTER GENERATED September, 2018

NORMAN, CLEVELAND COUNTY

NORMAN

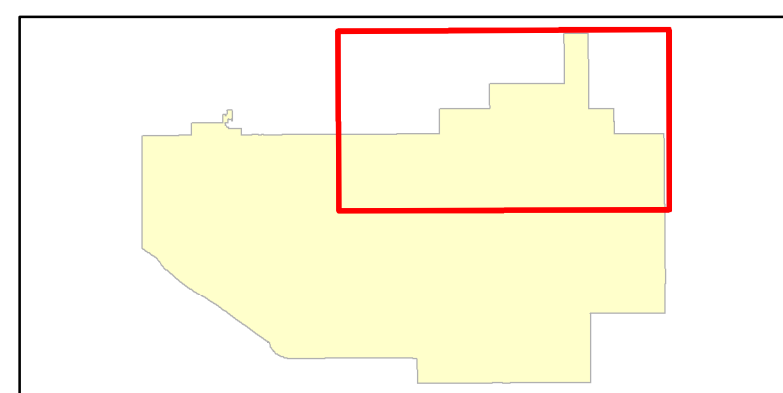
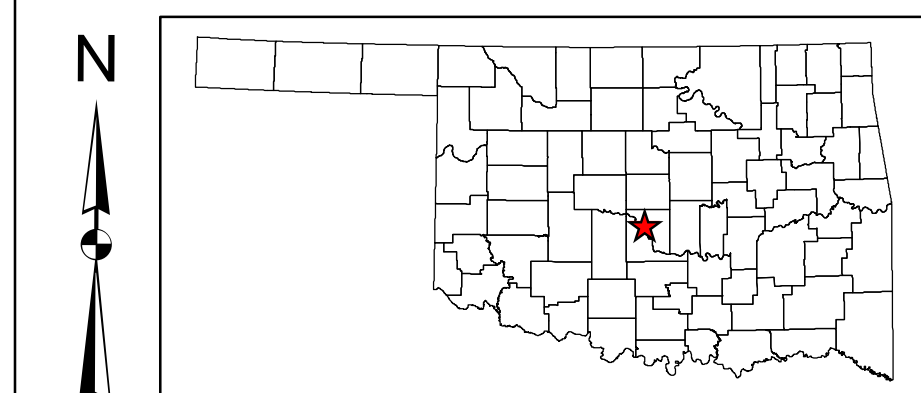
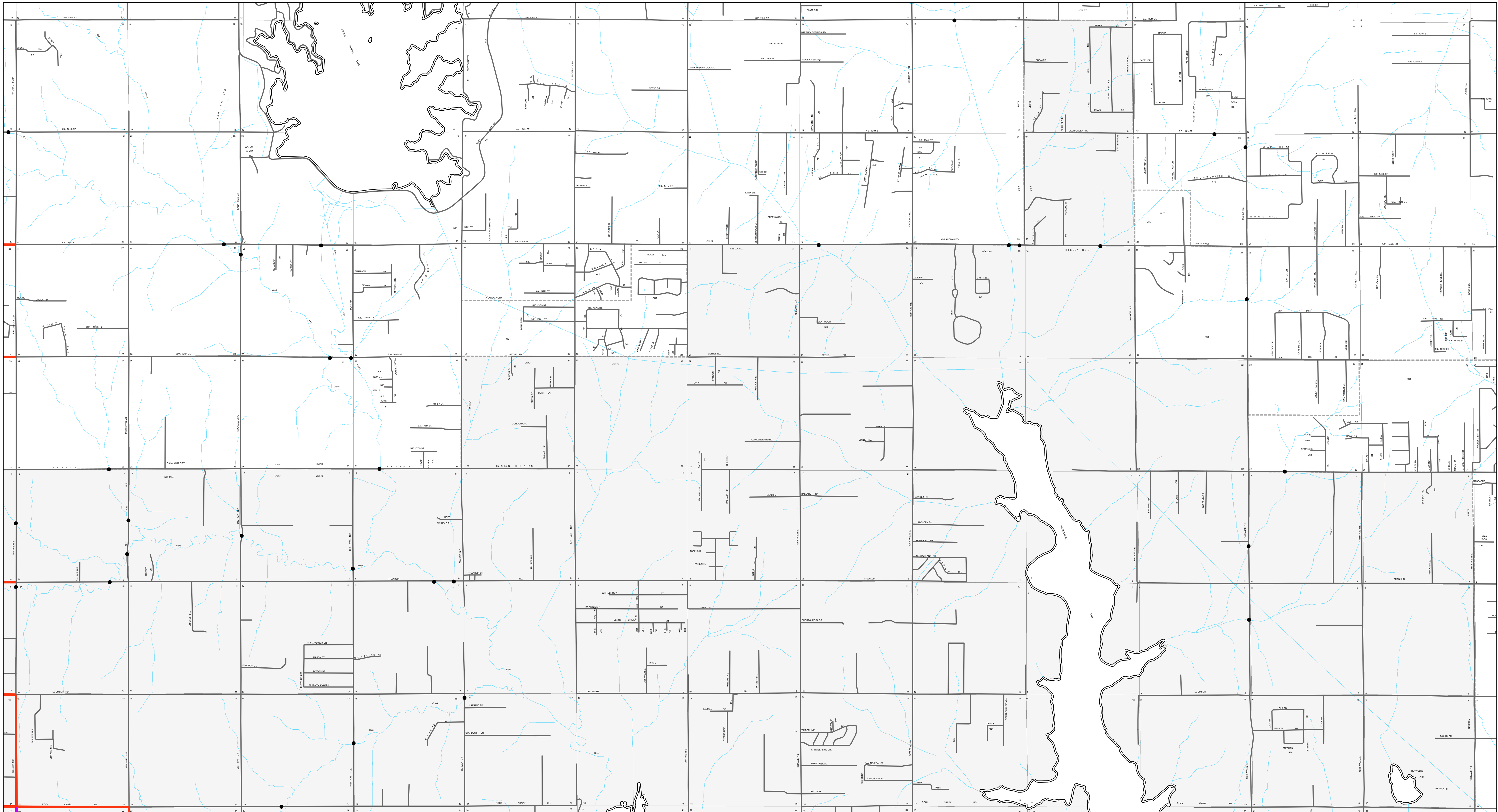

- Legend**
- Interstate
 - US Highway
 - State Highway
 - Highways
 - Local Roads
 - Railroad
 - Asphalt
 - Concrete
 - Gravel
 - Grade & Drain
 - Unimproved
 - Corporate Limit
 - NORMAN
 - County Line
 - Section Line
 - Wildlife Management Area
 - Wildlife Refuge
 - River or Stream
 - Lake or Reservoir
 - Bridges
 - Low Water Crossing

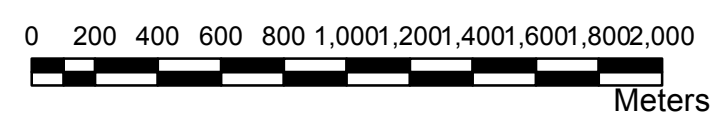
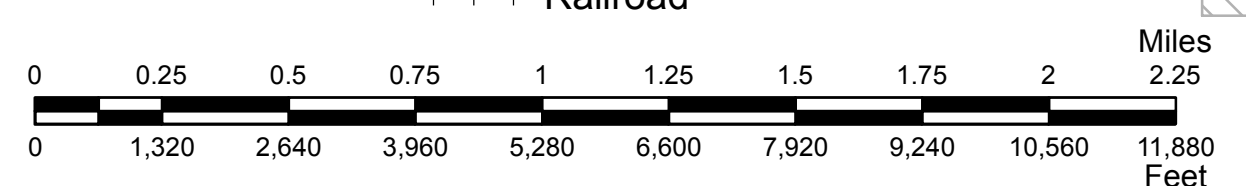

Copies of this map are available for public use at nominal cost.
 Address:
 OKLAHOMA DEPARTMENT OF TRANSPORTATION
 PRINTING SERVICES Phone (405) 521-2586
 200 N.E. 21st STREET
 OKLAHOMA CITY, OKLAHOMA 73105-3204

This map indicates those roads known to the Department to be open to public travel. Placement of a road on the map has no relationship to maintenance responsibility by any level of government.

© COPYRIGHT 2018
 PRINTED AT STATE EXPENSE

NOT FOR RESALE

**STATE OF OKLAHOMA
 DEPARTMENT OF TRANSPORTATION**

CITY OF
NORMAN
 CLEVELAND COUNTY

CENSUS YEAR 2010
 POPULATION 110,925

ALL RIGHTS RESERVED COMPUTER GENERATED September, 2018

NORMAN, CLEVELAND COUNTY

NORMAN