

Copies of this map are available for public use at nominal cost.
 Address:
 OKLAHOMA DEPARTMENT OF TRANSPORTATION
 PRINTING SERVICES Phone (405) 521-2586
 200 N.E. 21st STREET
 OKLAHOMA CITY, OKLAHOMA 73105-3204
 LANGSTON - SHEET 1

This map indicates those roads known to the Department to be open to public travel. Placement of a road on the map has no relationship to maintenance responsibility by any level of government.

© COPYRIGHT 2018
 PRINTED AT STATE EXPENSE

NOT FOR RESALE

ALL RIGHTS RESERVED
 COMPUTER GENERATED
 LANGSTON, LOGAN COUNTY
 September 2018

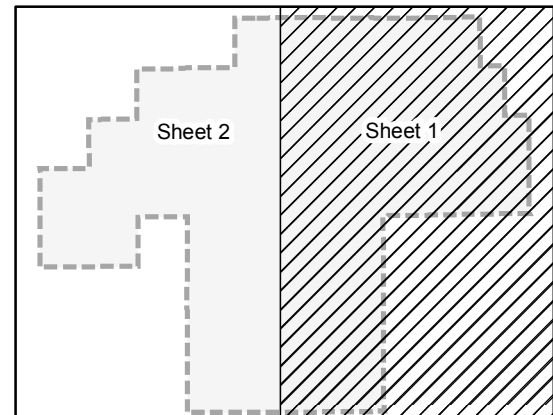
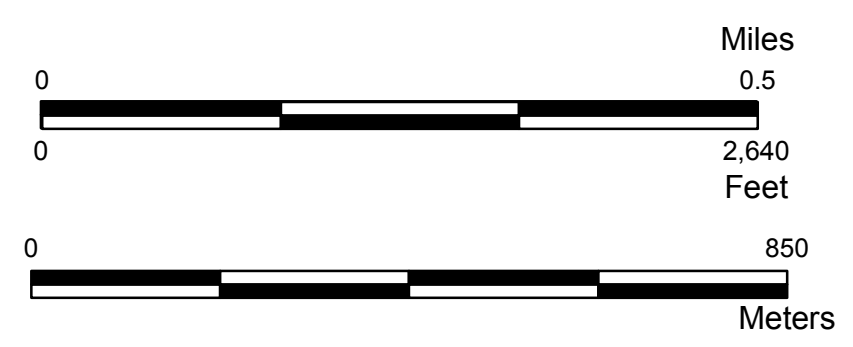
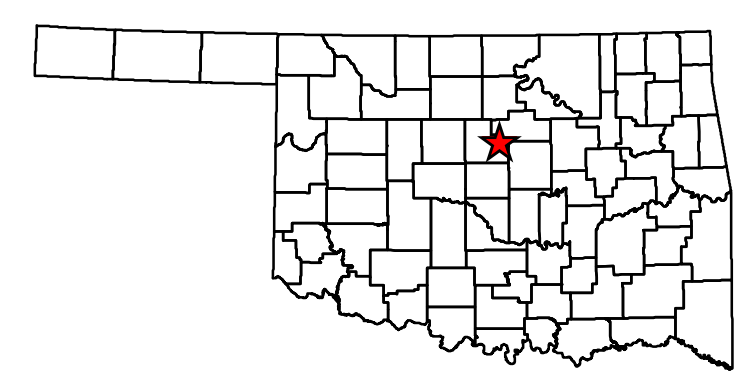
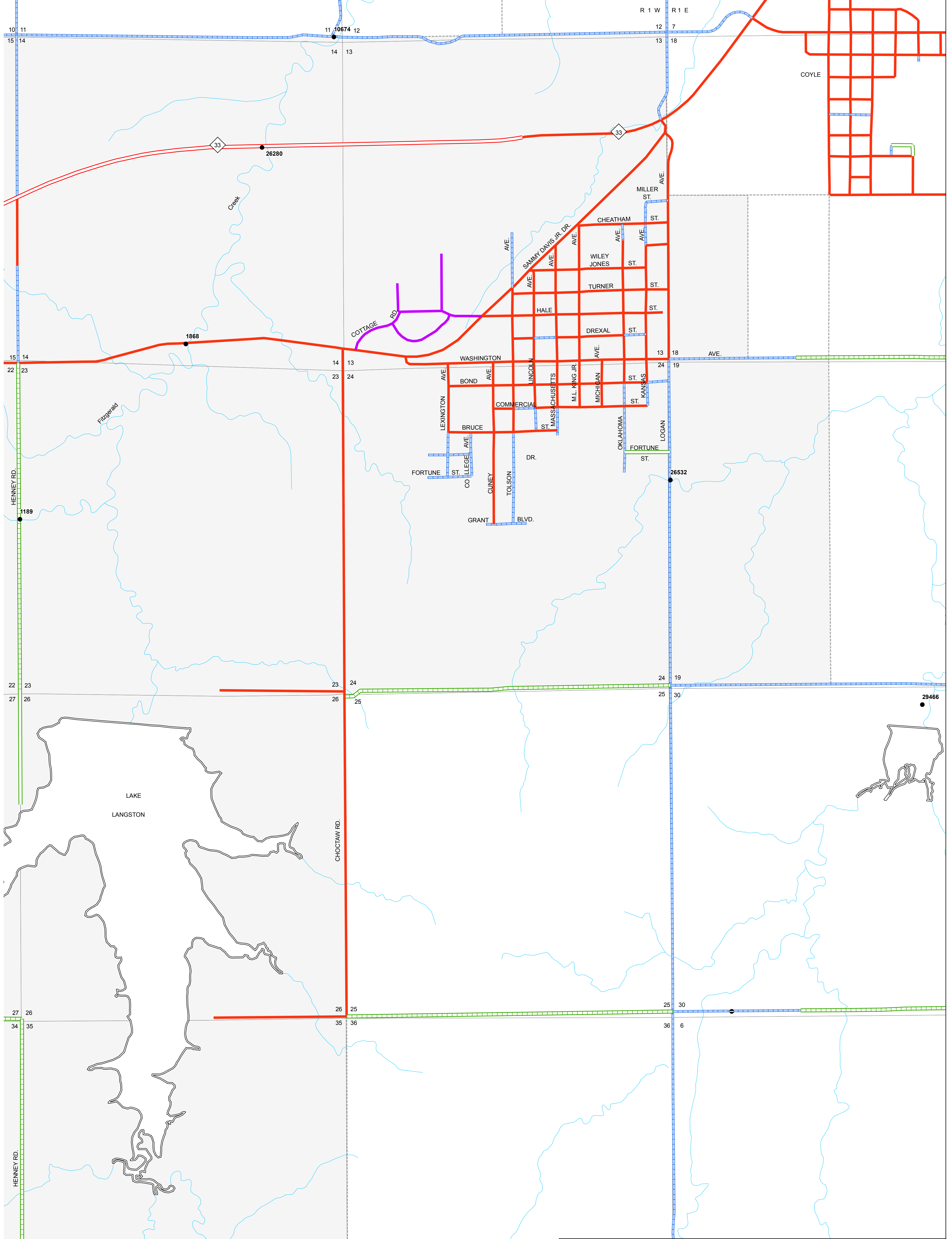

**STATE OF OKLAHOMA
 DEPARTMENT OF TRANSPORTATION**

**CITY OF
 LANGSTON
 LOGAN COUNTY**

CENSUS YEAR 2010
 POPULATION 1,724

Legend

- | | | |
|----------------------------------|---------------|--------------------------|
| State Highway | Asphalt | County Line |
| U.S. Highway | Concrete | State Line |
| Interstate | Gravel | Section Line |
| Divided Highway, 4 or more lanes | Grade & Drain | Wildlife Management Area |
| Asphalt | Unimproved | Wildlife Refuge |
| Concrete | Railroad | River or Stream |
| Corporate Limit | Langston | Lake or Reservoir |
| | | Bridges |
| | | Low Water Crossing |

Copies of this map are available for public use at nominal cost.
 Address:
 OKLAHOMA DEPARTMENT OF TRANSPORTATION
 PRINTING SERVICES Phone (405) 521-2586
 200 N.E. 21st STREET
 OKLAHOMA CITY, OKLAHOMA 73105-3204

This map indicates those roads known to the Department to be open to public travel. Placement of a road on the map has no relationship to maintenance responsibility by any level of government.

© COPYRIGHT 2018
 PRINTED AT STATE EXPENSE

NOT FOR RESALE

ALL RIGHTS RESERVED
 COMPUTER GENERATED
 LANGSTON, LOGAN COUNTY
 September 2018

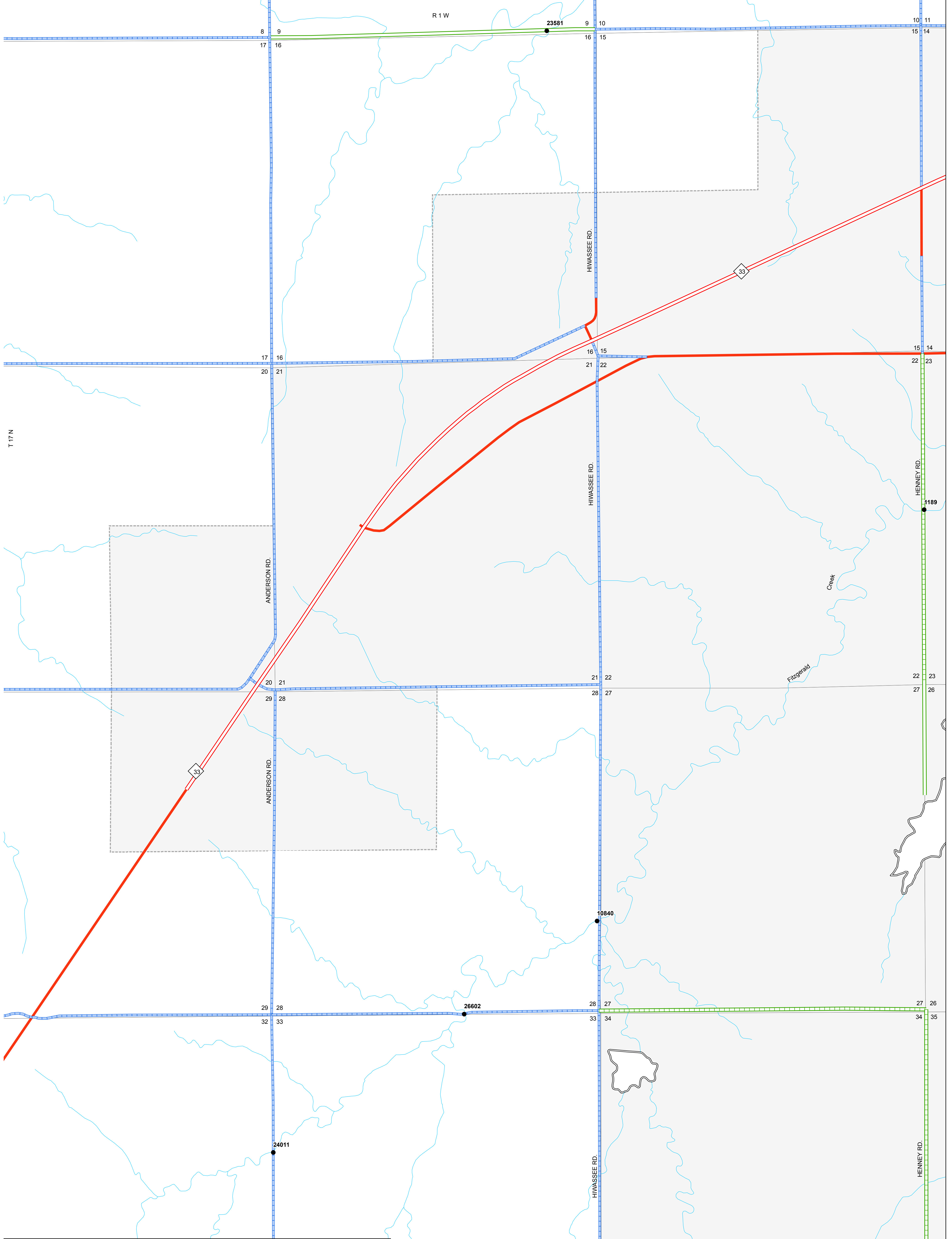

**STATE OF OKLAHOMA
 DEPARTMENT OF TRANSPORTATION**

CITY OF
LANGSTON
 LOGAN COUNTY

CENSUS YEAR 2010
 POPULATION 1,724

Legend

| | | | |
|--|----------------------------------|--|--------------------------|
| | State Highway | | County Line |
| | U.S. Highway | | State Line |
| | Interstate | | Section Line |
| | Divided Highway, 4 or more lanes | | Wildlife Management Area |
| | Asphalt | | Wildlife Refuge |
| | Concrete | | River or Stream |
| | Gravel | | Lake or Reservoir |
| | Grade & Drain | | Corporate Limit |
| | Unimproved | | Langston |
| | Railroad | | Bridges |
| | Low Water Crossing | | |

N

Miles
0.5

Feet
2,640

Meters
850

Sheet 1 Sheet 2