

Copies of this map are available for public use at nominal cost.  
 Address:  
 OKLAHOMA DEPARTMENT OF TRANSPORTATION  
 PRINTING SERVICES Phone (405) 521-2586  
 200 N.E. 21st STREET  
 OKLAHOMA CITY, OKLAHOMA 73105-3204

This map indicates those roads known to the Department to be open to public travel. Placement of a road on the map has no relationship to maintenance responsibility by any level of government.

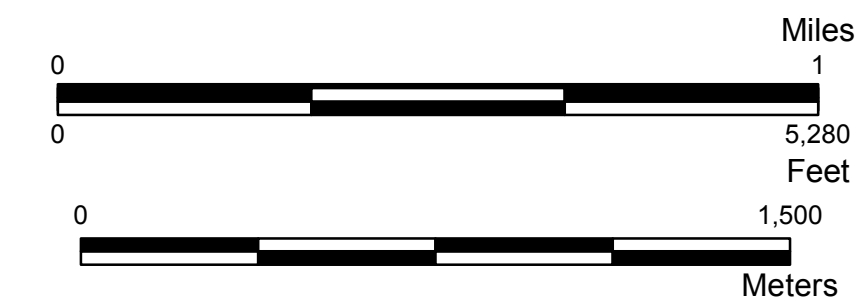
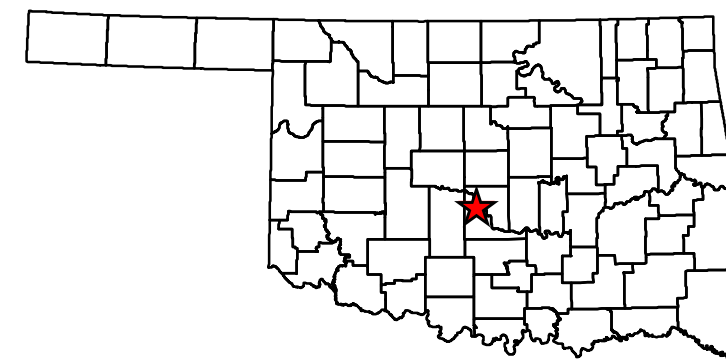
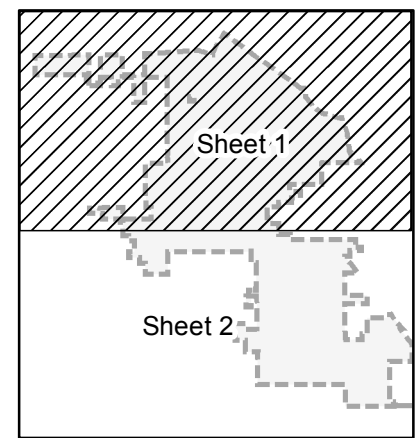

**STATE OF OKLAHOMA  
DEPARTMENT OF TRANSPORTATION**

**CITY OF  
GOLDSBY  
MCCLAIN COUNTY**

CENSUS YEAR 2010  
POPULATION 1,801

**Legend**

State Highway	<b>Road Surface Type</b>	County Line
U.S. Highway	Asphalt	Section Line
Interstate	Concrete	Wildlife Management Area
Divided Highway, 4 or more lanes	Gravel	Wildlife Refuge
Asphalt	Grade & Drain	River or Stream
Concrete	Unimproved	Lake or Reservoir
Railroad	Corporate Limit	Bridges
Goldsby	Goldsby	Low Water Crossing



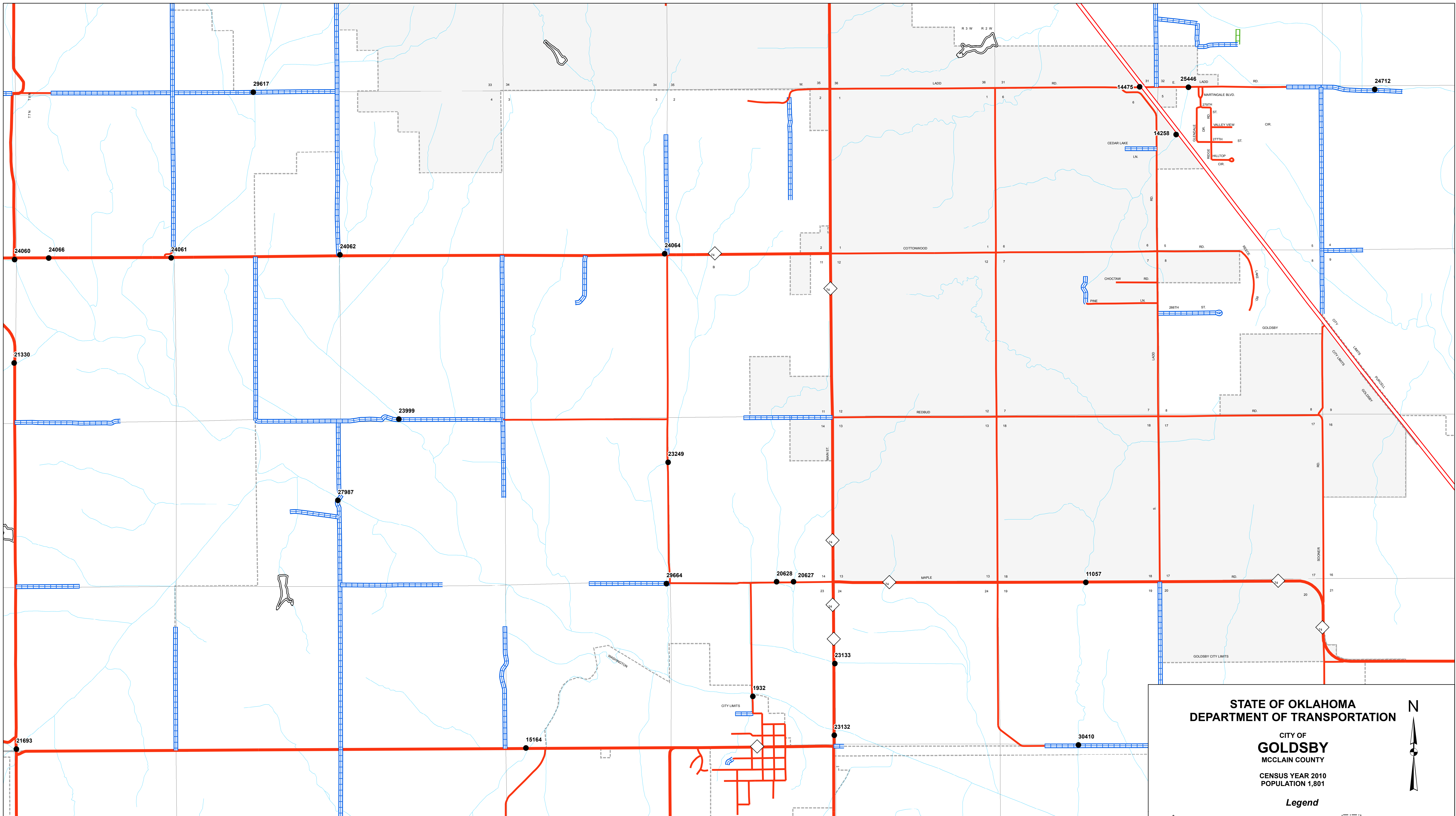

Copies of this map are available for public use at nominal cost.  
 Address:  
 OKLAHOMA DEPARTMENT OF TRANSPORTATION  
 PRINTING SERVICES Phone (405) 521-2586  
 200 N.E. 21st STREET  
 OKLAHOMA CITY, OKLAHOMA 73105-3204

This map indicates those roads known to the Department to be open to public travel. Placement of a road on the map has no relationship to maintenance responsibility by any level of government.

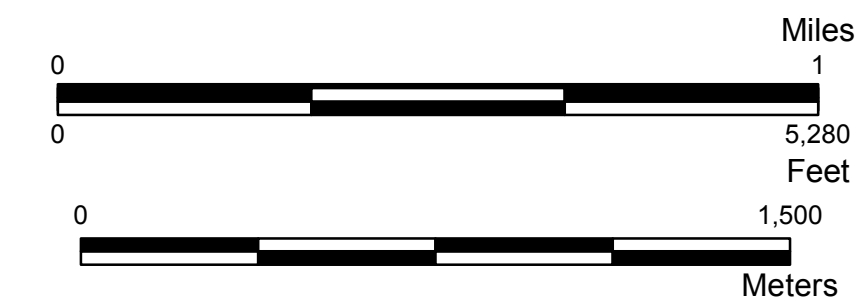
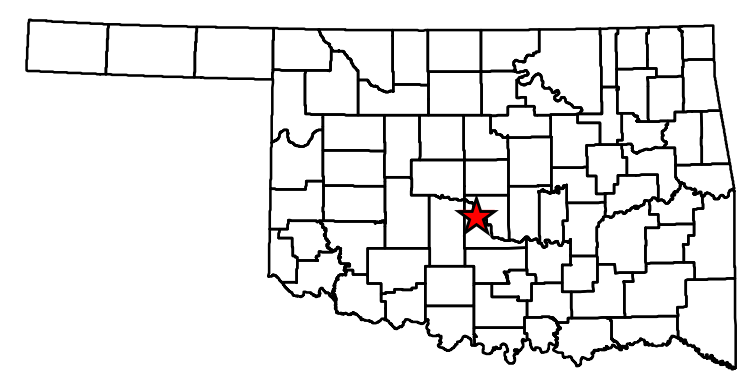
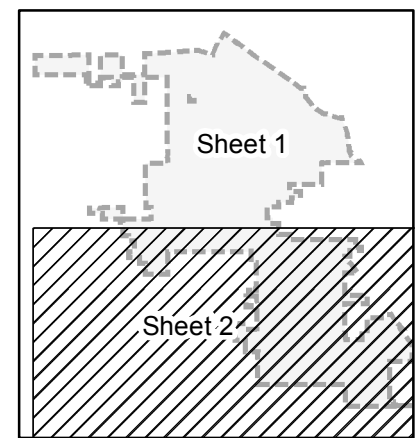

**STATE OF OKLAHOMA  
DEPARTMENT OF TRANSPORTATION**

**CITY OF  
GOLDSBY  
MCCLAIN COUNTY**

CENSUS YEAR 2010  
POPULATION 1,801

*Legend*

State Highway	Asphalt	County Line
U.S. Highway	Concrete	Section Line
Interstate	Gravel	Wildlife Management Area
Divided Highway, 4 or more lanes	Grade & Drain	Wildlife Refuge
Asphalt	Unimproved	River or Stream
Concrete	Railroad	Lake or Reservoir
	Corporate Limit	Bridges
	Goldsby	Low Water Crossing