

- (1) PARTRIDGE LN.
- (2) LARKSPUR LN.
- (3) INDIAN DR.
- (4) ROBIN RIDGE
- (5) S. HOOVER ST.
- (6) INDIAN CIR.
- (7) CANARY LN.
- (8) CANARY PL.
- (9) SUNNYBROOK LN.
- (10) SUNNYBROOK CIR.
- (11) QUAIL TRAIL
- (12) ROGERS TERRACE
- (13) CARDINAL PL.

- (1) B. CL.
- (2) C. CL.
- (3) E. CL.
- (4) CAMELOT DR.
- (5) WILSHIRE DR.
- (6) MOSHER DR.
- (7) THE OAKS ST.
- (8) MOCKINGBIRD LN.
- (9) W. WYNONA AVE.
- (10) VINTA AVE.
- (11) OSAGE AVE.
- (12) INDIAN TERRACE
- (13) ARAPAHO DR.
- (14) SIOUX AVE.
- (15) QUANNAH DR.
- (16) CHICKASAW DR.
- (17) PAWNEE AVE.
- (18) PONTIAC DR.
- (19) KIOWA DR.
- (20) SEMINOLE ST.
- (21) FIELD DR.
- (22) SEQUOYAH DR.
- (23) PARKWAY
- (24) NAVAJO PL.
- (25) KESTERFIELD BLVD
- (26) W. HUDSON DR.
- (27) WALLACE DR.
- (28) PAWNEE ST.
- (29) OSAGE AVE.
- (30) W. THOMPSON AVE.
- (31) MUNGER DR.
- (32) FOWLER ST.
- (33) S. WALLACE DR.
- (34) MEADOWLAKE GOLF COURSE
- (35) MEADOWLAKE
- (36) PARKWAY

- (1) MUNSEY ST.
- (2) CHANNEL ST.
- (3) BOOTH RD.
- (4) FIELDS ST.
- (5) WEAVER ST.
- (6) N. & S. BROWN RD.
- (7) BROWN PKWY
- (8) ANDERSON ST.
- (9)
- (10) GRITZ ST.
- (11) MANCOCK AVE.
- (12) WILLIAMS AVE.
- (13) GOAD ST.
- (14) MACH AVE.
- (15) CONWAY ST.
- (16) KLINE AVE.
- (17)
- (18)
- (19) GOTT RD.
- (20) BROWN PKWY
- (21)
- (22) BOOKS ST.
- (23) EDWARDS ST.
- (24) LEHR ST.
- (25) PARKER ST.
- (26) WOOLWINE ST.
- (27) HURST DR.
- (28) BASS DR.
- (29) WOODRING PKWY
- (30)
- (31) EAST ST.

**STATE OF OKLAHOMA**  
**DEPARTMENT OF TRANSPORTATION**

**CITY OF ENID**  
GARFIELD COUNTY  
CENSUS YEAR 2010  
POPULATION 49,379

**Legend**

	State Highway		Asphalt		County Line
	U.S. Highway		Concrete		State Line
	Interstate		Gravel		Section Line
	Divided Highway, 4 or more lanes		Grade & Drain		Wildlife Management Area
	Asphalt		Unimproved		Wildlife Refuge
	Concrete		Railroad		River or Stream
			Corporate Limit		Lake or Reservoir
			ENID		Bridges
					Low Water Crossing

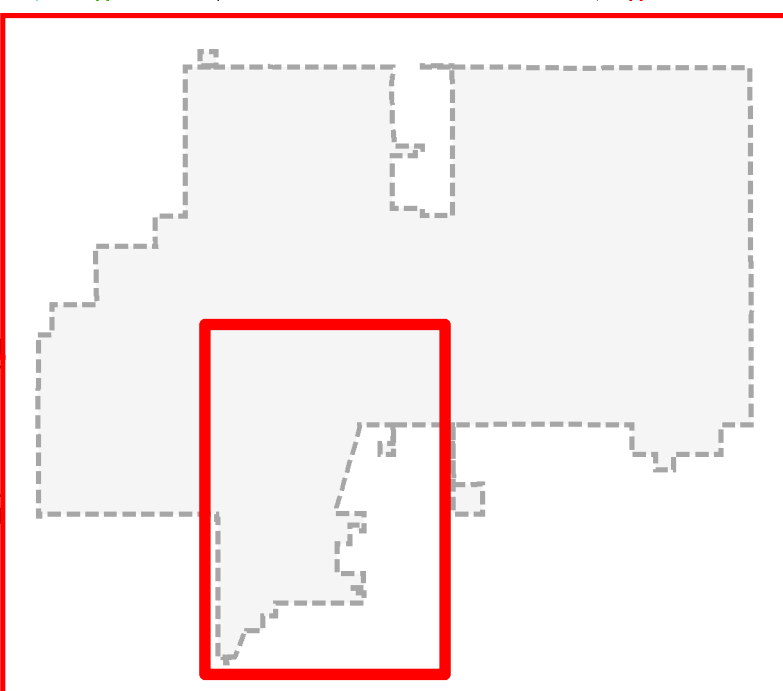
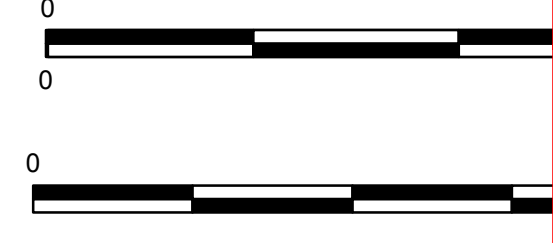
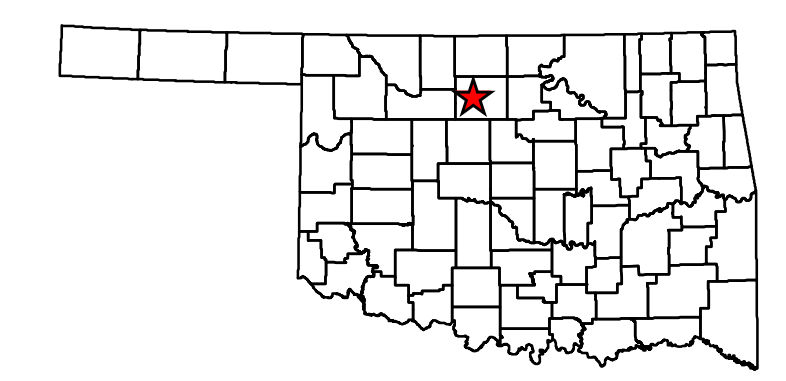



Copies of this map are available for public use at nominal cost.  
Address:  
OKLAHOMA DEPARTMENT OF TRANSPORTATION  
PRINTING SERVICES Phone (405) 521-2586  
200 N.E. 21st STREET  
OKLAHOMA CITY, OKLAHOMA 73105-3204

This map indicates those roads known to the Department to be open to public travel. Placement of a road on the map has no relationship to maintenance responsibility by any level of government.

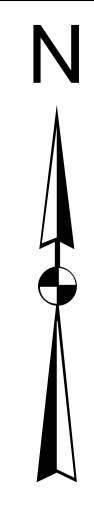
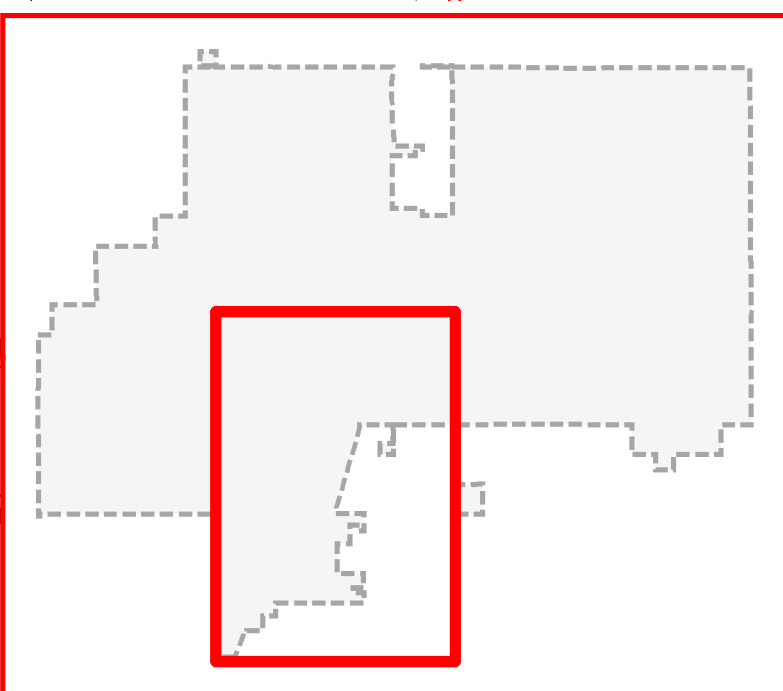
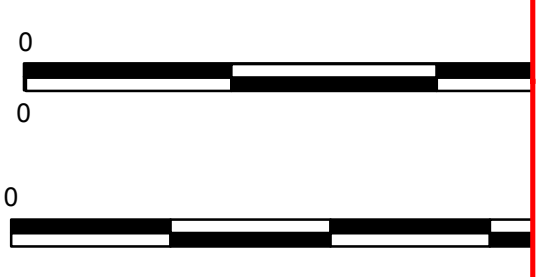
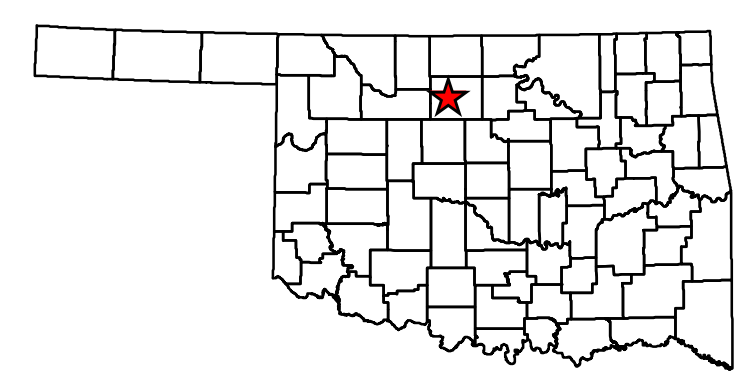
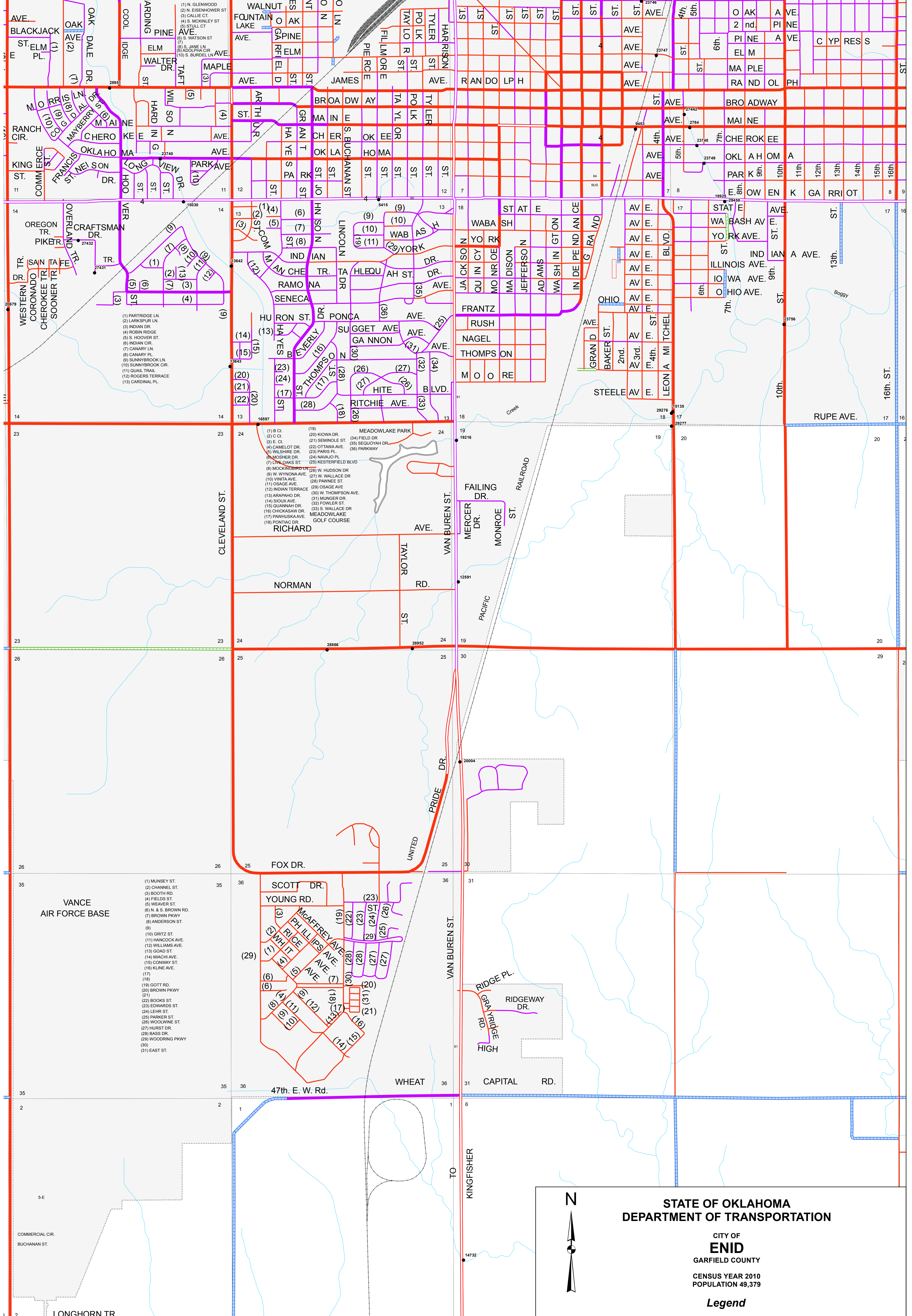

### STATE OF OKLAHOMA DEPARTMENT OF TRANSPORTATION

CITY OF  
**END**  
GARFIELD COUNTY  
CENSUS YEAR 2010  
POPULATION 49,379

#### Legend

- |  |                                  |  |                          |
|--|----------------------------------|--|--------------------------|
|  | State Highway                    |  | County Line              |
|  | U.S. Highway                     |  | State Line               |
|  | Interstate                       |  | Section Line             |
|  | Divided Highway, 4 or more lanes |  | Wildlife Management Area |
|  | Asphalt                          |  | Wildlife Refuge          |
|  | Concrete                         |  | River or Stream          |
|  | Gravel                           |  | Lake or Reservoir        |
|  | Grade & Drain                    |  | Bridges                  |
|  | Unimproved                       |  | Low Water Crossing       |
|  | Railroad                         |  |                          |
|  | Corporate Limit                  |  |                          |
|  | ENID                             |  |                          |



**STATE OF OKLAHOMA  
DEPARTMENT OF TRANSPORTATION**

**CITY OF  
ENID**  
GARFIELD COUNTY  
CENSUS YEAR 2010  
POPULATION 49,379

**Legend**

- |  |                                  |  |                          |
|--|----------------------------------|--|--------------------------|
|  | State Highway                    |  | County Line              |
|  | U.S. Highway                     |  | State Line               |
|  | Interstate                       |  | Section Line             |
|  | Divided Highway, 4 or more lanes |  | Wildlife Management Area |
|  | Asphalt                          |  | Wildlife Refuge          |
|  | Concrete                         |  | River or Stream          |
|  | Gravel                           |  | Lake or Reservoir        |
|  | Grade & Drain                    |  | Bridges                  |
|  | Unimproved                       |  | Low Water Crossing       |
|  | Railroad                         |  |                          |
|  | Corporate Limit                  |  |                          |
|  | ENID                             |  |                          |

Copies of this map are available for public use at nominal cost.  
Address:  
OKLAHOMA DEPARTMENT OF TRANSPORTATION  
PRINTING SERVICES Phone (405) 524-2586  
200 N.E. 21st STREET  
OKLAHOMA CITY, OKLAHOMA 73105-3204

This map indicates those roads known to the Department to be open to public travel. Placement of a road on the map has no relationship to maintenance responsibility by any level of government.

© COPYRIGHT 2018  
PRINTED AT STATE EXPENSE

**NOT FOR RESALE**

ALL RIGHTS RESERVED  
COMPUTER GENERATED  
ENID, GARFIELD COUNTY  
September 2018

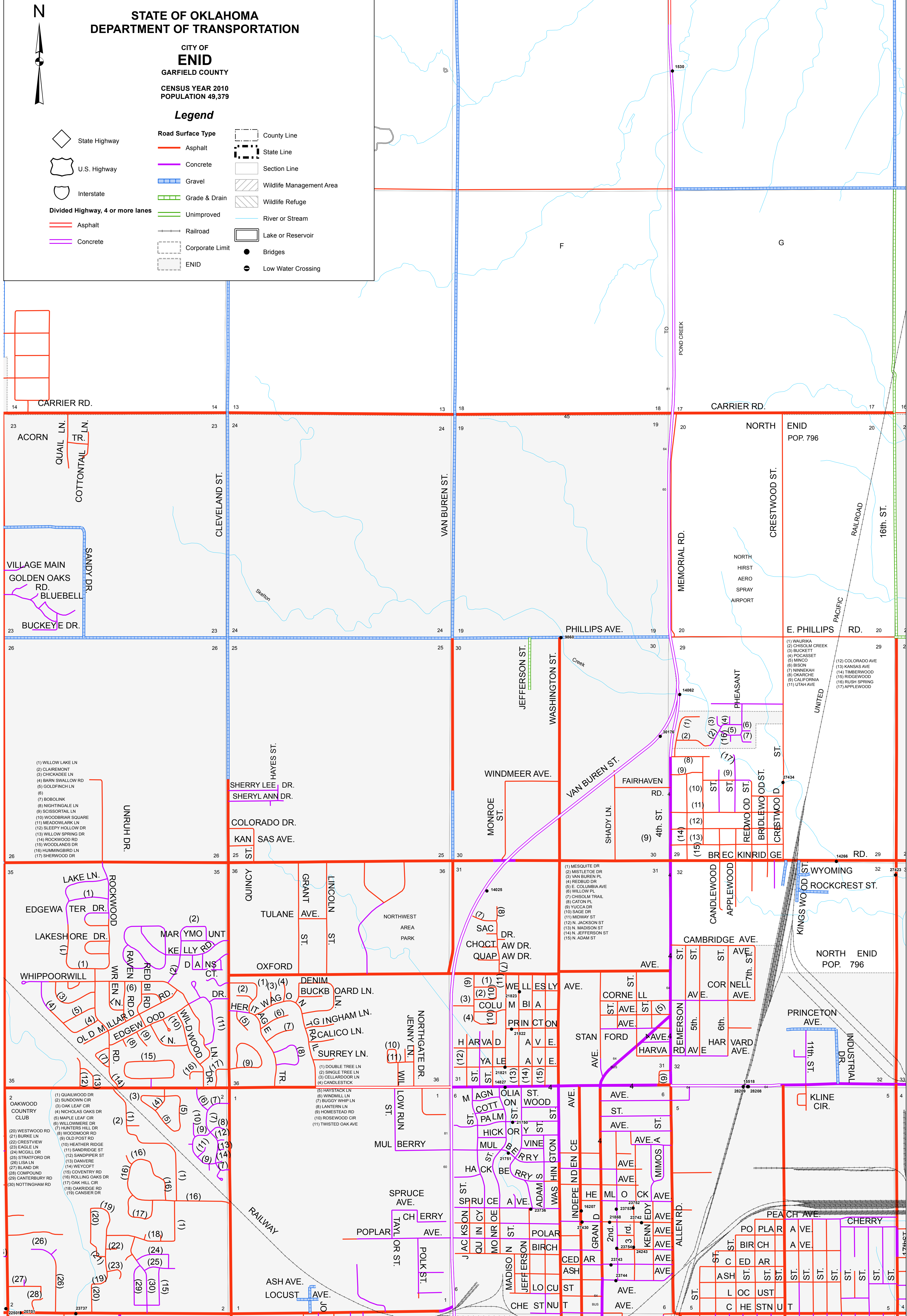

- (1) WILLOW LAKE LN
- (2) CLAREMONT
- (3) CHICKADEE LN
- (4) BARN SWALLOW RD
- (5) GOLDFINCH LN
- (6)
- (7) BOBOLINK
- (8) NIGHTINGALE LN
- (9) SCISSORTAIL LN
- (10) WOODBRIAR SQUARE
- (11) MEADOWLARK LN
- (12) SLEEPY HOLLOW DR
- (13) WILLOW SPRING DR
- (14) ROCKWOOD DR
- (15) WOODLANDS DR
- (16) HUMMINGBIRD LN
- (17) SHERWOOD DR

- (1) QUAILWOOD DR
- (2) SUNDOWN CIR
- (3) OAK LEAF CIR
- (4) NICHOLAS OAKS DR
- (5) MAPLE LEAF CIR
- (6) WILLOWMERE DR
- (7) HUNTERS HILL DR
- (8) WOODMOOR DR
- (9) OLD POST RD
- (10) HEATHER RIDGE
- (11) SANDRIDGE ST
- (12) SANDPIPER ST
- (13) DANVERE
- (14) WEYCOFF
- (15) COUNTRY RD
- (16) ROLLING OAKS DR
- (17) OAK HILL CIR
- (18) OAKRIDGE DR
- (19) CANSIER DR

- (1) MESQUITE DR
- (2) MISTLETOE DR
- (3) VAN BUREN PL
- (4) REDBUD DR
- (5) E. COLUMBIA AVE
- (6) WILLOW PL
- (7) CHISOLM TRAIL
- (8) CATON PL
- (9) YUCCA DR
- (10) SAGE DR
- (11) MIDDWAY ST
- (12) N. JACKSON ST
- (13) N. MADISON ST
- (14) N. JEFFERSON ST
- (15) N. ADAM ST

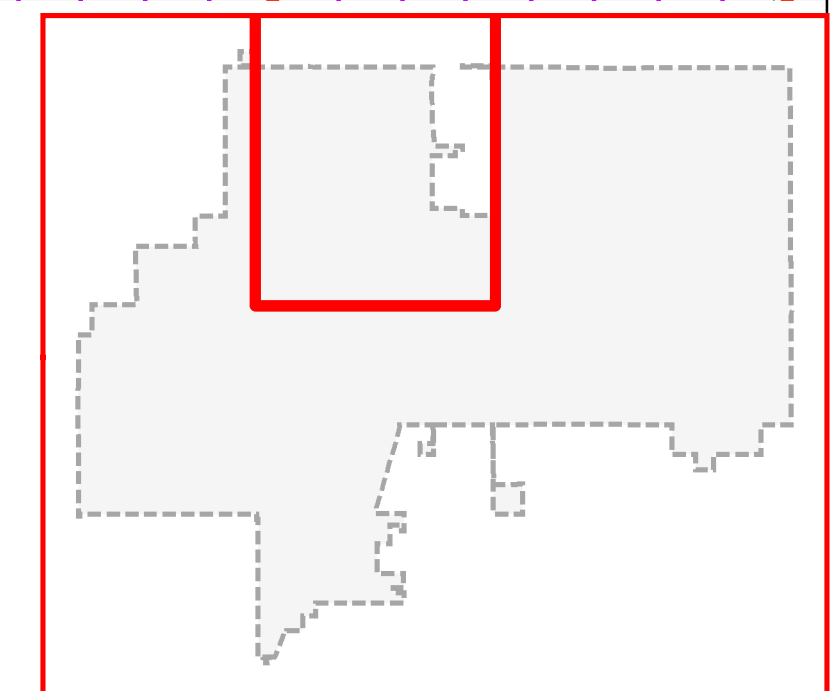
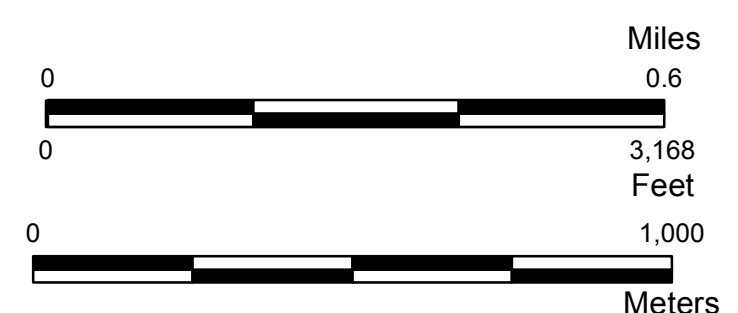
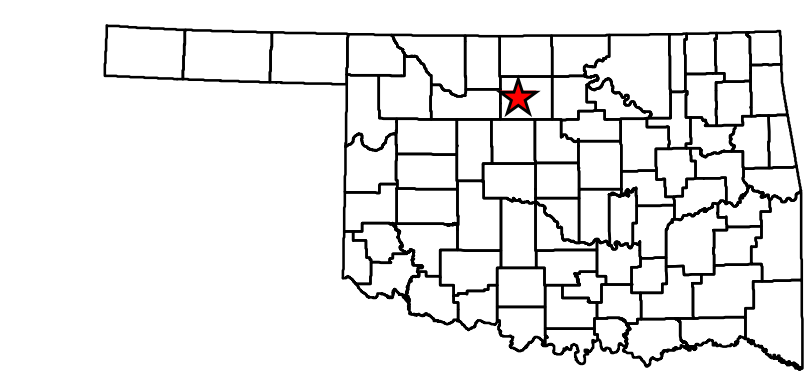



Copies of this map are available for public use at nominal cost.  
 Address:  
 OKLAHOMA DEPARTMENT OF TRANSPORTATION  
 PRINTING SERVICES Phone (405) 521-2586  
 200 N.E. 21st STREET  
 OKLAHOMA CITY, OKLAHOMA 73105-3204  
 ENID

This map indicates those roads known to the Department to be open to public travel. Placement of a road on the map has no relationship to maintenance responsibility by any level of government.  
 ENID

© COPYRIGHT 2018  
 PRINTED AT STATE EXPENSE

NOT FOR RESALE

ALL RIGHTS RESERVED  
 COMPUTER GENERATED  
 ENID, GARFIELD COUNTY  
 September 2018

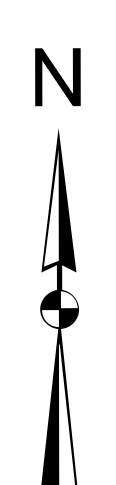
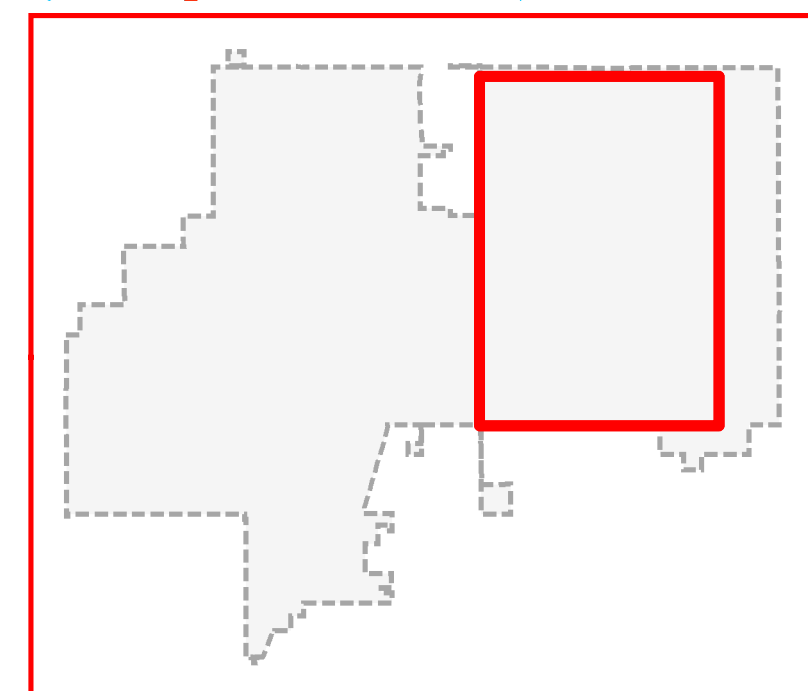
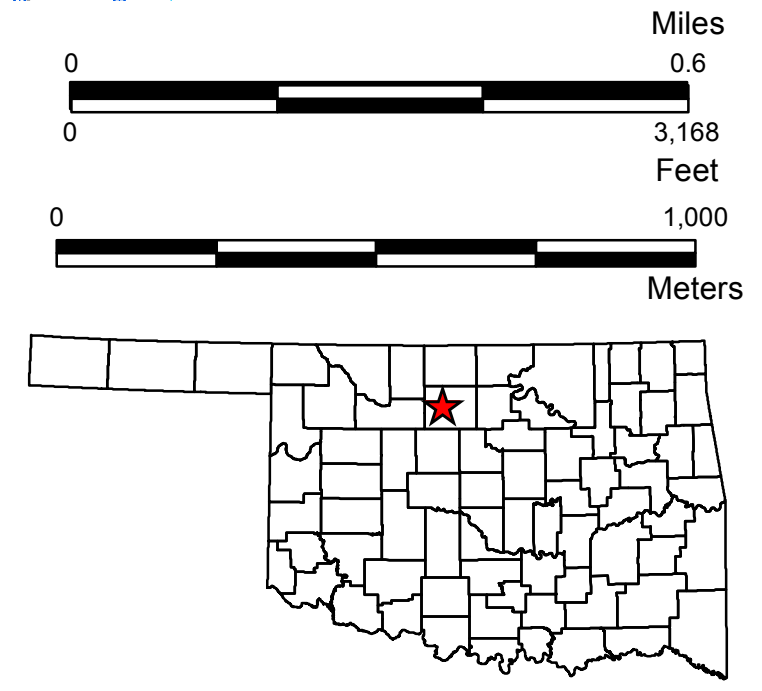
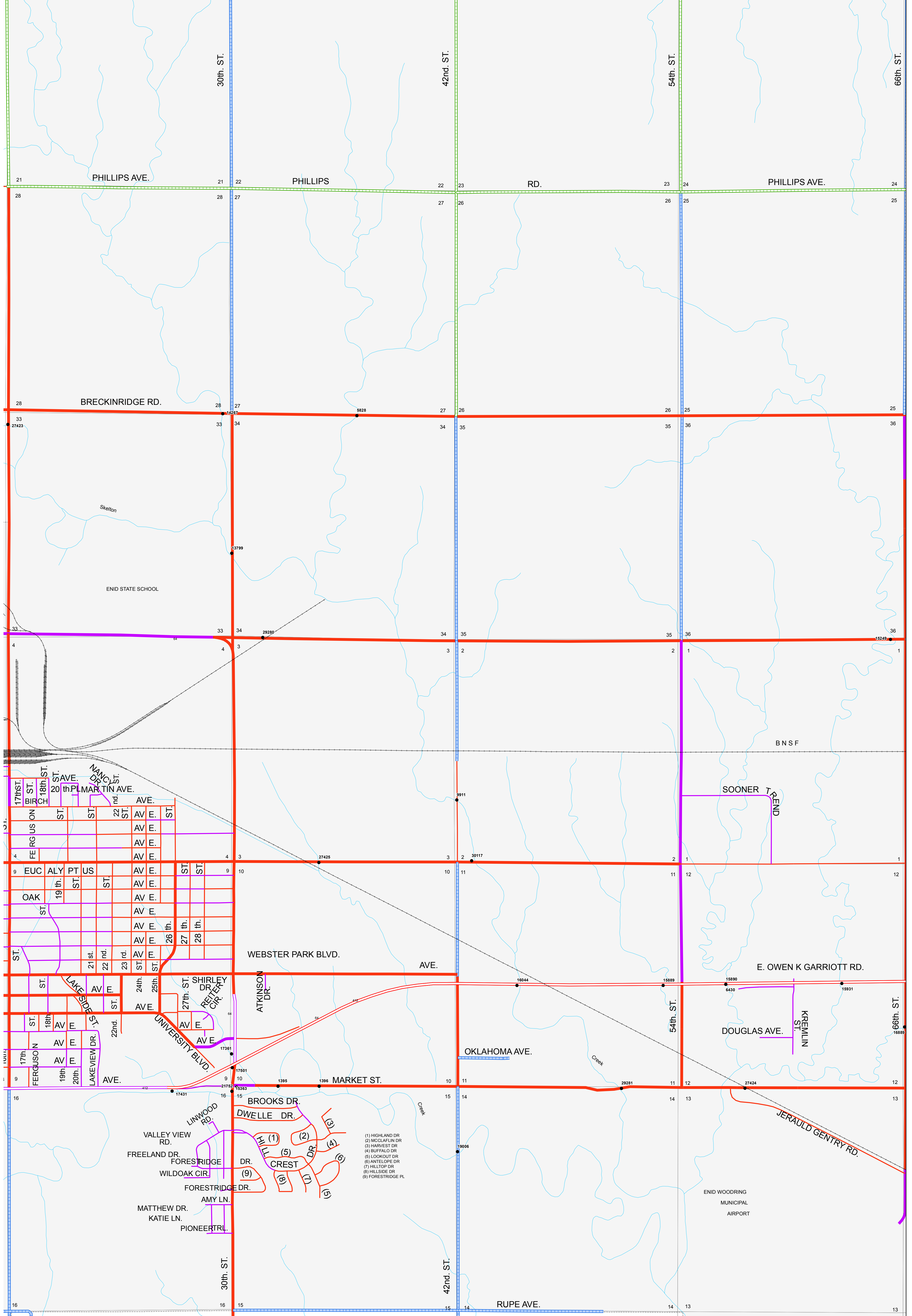

**STATE OF OKLAHOMA**  
**DEPARTMENT OF TRANSPORTATION**  
 CITY OF  
**ENID**  
 GARFIELD COUNTY  
 CENSUS YEAR 2010  
 POPULATION 49,379

Legend	
	State Highway
	U.S. Highway
	Interstate
	Divided Highway, 4 or more lanes
	Asphalt
	Concrete
	Gravel
	Grade & Drain
	Unimproved
	County Line
	State Line
	Section Line
	Wildlife Management Area
	Wildlife Refuge
	River or Stream
	Lake or Reservoir
	Bridges
	Low Water Crossing
	Railroad
	Corporate Limit
	ENID



Copies of this map are available for public use at nominal cost.  
 Address:  
 OKLAHOMA DEPARTMENT OF TRANSPORTATION  
 PRINTING SERVICES Phone (405) 521-2586  
 200 N.E. 21st STREET  
 OKLAHOMA CITY, OKLAHOMA 73105-3204

This map indicates those roads known to the Department to be open to public travel. Placement of a road on the map has no relationship to maintenance responsibility by any level of government.

© COPYRIGHT 2018  
 PRINTED AT STATE EXPENSE

NOT FOR RESALE

ALL RIGHTS RESERVED  
 COMPUTER GENERATED  
 ENID, GARFIELD COUNTY  
 September 2018

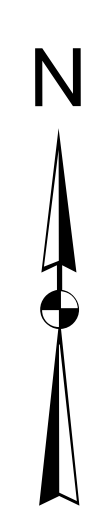
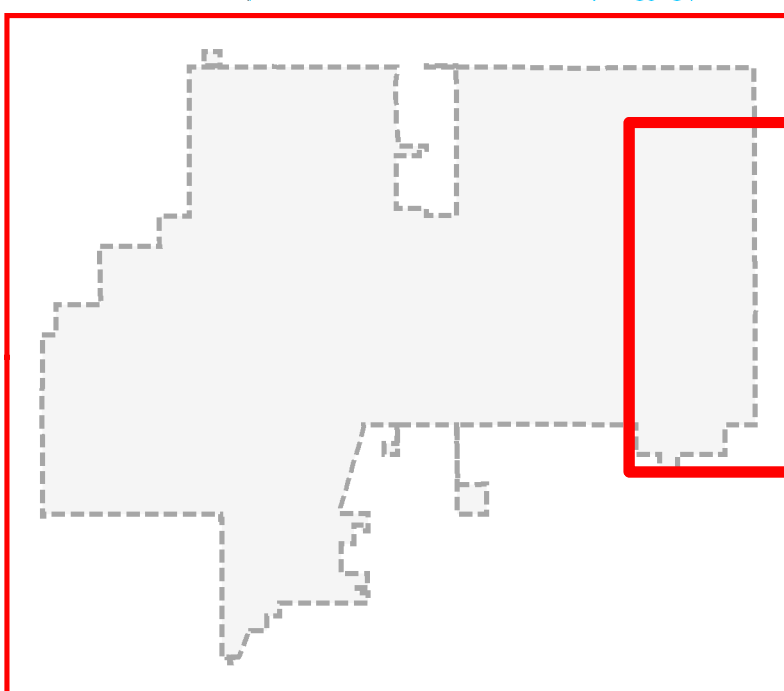
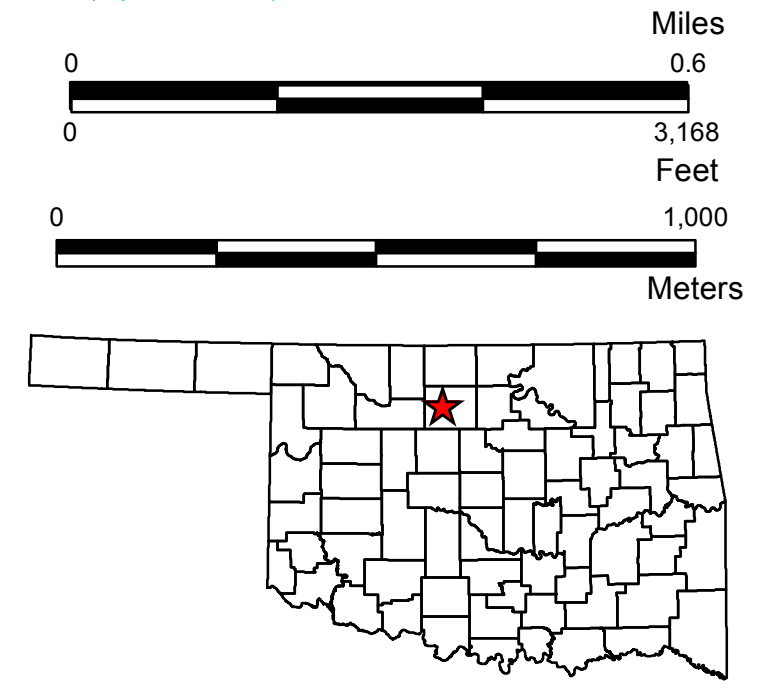
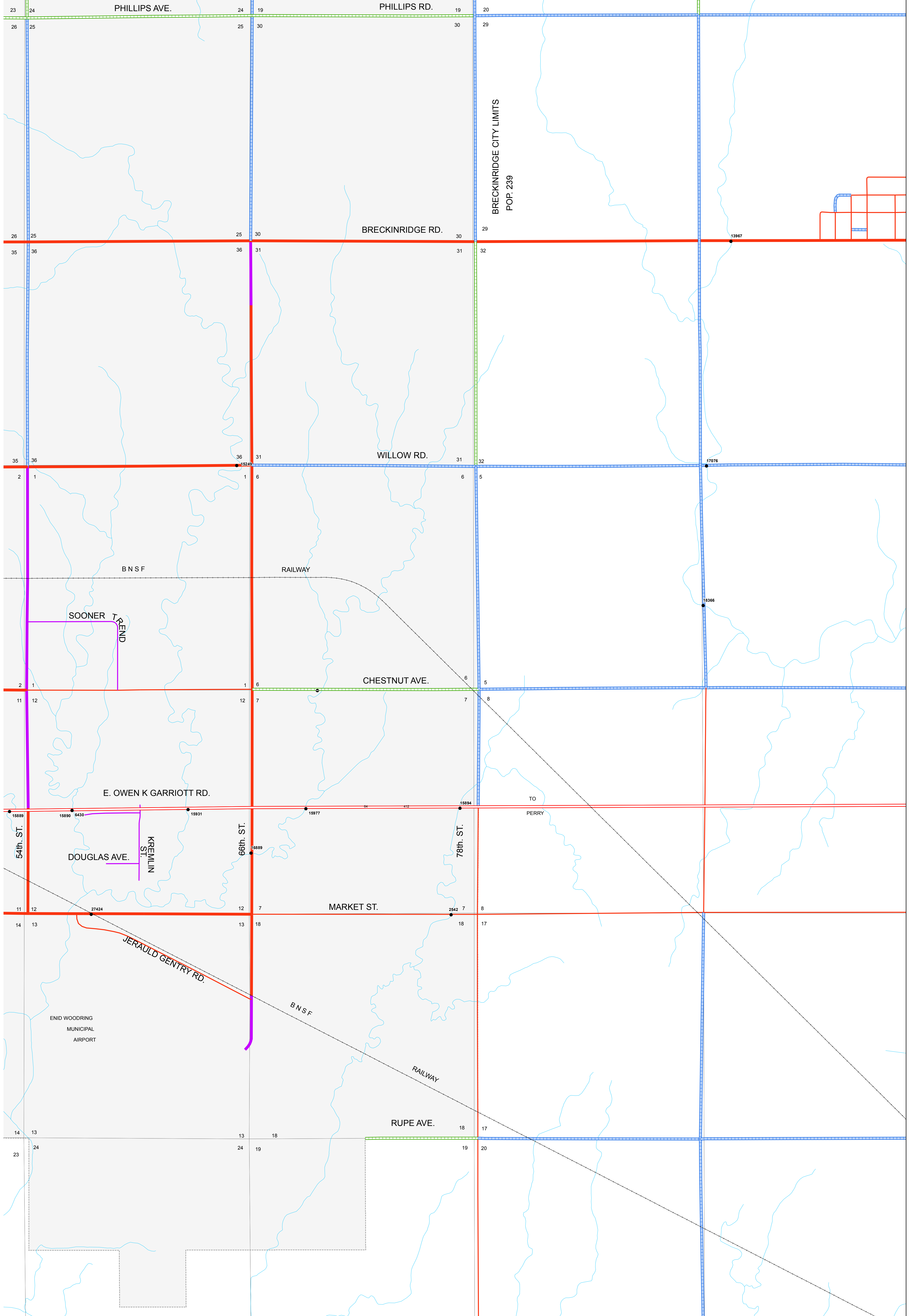

**STATE OF OKLAHOMA**  
**DEPARTMENT OF TRANSPORTATION**  
 CITY OF  
**ENID**  
 GARFIELD COUNTY  
 CENSUS YEAR 2010  
 POPULATION 49,379

Legend	
State Highway	County Line
Asphalt	State Line
Concrete	Section Line
Gravel	Wildlife Management Area
Grade & Drain	Wildlife Refuge
Unimproved	River or Stream
Divided Highway, 4 or more lanes	Lake or Reservoir
Asphalt	Bridges
Concrete	Low Water Crossing
Railroad	Corporate Limit
ENID	