

Copies of this map are available for public use at nominal cost.
 OKLAHOMA DEPARTMENT OF TRANSPORTATION
 PRINTING SERVICES Phone (405) 521-2586
 200 N.E. 21st STREET
 OKLAHOMA CITY, OKLAHOMA 73105-3204

This map indicates those roads known to the Department to be open to public travel. Placement of a road on the map has no relationship to maintenance responsibility by any level of government.

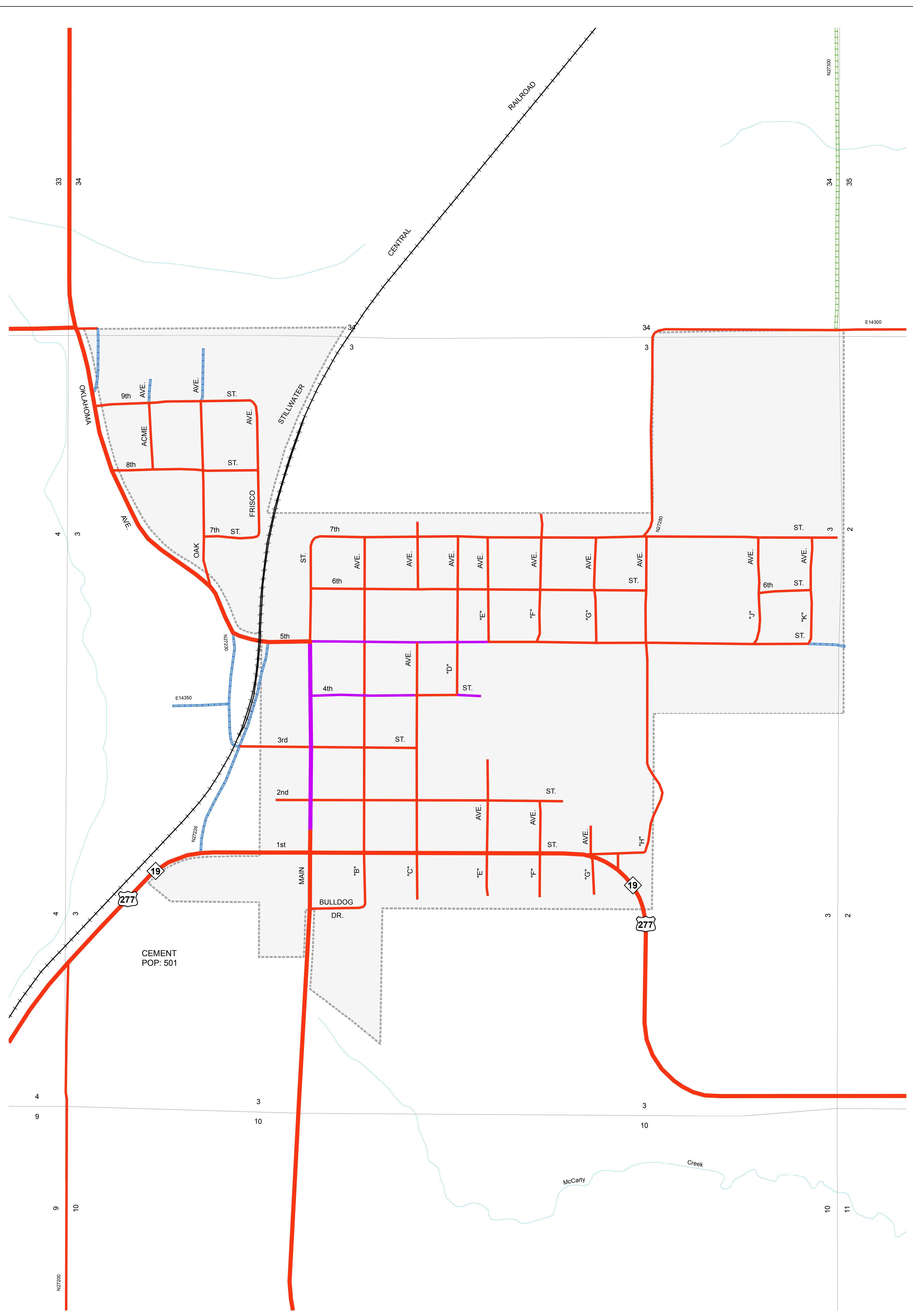

CEMENT
 POP: 501

Legend

- | | | | |
|--|----------------------------------|--|--------------------------|
| | Interstate | | Corporate Limit |
| | State | | CEMENT |
| | US | | County Line |
| | Railroad | | Section Line |
| | Divided Highway, 4 or more lanes | | Wildlife Management Area |
| | Asphalt | | Wildlife Refuge |
| | Concrete | | |
| | Gravel | | |
| | Grade & Drain | | |
| | Unimproved | | |

- Bridges
- Low Water Crossing
- River or Stream
- Lake or Reservoir

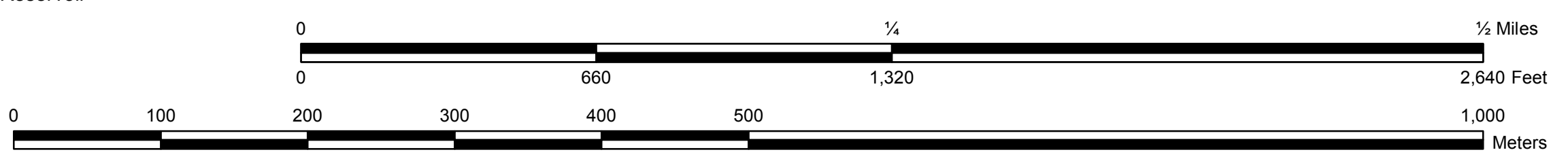
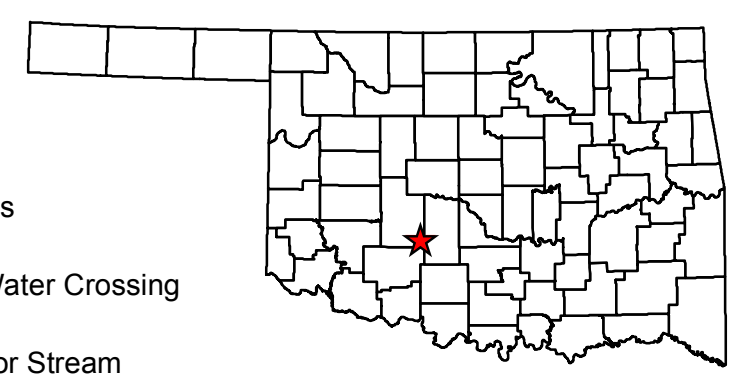

STATE OF OKLAHOMA
 DEPARTMENT OF TRANSPORTATION
 CITY OF
CEMENT
 CADDO COUNTY
 CENSUS YEAR 2010
 POPULATION 501