

BEGGS, OKMULGEE COUNTY  
 ALL RIGHTS RESERVED  
 COMPUTER GENERATED  
 September, 2018  
 NOT FOR RESALE  
 PRINTED AT STATE EXPENSE  
 © COPYRIGHT 2018  
 BEGGS  
 Copies of this map are available for public use at nominal cost.  
 OKLAHOMA DEPARTMENT OF TRANSPORTATION  
 PRINTING SERVICES Phone (405) 521-2566  
 200 N.E. 21st STREET  
 OKLAHOMA CITY, OKLAHOMA 73105-3204  
 This map indicates those roads known to the Department to be open to public travel. Placement of a road on the map has no relationship to maintenance responsibility by any level of government.

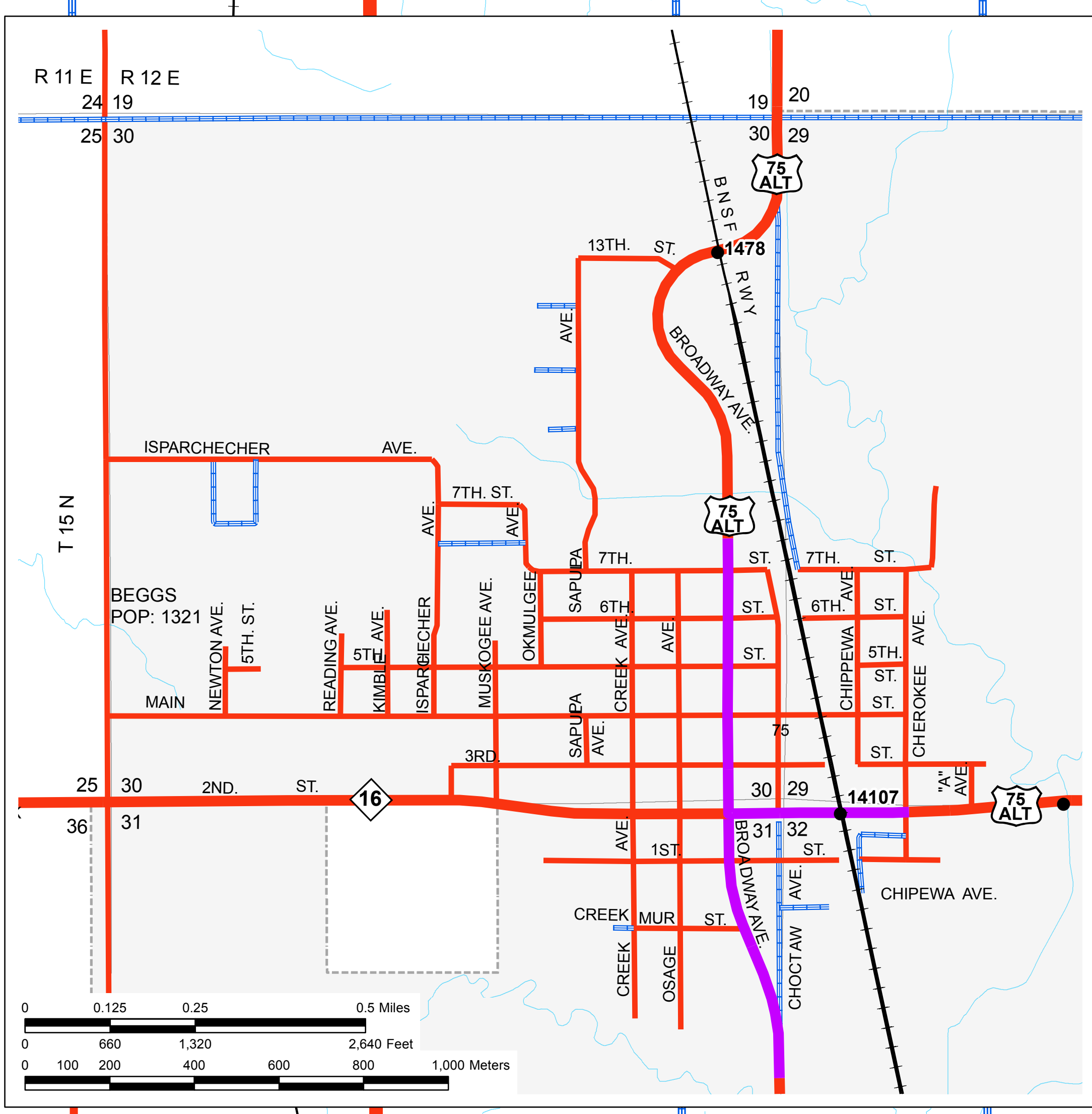
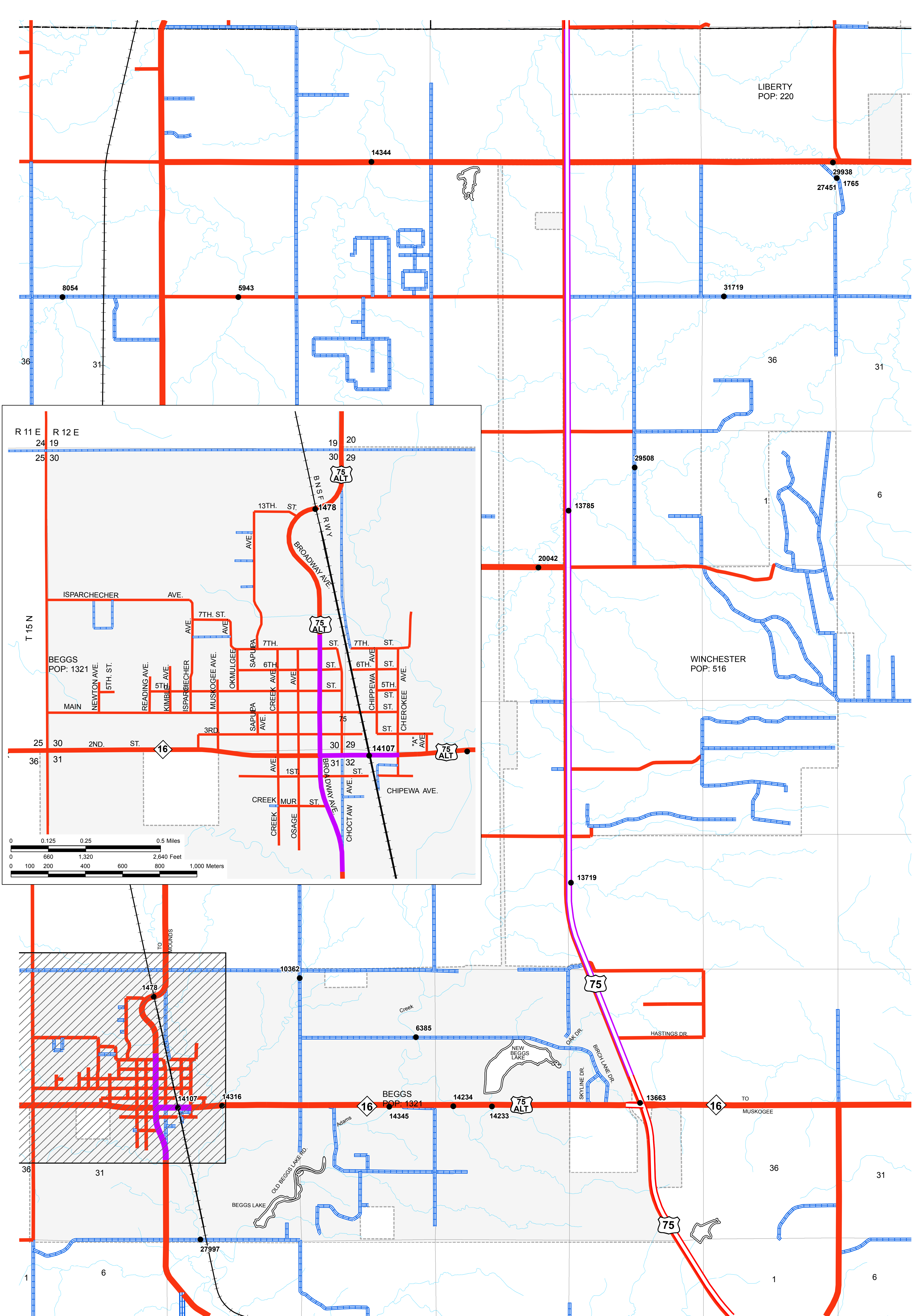

**Legend**

Interstate	<b>Road Surface Type</b>	Corporate Limit	Bridges
State	Asphalt	BEGGS	Low Water Crossing
US	Concrete	County Line	River or Stream
Railroad	Gravel	Section Line	Lake or Reservoir
<b>Divided Highway, 4 or more lanes</b>	Grade & Drain	Wildlife Management Area	
Asphalt	Unimproved	Wildlife Refuge	
Concrete			

**STATE OF OKLAHOMA**  
**DEPARTMENT OF TRANSPORTATION**

CITY OF  
**BEGGS**  
OKMULGEE COUNTY

CENSUS YEAR 2010  
POPULATION 1,321