

Copies of this map are available for public use at nominal cost.
 Address: REPRODUCTION BRANCH, Oklahoma Department of Transportation, 200 N.E. 27th Street, Oklahoma City, Oklahoma 73105.
 Public travel information is available from the Department to be given to motorists. This information is available to the public at nominal cost.

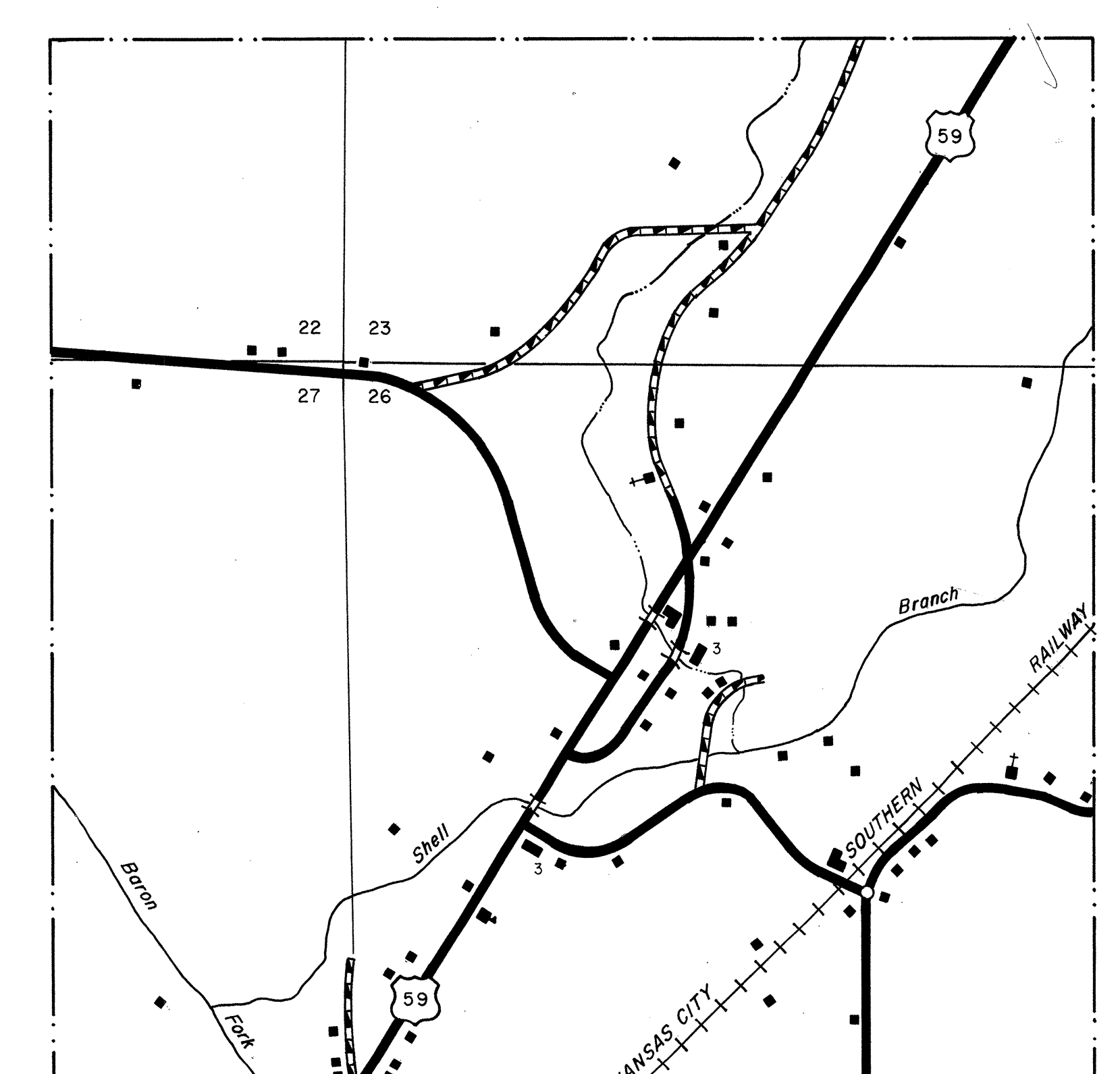
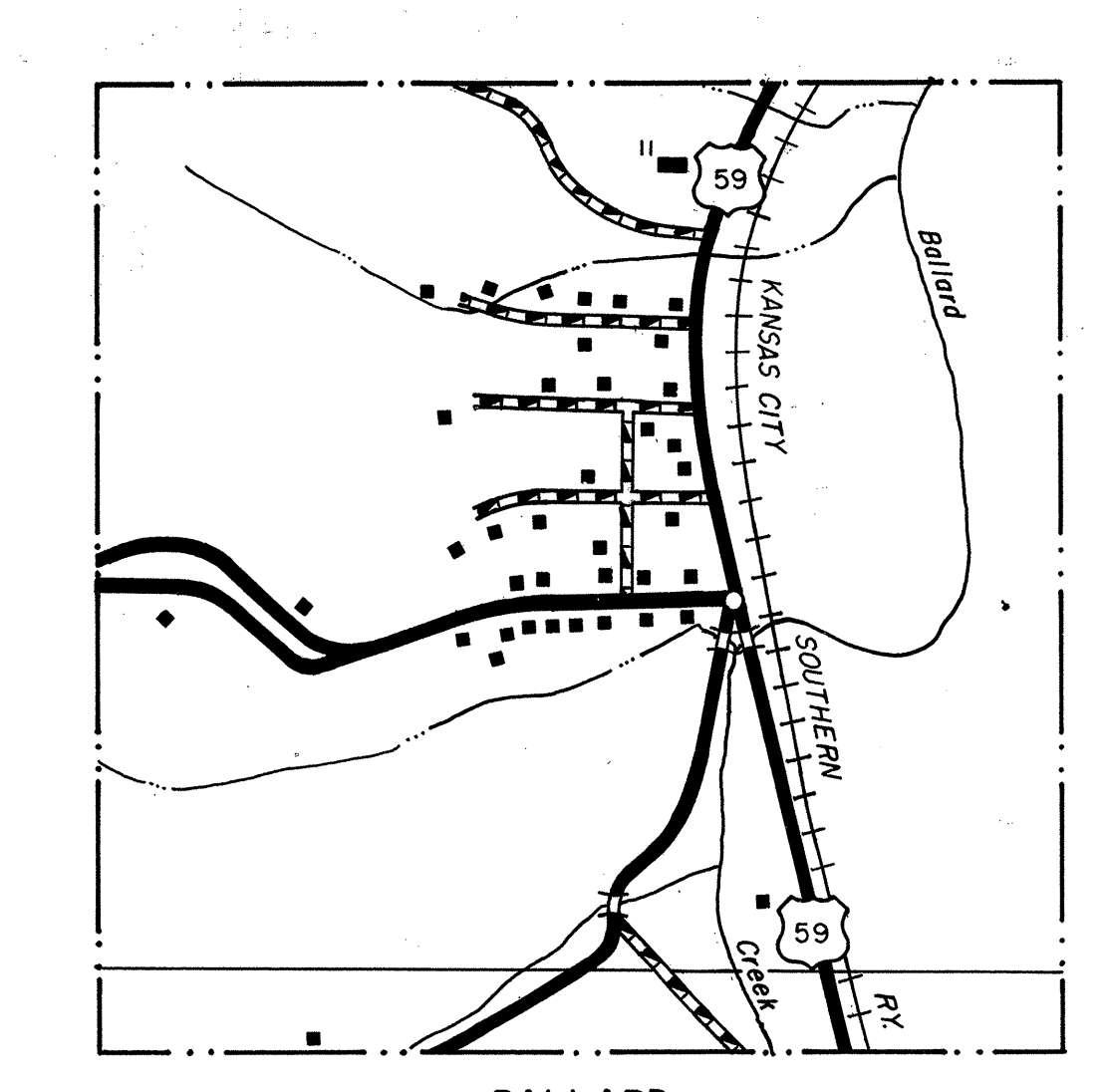
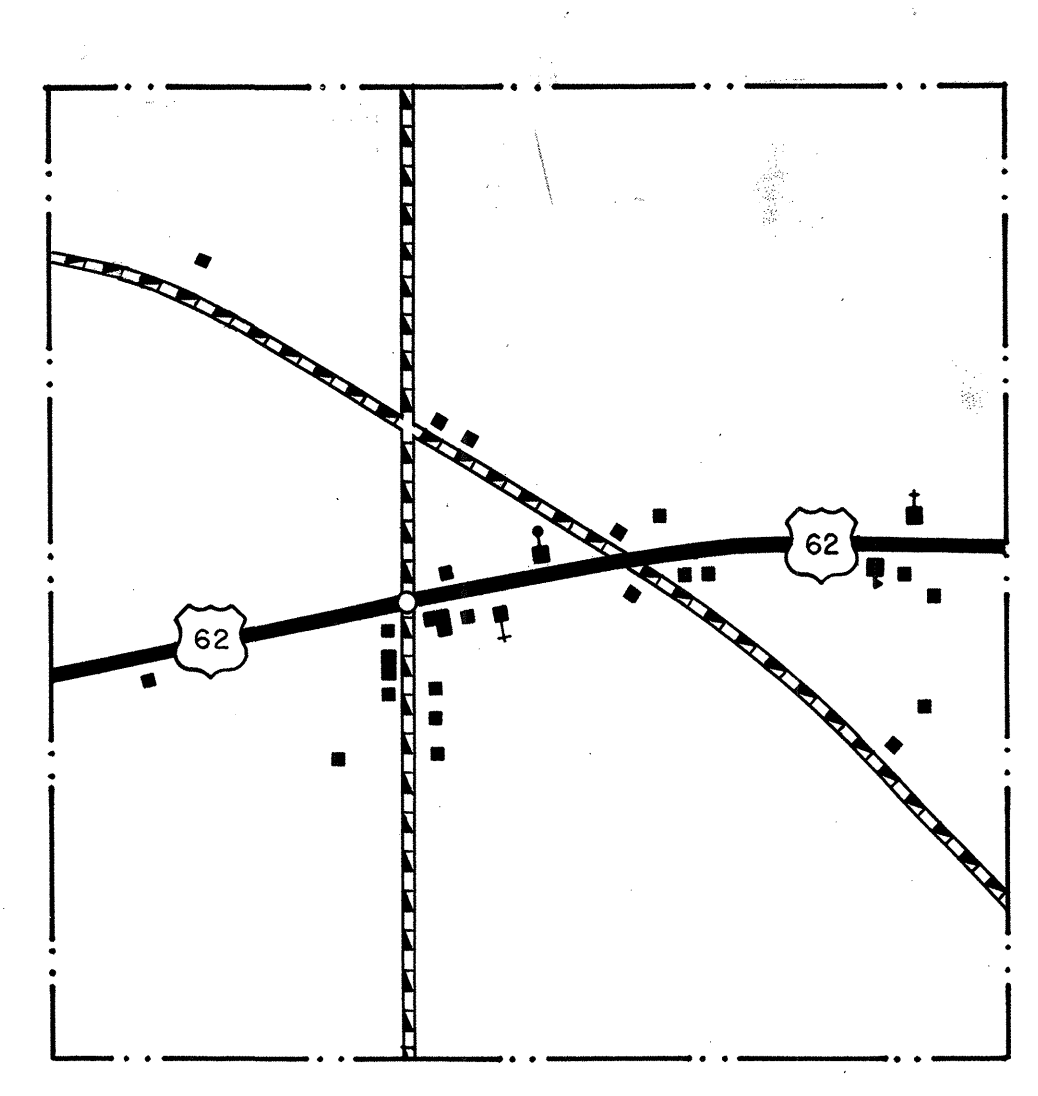
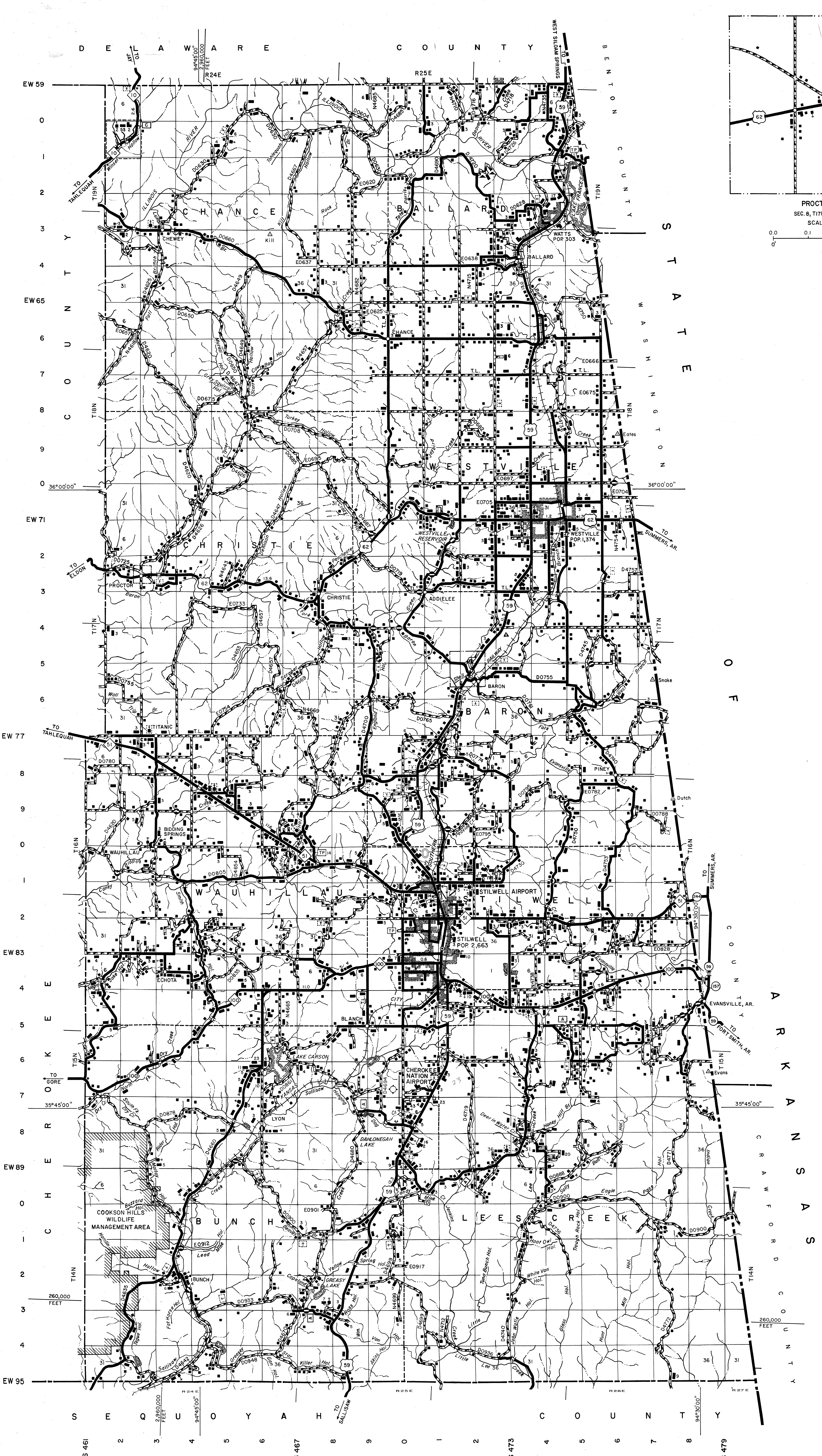

- LEGEND**
- U.S. NUMBERED HIGHWAY
 - STATE NUMBERED HIGHWAY
 - INTERSTATE HIGHWAY ROUTE
 - PAVED ROAD
 - GRAVEL ROAD
 - GRAVEL & DRAINED ROAD
 - UNIMPROVED ROAD
 - PRIMITIVE ROAD
 - PROJECTED ROAD
 - RESIDENTIAL ROAD
 - COUNTY ROAD ID NO.
 - RELEASE BETWEEN POINTS
 - DIVIDED HIGHWAY, 4 OR MORE LANES
 - TRAFFIC CIRCLE
 - HIGHWAY GRADE SEPARATION
 - TRAFFIC INTERCHANGE
 - STATE LINE
 - COUNTY LINE
 - CIVIL TOWNSHIP LINE
 - RURAL DEVELOPMENT AREA
 - GOVERNMENT PROPERTY LINE
 - MATCH LINE
 - COUNTY SEAT
 - TOWN CENTER
 - CORPORATE LIMITS
 - CIVIL TOWNSHIP, ROAD IN PLACE
 - INSET BOUNDARY
 - ELEVATION ABOVE SEA LEVEL
 - MOUNTAIN RANGE, BUTTE OR MESA
 - SMALL MOUNTAIN
 - MARSH OR SWAMP LANDS
 - DRAINAGE DITCH
 - IRRIGATION DITCH
 - LAKE, RESERVOIR OR POND WITH DAM
 - ROAD OVER DAM
 - DRY LAKE SUBJECT TO FLOOD
 - SMALL BRIDGES CLOSELY SPACED
 - HIGHWAY BRIDGE, OVER 20 FT. IN LENGTH
 - GENERAL BRIDGE, LONG CROSSING
 - ARCH BRIDGE
 - TRUSS BRIDGE, W. Wood, S. Steel, C. Concrete
 - CONCRETE DIP OR FORD
 - FORD ROAD ESTABLISHED
 - INTERMITTENT STREAM
 - NARROW STREAM
 - DOCK PIER OR LANDING
 - NAVIGABLE STREAM WITH LOCK & DAM
 - WIDE STREAM OR RIVER
 - TRIANGULATION STATION
 - RAILROAD, ANY NUMBER OF TRACKS
 - RAILROAD WITH STATIONS INDICATED
 - GRADE CROSSING
 - UNDERPASS, R.R. ABOVE
 - OVERPASS, R.R. BELOW
 - RAILROAD ON STREET
 - MILITARY AIRFIELD
 - AIRPORT WITH COMPLETE FACILITIES
 - AIRPORT WITH LIMITED FACILITIES
 - LANDING STRIP, PRIVATE FIELD
 - AIRPORT, GENERAL OUTLINE OF FIELD
 - RUNWAYS SHOWN IN POSITION
 - ROADSIDE PARK, Picnic Grounds
 - PLAYGROUNDS
 - BATHING BEACH OR SWIMMING POOL
 - SCENIC SITE
 - MOTEL
 - CAMP OR LODGE, Permanent With Buildings
 - SMALL PARK, M.P., Municipal, T.P., Trailer Park
 - FOREST WARDEN STATION
 - OBSERVATION OR LOOKOUT TOWER
 - CAMP SITE
 - FISH HATCHERY
 - GOLF COURSE OR COUNTRY CLUB
 - ATHLETIC FIELD OR AMUSEMENT PARK
 - FAIRGROUNDS, RACE COURSE
 - DWELLING
 - NUMBER OF DWELLINGS CLOSELY SPACED
 - COMBINED BUSINESS AND DWELLING
 - POST OFFICE
 - POST OFFICE COMBINATIONS
 - SEASONAL DWELLINGS
 - CHURCH OR OTHER RELIGIOUS BUILDING
 - CEMETERY
 - CHURCH WITH CEMETERY ADJACENT
 - REST HOME
 - HOSPITAL
 - SMALL BUSINESS
 - INDUSTRY
 - SAW MILL
 - MINI SHUTTLE OR DRIFT
 - OIL OR GAS FIELD
 - Gauging or Pumping Station
 - WAREHOUSE
 - GRAVEL PIT
 - QUARRY
 - SCHOOL
 - COMMUNITY HALL OR LODGE
 - DRIVE-IN THEATER
 - CORRECTIONAL INSTITUTION
 - HIGHWAY GARAGE
 - JUNK YARDS & DUMPS, A-Automobile, B-Score Building Materials, D-Refuse, Garbage or Trash Dump, F-Sewerage, G-Other
 - SEWAGE DISPOSAL PLANT
 - WATER SUPPLY STAND PIPE
 - POWER PLANT
 - POWER SUBSTATION
 - TELEVISION OR RADIO STATION
 - MILITARY INSTALLATION

GENERAL HIGHWAY MAP ADAIR COUNTY OKLAHOMA

PREPARED BY THE
 OKLAHOMA DEPARTMENT OF TRANSPORTATION
 PLANNING DIVISION

IN COOPERATION WITH THE
 U.S. DEPARTMENT OF TRANSPORTATION
 FEDERAL HIGHWAY ADMINISTRATION

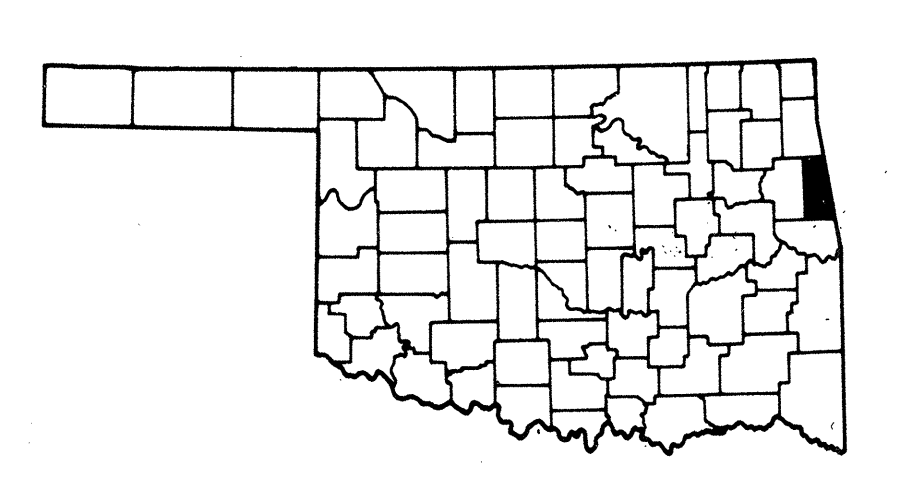
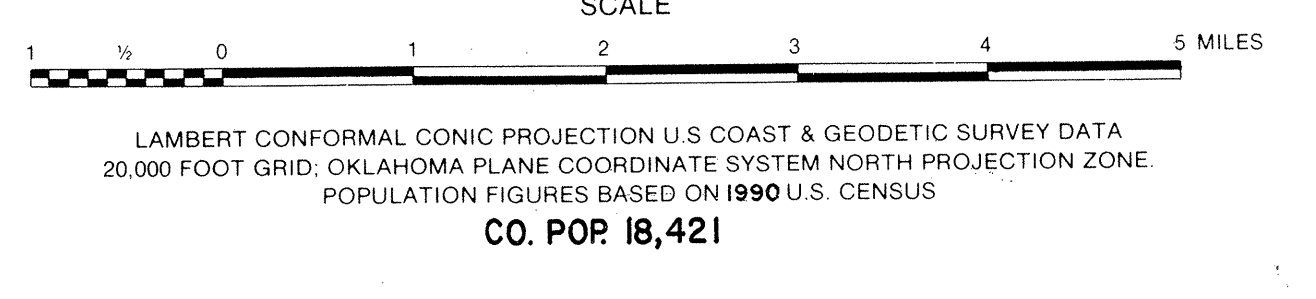

ALL DATA CURRENT TO
 DATE OF INVENTORY
 FEB. 1988
 ORIGINAL DRAFTING BY R.G.R., JAN. 1992
 STATE SYSTEM REVISED TO JAN. 1992

GENERAL HIGHWAY MAP ADAIR COUNTY OKLAHOMA