

Copies of this map are available for public use at nominal cost.
 ADDRESS: DEPARTMENT OF TRANSPORTATION
 OKLAHOMA RELOCATION BRANCH (PHONE - 52-2586)
 200 N.E. 21ST STREET
 OKLAHOMA CITY, OKLA. 73105

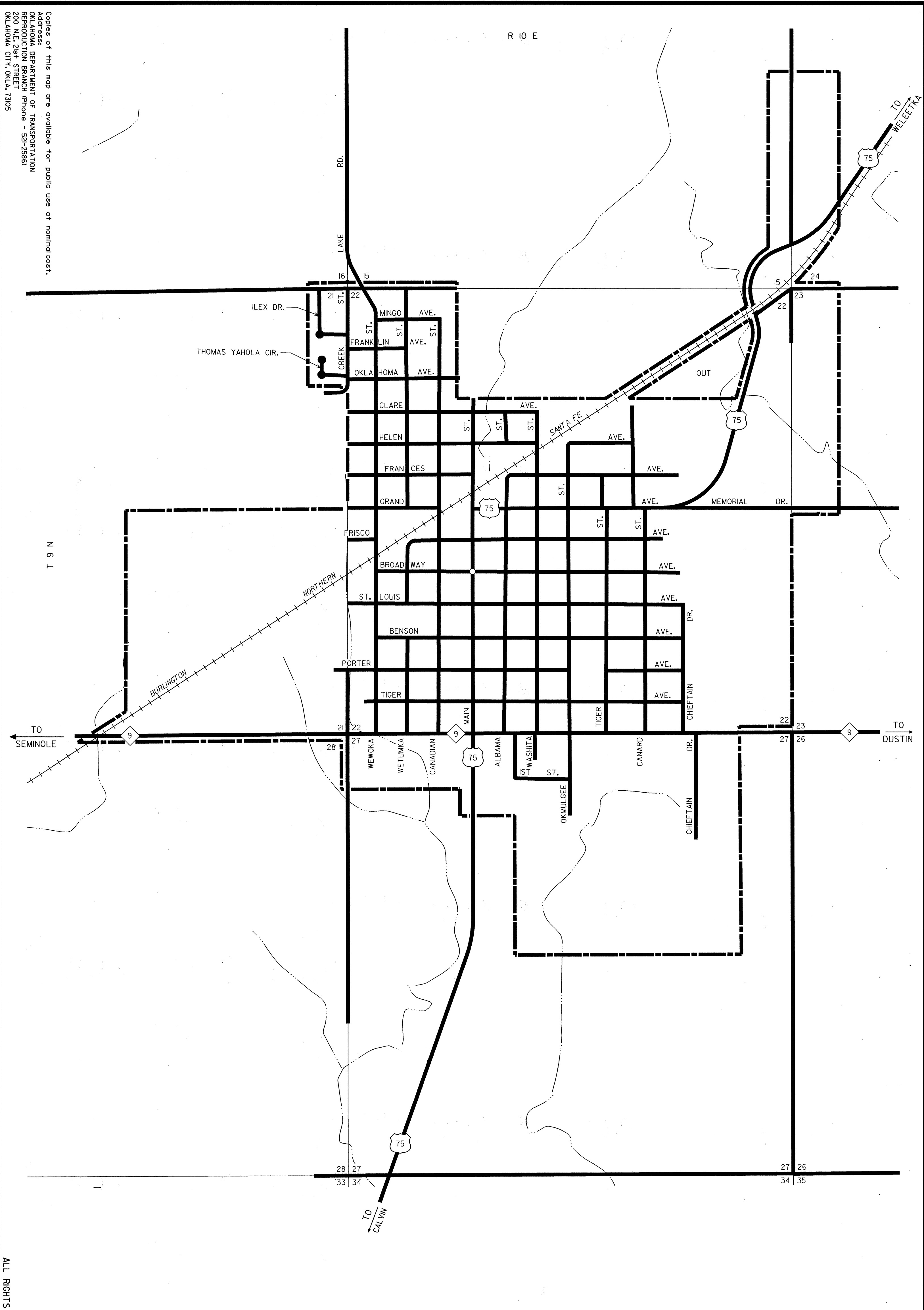

ALL RIGHTS RESERVED COMPUTER GENERATED APRIL, 1995
 WETUMKA, HUGHES CO.

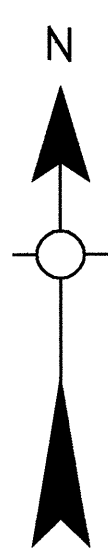

STATE OF OKLAHOMA
 DEPARTMENT OF TRANSPORTATION
 CITY OF
WETUMKA
 HUGHES COUNTY
 1990
 POPULATION
 1,427
 SCALE
 0.0 0.1 0.2 0.3 0.4 0.5 MILE
 0 660 1,320 2,640 FEET

LEGEND
 CORPORATE LIMITS
 STATE NUMBERED ROUTES
 U.S. NUMBERED ROUTES
 INTERSTATE ROUTES