

R 17 E

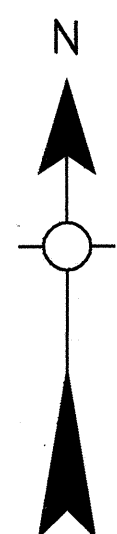

STATE OF OKLAHOMA
 DEPARTMENT OF TRANSPORTATION
 CITY OF
PORTER
 WAGONER COUNTY
 1990
 POPULATION
 588

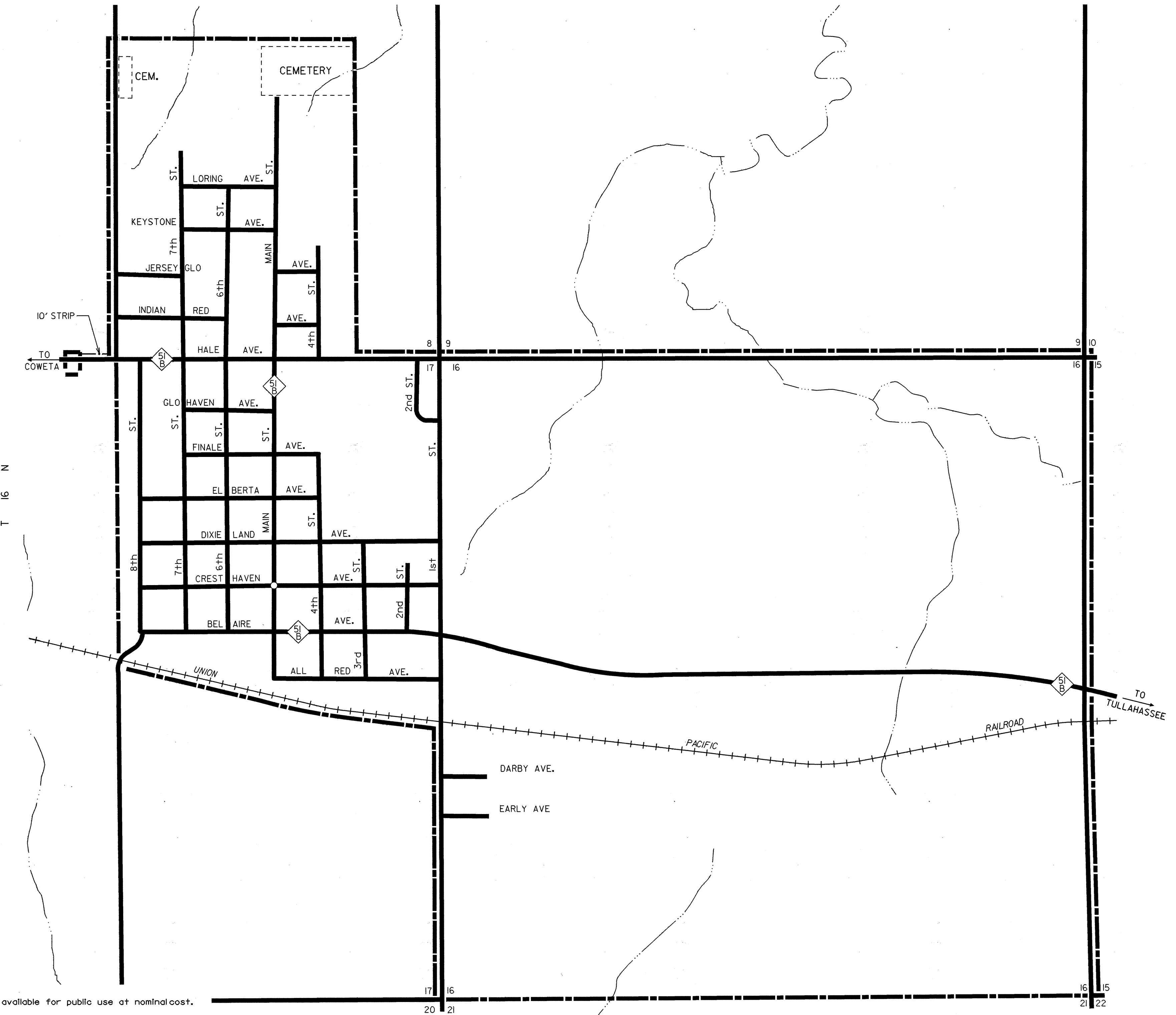
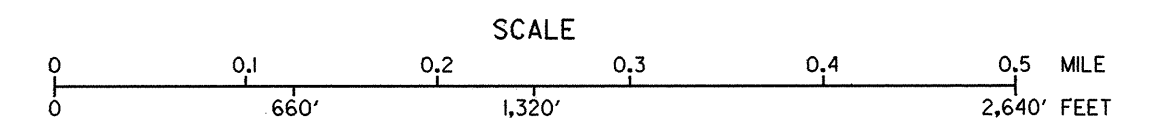

LEGEND
 CORPORATE LIMITS
 STATE NUMBERED ROUTES
 U.S. NUMBERED ROUTES
 INTERSTATE ROUTES

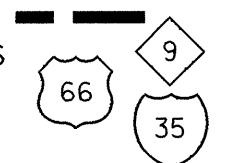

Copies of this map are available for public use at nominal cost.
 Address:
 OKLAHOMA DEPARTMENT OF TRANSPORTATION
 REPRODUCTION BRANCH (Phone - 521-2586)
 200 N.E. 21st STREET
 OKLAHOMA CITY, OKLA. 73105

ALL RIGHTS RESERVED

JUNE, 1995

PORTER, WAGONER CO.