

Copies of this map are available for public use at nominal cost
 Address:
 OKLAHOMA DEPARTMENT OF TRANSPORTATION
 REPRODUCTION BRANCH (Phone - 521-2586)
 200 N. E. 21st STREET
 OKLAHOMA CITY OKLA. 73105

R 15 E R 16 E

N 28 T N 27 T

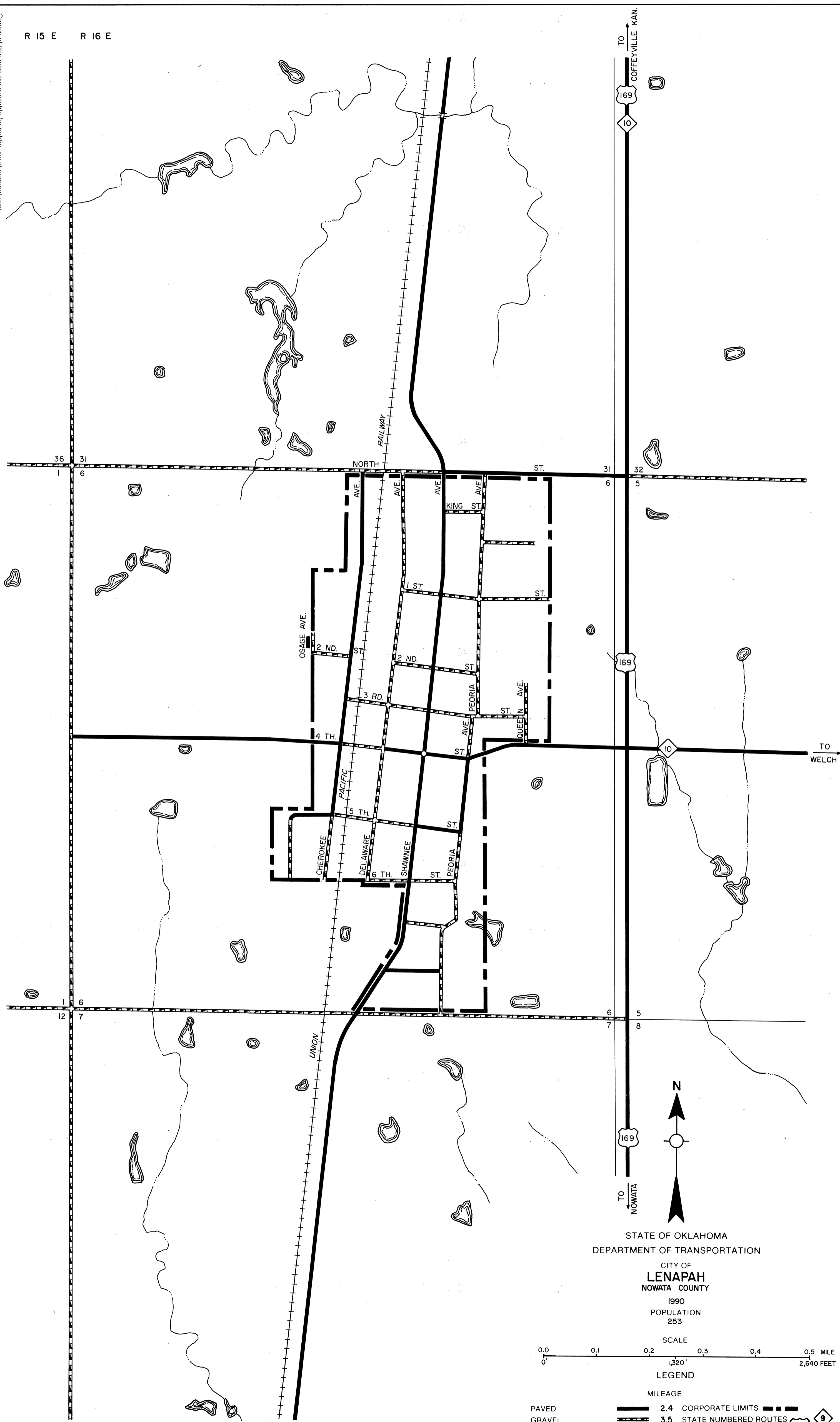

TO COFFEYVILLE KAN.
 169
 10
 TO NOWATA
 169
 TO WELCH

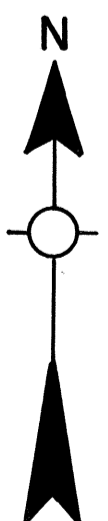

STATE OF OKLAHOMA
 DEPARTMENT OF TRANSPORTATION

CITY OF
LENAPAH
 NOWATA COUNTY

1990
 POPULATION
 253

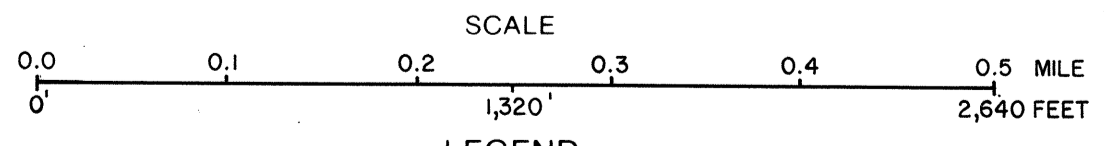

LEGEND

PAVED	2.4	CORPORATE LIMITS	---
GRAVEL	3.5	STATE NUMBERED ROUTES	---
GRADED & DRAINED	0.0	U.S. NUMBERED ROUTES	66
UNIMPROVED	0.0	INTERSTATE ROUTES	35
TOTAL STREETS & HIGHWAYS	5.9	STREETS	5.9
		HIGHWAYS	0.0

ALL RIGHTS RESERVED

LENAPAH, NOWATA CO.

JAN. 1989