

Copies of this map are available for public use at nominal cost.
 Address:
 OKLAHOMA DEPARTMENT OF TRANSPORTATION
 REPRODUCTION BRANCH (Phone - 521-2586)
 200 N. E. 21st STREET
 OKLAHOMA CITY, OKLA. 73105

R 16 E R 17 E

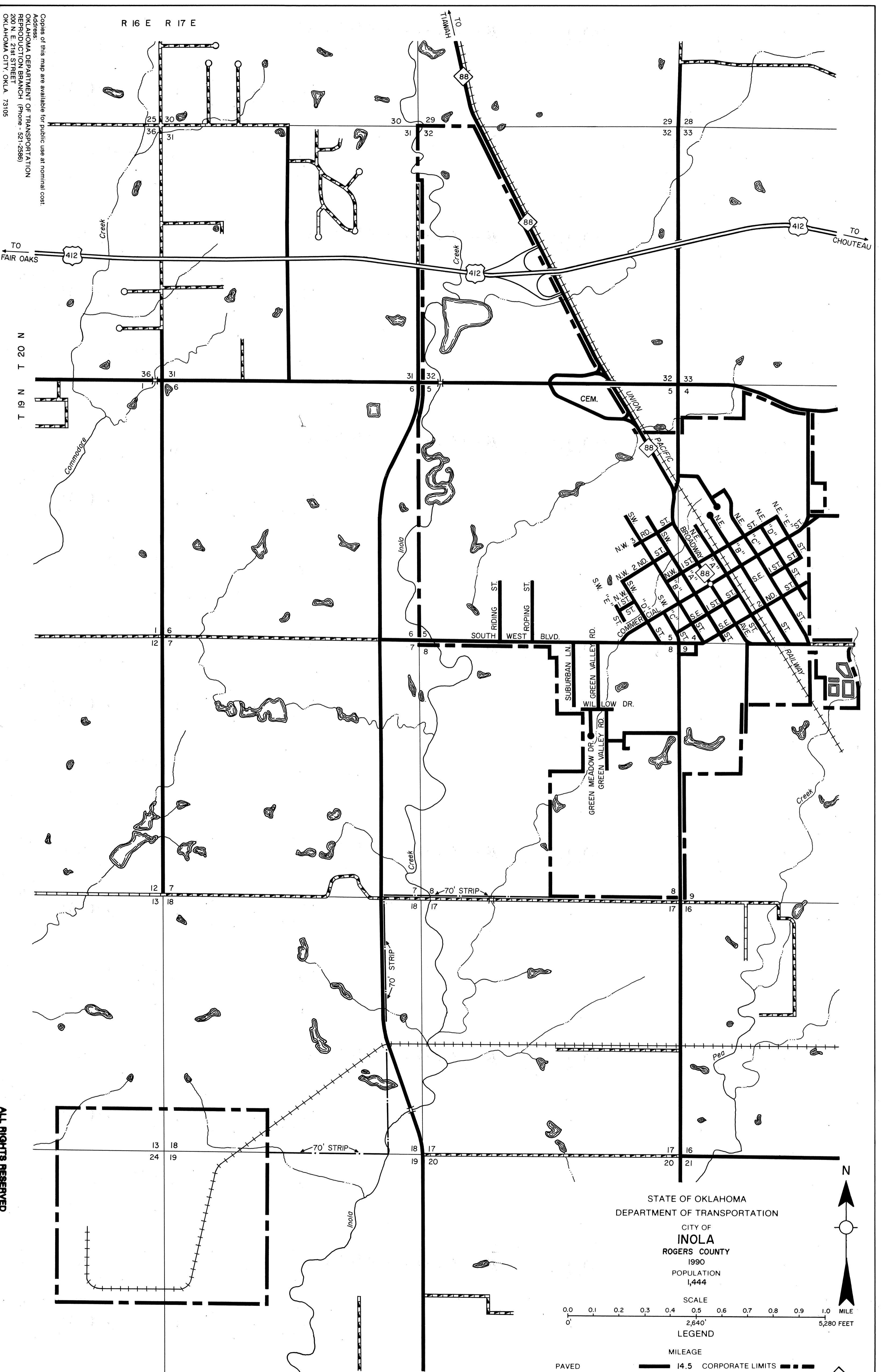

STATE OF OKLAHOMA
 DEPARTMENT OF TRANSPORTATION

CITY OF
INOLA
 ROGERS COUNTY
 1990
 POPULATION
 1,444

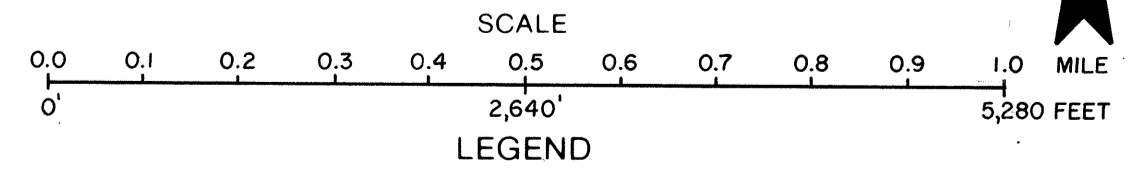

LEGEND

MILEAGE	
PAVED	14.5
GRAVEL	0.1
GRADED & DRAINED	0.0
UNIMPROVED	0.0
TOTAL STREETS & HIGHWAYS	14.6
CORPORATE LIMITS	13.7
STATE NUMBERED ROUTES	0.9
U.S. NUMBERED ROUTES	0.0
INTERSTATE ROUTES	0.0
STREETS	13.7
HIGHWAYS	0.9

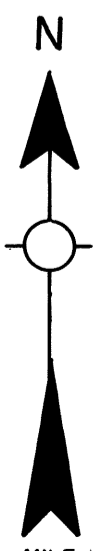

ALL RIGHTS RESERVED

INOLA, ROGERS CO.
 APRIL, 1989