

R 25 E

TO IDABEL

3

14 13

23 24

ST. COUNTY

ST.

SEVENTH ST.

PINE ST.

SIXTH ST.

FIFTH ST.

FOURTH ST.

THIRD ST.

STILES ST.

GILBERT ST.

ARKANSAS AVE.

STILES ST.

GILBERT ST.

CHOC TAW AVE.

RAILROAD AVE.

ELM ST.

PINE ST.

FIRST ST.

TO BOKOMA

3

23 24

26 25

15 14

22 23

22 23

27 26

T 8 S

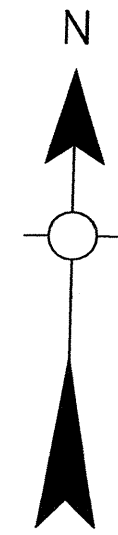
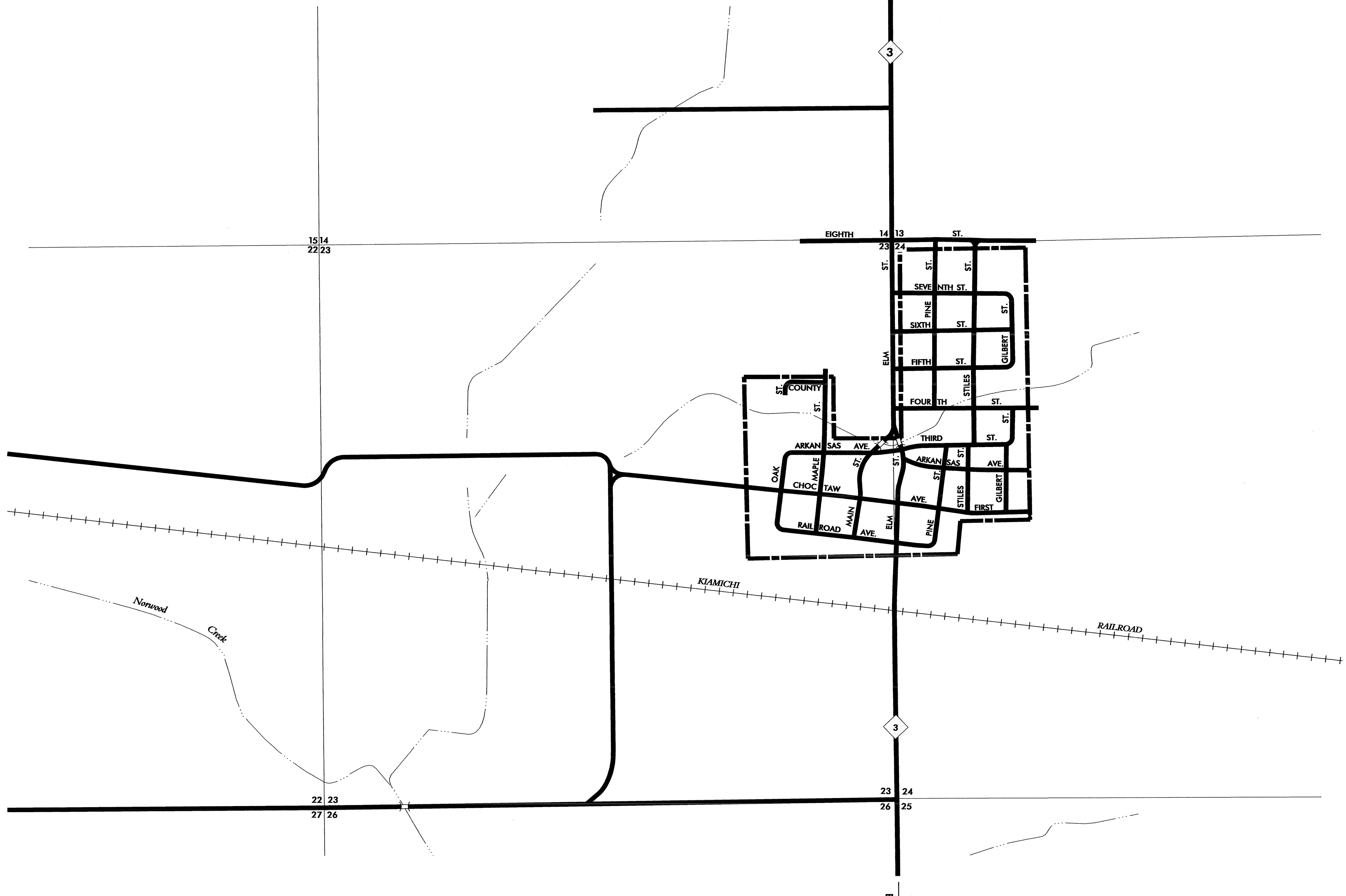

STATE OF OKLAHOMA
DEPARTMENT OF TRANSPORTATION

CITY OF
HAWORTH
McCURTAIN COUNTY

2000
POPULATION
354

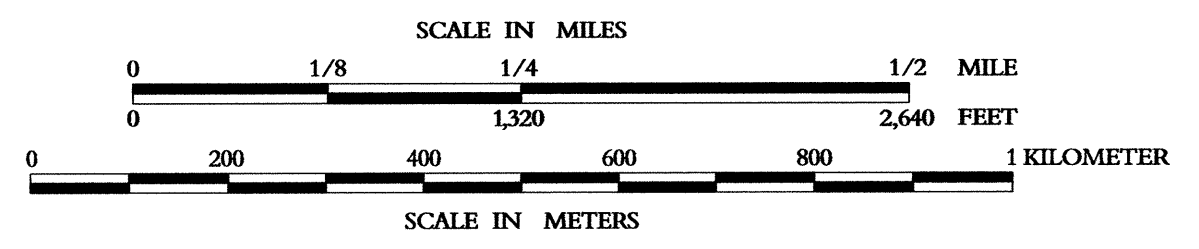

LEGEND

- CORPORATE LIMITS
- STATE NUMBERED ROUTES
- U.S. NUMBERED ROUTES
- INTERSTATE ROUTES

Copies of this map are available for public use at nominal cost.
Address:
OKLAHOMA DEPARTMENT OF TRANSPORTATION
REPRODUCTION BRANCH (Phone - 521-2586)
200 N.E. 21st STREET
OKLAHOMA CITY, OKLA. 73105

ALL RIGHTS RESERVED COMPUTER GENERATED JULY 2000

HAWORTH, McCURTAIN CO.