

R 6 W

R 5 W

Copies of this map are available for public use at nominal cost.
Address:
OKLAHOMA DEPARTMENT OF TRANSPORTATION
REPRODUCTION BRANCH (Phone - 521-2589)
200 N. E. 21st STREET
OKLAHOMA CITY, OKLA. 73105

N 22 T

N 22 T

SHEET 1 OF 2 SHEETS

ALL RIGHTS RESERVED

N 12 T

END, GARFIELD CO.

DEC. 1987

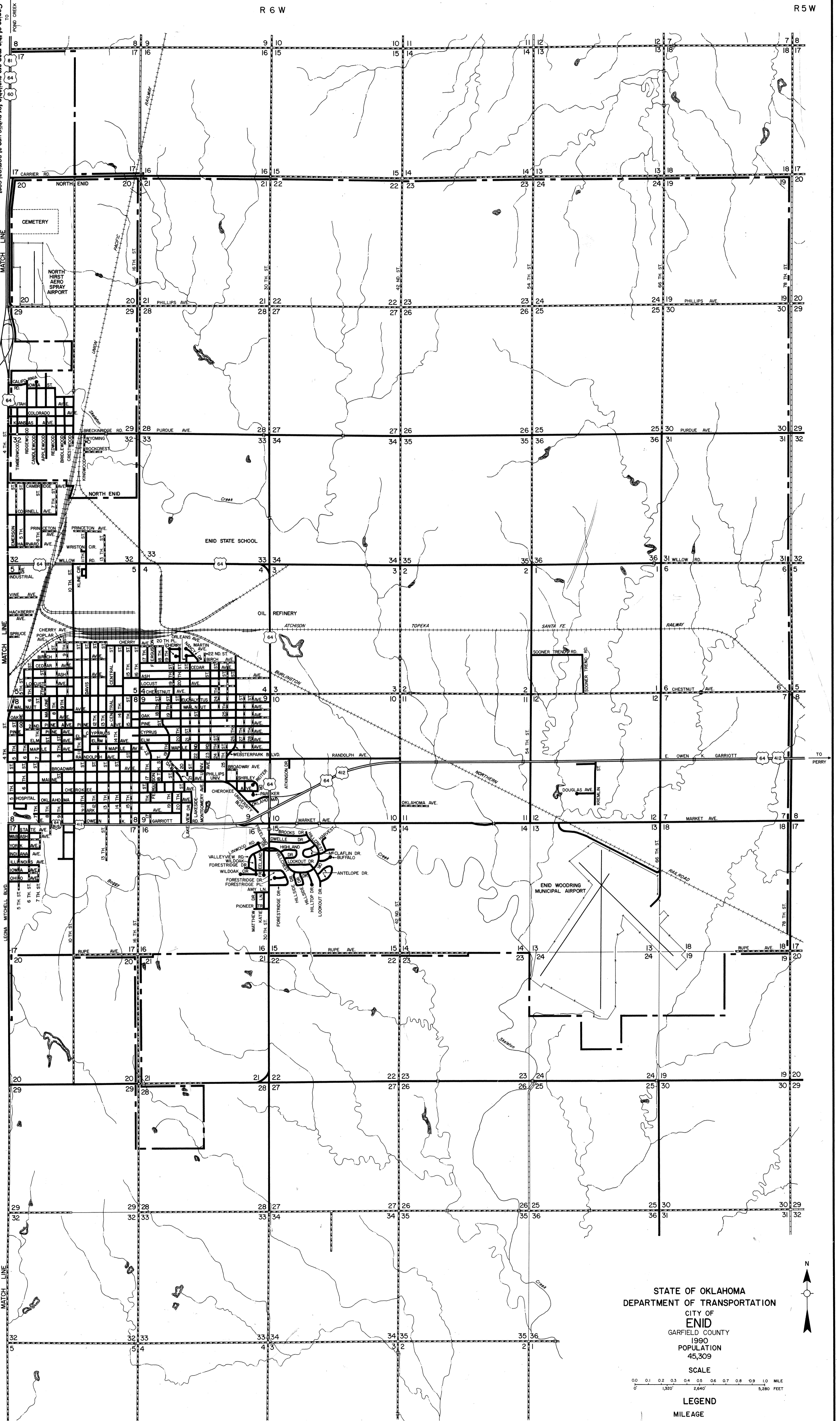

STATE OF OKLAHOMA
DEPARTMENT OF TRANSPORTATION
CITY OF
ENID
GARFIELD COUNTY
1990
POPULATION
45,309

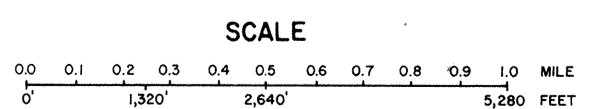

LEGEND

MILEAGE	
PAVED	320.8
GRAVEL	95.6
GRADED & DRAINED	0.4
UNIMPROVED	0.1
TOTAL STREETS & HIGHWAYS	416.9
CORPORATE LIMITS	320.8
STATE NUMBERED ROUTES	95.6
U.S. NUMBERED ROUTES	0.4
INTERSTATE ROUTES	0.1
STREETS	386.4
HIGHWAYS	30.5