

R 3 W

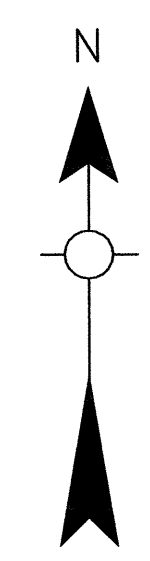

STATE OF OKLAHOMA  
 DEPARTMENT OF TRANSPORTATION  
 CITY OF  
**DEER CREEK**  
 GRANT COUNTY  
 2000  
 POPULATION  
 147

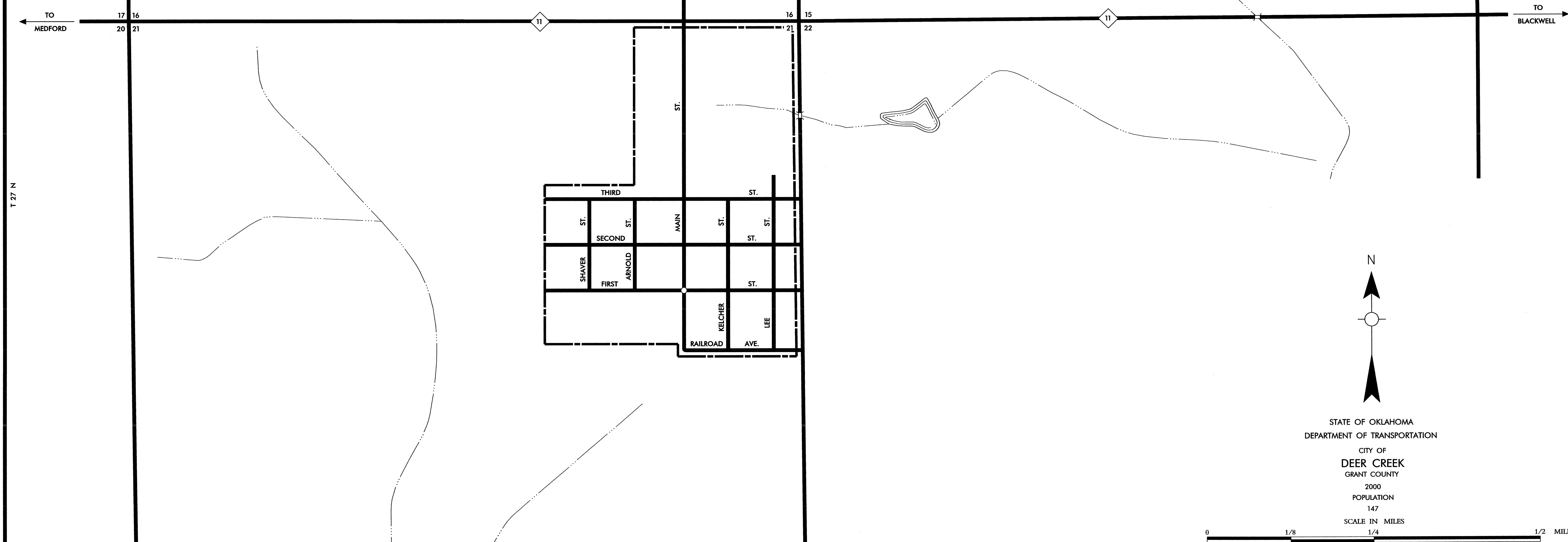
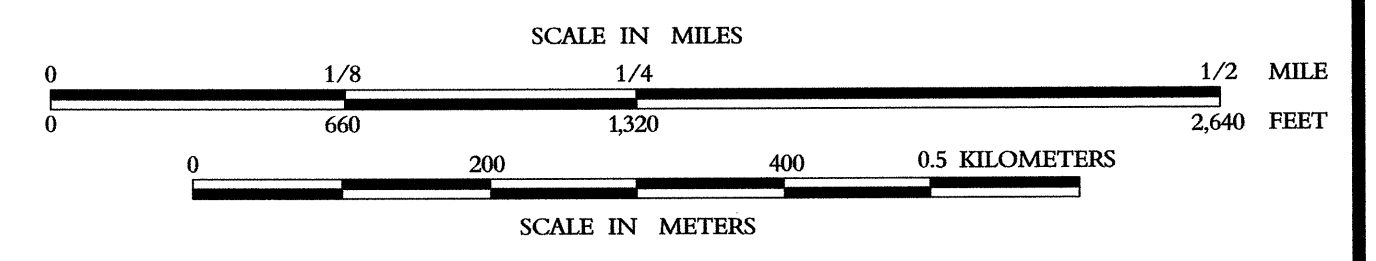

LEGEND  
 CORPORATE LIMITS ———  
 STATE NUMBERED ROUTES 9  
 U.S. NUMBERED ROUTES 66 35  
 INTERSTATE ROUTES

Copies of this map are available for public use at nominal cost.  
 Address:  
 OKLAHOMA DEPARTMENT OF TRANSPORTATION  
 REPRODUCTION BRANCH (Phone - 521-2586)  
 200 N.E. 21st STREET  
 OKLAHOMA CITY, OKLA. 73105

ALL RIGHTS RESERVED      COMPUTER GENERATED      AUGUST, 2001  
 DEER CREEK, GRANT CO.