

R 1 E

R 2 E

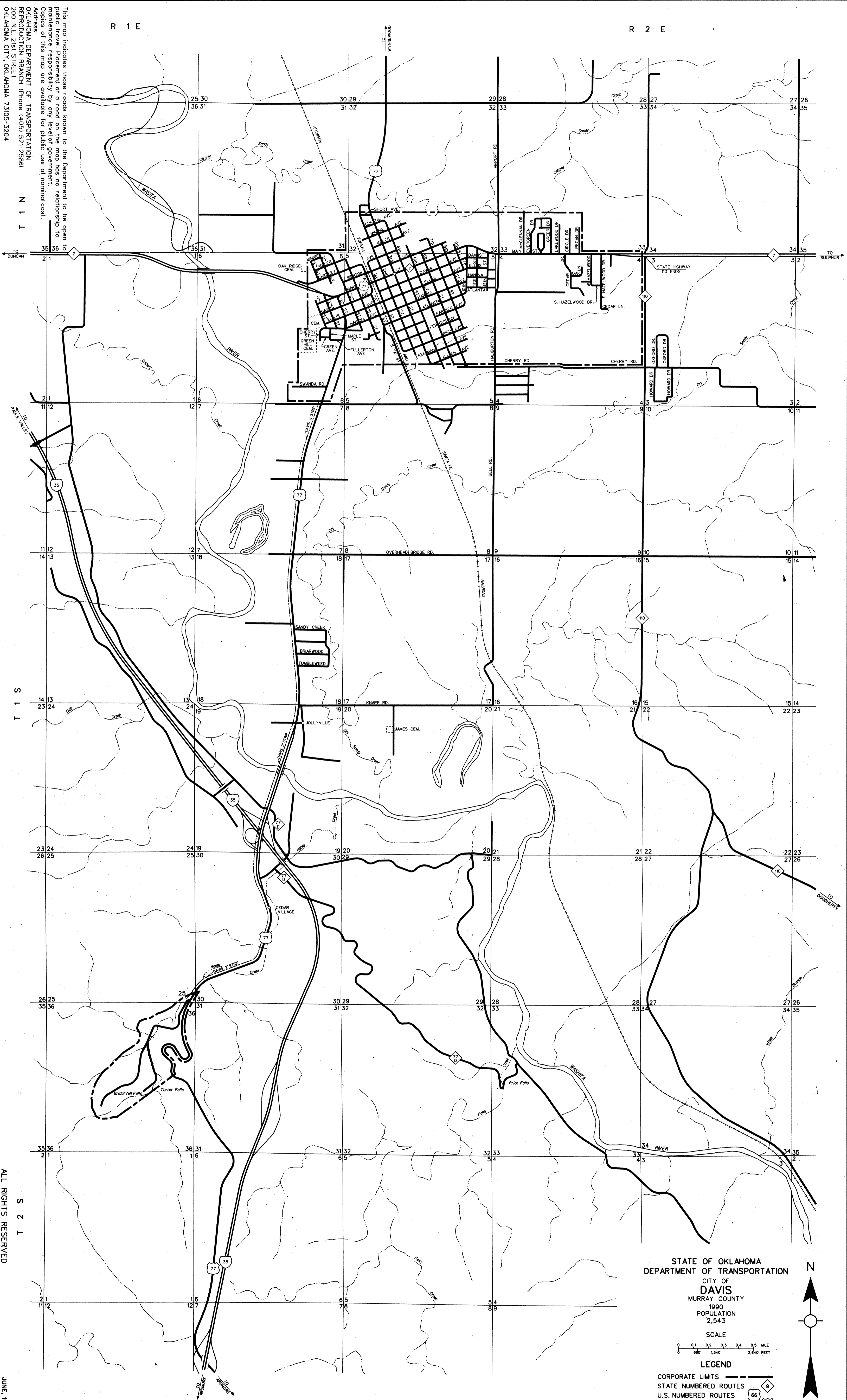

This map indicates those roads known to the Department to be open to public travel. Placement of a road on the map has no relationship to maintenance responsibility by any level of government. Copies of this map are available for public use at nominal cost. OKLAHOMA DEPARTMENT OF TRANSPORTATION, REPRODUCTION BRANCH, PHONE (405) 521-2586, 200 N.E. 24th STREET, OKLAHOMA CITY, OKLAHOMA 73105-3204

N 1 T

S 1 T

S 2 T

ALL RIGHTS RESERVED

JUNE, 1990
DAVIS, MURRAY CO.

STATE OF OKLAHOMA
 DEPARTMENT OF TRANSPORTATION
 CITY OF
DAVIS
 MURRAY COUNTY
 1990
 POPULATION
 2,543

SCALE
 0 0.1 0.2 0.3 0.4 0.5 MILE
 0 660 1,340 2,640 FEET

LEGEND
 CORPORATE LIMITS
 STATE NUMBERED ROUTES
 U.S. NUMBERED ROUTES
 INTERSTATE ROUTES

