

R 10 W

TO AMORITA

T 28 N

TO CHEROKEE

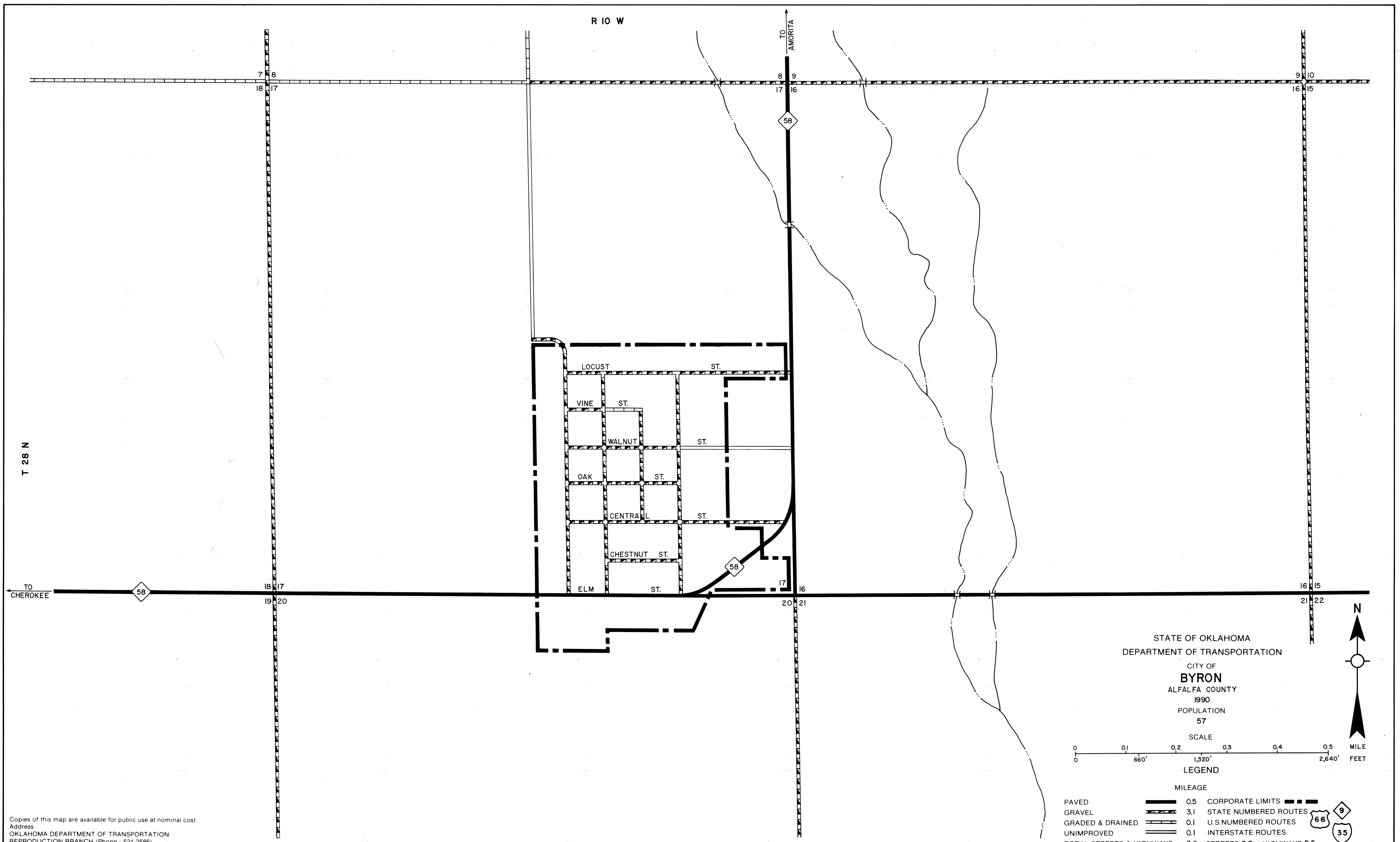

STATE OF OKLAHOMA
 DEPARTMENT OF TRANSPORTATION
 CITY OF
BYRON
 ALFALFA COUNTY
 1990.
 POPULATION
 57

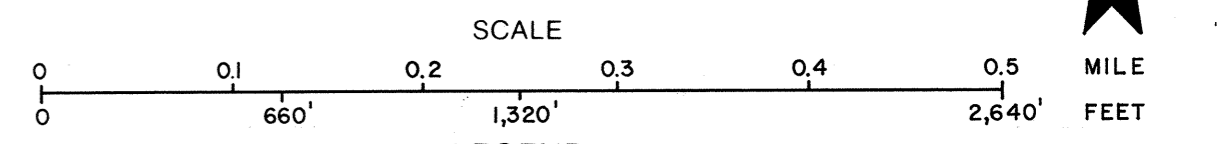

MILEAGE	
PAVED	0.5
GRAVEL	3.1
GRADED & DRAINED	0.1
UNIMPROVED	0.1
TOTAL STREETS & HIGHWAYS	3.8
CORPORATE LIMITS	0.5
STATE NUMBERED ROUTES	3.1
U.S. NUMBERED ROUTES	0.1
INTERSTATE ROUTES	0.1
STREETS	3.3
HIGHWAYS	0.5

ALL RIGHTS RESERVED

FEBRUARY, 1989

Copies of this map are available for public use at nominal cost.
 Address:
 OKLAHOMA DEPARTMENT OF TRANSPORTATION
 REPRODUCTION BRANCH (Phone - 521-2586)
 200 N. E. 21st STREET
 OKLAHOMA CITY OKLA 73105

BYRON, ALFALFA CO.