

R13 E R14 E

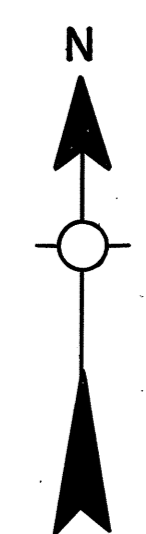

STATE OF OKLAHOMA  
 DEPARTMENT OF TRANSPORTATION  
 CITY OF  
**BOSWELL**  
 CHOCTAW COUNTY

1990  
 POPULATION  
 643

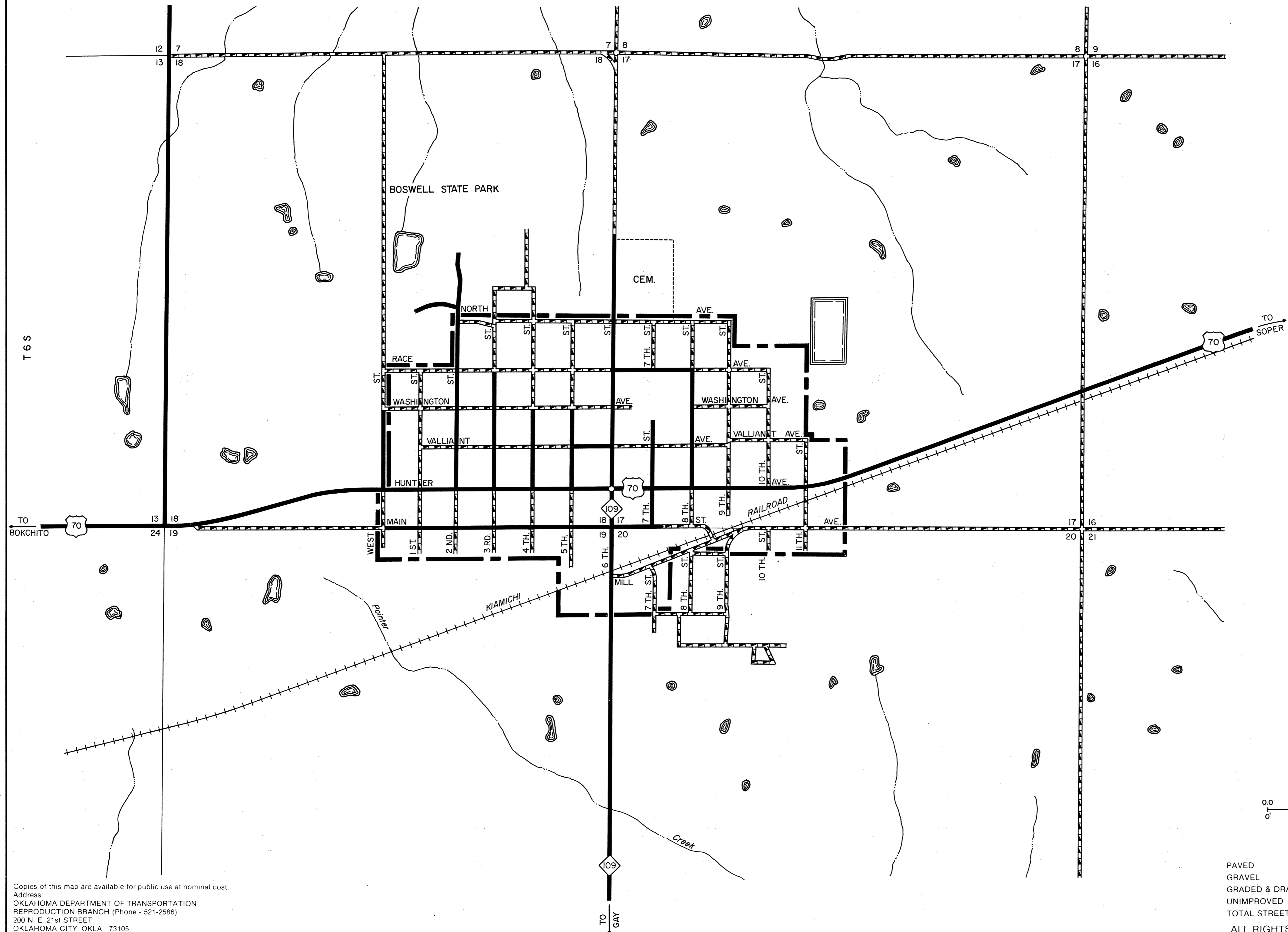
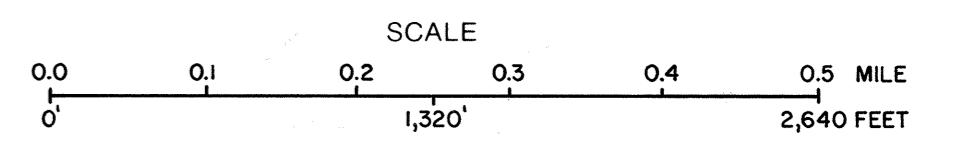

LEGEND

MILEAGE	
PAVED	3.9
GRAVEL	5.9
GRADED & DRAINED	0.0
UNIMPROVED	0.0
TOTAL STREETS & HIGHWAYS	9.8
ALL RIGHTS RESERVED	
CORPORATE LIMITS	8.5
STATE NUMBERED ROUTES	1.3
U.S. NUMBERED ROUTES	
INTERSTATE ROUTES	
STREETS	8.5
HIGHWAYS	1.3

Copies of this map are available for public use at nominal cost.  
 Address:  
 OKLAHOMA DEPARTMENT OF TRANSPORTATION  
 REPRODUCTION BRANCH (Phone - 521-2586)  
 200 N. E. 21st STREET  
 OKLAHOMA CITY, OKLA. 73105

OCT. 1989

BOSWELL, CHOCTAW CO.