

Copies of this map are available for public use at nominal cost.  
 Address:  
 OKLAHOMA DEPARTMENT OF TRANSPORTATION  
 REPRODUCTION BRANCH (Phone - 521-2566)  
 200 N. E. 21st STREET  
 OKLAHOMA CITY, OKLA. 73105

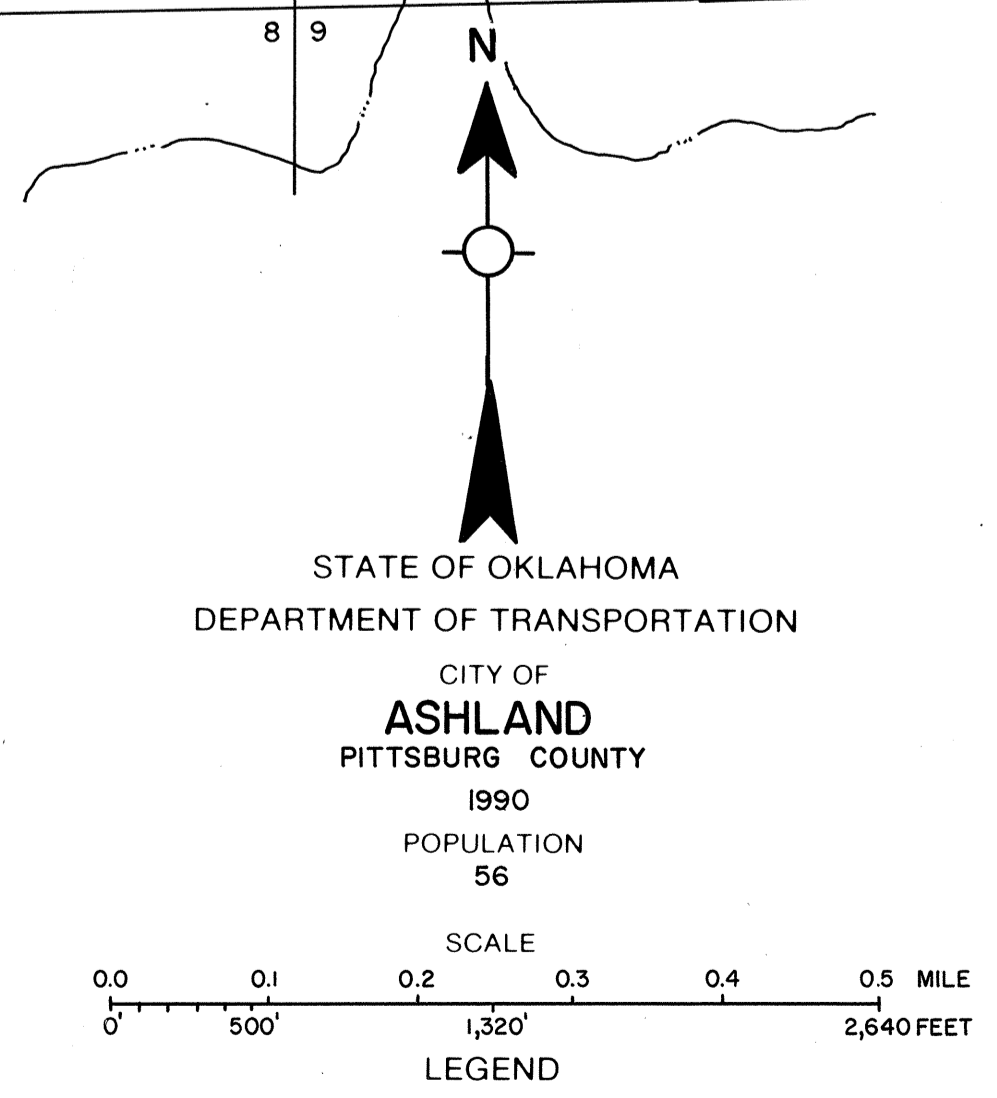
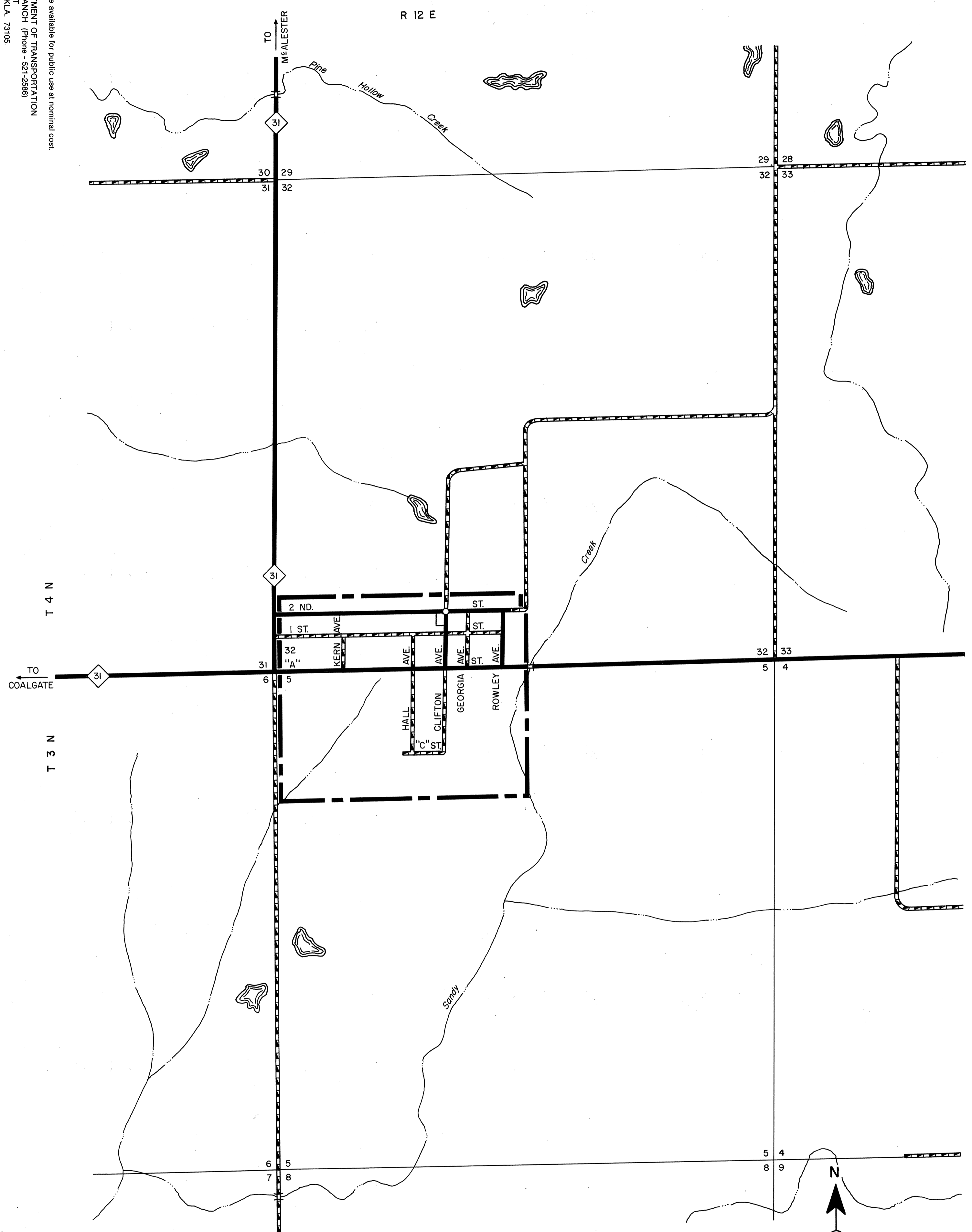

STATE OF OKLAHOMA  
 DEPARTMENT OF TRANSPORTATION  
 CITY OF  
**ASHLAND**  
 PITTSBURG COUNTY  
 1990  
 POPULATION  
 56

LEGEND

MILEAGE	
PAVED	1.2 CORPORATE LIMITS
GRAVEL	1.1 STATE NUMBERED ROUTES
GRADED & DRAINED	0.0 U.S. NUMBERED ROUTES
UNIMPROVED	0.0 INTERSTATE ROUTES
TOTAL STREETS & HIGHWAYS	2.3 STREETS 2.3 HIGHWAYS 0.0

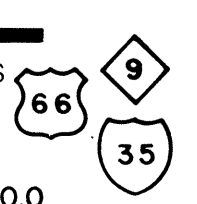

ALL RIGHTS RESERVED

ASHLAND, PITTSBURG CO.

JAN. 1987