

Copies of this map are available for public use at nominal cost.
 Address:
 OKLAHOMA DEPARTMENT OF TRANSPORTATION
 REPRODUCTION BRANCH (Phone - 521-2586)
 200 N. E. 21st STREET
 OKLAHOMA CITY, OKLA. 73105

R 6 W R 5 W

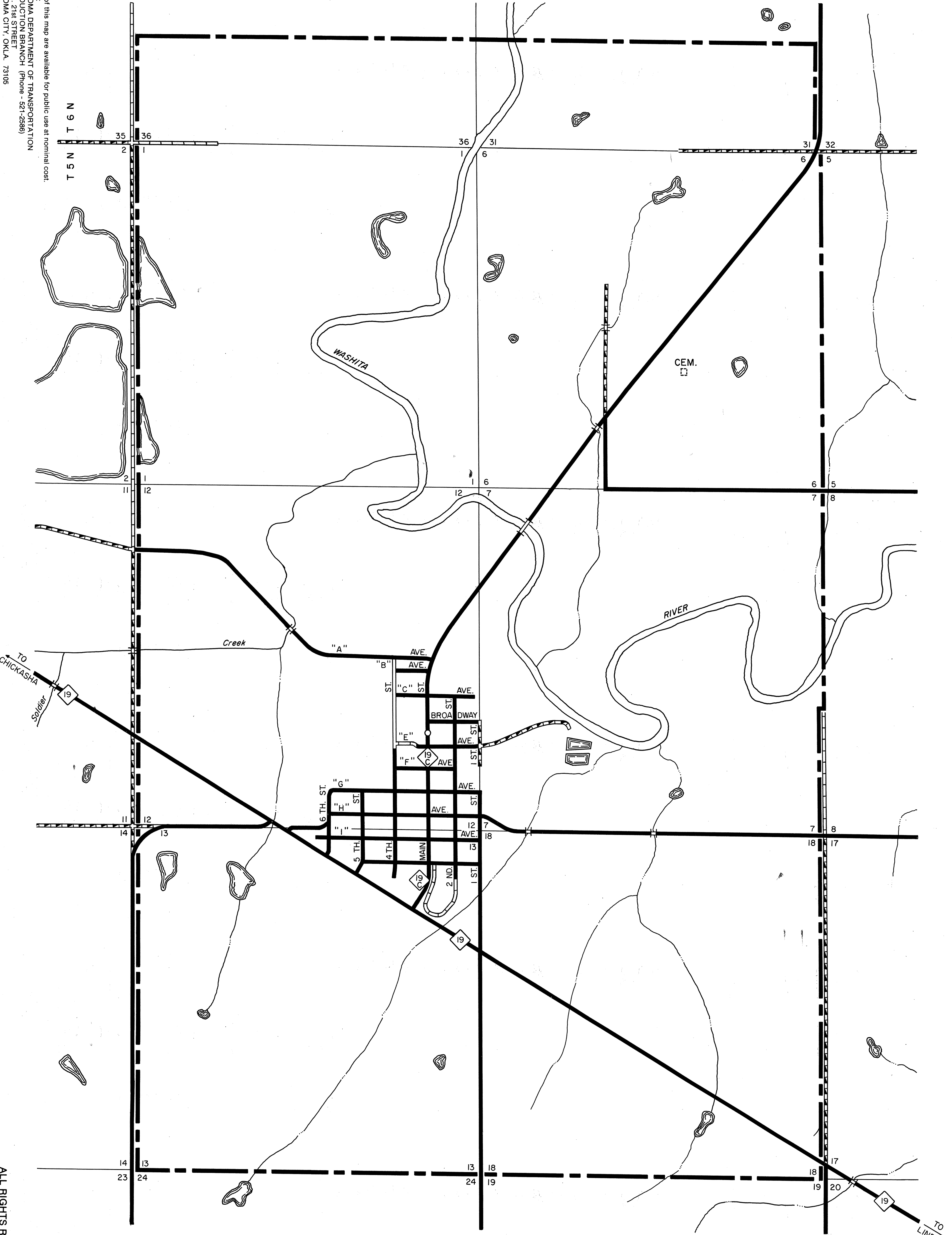

ALL RIGHTS RESERVED



STATE OF OKLAHOMA
 DEPARTMENT OF TRANSPORTATION
 CITY OF
ALEX
 GRADY COUNTY

1990
 POPULATION
 639

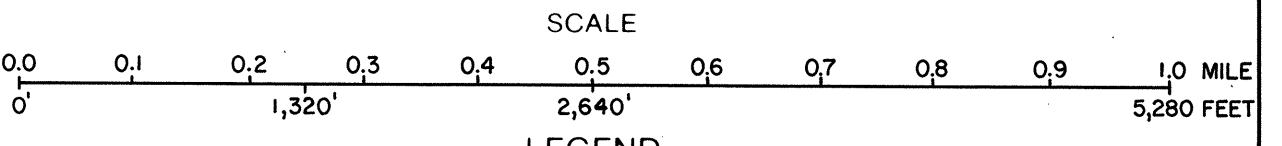

LEGEND

MILEAGE	
PAVED	13.4
GRAVEL	1.3
GRADED & DRAINED	0.6
UNIMPROVED	0.3
TOTAL STREETS & HIGHWAYS	15.6
CORPORATE LIMITS	1.3
STATE NUMBERED ROUTES	0.6
U.S. NUMBERED ROUTES	0.3
INTERSTATE ROUTES	15.6
STREETS	12.7
HIGHWAYS	2.9

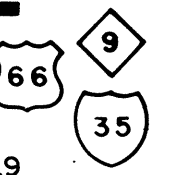

SEPT. 1989

ALEX, GRADY CO.