

Copies of this map are available for public use at nominal cost.
 Address:
 OKLAHOMA DEPARTMENT OF TRANSPORTATION
 REPRODUCTION BRANCH (phone - 521-2586)
 200 N.E. 28th STREET
 OKLAHOMA CITY, OKLA. 73105

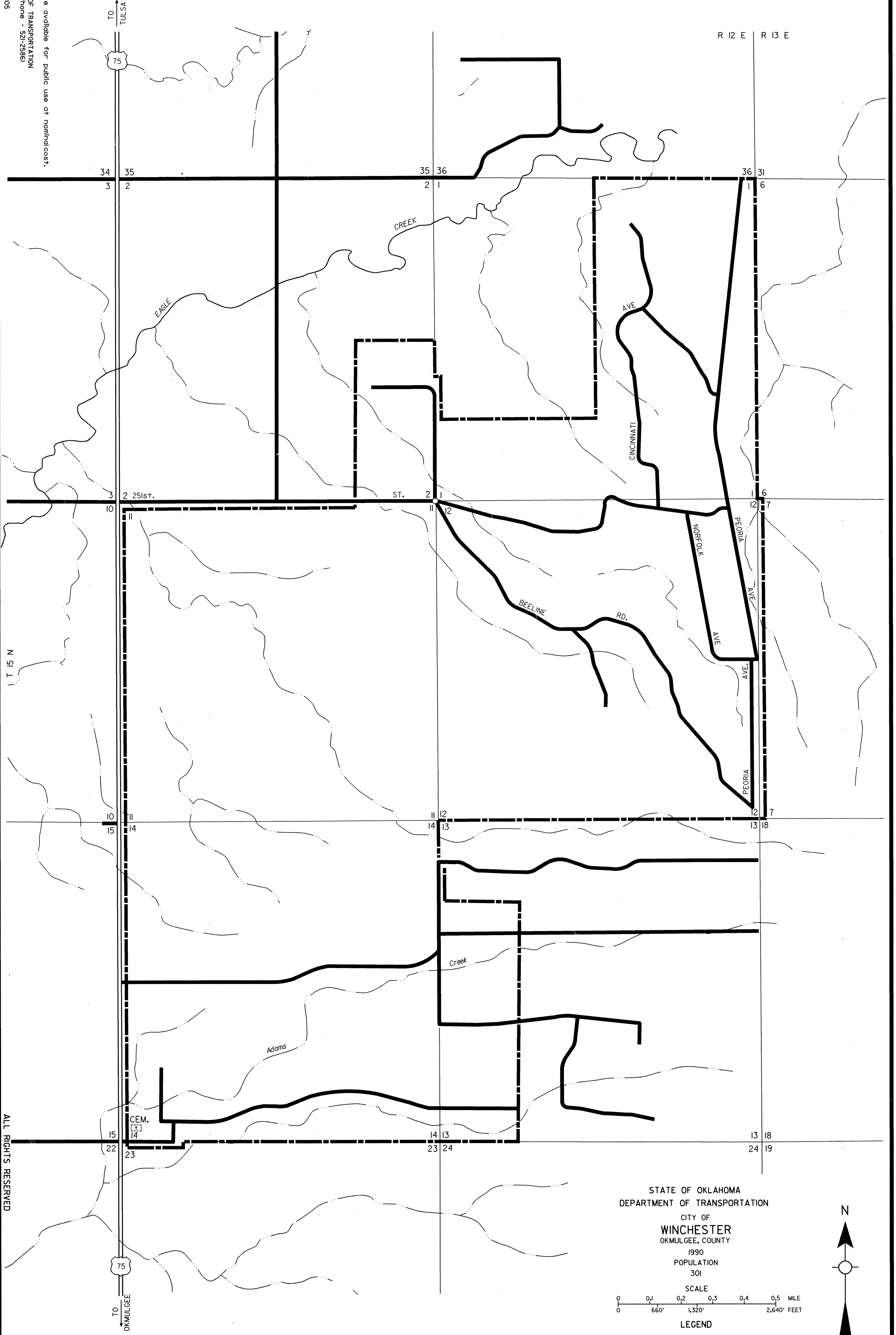





R 12 E R 13 E

TO TULSA

TO OKMULGEE

STATE OF OKLAHOMA
 DEPARTMENT OF TRANSPORTATION
 CITY OF
WINCHESTER
 OKMULGEE COUNTY
 1990
 POPULATION
 301
 SCALE
 0 0.1 0.2 0.3 0.4 0.5 MILE
 0 660' 1,320' 2,640' FEET

LEGEND
 CORPORATE LIMITS ———
 STATE NUMBERED ROUTES  
 U.S. NUMBERED ROUTES  
 INTERSTATE ROUTES 

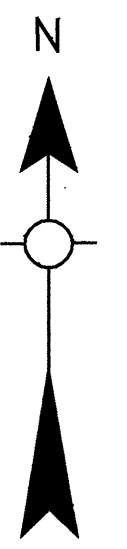

N 5 T 1

ALL RIGHTS RESERVED

WINCHESTER, OKMULGEE CO.

MARCH 1991