

R 8 W

R 7 W

TO WAURIKA

T 5 S

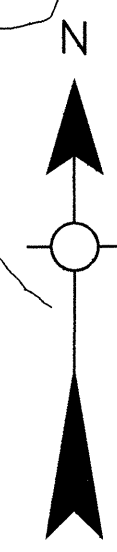
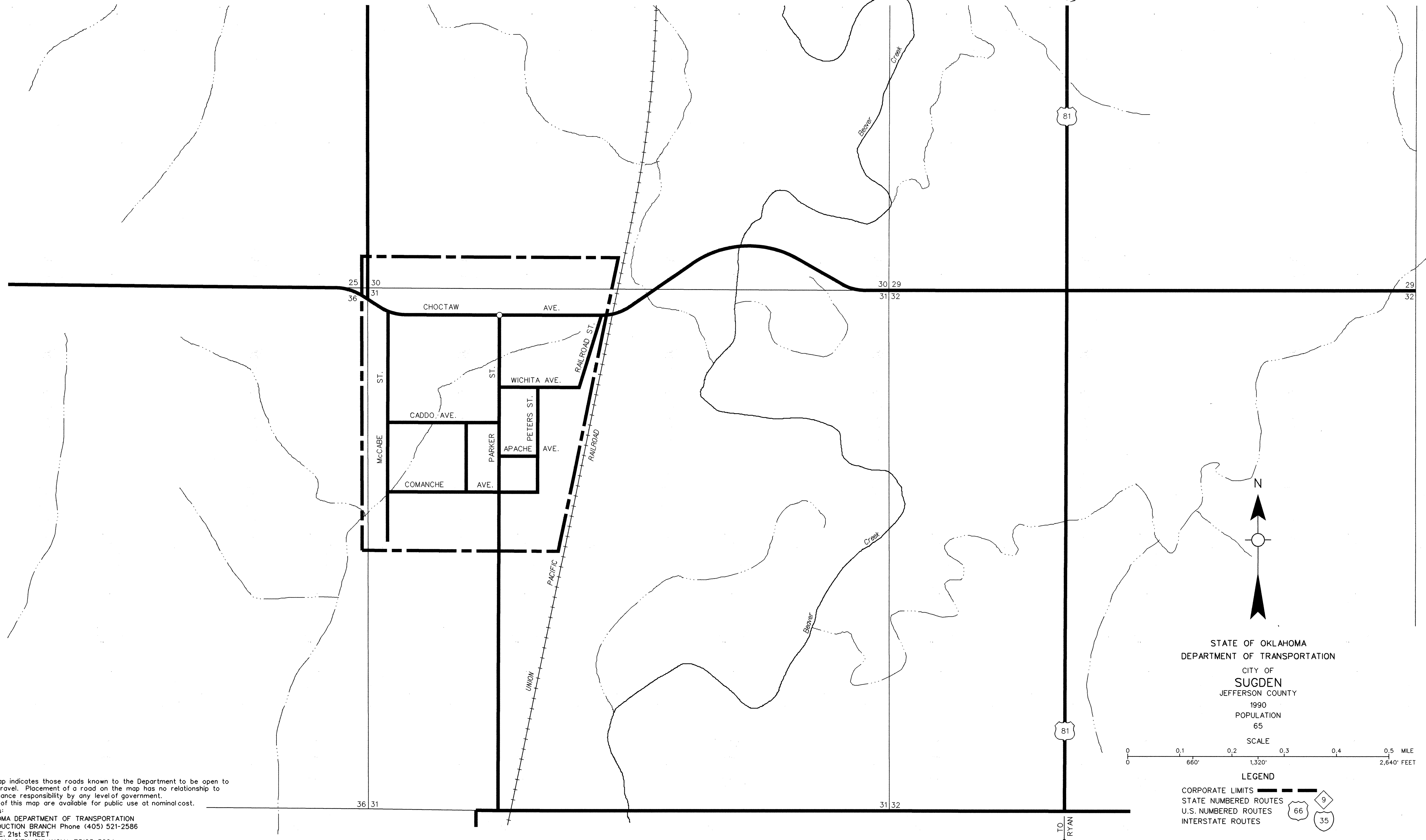

STATE OF OKLAHOMA
 DEPARTMENT OF TRANSPORTATION
 CITY OF
SUGDEN
 JEFFERSON COUNTY
 1990
 POPULATION
 65

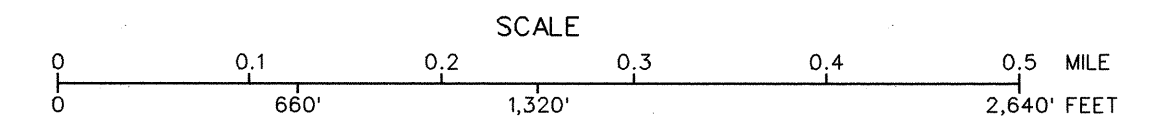

LEGEND
 CORPORATE LIMITS
 STATE NUMBERED ROUTES
 U.S. NUMBERED ROUTES
 INTERSTATE ROUTES

This map indicates those roads known to the Department to be open to public travel. Placement of a road on the map has no relationship to maintenance responsibility by any level of government. Copies of this map are available for public use at nominal cost.
 Address:
 OKLAHOMA DEPARTMENT OF TRANSPORTATION
 REPRODUCTION BRANCH Phone (405) 521-2586
 200 N.E. 21st STREET
 OKLAHOMA CITY, OKLAHOMA 73105-3204

ALL RIGHTS RESERVED

DECEMBER, 1990

SUGDEN, JEFFERSON CO.