

Copies of this map are available for public use at nominal cost.
 Address:
 OKLAHOMA DEPARTMENT OF TRANSPORTATION
 REPRODUCTION BRANCH (Phone - 521-2586)
 200 N.E. 21st STREET
 OKLAHOMA CITY, OKLA. 73105

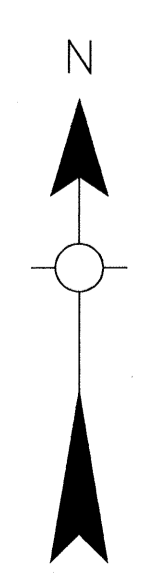
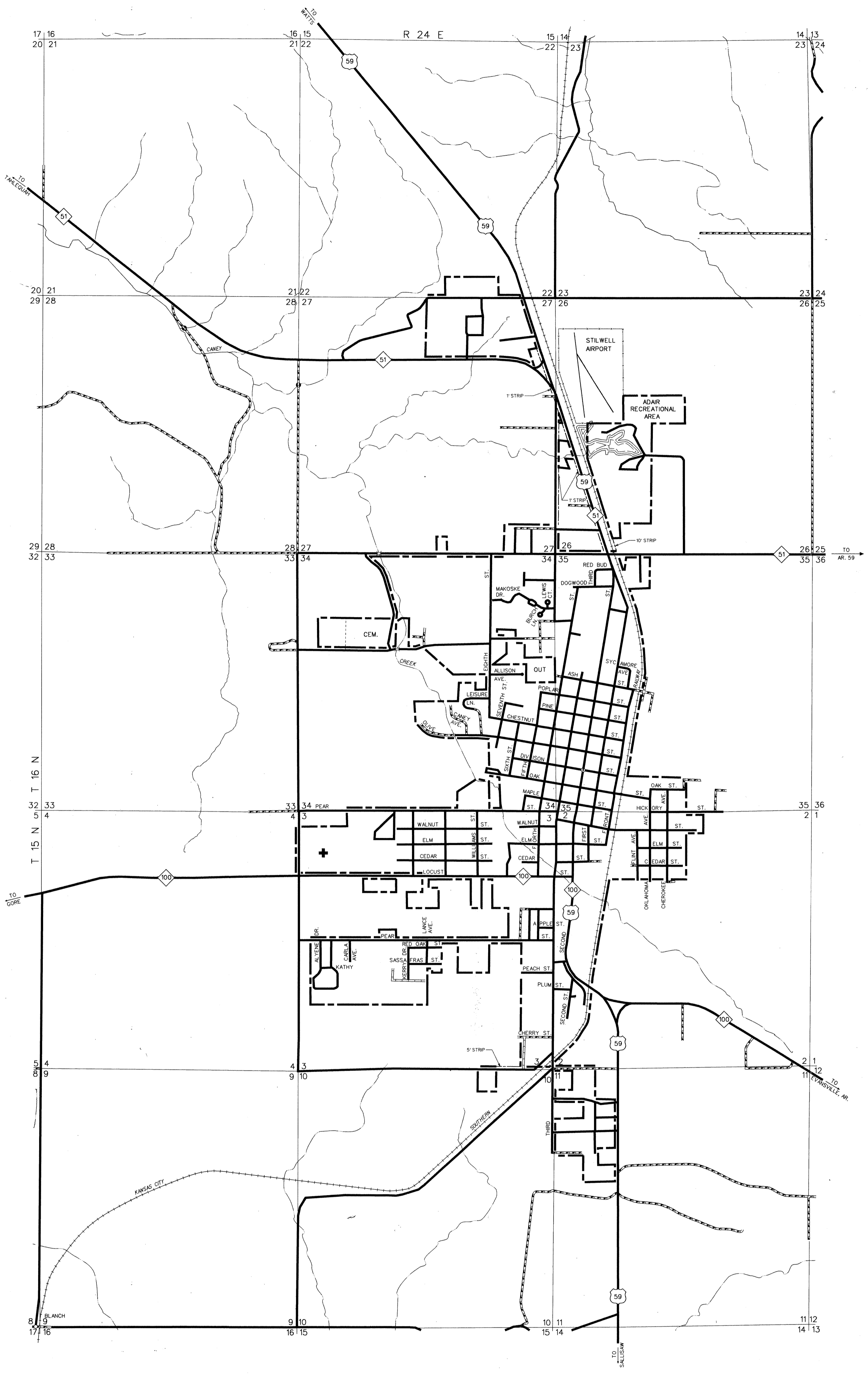

STATE OF OKLAHOMA
 DEPARTMENT OF TRANSPORTATION
 CITY OF
STILWELL
 ADAIR COUNTY
 1990
 POPULATION
 2,663

SCALE
 0.0 0.1 0.2 0.3 0.4 0.5 MILE
 0 500 1000 1500 2000 FEET

MILEAGE		LEGEND	
PAVED	28.5	—	CORPORATE LIMITS
GRAVEL	1.7	—	STATE NUMBERED ROUTES
GRADED & DRAINED	0.4	—	U.S. NUMBERED ROUTES
UNIMPROVED	0.0	—	INTERSTATE ROUTES
TOTAL STREETS & HIGHWAYS	30.6	—	STREETS 28.2 HIGHWAYS 2.4

ALL RIGHTS RESERVED

STILWELL, ADAIR CO.
 FEBRUARY, 1988