

Copies of this map are available for public use at nominal cost.  
 Address: OKLAHOMA DEPARTMENT OF TRANSPORTATION  
 REPRODUCTION BRANCH (Phone - 521-2586)  
 200 N.E. 21st STREET  
 OKLAHOMA CITY, OKLA. 73105

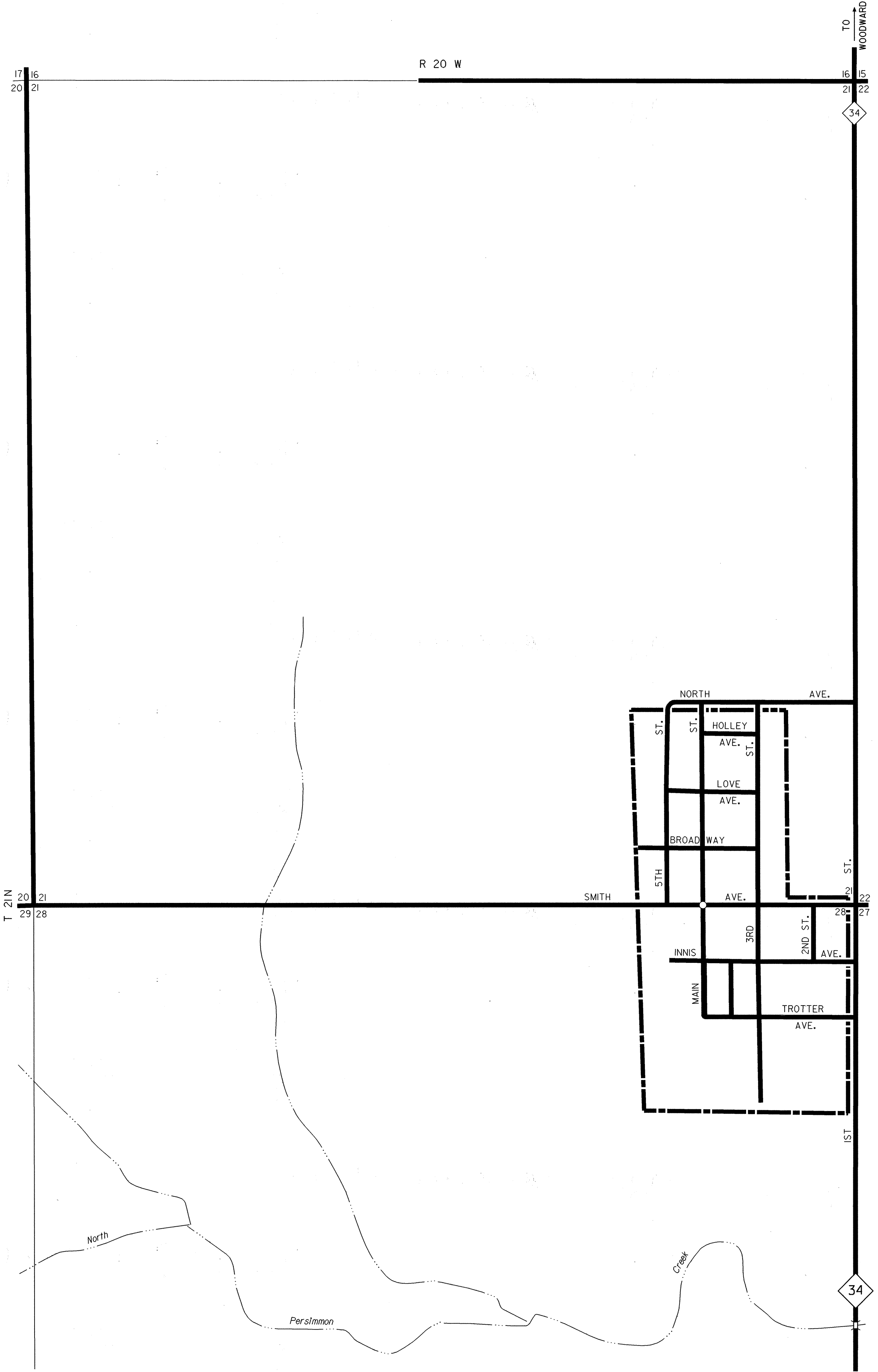

STATE OF OKLAHOMA  
 DEPARTMENT OF TRANSPORTATION

CITY OF  
**SHARON**  
 OKLAHOMA COUNTY  
 1990  
 POPULATION  
 108

SCALE

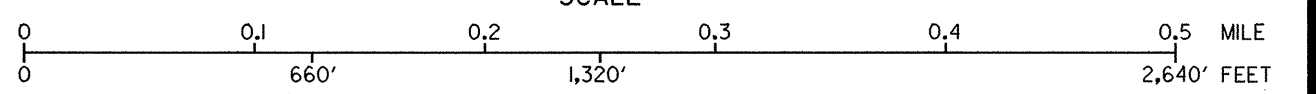

LEGEND

- CORPORATE LIMITS
- STATE NUMBERED ROUTES
- U.S. NUMBERED ROUTES
- INTERSTATE ROUTES