

R 15 E

TO TALALA

169

16 15

21 22

17 16

20 21

20 21

29 28

27 28

21 22

28 27

29 28

32 33

27 28

33 34

33 34

32 33

33 34

32 33

33 34

32 33

33 34

32 33

33 34

32 33

33 34

32 33

33 34

32 33

33 34

32 33

33 34

32 33

33 34

32 33

33 34

32 33

33 34

32 33

33 34

32 33

33 34

32 33

33 34

32 33

33 34

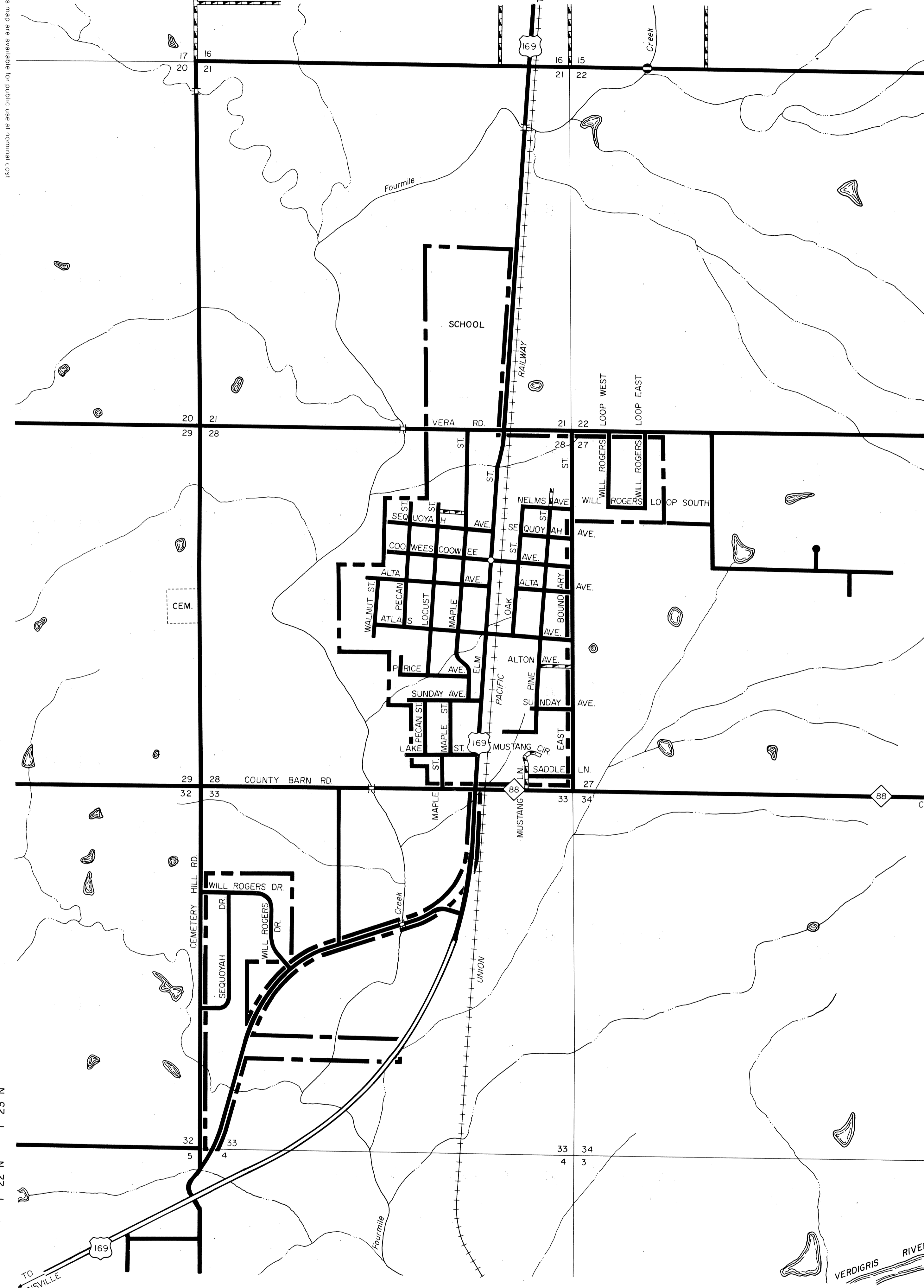

Copies of this map are available for public use at nominal cost.
 Address
 OKLAHOMA DEPARTMENT OF TRANSPORTATION
 REPRODUCTION BRANCH (Phone - 521-2586)
 200 N. E. 27th STREET
 OKLAHOMA CITY OKLA 73105

ALL RIGHTS RESERVED

OLOGAH, ROGERS CO.
 APRIL 1988

STATE OF OKLAHOMA
 DEPARTMENT OF TRANSPORTATION

CITY OF
OLOGAH
 ROGERS COUNTY

1990
 POPULATION
 828

SCALE

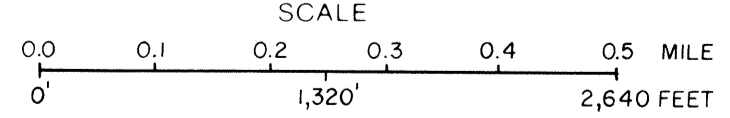

LEGEND

PAVED	10.3	CORPORATE LIMITS	1.0
GRAVEL	0.4	STATE NUMBERED ROUTES	66
GRADED & DRAINED	0.0	U.S. NUMBERED ROUTES	9
UNIMPROVED	0.0	INTERSTATE ROUTES	35
TOTAL STREETS & HIGHWAYS	10.7	STREETS	8.4
		HIGHWAYS	2.3

