

- N-7 (1) BRIGHT CANYON RD. (2) MESAVILLE. (3) TORRENTE PK. (4) BEYCE CANYON CT. (5) ACADIA CT.
- N-8 (1) MAGNOLIA CT. (2) HOLLYWOOD DR. (3) BOSSON LN. (4) O'CASEY ST. (5) MALPI CT. (6) HORTON CR. (7) PUMPKIN CR. (8) O'CASEY CT. (9) WILLOW DR. (10) GAIETY DR. (11) STOODALE PL. (12) SILVER MAPLE DR. (13) BEEB RIDGE. (14) LARKDALE DR. (15) CEDAR HALL CR. (16) SAGANORE DR. (17) LOCKWOOD PL. (18) LOCKWOOD LN. (19) HICKORY HILLS ST.
- N-9 (1) BANTRY CT. (2) BANTRY WAY CR. (3) ETER CR. (4) CAGLEY PL. (5) SENEYBRIDGE CT. (6) WESTBURY CT. (7) SENEYBRIDGE LN. (8) FAIRFAX CT. (9) FAIRFAX CT. (10) S.W. 14th ST. (11) KATHLEEN WAY. (12) SELBORNE DR. (13) S.W. 15th ST. (14) MAYER DR. (15) BIRKENHEAD RD. (16) HOLLYHEAD TER. (17) DANBURY TER.

- N-10 (1) LAKVIEW PL. (2) NIMAN DR. (3) LAGLEY DR. (4) BERRY CANYON. (5) LAKVIEW TER. (6) BECK DR. (7) LAKVIEW DR. (8) LAKVIEW DR. (9) LAKVIEW DR. (10) LAKVIEW DR. (11) LAKVIEW DR. (12) LAKVIEW DR. (13) LAKVIEW DR. (14) LAKVIEW DR. (15) LAKVIEW DR. (16) LAKVIEW DR. (17) LAKVIEW DR. (18) LAKVIEW DR. (19) LAKVIEW DR. (20) LAKVIEW DR.
- O-7 (1) SILVER MAPLE CR. (2) FAWNEE CR. (3) LOON LOOP. (4) PARKDALE DR. (5) SULLY CR. (6) SULLY CR. (7) SULLY CR. (8) O'NDALE DR. (9) SENEY CR. (10) LOCKWOOD DR. (11) BOGGS CR. (12) GLEN DR. (13) STOODALE PL. (14) SILVER MAPLE DR. (15) BEEB RIDGE. (16) LARKDALE DR. (17) CEDAR HALL CR. (18) SAGANORE DR. (19) LOCKWOOD PL. (20) LOCKWOOD LN. (21) HICKORY HILLS ST.
- O-11 (1) HAWANNA DR. (2) SUZY DR.

- Q-9 (1) KENDAL AVE. (2) KENRUBO CT. (3) LANKESTAR PL. (4) LANKESTAR WAY. (5) MACKENZIE WAY. (6) NORWICH CR. (7) NORWICH PL. (8) KENDAL PL. (9) KENDAL PL. (10) BIKENHEAD RD. (11) BENTHAM CT. (12) BENTHAM CT. (13) BENTHAM CT. (14) BENTHAM PL. (15) BENTHAM PL. (16) BUTLAND TER. (17) SELBORNE PL.

- R-7 (1) CHEROKEE WAY. (2) CADDELL WAY. (3) CROOKING WAY. (4) SAM HOUSTON WAY. (5) LAMAR WAY. (6) CHRISTINA WAY. (7) ARROWHEAD WAY. (8) ARDEN WAY. (9) HORDON WAY. (10) BIC WAY. (11) CELESTIAL WAY. (12) PARADISE WAY.
- T-30 (1) H. EDGEWOOD TER. (2) N. OAKWOOD TER. (3) E. LAKESIDE TER. (4) S. WILLOW CREEK TER. (5) N. LAKESIDE TER. (6) CANADIAN CT. (7) S. SHERWOOD TER. (8) KEBENE TER. (9) COTTONWOOD TER. (10) LAKESIDE TER. (11) HILLSIDE TER. (12) WILLOW TER.

- U-7 (1) FOREST CT. (2) S. GREENWOOD CT. (3) SHERBURN LN. (4) W. GREENWOOD DR. (5) W. HILLCREST DR. (6) JAZZIER DR. (7) SHERBURN CT. (8) ARLINE CT DR. (9) PHILBROOK CT. DR.
- U-8 (1) CHANDA LN. (2) S. QUINCY LN. (3) CEDAR LN. (4) E. BLAKE DR. (5) E. FOREST LN. (6) E. GREENWOOD LN. (7) LINDEN LN. CT. (8) LINDEN LN.

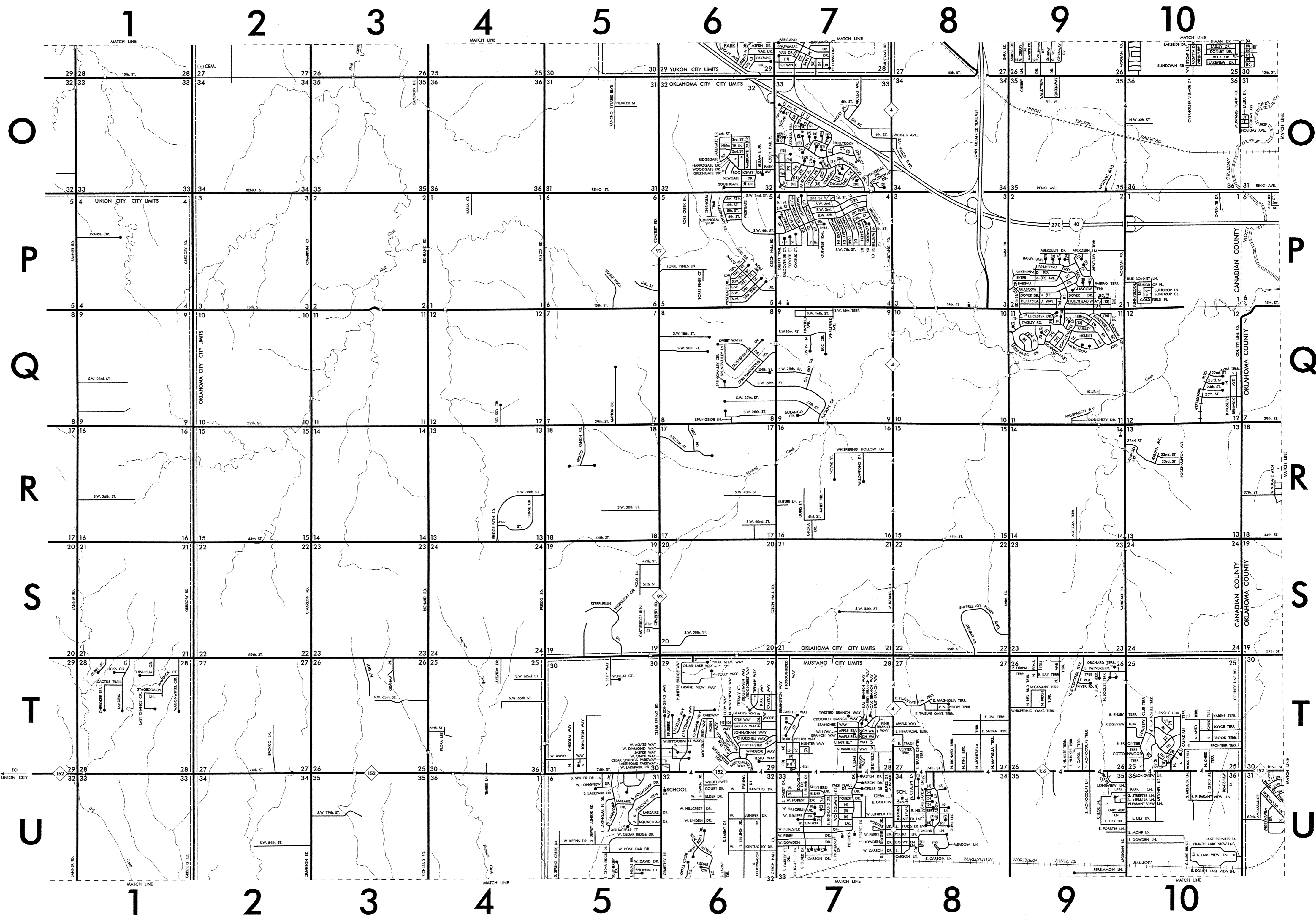
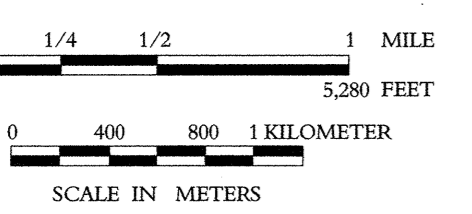
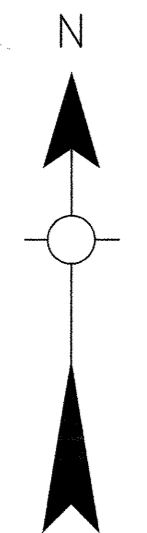
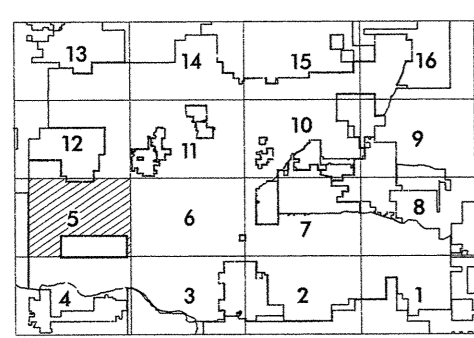

Copies of this map are available for public use at nominal cost.  
 Address:  
 OKLAHOMA DEPARTMENT OF TRANSPORTATION  
 REPRODUCTION BRANCH (Phone - 521-2586)  
 200 N.E. 21st STREET  
 OKLAHOMA CITY, OKLA. 73105