

32 33 34 35 36 37 38 39 40 41 42

V
W
X
Y
Z
AA
BB

V
W
X
Y
Z
AA
BB

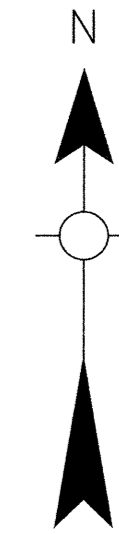
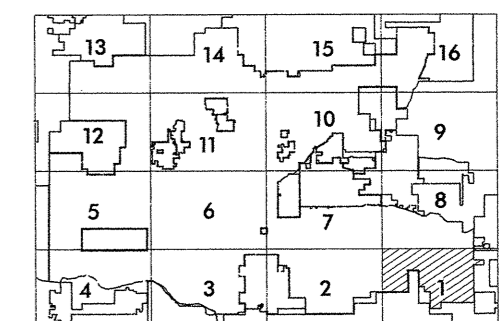
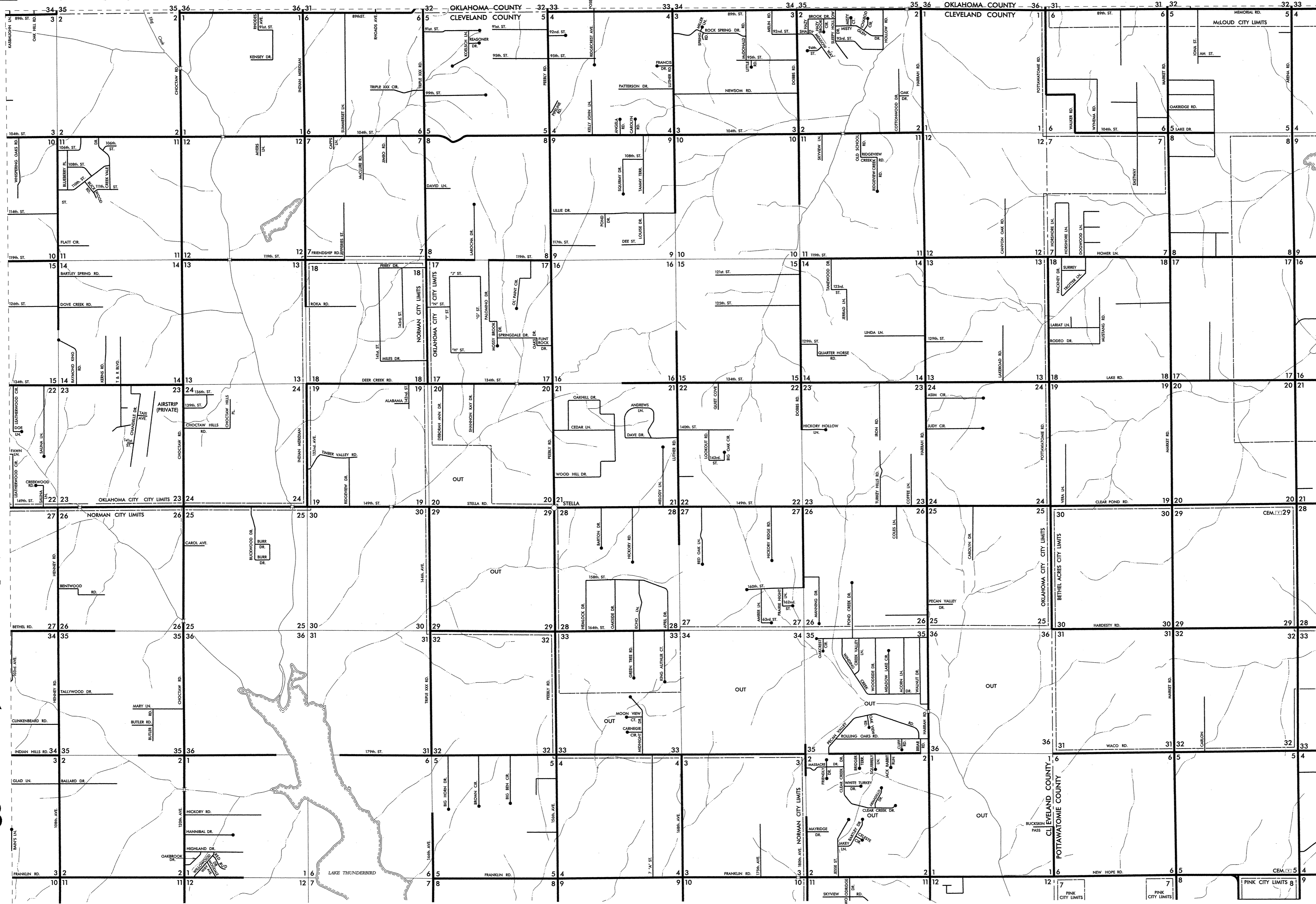

STATE OF OKLAHOMA
DEPARTMENT OF TRANSPORTATION
CITY OF
OKLAHOMA CITY
OKLAHOMA COUNTY
1990
POPULATION
444,719

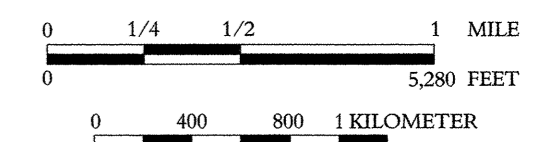

LEGEND
CORPORATE LIMITS
STATE NUMBERED ROUTES
U.S. NUMBERED ROUTES
INTERSTATE ROUTES

Copies of this map are available for public use at nominal cost.
Address:
OKLAHOMA DEPARTMENT OF TRANSPORTATION
REPRODUCTION BRANCH (Phone - 521-2586)
200 N.E. 21st STREET
OKLAHOMA CITY, OKLA. 73105

33 34 35 36 37 38 39 40 41 42

ALL RIGHTS RESERVED COMPUTER GENERATED JANUARY, 1995

OKLAHOMA CITY, OKLAHOMA CO.