

Copies of this map are available for public use at nominal cost.
 OKLAHOMA DEPARTMENT OF TRANSPORTATION
 REPRODUCTION BRANCH (Phone - 521-2589)
 200 N. E. 24th STREET
 OKLAHOMA CITY, OKLA. 73105

R 15 E R 16 E

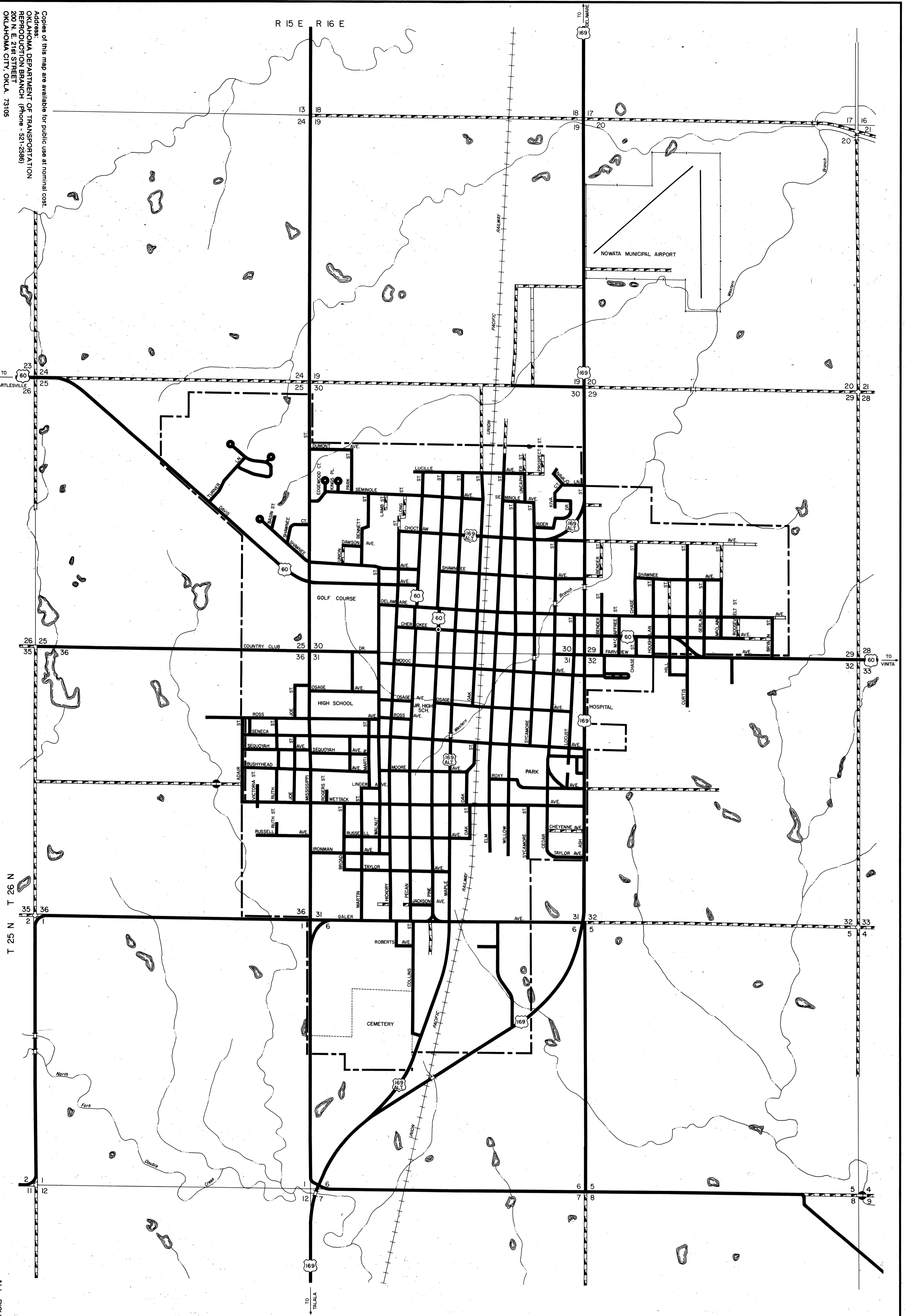

T 26 N
T 25 N

ALL RIGHT RESERVED

NOWATA, NOWATA CO. JAN. 1989

STATE OF OKLAHOMA
 DEPARTMENT OF TRANSPORTATION
 CITY OF
NOWATA
 NOWATA COUNTY
 1990
 POPULATION
 3,896
 SCALE
 0.0 0.1 0.2 0.3 0.4 0.5 MILE
 0' 1,320' 2,640' FEET

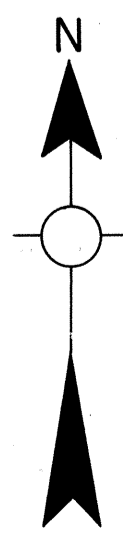

MILEAGE	
PAVED	45.4
GRAVEL	2.1
GRADED & DRAINED	0.2
UNIMPROVED	0.0
TOTAL STREETS & HIGHWAYS	47.7
CORPORATE LIMITS	45.4
STATE NUMBERED ROUTES	2.1
U.S. NUMBERED ROUTES	0.2
INTERSTATE ROUTES	0.0
STREETS	41.0
HIGHWAYS	6.7