

Copies of this map are available for public use at nominal cost.
 Address:
 OKLAHOMA DEPARTMENT OF TRANSPORTATION
 REPRODUCTION BRANCH (Phone - 521-2586)
 200 N. E. 21st STREET
 OKLAHOMA CITY, OKLA. 73105

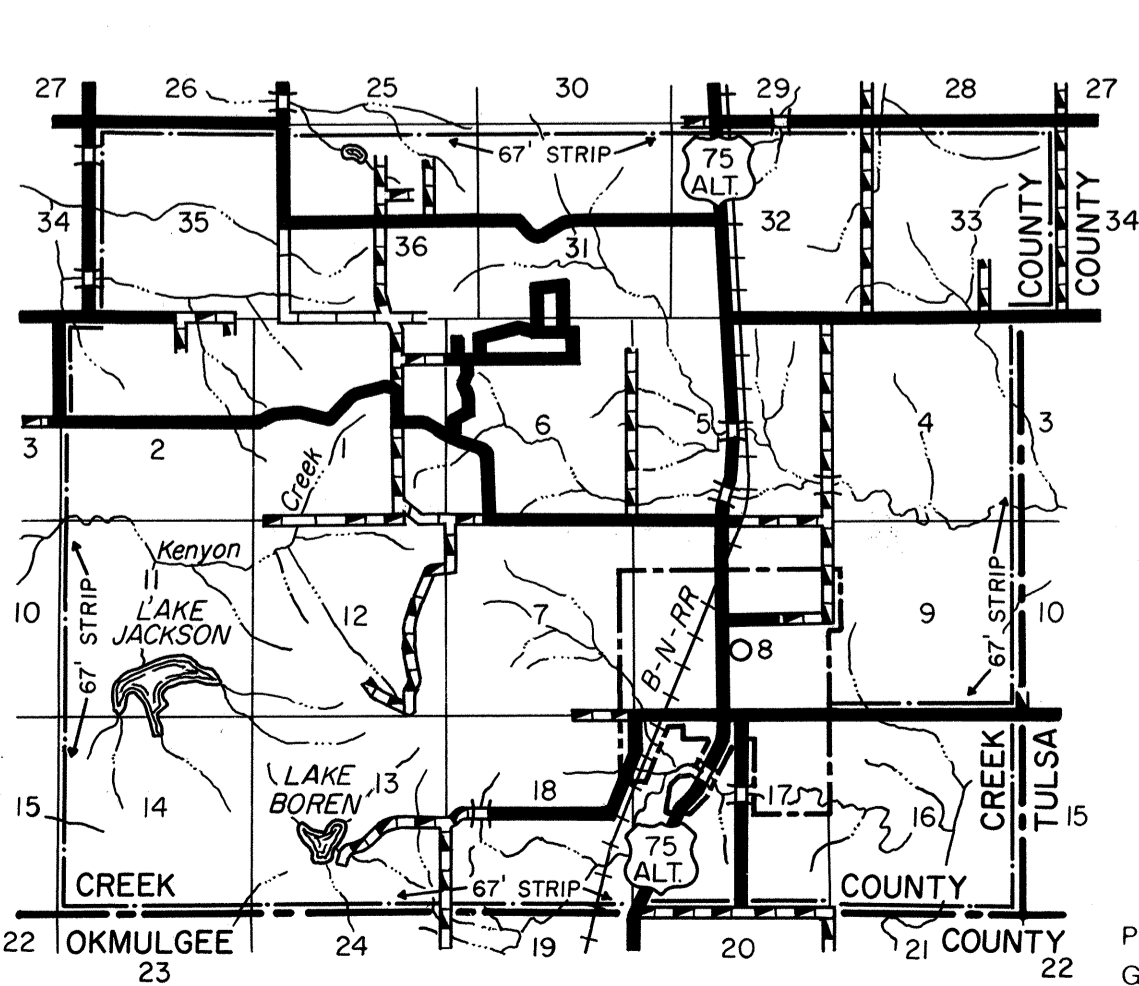
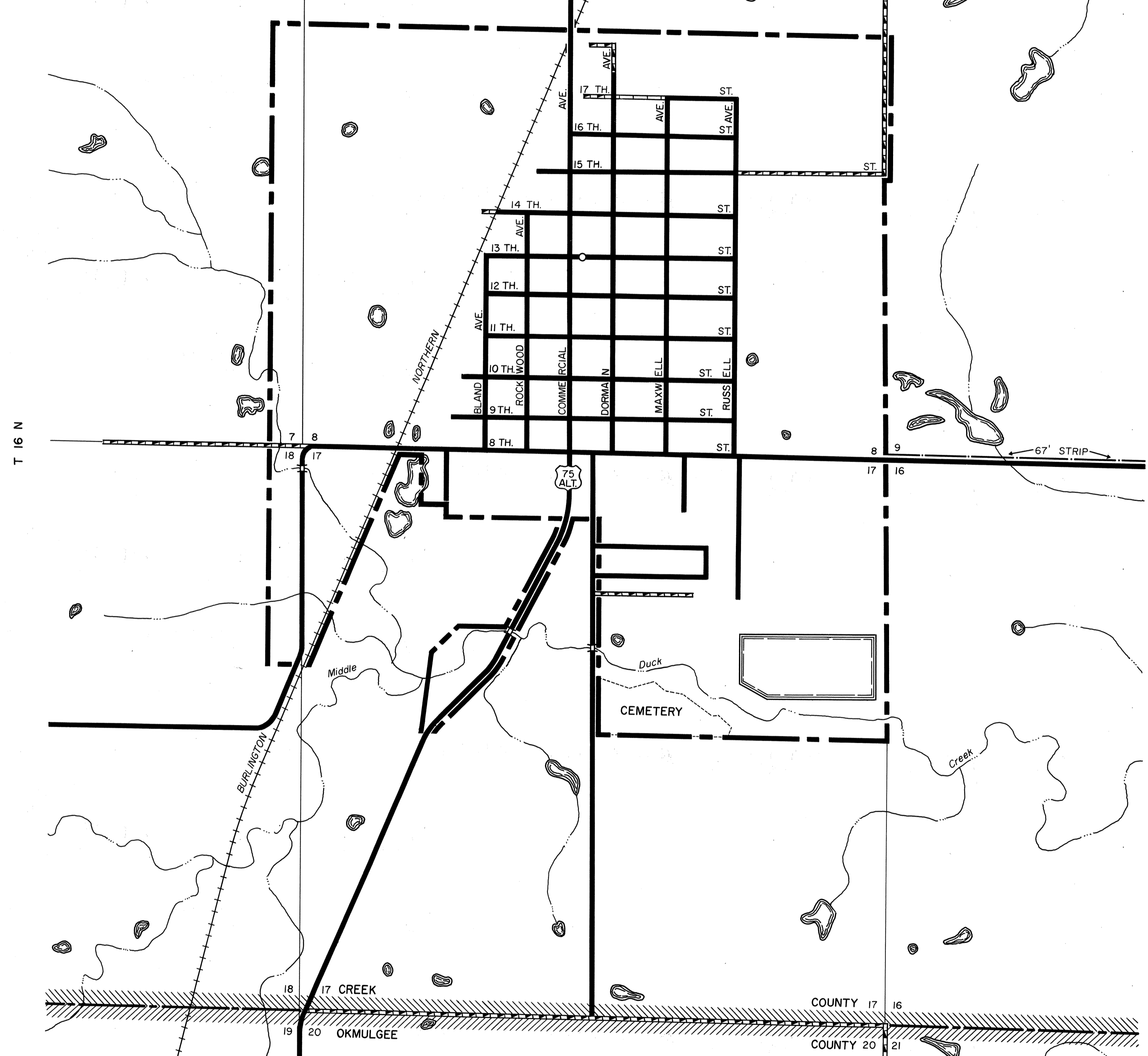

1 INCH = 1 MILE

STATE OF OKLAHOMA
 DEPARTMENT OF TRANSPORTATION

CITY OF
MOUNDS
 CREEK COUNTY

1990
 POPULATION
 960

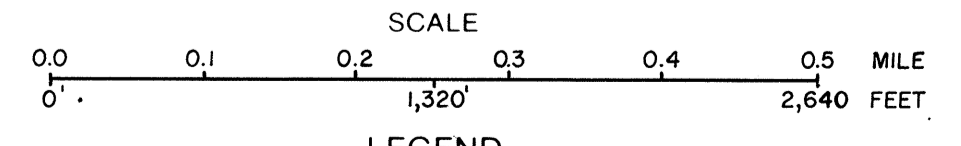

LEGEND

- | | | |
|--------------------------|------|--------------------------|
| PAVED | 10.0 | CORPORATE LIMITS |
| GRAVEL | 0.9 | STATE NUMBERED ROUTES |
| GRADED & DRAINED | 0.1 | U.S. NUMBERED ROUTES |
| UNIMPROVED | 0.0 | INTERSTATE ROUTES |
| TOTAL STREETS & HIGHWAYS | 11.0 | STREETS 9.7 HIGHWAYS 1.3 |

ALL RIGHTS RESERVED

MOUNDS, CREEK CO.
 DEC. 1989

