

ENLARGED AREA

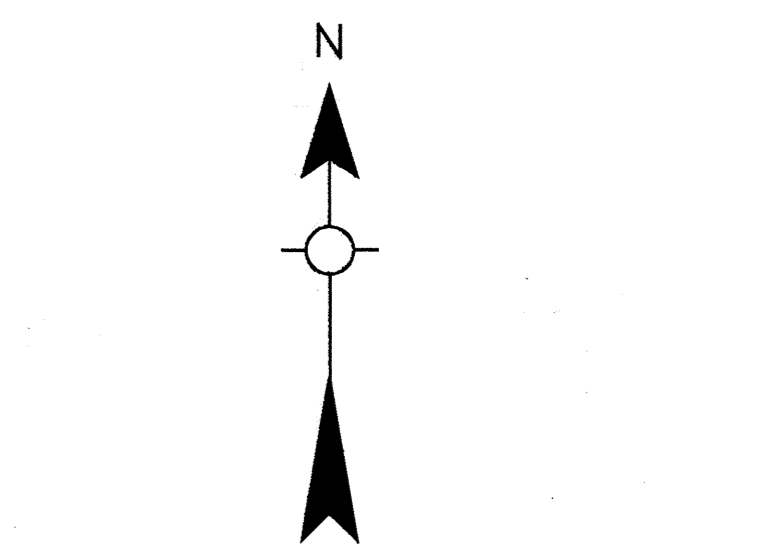
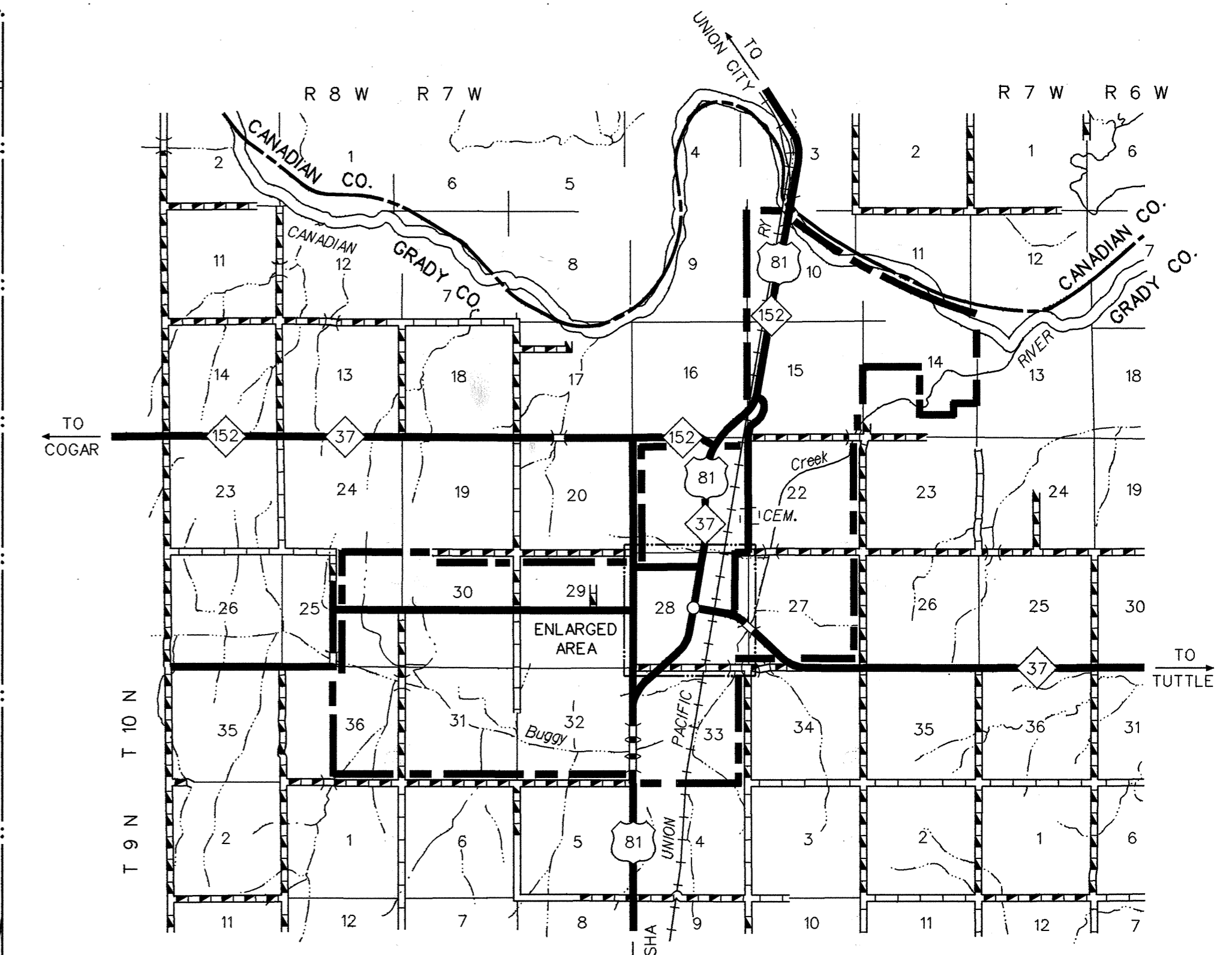

STATE OF OKLAHOMA
 DEPARTMENT OF TRANSPORTATION
 CITY OF
MINCO
 GRADY COUNTY
 1990
 POPULATION
 1,411
 SCALE
 0 0.1 0.2 0.25 MILE
 0' 500' 1,000' 1,320 FEET

LEGEND

MILEAGE	
PAVED	22.7
GRAVEL	5.9
GRADED & DRAINED	1.0
UNIMPROVED	0.2
TOTAL STREETS & HIGHWAYS	29.8
ALL RIGHTS RESERVED	
CORPORATE LIMITS	22.7
STATE NUMBERED ROUTES	5.9
U.S. NUMBERED ROUTES	1.0
INTERSTATE ROUTES	0.2
STREETS	23.4
HIGHWAYS	6.4

Copies of this map are available for public use at nominal cost.
 Address:
 OKLAHOMA DEPARTMENT OF TRANSPORTATION
 REPRODUCTION BRANCH (Phone - 521-2586)
 200 N.E. 21st STREET
 OKLAHOMA CITY, OKLA. 73105

SEPT. 1989