

Copies of this map are available for public use at nominal cost.
Address:
OKLAHOMA DEPARTMENT OF TRANSPORTATION
PERIODIC STATION
200 EAST STEPHENS
OKLAHOMA CITY, OKLA. 73105

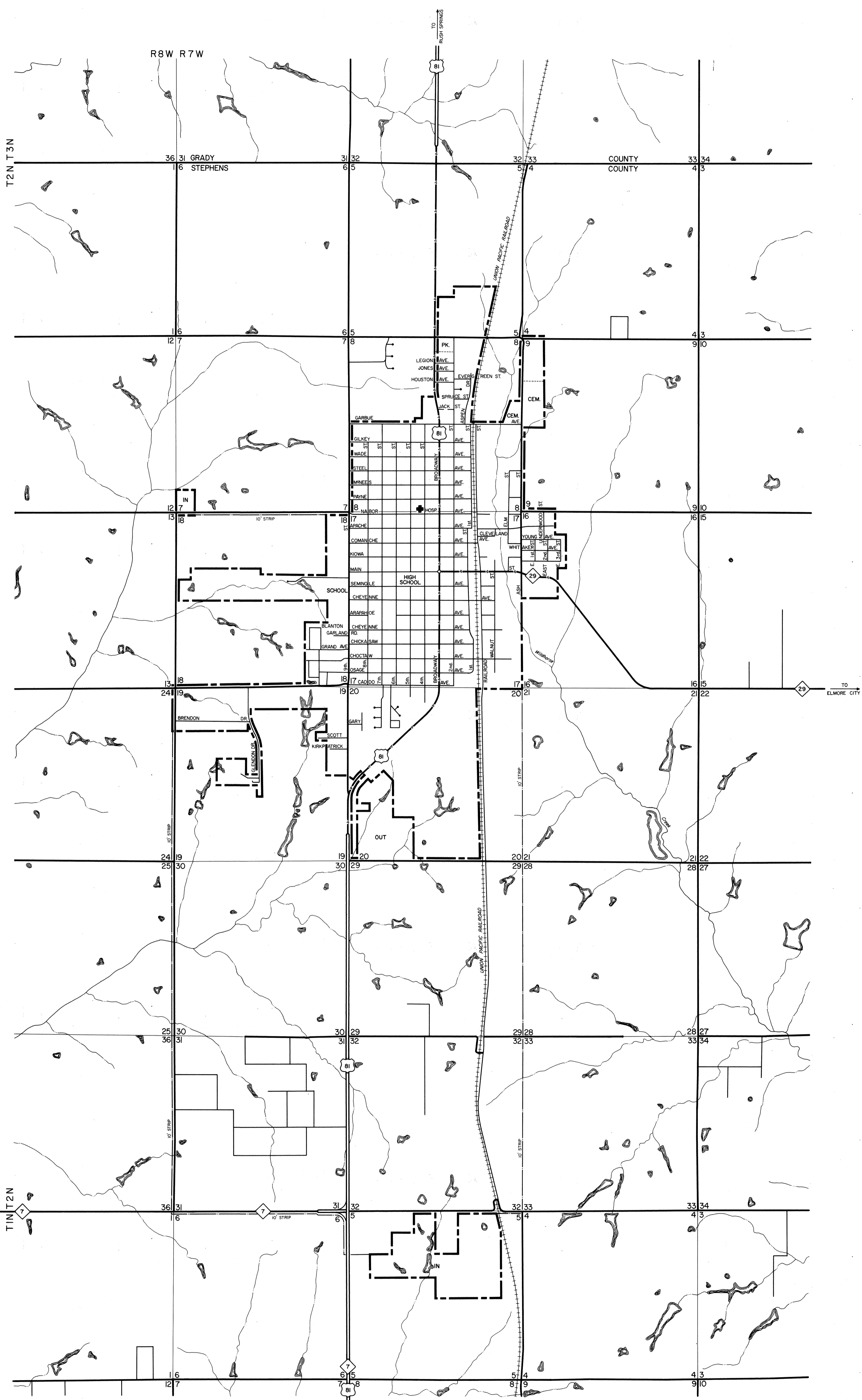

STATE OF OKLAHOMA
DEPARTMENT OF TRANSPORTATION
CITY OF
MARLOW
STEPHENS COUNTY
1990
POPULATION
4,416

SCALE
0.0 0.1 0.2 0.3 0.4 0.5 0.6 0.7 0.8 0.9 1.0 MILE
0' 1,320' 2,640' 3,960' 5,280 FEET

LEGEND

- CORPORATE LIMITS
- STATE NUMBERED ROUTES
- U.S. NUMBERED ROUTES
- INTERSTATE ROUTES

