

R 6 W

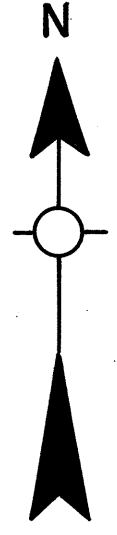

STATE OF OKLAHOMA
 DEPARTMENT OF TRANSPORTATION
 CITY OF
KREMLIN
 GARFIELD COUNTY
 1990
 POPULATION
 243

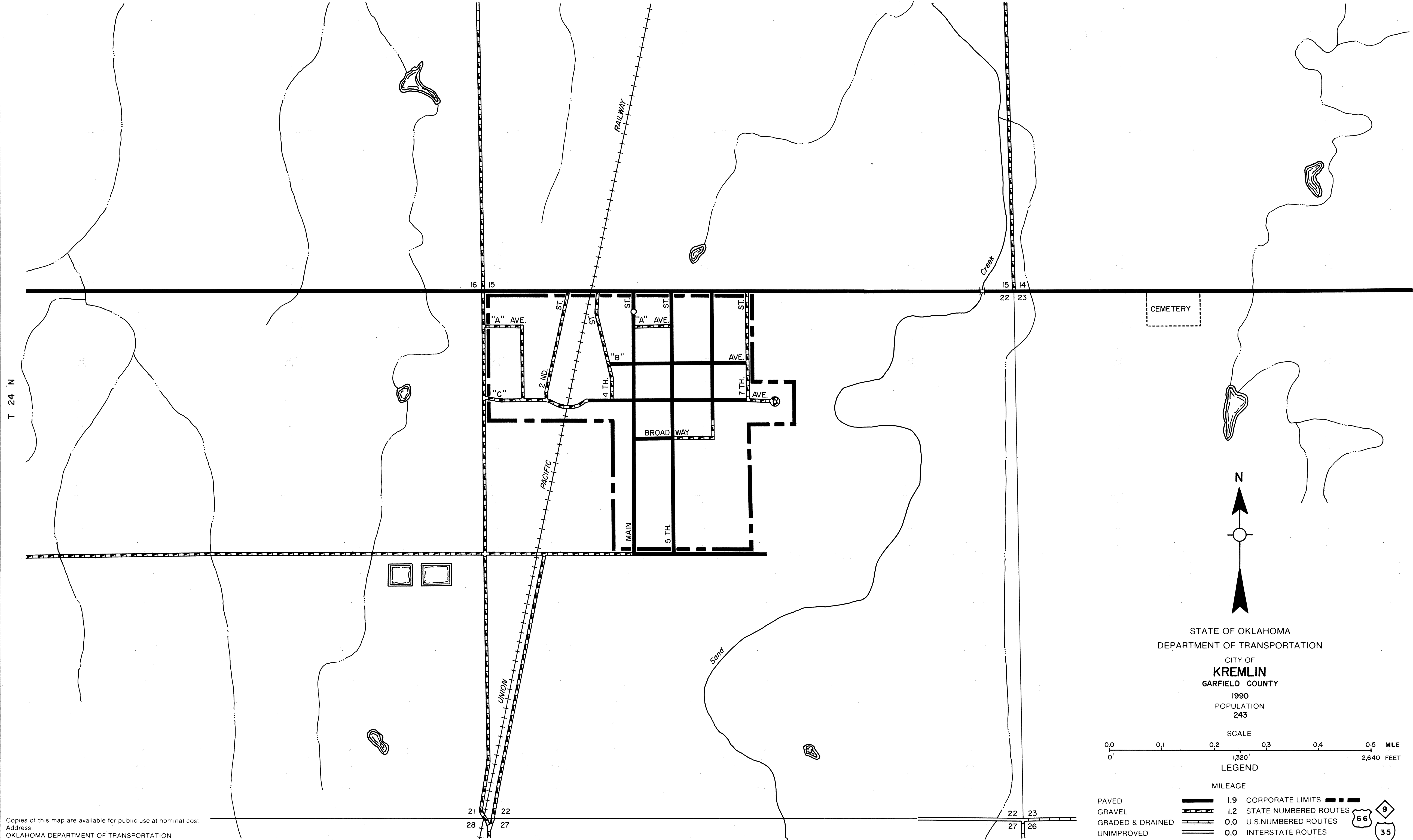
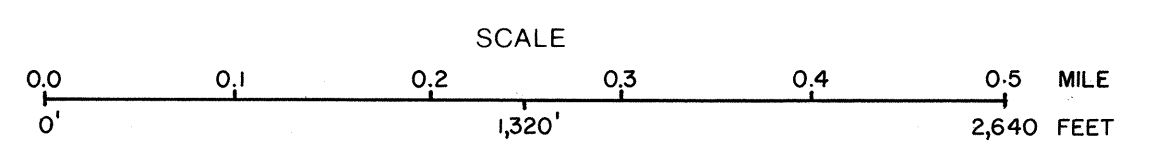

MILEAGE	
PAVED	1.9
GRAVEL	1.2
GRADED & DRAINED	0.0
UNIMPROVED	0.0
TOTAL STREETS & HIGHWAYS	3.1
ALL RIGHTS RESERVED	

1.9	CORPORATE LIMITS	---
1.2	STATE NUMBERED ROUTES	---
0.0	U.S. NUMBERED ROUTES	---
0.0	INTERSTATE ROUTES	---
3.1	STREETS	3.1
0.0	HIGHWAYS	0.0

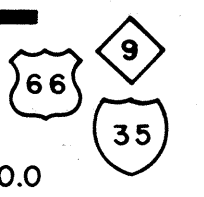

Copies of this map are available for public use at nominal cost.
 Address:
 OKLAHOMA DEPARTMENT OF TRANSPORTATION
 REPRODUCTION BRANCH (Phone - 521-2586)
 200 N. E. 21st STREET
 OKLAHOMA CITY, OKLA 73105

MAY 1989

KREMLIN, GARFIELD CO.