

R 10 E

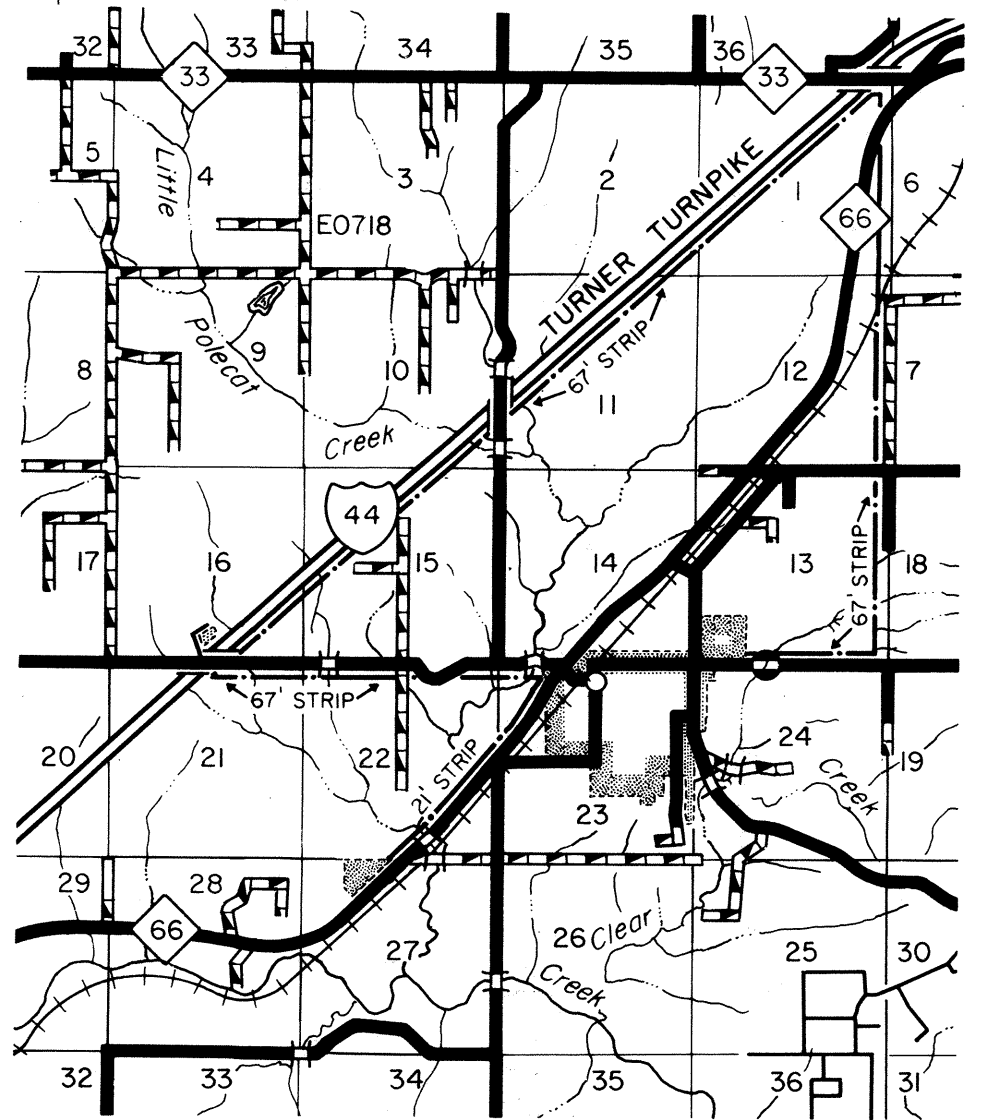
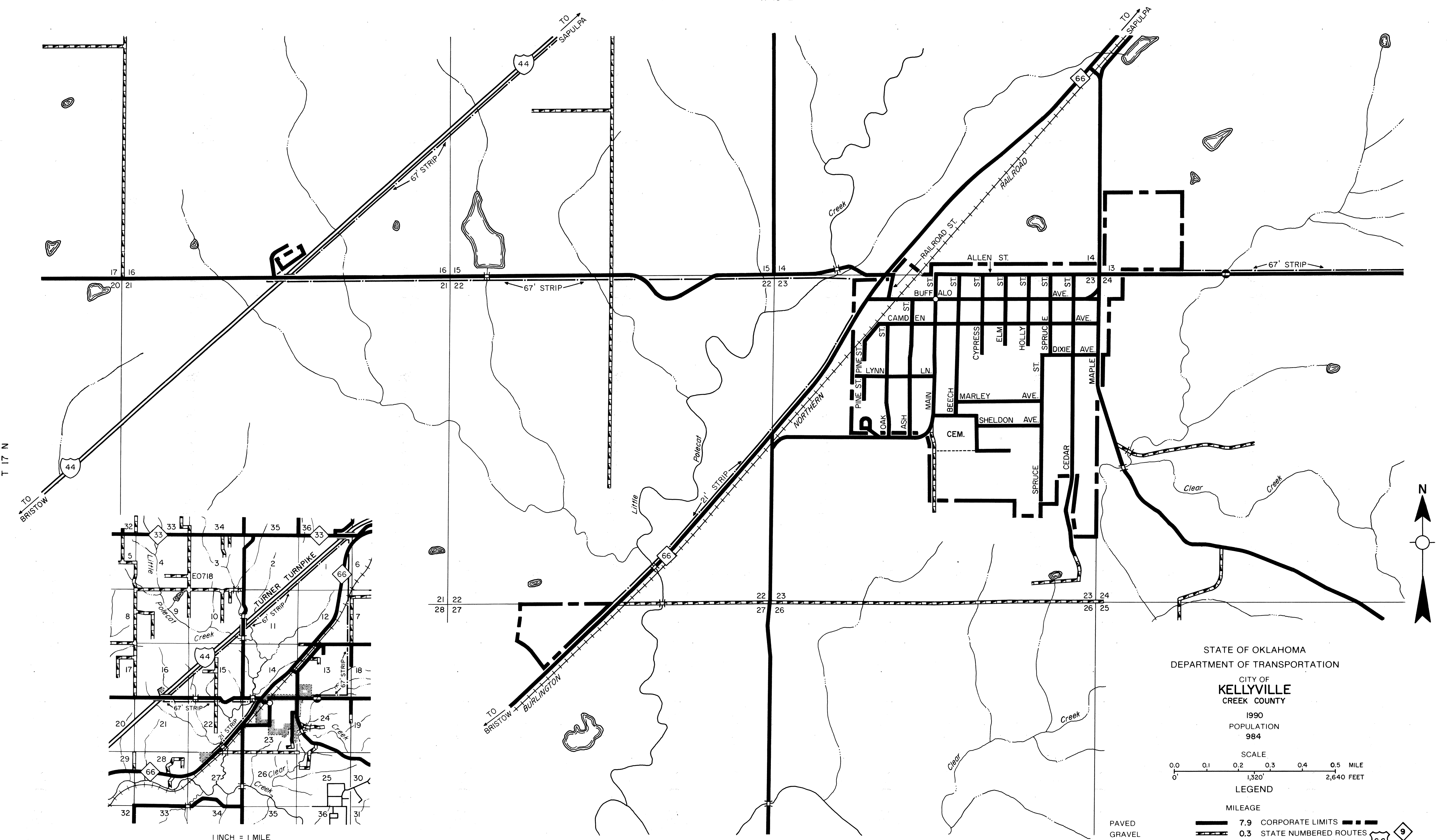

1 INCH = 1 MILE

Copies of this map are available for public use at nominal cost.
 Address:
 OKLAHOMA DEPARTMENT OF TRANSPORTATION
 REPRODUCTION BRANCH (Phone - 521-2586)
 200 N. E. 21st STREET
 OKLAHOMA CITY OKLA 73105

STATE OF OKLAHOMA
 DEPARTMENT OF TRANSPORTATION
 CITY OF
KELLYVILLE
 CREEK COUNTY
 1990
 POPULATION
 984
 SCALE
 0.0 0.1 0.2 0.3 0.4 0.5 MILE
 0 1,320 2,640 FEET
 LEGEND

MILEAGE	
PAVED	7.9
GRAVEL	0.3
GRADED & DRAINED	0.0
UNIMPROVED	0.0
TOTAL STREETS & HIGHWAYS	8.2
ALL RIGHTS RESERVED	
7.9 CORPORATE LIMITS	---
0.3 STATE NUMBERED ROUTES	66 9
0.0 U.S. NUMBERED ROUTES	35
0.0 INTERSTATE ROUTES	
STREETS	8.0
HIGHWAYS	0.2

DEC. 1989

KELLYVILLE, CREEK CO.