

Copies of this map are available for public use at nominal cost
 Address:
 OKLAHOMA DEPARTMENT OF TRANSPORTATION
 REPRODUCTION BRANCH (Phone - 521-2586)
 200 N. E. 21st STREET
 OKLAHOMA CITY, OKLA. 73105

ALL RIGHTS RESERVED

HUNTER, GARFIELD CO.
 MAY 1989

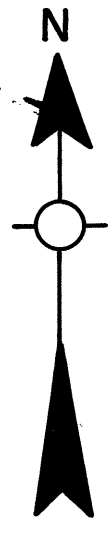
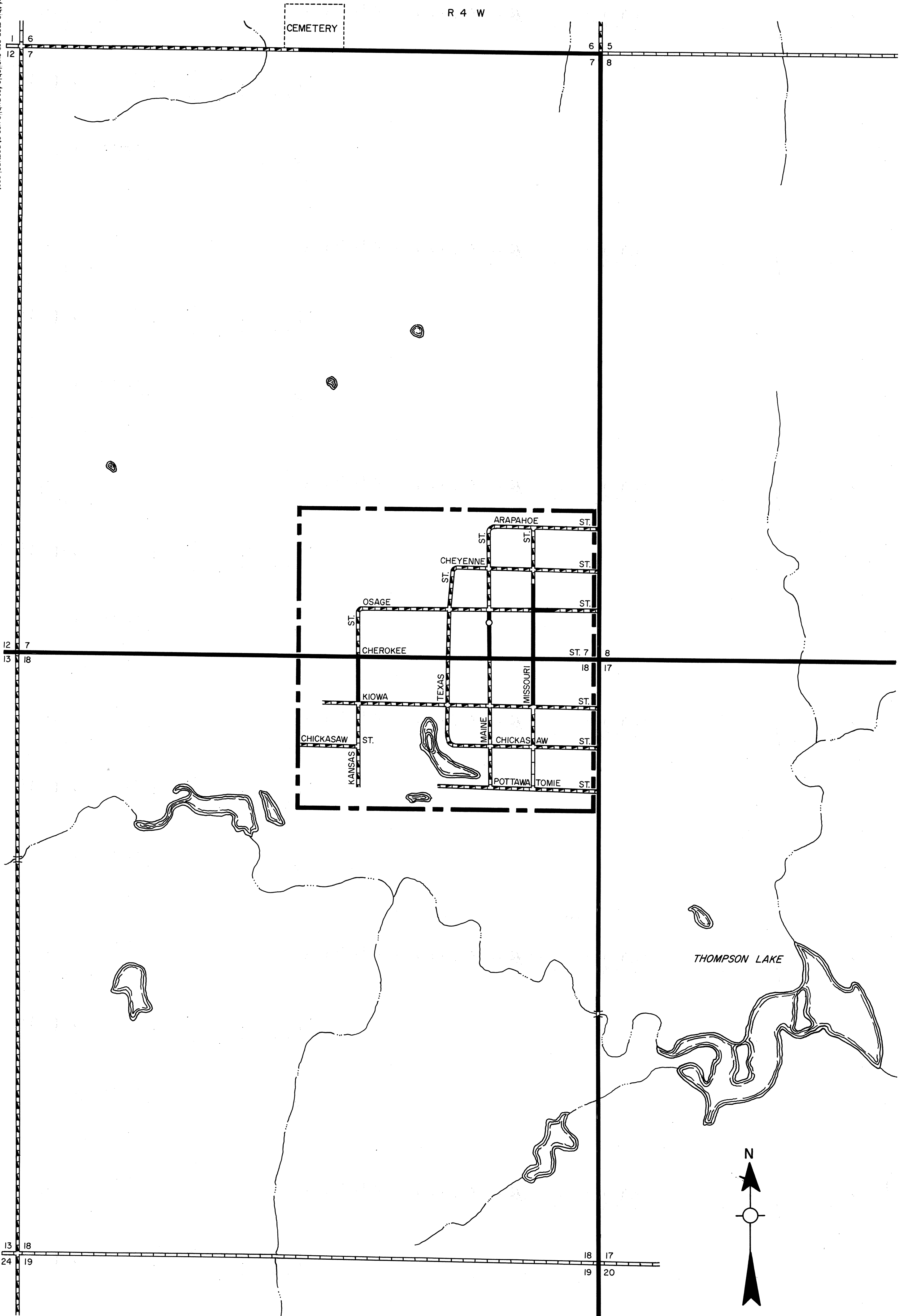

STATE OF OKLAHOMA
 DEPARTMENT OF TRANSPORTATION
 CITY OF
HUNTER
 GARFIELD COUNTY
 1990
 POPULATION
 218

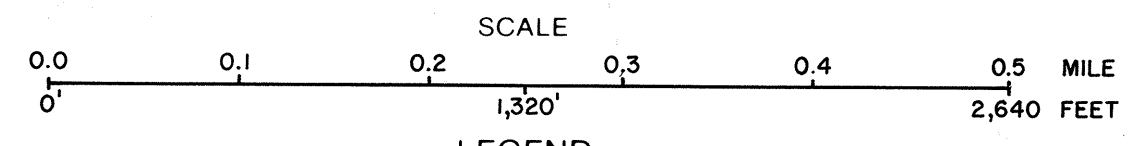

LEGEND

MILEAGE	
PAVED	0.9
GRAVEL	2.8
GRADED & DRAINED	0.1
UNIMPROVED	0.0
TOTAL STREETS & HIGHWAYS	3.8
CORPORATE LIMITS	0.9
STATE NUMBERED ROUTES	2.8
U.S. NUMBERED ROUTES	0.1
INTERSTATE ROUTES	0.0
STREETS	3.8
HIGHWAYS	0.0

