

Copies of this map are available for public use at nominal cost.  
 Address:  
 OKLAHOMA DEPARTMENT OF TRANSPORTATION  
 REPRODUCTION BRANCH (Phone - 521-2566)  
 200 N. E. 21st STREET  
 OKLAHOMA CITY, OKLA. 73105

R 13 W

N 25 N  
 T 25 T

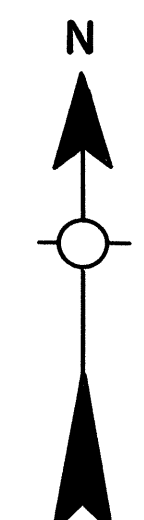
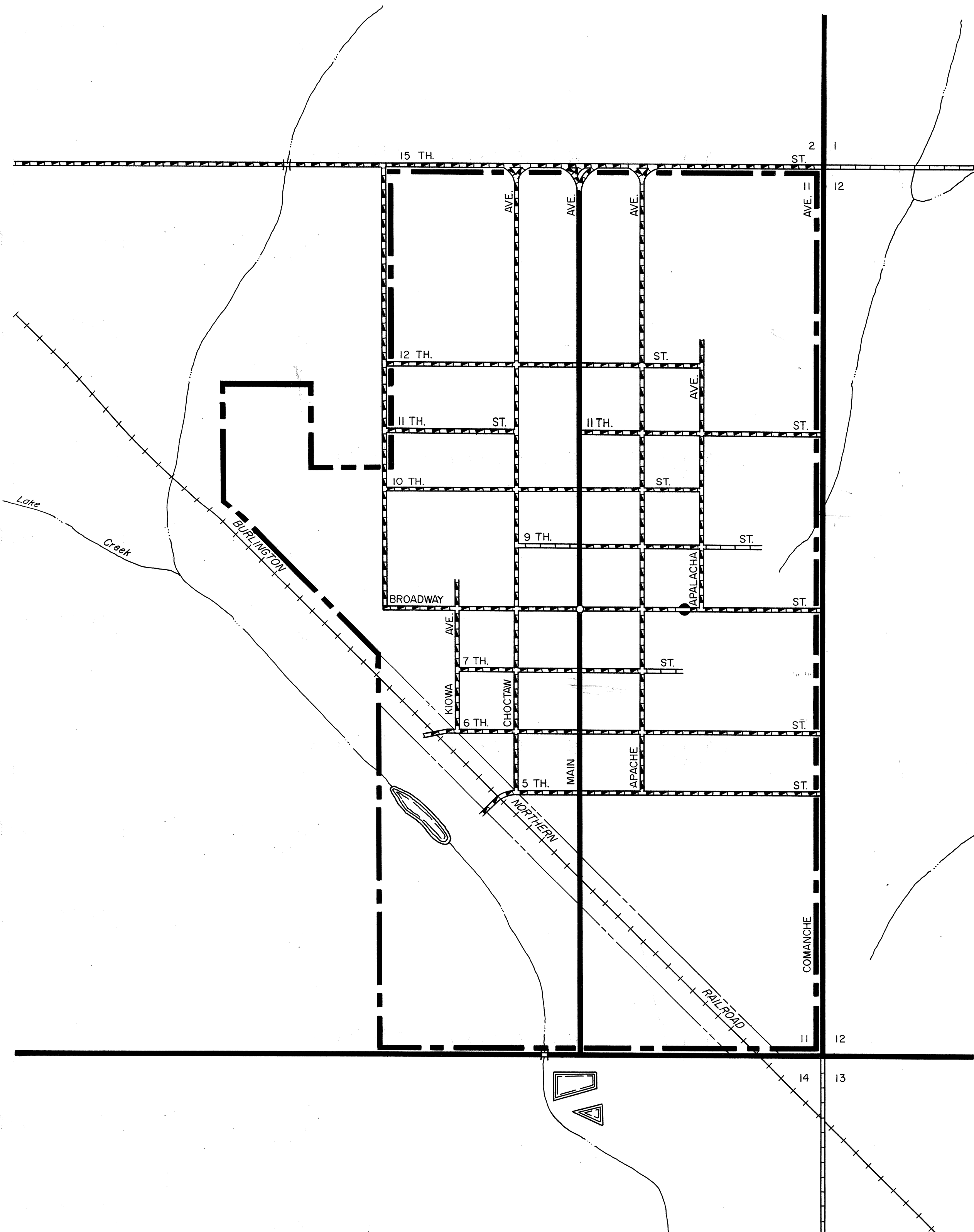

STATE OF OKLAHOMA  
 DEPARTMENT OF TRANSPORTATION

CITY OF  
**DACOMA**  
 WOODS COUNTY

1990  
 POPULATION  
 182

SCALE

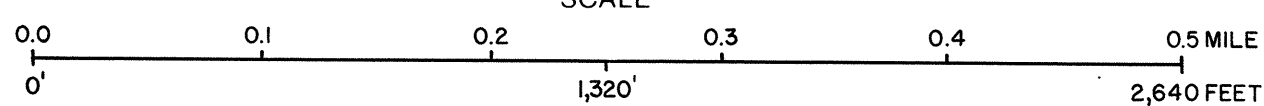

LEGEND

| MILEAGE                  |     |
|--------------------------|-----|
| PAVED                    | 1.0 |
| GRAVEL                   | 4.8 |
| GRADED & DRAINED         | 0.2 |
| UNIMPROVED               | 0.0 |
| TOTAL STREETS & HIGHWAYS | 6.0 |
| CORPORATE LIMITS         | 0.0 |
| STATE NUMBERED ROUTES    | 4.8 |
| U.S. NUMBERED ROUTES     | 0.2 |
| INTERSTATE ROUTES        | 0.0 |
| STREETS                  | 6.0 |
| HIGHWAYS                 | 0.0 |



ALL RIGHTS RESERVED

DACOMA, WOODS COUNTY

AUG. 1987