

Copies of this map are available for public use at nominal cost.
 Address: OKLAHOMA DEPARTMENT OF TRANSPORTATION
 REPRODUCTION BRANCH (phone - 521-2586)
 200 N.E. 21st STREET
 OKLAHOMA CITY, OKLA. 73105

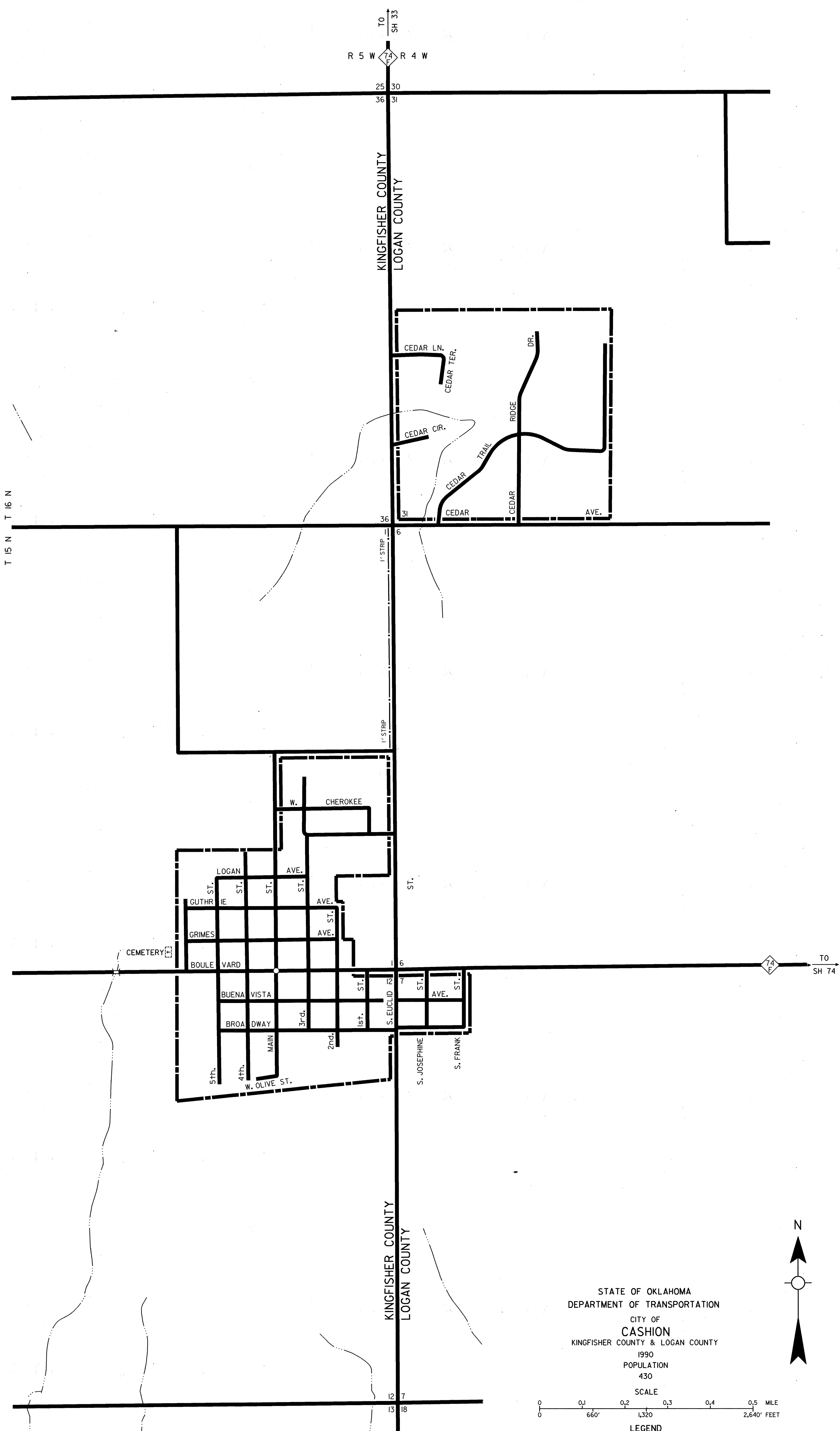

STATE OF OKLAHOMA
 DEPARTMENT OF TRANSPORTATION
 CITY OF
CASHION
 KINGFISHER COUNTY & LOGAN COUNTY
 1990
 POPULATION
 430

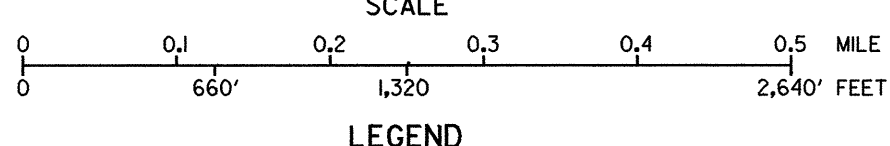

LEGEND
 CORPORATE LIMITS ———
 STATE NUMBERED ROUTES (66, 9)
 U.S. NUMBERED ROUTES (35)
 INTERSTATE ROUTES

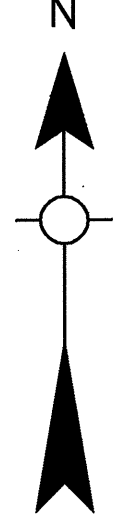

ALL RIGHTS RESERVED COMPUTER GENERATED DEC. 1993 CASHION, KINGFISHER CO. & LOGAN CO.