

BROKEN ARROW NO. 1
N 11 L
FEB. 1992
SHEET 1 OF 2 SHEETS
ALL RIGHT RESERVED
BROKEN ARROW, TULSA CO, WAGONER CO.

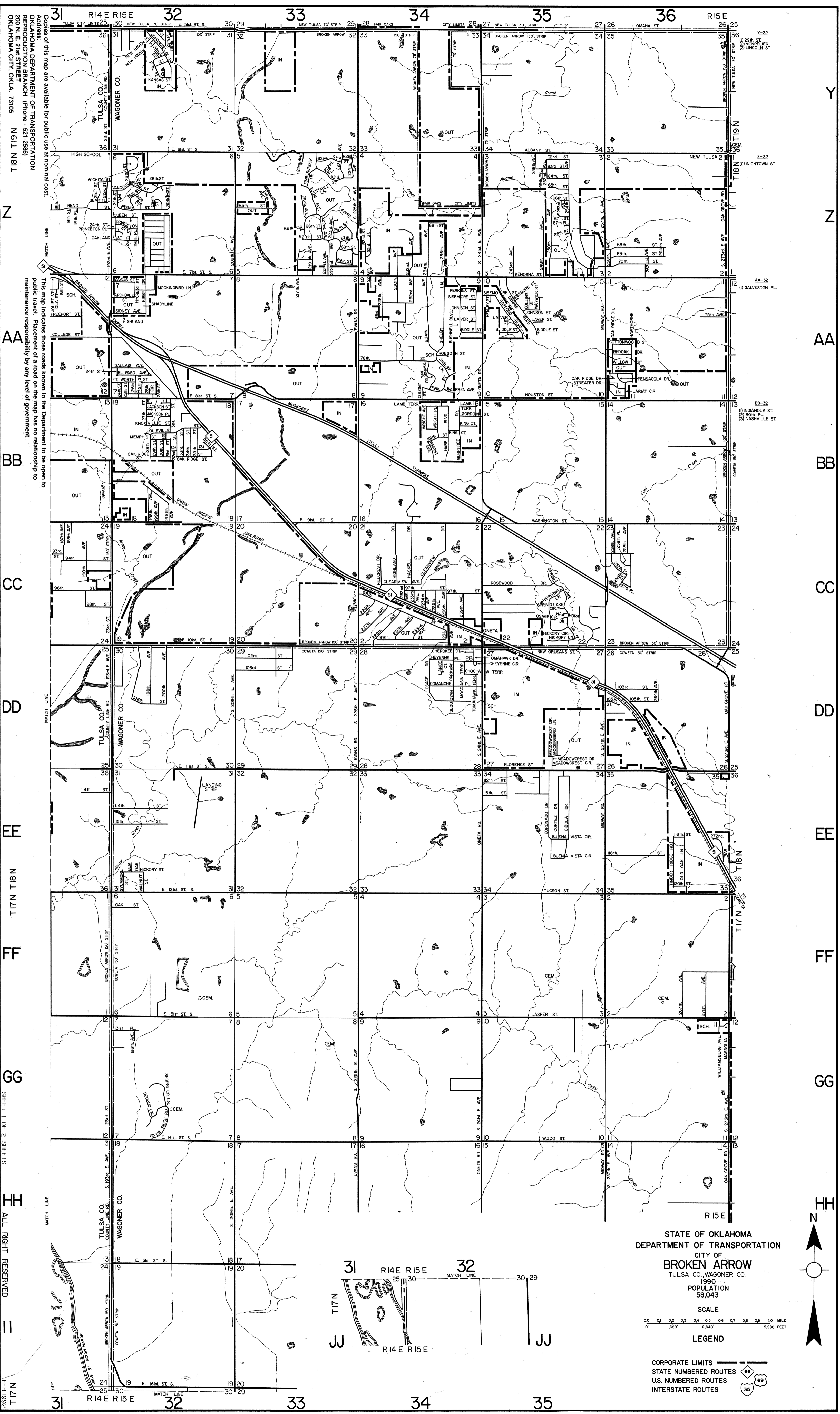

Copies of this map are available for public use at nominal cost.
Address:
OKLAHOMA DEPARTMENT OF TRANSPORTATION
OKLAHOMA CITY BRANCH (Phone - 521-2585)
260 N. OAK STREET
OKLAHOMA CITY, OKLA. 73106 N 61 L N 81 L

This map indicates those roads known to the Department to be open to public travel. Placement of a road on the map has no relationship to maintenance responsibility by any level of government.

STATE OF OKLAHOMA
DEPARTMENT OF TRANSPORTATION
CITY OF
BROKEN ARROW
TULSA CO, WAGONER CO.
1990
POPULATION
58,043
SCALE
0 0.1 0.2 0.3 0.4 0.5 0.6 0.7 0.8 0.9 1.0 MILE
0 0.1 0.2 0.3 0.4 0.5 0.6 0.7 0.8 0.9 1.0 FEET
LEGEND
CORPORATE LIMITS
STATE NUMBERED ROUTES 66 69
U.S. NUMBERED ROUTES 35
INTERSTATE ROUTES

