

Copies of this map are available for public use at nominal cost.  
ADDRESS: OKLAHOMA DEPARTMENT OF TRANSPORTATION  
REPRODUCTION BRANCH (Phone - 521-2586)  
200 N. E. 21st STREET  
OKLAHOMA CITY, OKLA. 73105

DD  
EE  
FF  
GG  
HH  
II  
JJ  
KK  
LL  
MM  
NN

- 0022 (1) KNOXVILLE AVE.
  - (2) LOUISVILLE AVE.
  - (3) OSWEGO AVE.
  - (4) OSWEGO PL.
  - (5) RICHMOND AVE.
  - (6) RICHMOND PL.
  - (7) QUEBEC PL.
  - (8) 105th. ST.
  - (9) SANDUSKY AVE.
  - (10) VANDALIA AVE.
  - (11) QUEBEC AVE.
- 0023 (1) BRADEN AVE.
  - (2) CANTON AVE.
  - (3) FULTON AVE.
  - (4) GRANITE AVE.
- 0024 (1) 104th. ST.
  - (2) 103th. ST.
  - (3) 66th. AVE.
  - (4) 71st. AVE.
- 0025 (1) 83rd. PL.
  - (2) 84th. AVE.

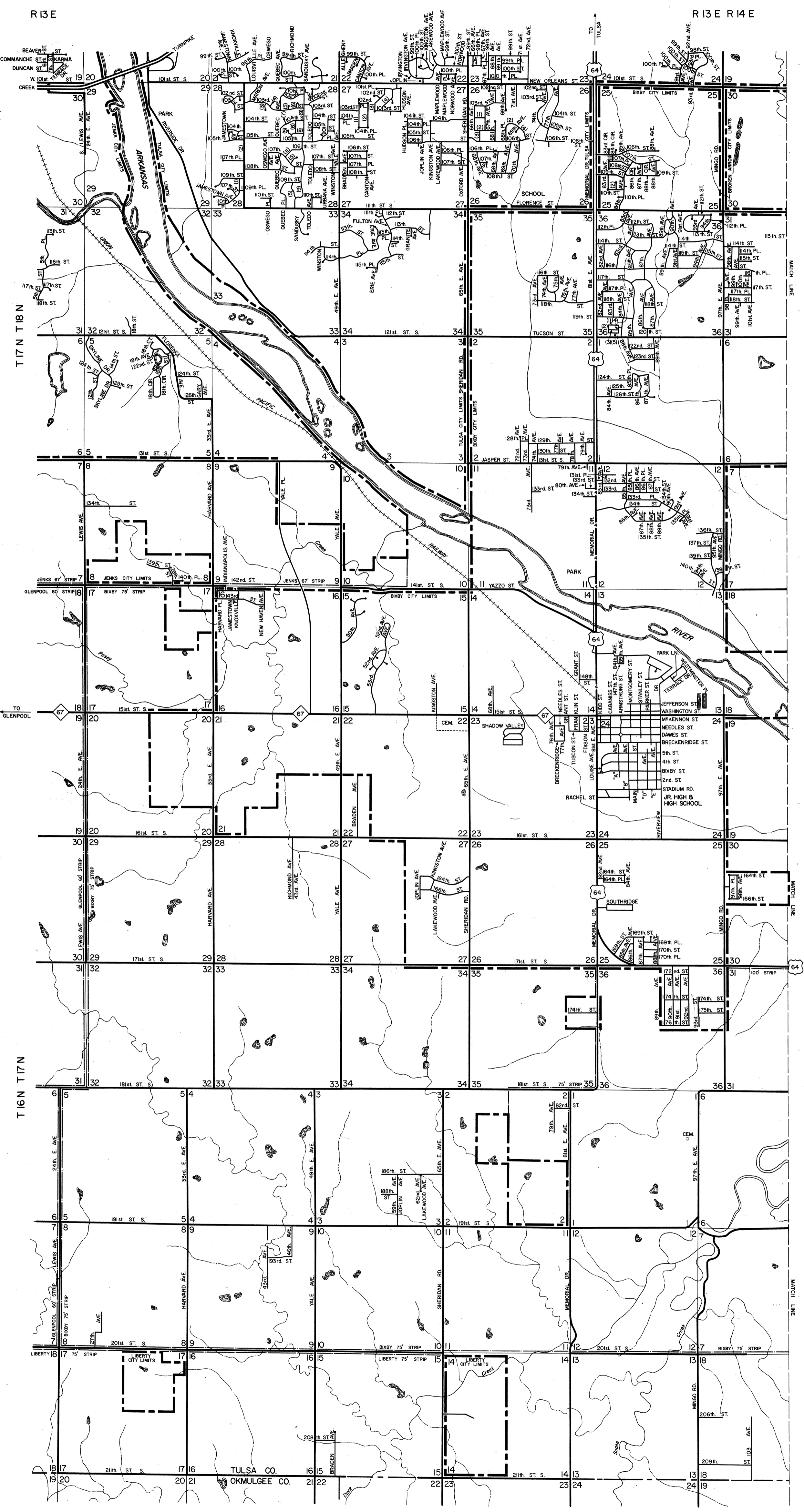

CC  
DD  
EE  
FF  
GG  
HH  
II  
JJ  
KK  
LL  
MM  
NN

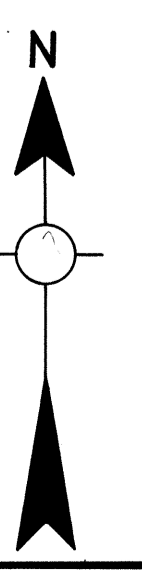

SHEET 2 OF 2 SHEETS  
ALL RIGHT RESERVED  
BIXBY, TULSA CO., WAGONER CO.  
JULY 1991