

Cultural Resources and ODOT Construction Projects



SCOTT SUNDERMEYER

ODOT CULTURAL RESOURCES PROGRAM DIRECTOR

ODOT Standard Specifications (2009)



- Spec 107.09 – Protection of Archeological and Unmarked Burial Sites
 - Presents and establishes the field review procedures for **contractor-selected off-site facilities** and **construction**
 - ✦ Responsibilities of the 1) Resident Engineer, 2) ODOT Archeologist
- Two areas where protection is necessary
 - 1) Off-site facilities that are contractor-selected and not part of the environmental review
 - 2) Discoveries during construction of the project - *after* the environmental review of the project

What are Off-site Facilities



- Definition of *Off-site Facilities*
 - Plant sites, borrow pits, waste areas, haul roads, storage sites, parking areas, and similar areas associated with the acquisition, production, and delivery of borrow material and related road building materials (107.09)
- Location is called in (405-325-7201) or submitted via ODOT web site by the Resident Engineer
 - <http://www.odotculturalresources.info/off-site-facility-search.html>
 - Legal location to the 1/4, 1/4 section (40 acres)
 - Allow 10 days for the review
- ODOT archeologist will conduct a file review of the legal location and report back to Residency
 - We may ask for a *refinement* of your selected area in order to avoid archeological sites



**We are
NOT
approving
anything**

We simply do
a *screening*
for
archeological
sites



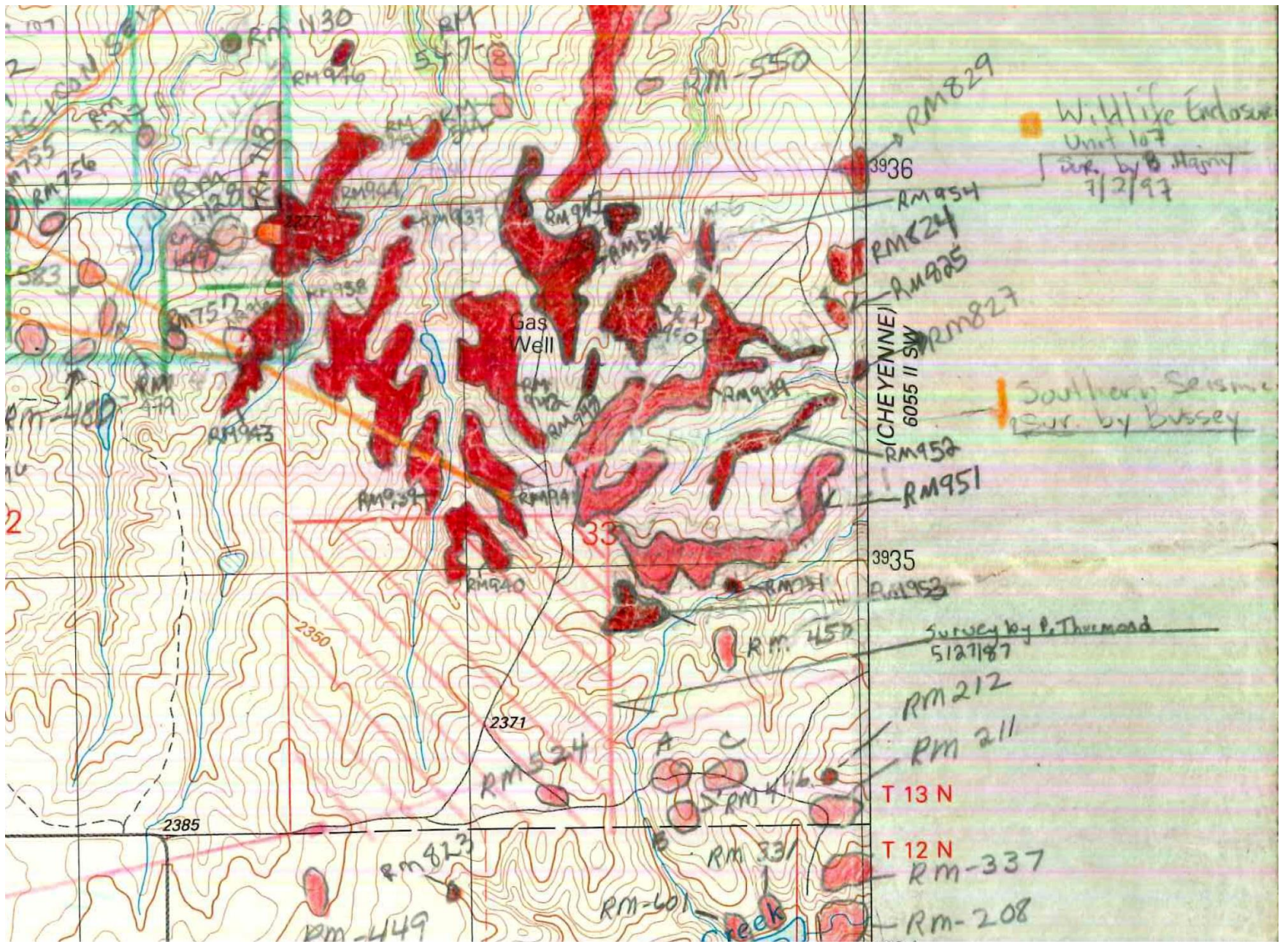



Osage
Nation
Mineral
Reservation
Sandy Soil
Permit

2009
Special Provision 202-2



The contractor is expected to consult with the Bureau of Indian Affairs as part of the *Osage Nation Reservation Sandy Soil Mining Permit*.

...which is a federal permit issued by the BIA

What to look for during construction, excavation, and/or off-site facility examination

- “...remains of prehistoric dwelling sites or artifacts of historical or archaeological significance...”
 - “...unmarked human burial...”
 - require that the contractor immediately cease all activities in the surrounding area and notify the Resident Engineer
-

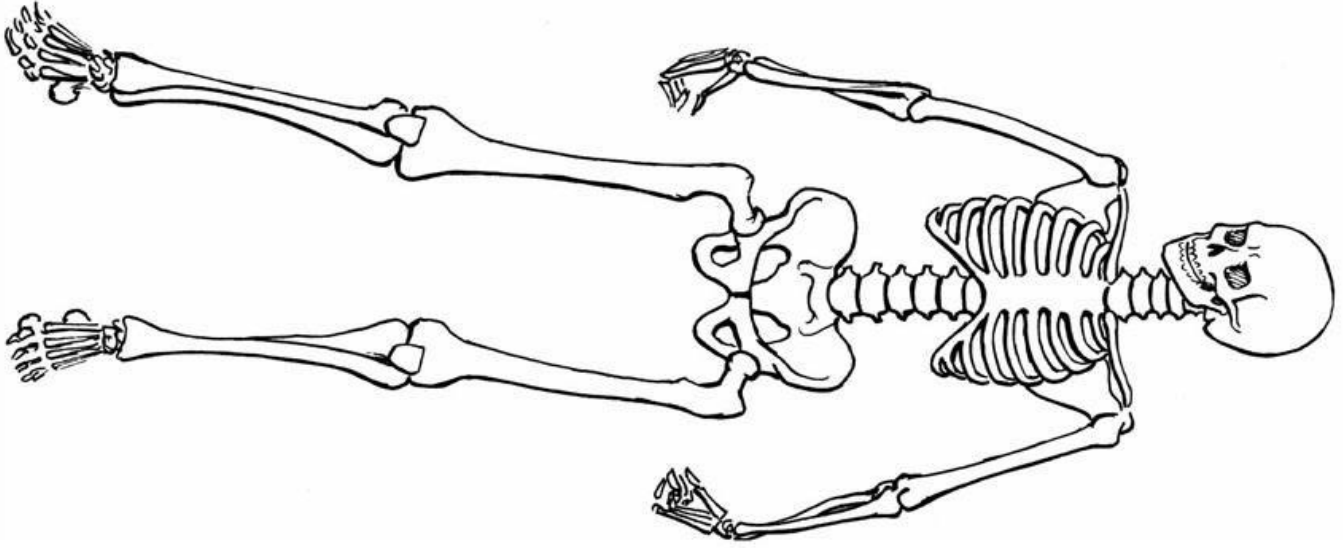







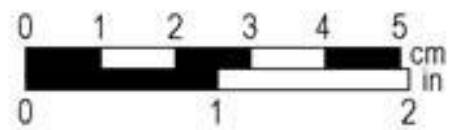

Prehistoric feature stain

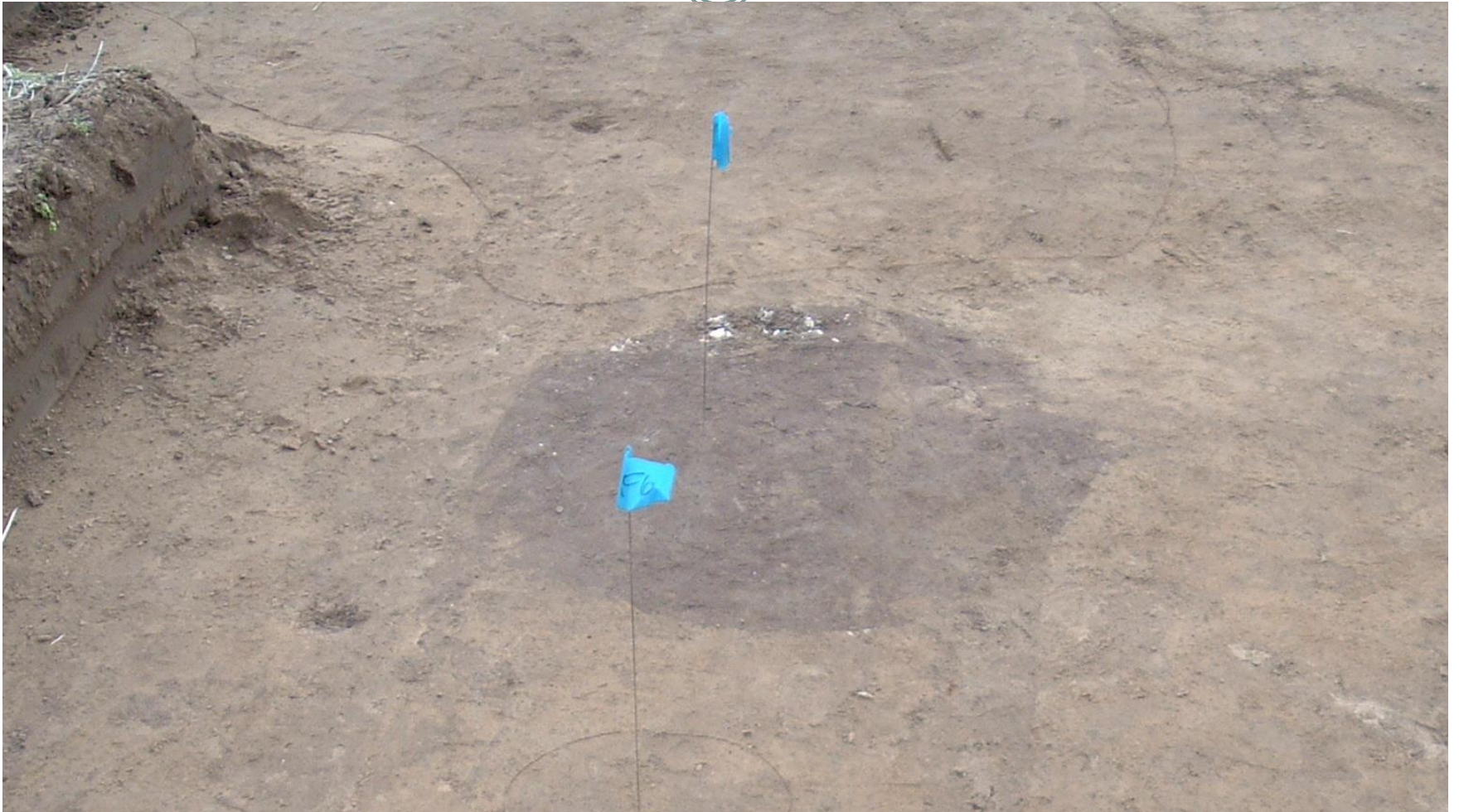

























9-25-10 100ft

9-25-10 500ft





Bottom Line



- You will find “archeology”...
 - Spec book intended for use with unanticipated discoveries for
 - ✦ Off-site facilities (Borrow pit and other excavation)
 - ✦ Project Construction
- There is a chance we already know about it
- Our folks intend to begin visiting Residencies or preparing workshops/talks for the Resident Academy, etc.
- Contact ODOT Cultural Resources Program
 - 405-325-7201
 - ssundermeyer@ou.edu