

NOTE:
 1. CONSTRUCTION SIGNS SHALL BE VISIBLE ONLY WHEN ACTIVITIES WARRANT. TO BE COVERED OR REMOVED WHEN NOT IN USE.
 2. EXISTING SIGNS THAT WOULD INTERFERE WITH CONSTRUCTION ZONE SIGNING SHALL BE REMOVED OR COVERED.
 3. DIRECTIVES FROM STANDARD PDT-1 "PAVEMENT DROP-OFF TREATMENTS" SHALL BE FOLLOWED AT ALL TIMES.
 4. (1) W1-8 SHALL BE PLACED ON EVERY OTHER DRUM THRU LANE TAPERS. (1) R4-7A(R) OR (1) R4-7A(L) (AS APPLIES) SHALL BE PLACED ON EVERY OTHER DRUM THRU TANGENT LANES.
 5. GUIDELINES FROM THE 2009 MUTCD SHALL GOVERN.

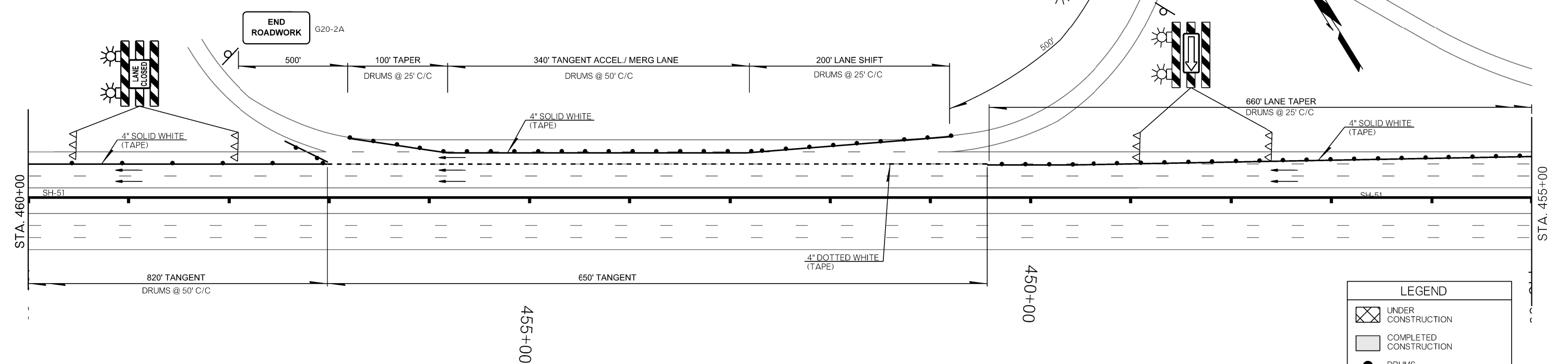

LEGEND	
	UNDER CONSTRUCTION
	COMPLETED CONSTRUCTION
	DRUMS
	TRAFFIC SIGN
	TRAFFIC DIRECTION
	TYPE III BARRICADE
	CONSTRUCTION ZONE IMPACT ATTENUATOR
	PORTABLE LONGITUDINAL BARRIER
	CHANGEABLE MESSAGE SIGN/ ARROW DISPLAY

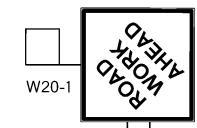
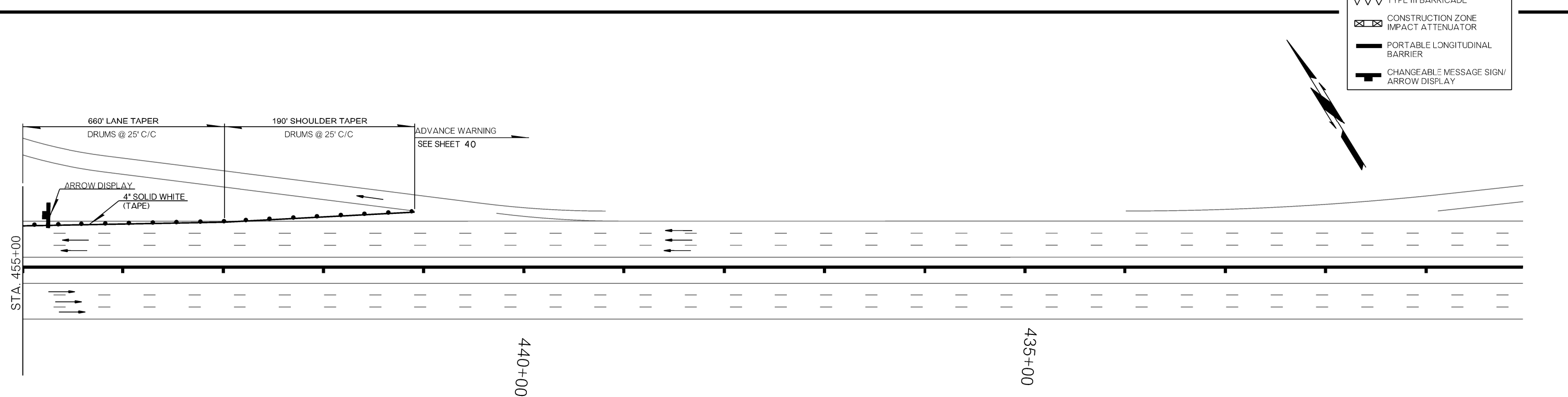

6/2/2017 9:43:34 AM L:\2021\2037096 - 000T EC-414 Task Order 6\Drawings\28878(04)_TC_005.dgn

PHASE 2

DESIGN	MMK	I/17	OKLAHOMA DEPARTMENT OF TRANSPORTATION US-64/SH-51 OVER SHERIDAN RD. SUGGESTED CONSTRUCTION SEQUENCE AND TRAFFIC CONTROL (SHEET 7 OF 9)
DRAWN	BWH	I/17	
CHECKED	NAB	I/17	
APPROVED			
SQUAD	GARVER		
COUNTY	TU_SA	HIGHWAY	SH-51 STATE JOB NO. 28878(04) SHEET NO. 46