

PV1 #6 x 6'-1"
 PV2 #6 x 5'-7"
 DB1 #5 x 4'-11 1/2" Avg.
 DB2 #5 x 4'-9" Avg.

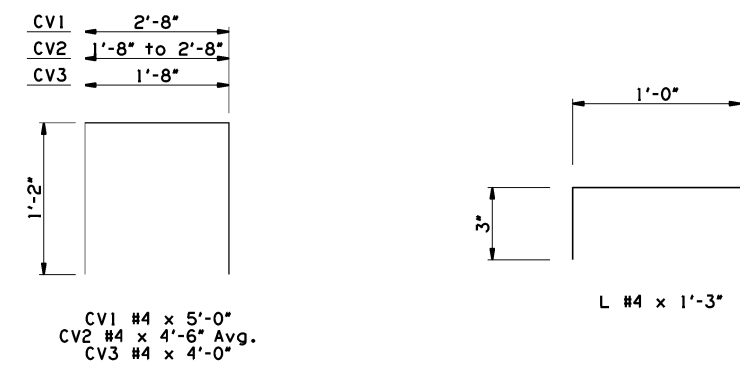

CV1 #4 x 5'-0"
 CV2 #4 x 4'-6" Avg.
 CV3 #4 x 4'-0"
 L #4 x 1'-3"

ITEM	UNIT	PHASE I CONSTRUCTION	PHASE II CONSTRUCTION	TOTAL
④ CLSM BACKFILL	C.Y.	17.70	22.30	40.00
① APPROACH SLAB	S.Y.	106.00	133.70	239.70
SAW-CUT GROOVING	S.Y.	96.40	122.80	219.20
② CONCRETE PARAPET	L.F.	30.00	49.40	79.40
① CLASS AA CONCRETE	C.Y.	38.30	48.30	86.60
MECHANICAL SPLICES	EA.	41.00		41.00
① EPOXY COATED REINFORCING STEEL	LB.	8,050.00	10,070.00	18,120.00
WATER REPELLENT (VISUALLY INSPECTED)	S.Y.	33.00	54.00	87.00

ITEM	UNIT	PHASE I CONSTRUCTION	PHASE II CONSTRUCTION	TOTAL
④ CLSM BACKFILL	C.Y.	23.20	17.20	40.40
① APPROACH SLAB	S.Y.	138.80	103.10	241.90
SAW-CUT GROOVING	S.Y.	122.80	96.40	219.20
③ CONCRETE PARAPET	L.F.	49.40	30.00	79.40
① CLASS AA CONCRETE	C.Y.	50.10	37.30	87.40
MECHANICAL SPLICES	EA.	41.00		41.00
① EPOXY COATED REINFORCING STEEL	LB.	10,660.00	7,790.00	18,450.00
WATER REPELLENT (VISUALLY INSPECTED)	S.Y.	54.00	33.00	87.00

- The contract unit price for "APPROACH SLAB" shall be full compensation for Concrete, Epoxy Coated Reinforcing Steel (including CV1, CV2, CV3, DB1, DB2, PVI & PV2 bars) and Lap Splices, Backer Rod, Rapid Cure Joint Sealant, labor, equipment and other incidentals necessary to complete the work as specified on the plans.
- Quantities shown are for the construction of the Raised Curb & Concrete Barrier. There is an estimated 3.60 C.Y. of Class AA Concrete and 280.00 LBS. of Epoxy Coated Reinforcing Steel in Phase I Construction. There is an estimated 5.90 C.Y. of Class AA Concrete and 460.00 LBS. of Epoxy Coated Reinforcing Steel in Phase II Construction. All costs of Concrete and Epoxy Coated Reinforcing Steel (including CH, L, PH & PV3 Bars) shall be included in the price bid per Linear Foot of "CONCRETE PARAPET".
- Quantities shown are for the construction of the Raised Curb & Concrete Barrier. There is an estimated 5.90 C.Y. of Class AA Concrete and 470.00 LBS. of Epoxy Coated Reinforcing Steel in Phase I Construction. There is an estimated 3.60 C.Y. of Class AA Concrete and 290.00 LBS. of Epoxy Coated Reinforcing Steel in Phase II Construction. All costs of Concrete and Epoxy Coated Reinforcing Steel (including CH, L, PH & PV3 Bars) shall be included in the price bid per Linear Foot of "CONCRETE PARAPET".
- CLSM Backfill shall be used at the discretion of the Engineer, to fill any voids prior to placement of the new Approach Slabs.

MARK	SIZE	NO.	FORM	LENGTH	LENGTH VARIATION
EPOXY COATED REINFORCING STEEL					
AL1	#4	28	STR.	19'-8"	-
AL2	#4	4	STR.	9'-8"	-
AL3	#4	24	STR.	15'-3" AVG.	10'-8" TO 19'-10"
AT1	#4	9	STR.	12'-3" AVG.	2'-2" TO 22'-4"
AT2	#4	1	STR.	24'-0"	-
AT3	#4	10	STR.	26'-8 1/2" AVG.	26'-3" TO 27'-2"
AT4	#4	21	STR.	27'-2"	-
AW1	#5	1	STR.	25'-10"	-
BL1	#9	2	STR.	23'-11 1/2" AVG.	20'-8" TO 27'-3"
BL2	#9	3	STR.	29'-8"	-
BL3	#9	38	STR.	35'-1" AVG.	30'-5" TO 39'-9"
BT1	#4	9	STR.	12'-4" AVG.	2'-4" TO 22'-6"
BT2	#4	1	STR.	24'-2"	-
BT3	#4	10	STR.	26'-10 1/2" AVG.	26'-5" TO 27'-4"
BT4	#4	20	STR.	27'-4"	-
BW1	#5	1	STR.	26'-0"	-
CV1	#4	21	BENT	5'-0"	-
CV2	#4	11	BENT	4'-6" AVG.	4'-0" TO 5'-0"
DB1	#5	28	BENT	4'-11 1/2" AVG.	4'-10" TO 5'-1"
PV1	#6	62	BENT	6'-1"	-
PV2	#6	31	BENT	5'-7"	-
PHASE I CONSTRUCTION					
AL1	#4	28	STR.	19'-8"	-
AL4	#4	25	STR.	24'-6 1/2" AVG	20'-0" TO 29'-1"
AL5	#4	3	STR.	29'-0"	-
AT5	#4	10	STR.	14'-10" AVG.	3'-6" TO 26'-2"
AT6	#4	41	STR.	26'-2"	-
AW2	#5	1	STR.	25'-10"	-
BL4	#9	37	STR.	44'-7 1/2" AVG.	40'-0" TO 49'-3"
BL5	#9	4	STR.	49'-0"	-
BT5	#4	10	STR.	14'-10" AVG.	3'-6" TO 26'-2"
BT6	#4	40	STR.	26'-4"	-
BW2	#5	1	STR.	26'-0"	-
C1	#4	40	STR.	2'-0"	-
CV3	#4	37	BENT	4'-0"	-
D1	#5	1	STR.	2'-6"	-
DB2	#5	28	BENT	4'-9" AVG.	4'-8" TO 4'-10"
PV1	#6	74	BENT	6'-1"	-
PV2	#6	37	BENT	5'-7"	-

MARK	SIZE	NO.	FORM	LENGTH	LENGTH VARIATION
EPOXY COATED REINFORCING STEEL					
AL1	#4	28	STR.	19'-8"	-
AL2	#4	1	STR.	20'-0"	-
AL3	#4	3	STR.	29'-0"	-
AL4	#4	24	STR.	24'-6 1/2" AVG.	20'-0" TO 29'-1"
AT1	#4	41	STR.	27'-2"	-
AT2	#4	10	STR.	15'-3 1/2" AVG.	3'-6" TO 27'-1"
AW1	#5	1	STR.	25'-10"	-
BL1	#9	2	STR.	43'-3 1/2" AVG.	40'-0" TO 46'-7"
BL2	#9	3	STR.	49'-0"	-
BL3	#9	37	STR.	44'-8" AVG.	40'-0" TO 49'-4"
BT1	#4	40	STR.	27'-4"	-
BT2	#4	10	STR.	15'-3 1/2" AVG.	3'-6" TO 27'-1"
BW1	#5	1	STR.	26'-0"	-
CV1	#4	41	BENT	5'-0"	-
CV2	#4	11	BENT	4'-6" AVG.	4'-0" TO 5'-0"
DB1	#5	28	BENT	4'-11 1/2" AVG.	4'-10" TO 5'-1"
PV1	#6	102	BENT	6'-1"	-
PV2	#6	51	BENT	5'-7"	-
PHASE I CONSTRUCTION					
AL1	#4	28	STR.	19'-8"	-
AL5	#4	25	STR.	15'-2 1/2" AVG.	10'-8" TO 19'-9"
AL6	#4	3	STR.	9'-8"	-
AT3	#4	31	STR.	26'-2"	-
AT4	#4	1	STR.	24'-0"	-
AT5	#4	9	STR.	12'-3" AVG.	2'-2" TO 22'-4"
AW2	#5	1	STR.	25'-10"	-
BL4	#9	36	STR.	35'-2" AVG.	30'-7" TO 39'-9"
BL5	#9	4	STR.	29'-8"	-
BT3	#4	30	STR.	26'-4"	40'-0" TO 49'-3"
BT4	#4	1	STR.	24'-2"	-
BT5	#4	9	STR.	12'-5 1/2" AVG.	22'-7" TO 2'-4"
BW2	#5	1	STR.	26'-0"	-
C1	#4	40	STR.	2'-0"	-
CV3	#4	32	BENT	4'-0"	-
D1	#5	1	STR.	2'-6"	-
DB2	#5	28	BENT	4'-9" AVG.	4'-8" TO 4'-10"
PV1	#6	64	BENT	6'-1"	-
PV2	#6	32	BENT	5'-7"	-

US-64/SH-51 EB OVER SHERIDAN RD.		TULSA COUNTY		DESIGN	JGS	6/15
BRIDGE "B"				DETAIL	SJL	1/17
APPROACH SLAB DETAILS (SHEET 4 OF 4)				CHECK	BRT	1/17
				GARVER		
STATE OF OKLAHOMA		DEPARTMENT OF TRANSPORTATION				
		JOB PIECE NO. 28878(04)			SHEET NO. 38	

6/2/2017 9:42:05 AM L:\2021\2037096 - 000T EC-414 Task Order 6\Drawings\BRIDGE\p28878(04)_b-apps4.dgn